

Permit No. _____
A.I. No. _____

STATE OF MISSISSIPPI

Application No. **A1960A**
AI#70120

APPLICATION TO AMEND AN EXISTING PERMIT

MISSISSIPPI DEPARTMENT OF ENVIRONMENTAL QUALITY
OFFICE OF GEOLOGY / MINING & RECLAMATION DIVISION

Other permits required: Y/N Date
NPDES _____
State Operating Permit _____
Corps of Engineers _____

P. O. Box 2279
Jackson, Mississippi 39225-2279
(601) 961-5515
Fax (601) 961-5521

For Office use only

City/County approval
Required Yes _____ No _____
Received Date: _____
County _____
City _____

A. GENERAL INFORMATION

- Existing Permit No. P16-029 Current Acreage 37.50
- 1.. Name of Applicant: Joe McGee Construction Co., Inc.
Mailing Address: PO Box 340, Lake, MS 39092
E-mail Address: jason.mcgee@joemcgeeconst.com
Phone No. 601-775-3754 Fax No. 601-775-3785
Authorized Representative Jason McGee, P.E.
2. Engineering Firm, Consultant, etc.: N/A
Mailing Address: _____
E-mail Address: _____
Phone No. _____ Fax No. _____
3. Name of Mine: Catfish Pit Mine Supervisor: Josh McGee
Phone No. 601-775-3754 Fax No. 601-775-3785
4. Location of Operation (to nearest quarter-quarter section):
See Additional Comments Section
Section _____ Township _____ Range _____ County _____
5. Physical address or nearest named road Hwy 32
6. **Type of Amendment**
☒ Amendment to Expand Operation ☐ Amendment not involving an acreage change
7. Method of Operation
☒ Open Pit ☐ Strip ☐ Dredge ☐ Wash Operation, if so Water Source _____
Wash System Type ☐ Closed system ☐ Open system
8. Acres of new excavation → 30.0
New haul roads, plant site, storage piles, etc. → _____
Total new acreage → 30.0
Number of acres already permitted → 37.50
Total acres for amended permit → 67.50
Materials to be mined Unified ML, CL, and SC
9. Is the Permit Area located: Yes No
a. within 100 feet of a public road? _____ x
b. within 100 feet of a cemetery? _____ x
c. within 300 feet of an occupied building? _____ x

If YES to a, b, or c, a letter must be filed with the Office giving permission from the owner or maintaining authority to mine within these distances to the subject property.

10. Has the applicant applied for, or have, any other permits or licenses that pertain to this or any other mining operation? Yes x No

If "YES," list them in the space provided on page 5, or attach separate pages, and give the current status of each, including any violations or penalties. (See Attached JMC Material Pit List)

B. MINING PROCEDURE AND ENVIRONMENTAL ANALYSIS

- | | |
|---|---|
| 1. Description of materials: | 2. Anticipated Schedule (month/year) |
| Thickness of overburden <u>0.5</u> ft.
(Topsoil MUST be stockpiled
for use during reclamation) | Begin clearing <u>3</u> / <u>2017</u> |
| Thickness of useable material <u>10.0</u> ft. | Begin mining <u>3</u> / <u>2017</u> |
| Total depth of excavation <u>10.5</u> ft. | Complete mining <u>8</u> / <u>2018</u> |
| Estimated annual production <u>725,000</u> tons | Begin reclamation <u>5</u> / <u>2018</u> |
| | Complete reclamation <u>9</u> / <u>2018</u> |
3. Depth to ground water: >10.5 ft.
4. How will dust be controlled?
- ☒ Water on haul roads
- ☐ _____
5. Types of erosion control structures that will be utilized.
- ☒ Settling ponds ☐ Drainage ditches
- ☒ Diversion berms ☐ Terraced slopes
- ☐ _____
6. Describe the land to be affected by mining as it presently exists:
- a. Land use Ag Fields
- b. Predominant vegetation Soy Beans
7. Will explosives be used? Yes x No
8. Is test-boring data available? Yes x No
9. Are toxic materials likely to be encountered at any time? Yes x No
10. Will there be any discharge to local streams or other bodies of water? Yes x No

If any of questions 7-10 are answered "YES," provide additional information on page 5, or attach separate pages.

C. RECLAMATION PLAN

NOTE: It is suggested that the county NRCS office be consulted for specific recommendations on the following items.

1. Describe the soil handling technique for the reclamation phase of the operation:
- ☒ Topsoil segregated ☐ Mixed strata ☐ _____
2. Describe the protection method for the stockpiled topsoil.
- ☐ berm around the storage pile
- ☒ grass cover on the pile (recommended)
- ☐ stored under a cover
- ☐ _____
3. How will highwalls, standing faces, and banks be reduced to minimize erosion? (All highwalls must be sloped, minimum 3 horizontal to 1 vertical.)
- ☐ slopes will be terraced
- ☒ sloped to a gradient of 3 to 1
- ☒ blended with surrounding contours
- ☐ _____

4. What is the general plan for reclamation?

- ☐ reforestation
☒ establish grass cover
☒ pond or lake
☐ _____

5. What planting method will be used?

- ☒ broadcast seed ☐ mechanical seeding
☐ seeding by manual labor
☐ _____

6. How will fertilizer and lime be applied and incorporated?

- ☒ harrowing ☒ broadcasting ☐ disking

7. Quantity of lime and fertilizer to be applied?

a. For initial planting

lime: 1.0 tons per acre

fertilizer: 13 - 13 - 13 (type) 500 pounds per acre

b. For successive years prior to 100% release

fertilizer: 13 - 13 - 13 (type) 200 pounds per acre

when: March (month)

8. Describe the planting schedule:

Tree or Seed Species	Tree spacing or lbs./acre	Planting Season
Common Bermudagrass	15 lbs/acre	Spring/Summer/Fall/Winter
Bahiagrass	40 lbs/acre	Spring/Summer/Fall/Winter
Ryegrass	40 lbs/acre	Fall/Winter
_____	_____	_____

9. Will the area be mulched? Yes x No If yes, rate per acre _____

Method of holding in place: ☐ crimped ☐ _____

10. How will the vegetation be maintained until the final bond release?

- ☐ watering
☒ mowing
times per year 1

approximate month(s) April, _____, _____

- ☒ repairing gullies
☒ replanting eroded areas
☐ _____

11. How will debris be disposed of when the mine is finally closed?

- ☐ burying ☐ burning ☐ hauling away

12. Will a soil analysis be submitted for this site? Yes x No

NOTE: available from the Cooperative Extension Service through the applicant's County Agent

13. Estimated cost per acre for reclamation of this site: \$1,000.00 (minimum of \$1,000 per acre)

RECEIVED
FEB 08 2017
OFFICE OF GEOLOGY
DEPT OF ENVIRONMENTAL QUALITY

D. NAMES AND ADDRESSES OF PERSONS AFFECTED BY THIS OPERATION

1. Landowner(s) of area to be mined/leased

Name: Mike Flautt
Address: PO Box 237
Webb, MS 38966
Phone: 662-375-8792

Name: _____
Address: _____
Phone: _____

2. Landowner(s) within 500 feet of the area

Name: _____
Address: _____
Phone: _____

Name: _____
Address: _____
Phone: _____

Name: _____
Address: _____
Phone: _____

Name: _____
Address: _____
Phone: _____

3. Person(s) living on permit area

Name: N/A
Address: _____
Phone: _____

Name: _____
Address: _____
Phone: _____

RECEIVED
FEB 08 2017
OFFICE OF GEOLOGY
DEPT OF ENVIRONMENTAL QUALITY

I declare that I have knowledge of the facts presented in the preceding pages and in all of the items attached to this application; furthermore, I certify that they are true to the best of my knowledge.

2/3/17
date

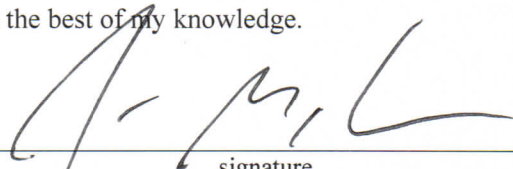
signature

Jason McGee, P.E.
printed name

Vice President
title

RECEIVED

JUL 6 2016

MISSISSIPPI
OFFICE OF GEOLOGY
DEPT OF ENVIRONMENTAL QUALITY

Location

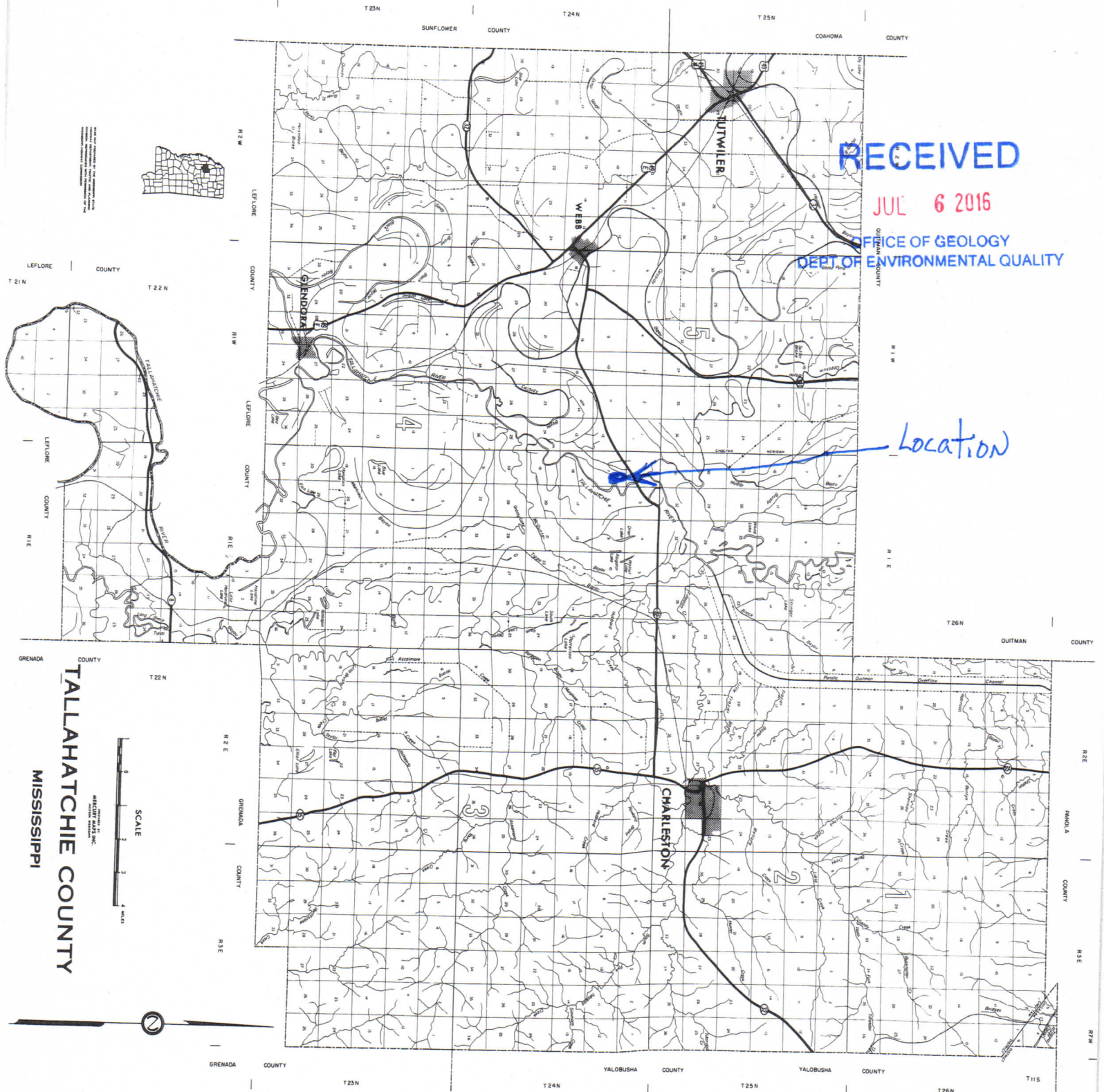

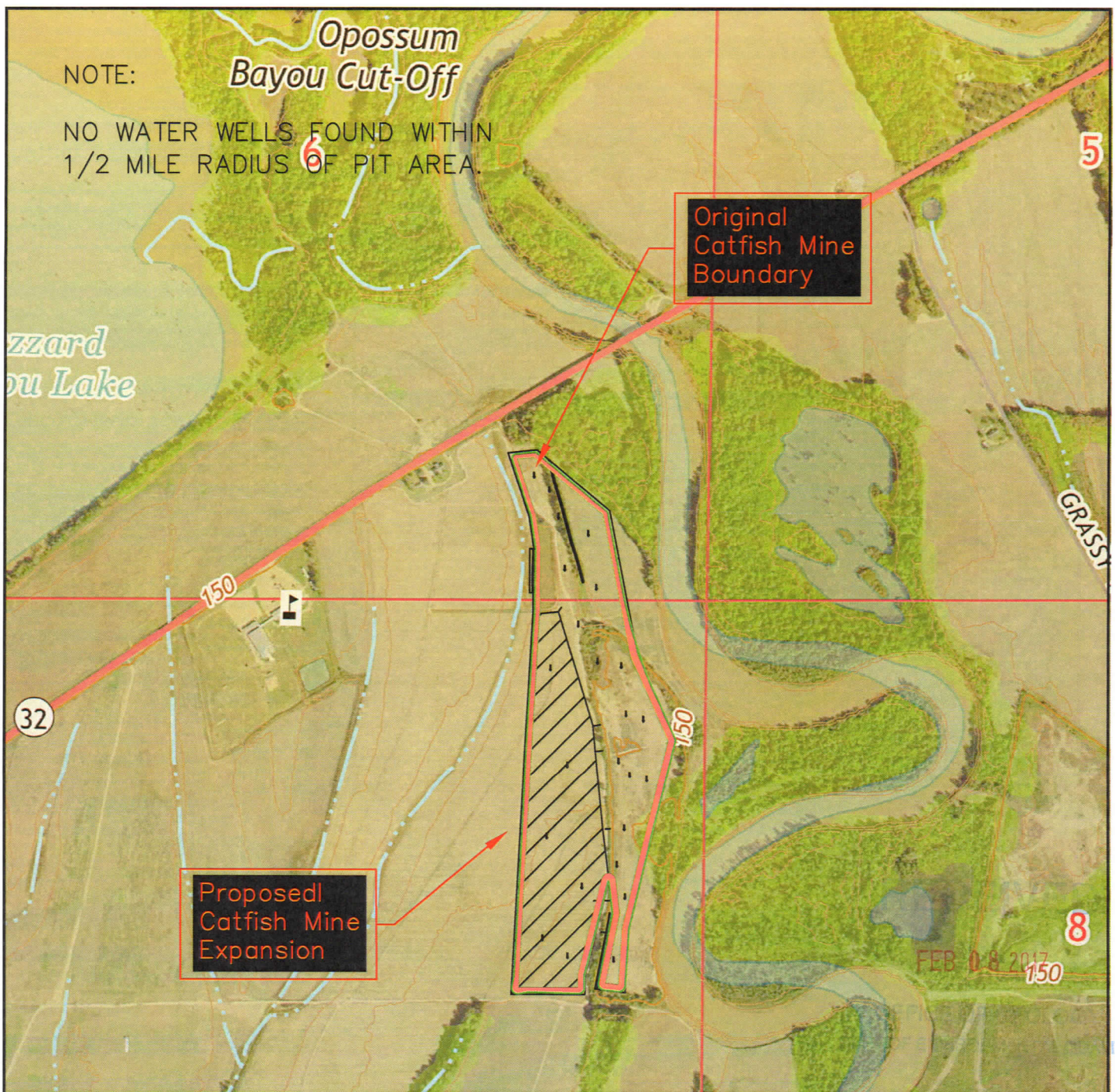

Catfish Mine Expansion is located in part of the SE 1/4 of Section 6, and part of the NE 1/4 of Section 7, Township 24 North, Range 1 East, Tallahatchie County, MS. and contains 30.0 acres more or less.

Mine Entrance is located at:
33° 58' 24.7" North, 90° 13' 48.8" West

Catfish Mine is located within the
Tippo Quadrangle.

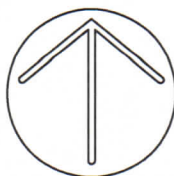

SCALE: 1" = 1000'

Catfish Mine Expansion Aerial Mapping

for
Joe McGee Construction Co., Inc.
P.O. Box 340
Lake, MS 39092

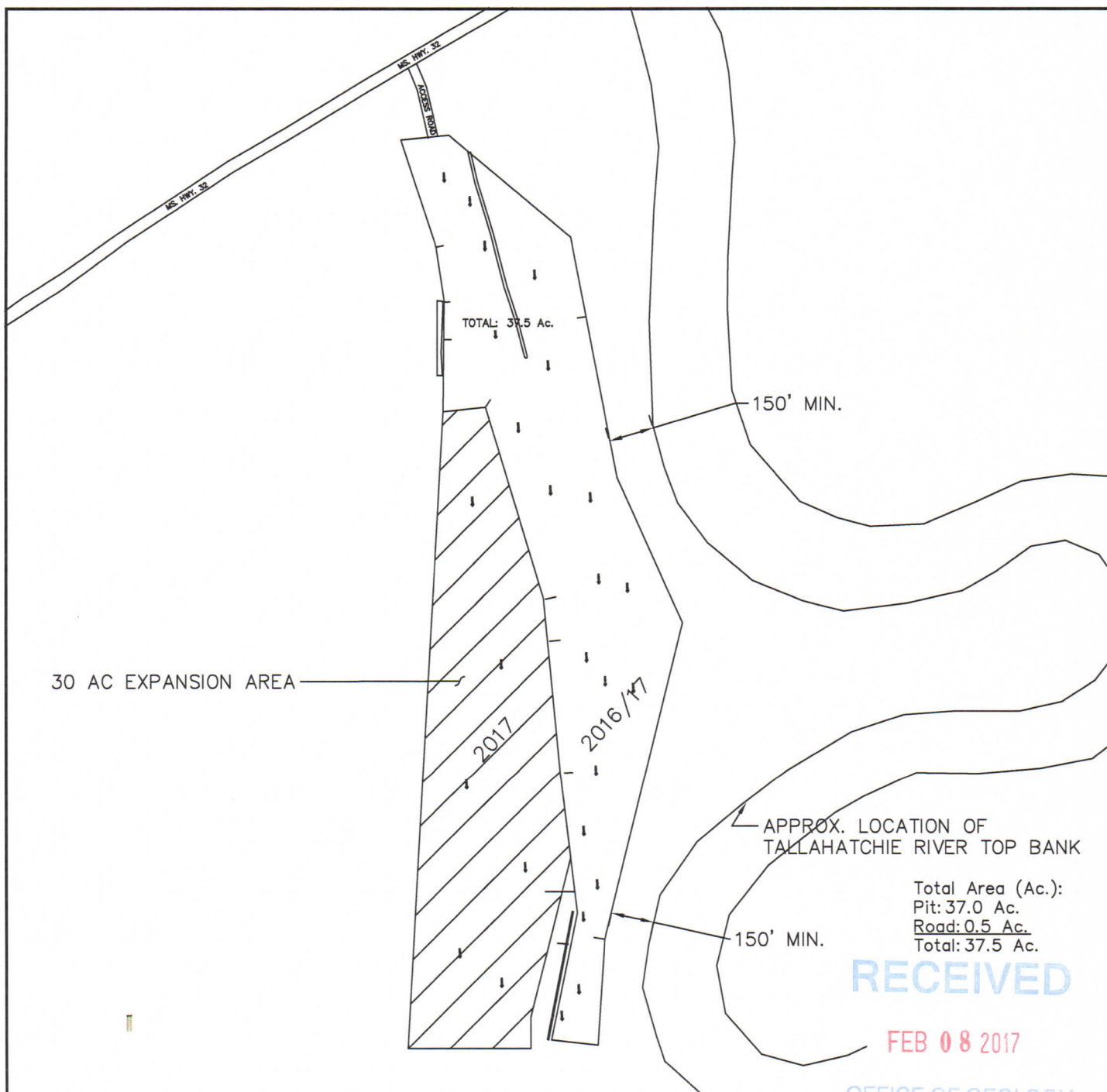

RECEIVED

FEB 08 2017

OFFICE OF GEOLOGY
DEPT. OF ENVIRONMENTAL QUALITY

Pit expansion to be mined in 2017

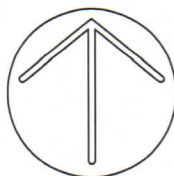

SCALE: 1" = 600'

Catfish Mine Expansion Annual Mining Plan

for
Joe McGee Construction Co., Inc.
P.O. Box 340
Lake, MS 39092

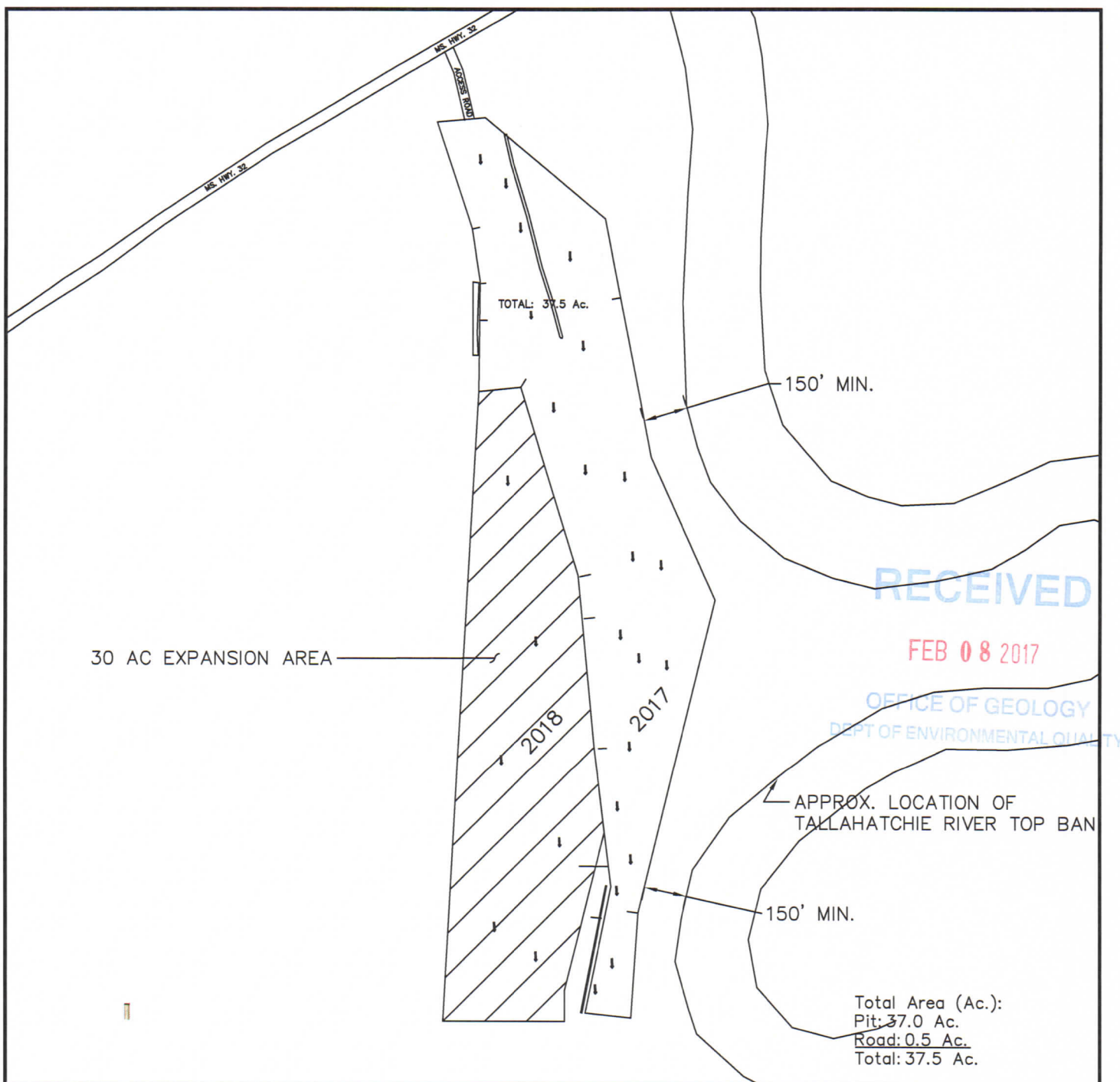

Pit expansion to be reclaimed in
2018

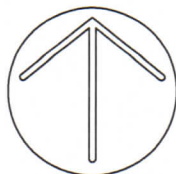

SCALE: 1" = 600'

Catfish Mine Expansion Annual Reclamation Plan

for
Joe McGee Construction Co., Inc.
P.O. Box 340
Lake, MS 39092

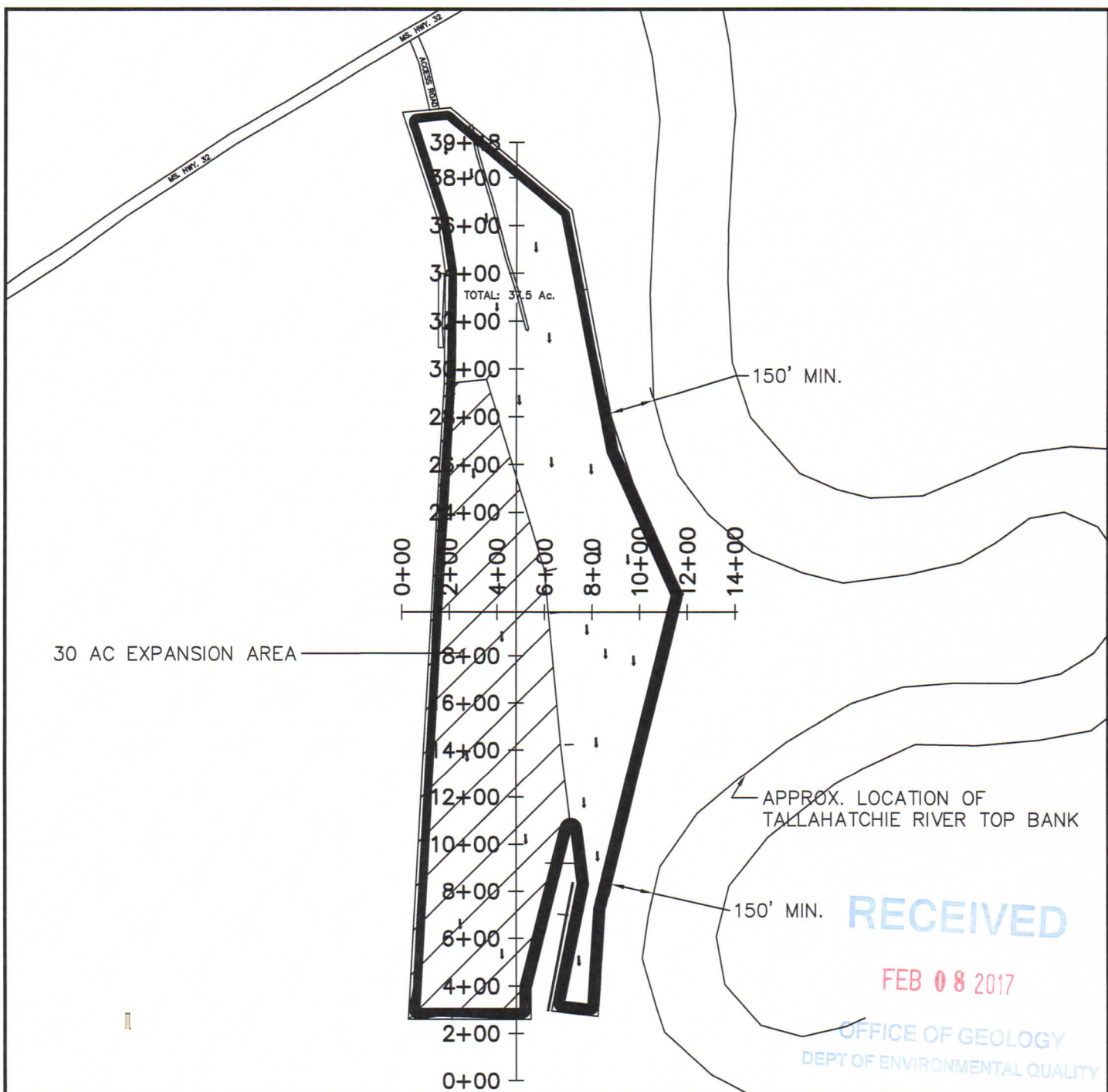

Catfish Mine Expansion is located in part of the SE 1/4 of Section 6, and part of the NE 1/4 of Section 7, Township 24 North, Range 1 East, Tallahatchie County, MS. and contains 30.0 acres more or less.

Mine Entrance is located at:
33° 58' 24.7" North, 90° 13' 48.8" West

Catfish Mine is located within the
Tippo Quadrangle.

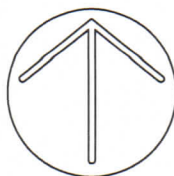

SCALE: 1" = 600'

Catfish Mine Expansion Excavation Cross Section Alignments

for
Joe McGee Construction Co., Inc.
P.O. Box 340
Lake, MS 39092

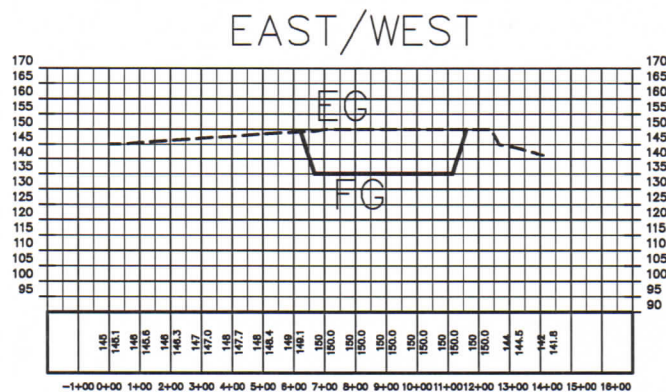
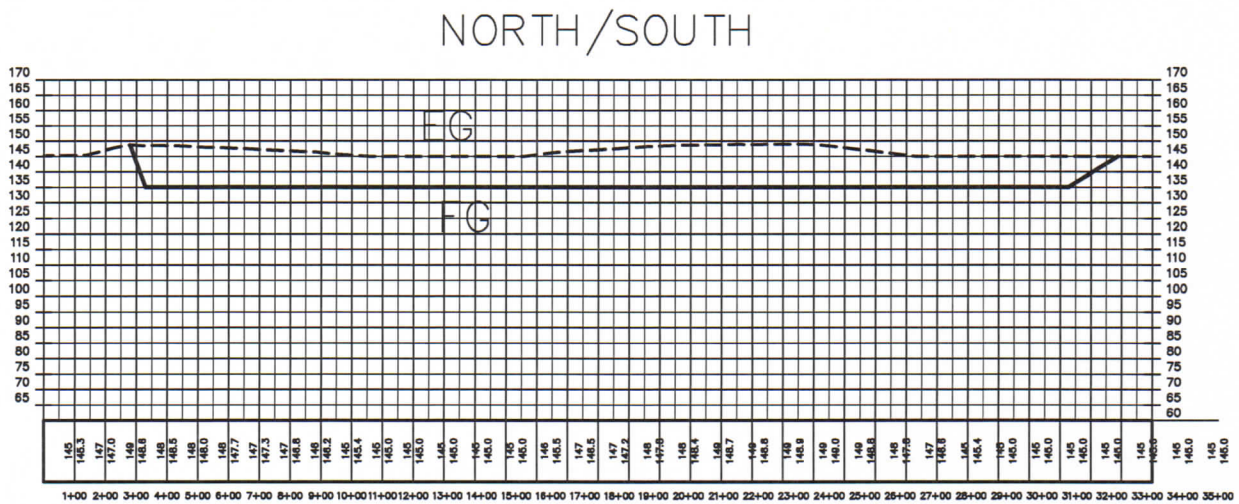

RECEIVED

FEB 08 2017

OFFICE OF GEOLOGY
DEPT OF ENVIRONMENTAL QUALITY

All slopes to be 3:1 max.

All slopes to be plated with
previously stockpiled topsoil
subsequent to excavation operation.

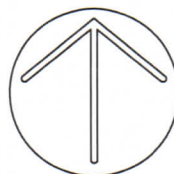

SCALE:
1" = 300' Hor.
1" = 30' Vert.

Catfish Mine
Expansion
CROSS SECTIONS

for
Joe McGee Construction Co., Inc.
P.O. Box 340
Lake, MS 39092

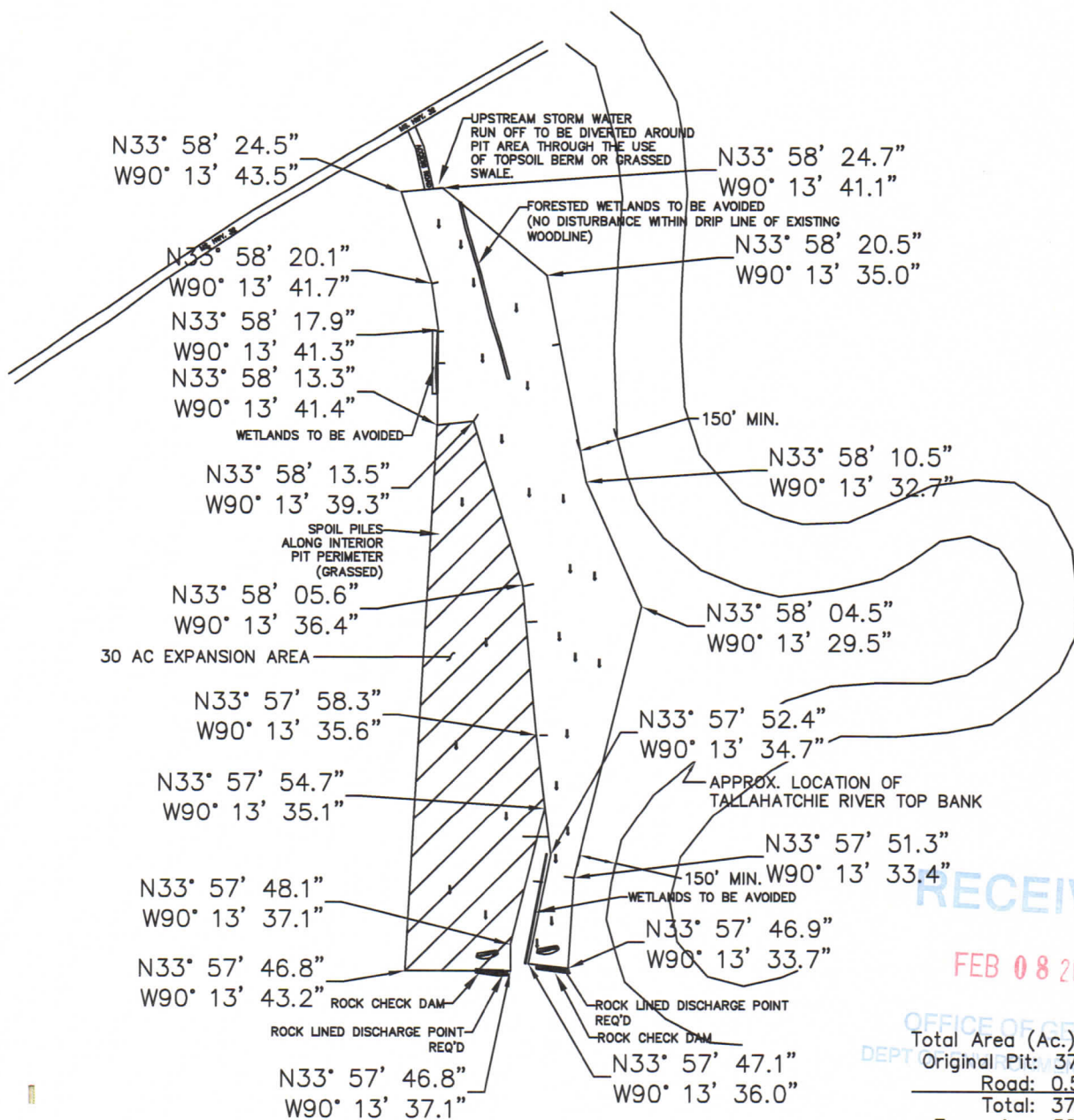

RECEIVED

FEB 08 2017

OFFICE OF GEOLOGY
DEPT. OF NATURAL RESOURCES

Total Area (Ac.):
Original Pit: 37.0 Ac.
Road: 0.5 Ac.
Total: 37.5 Ac.
Expansion: 30.0 Ac.
New Total: 67.5 Ac.

Subsequent to clearing and grubbing, topsoil to be stripped and stockpiled along the entire perimeter of pit area. Upstream storm water runoff to be diverted around pit area through use of topsoil berm. Storm water runoff within pit area and access road to be collected in settlement pond/sump to allow for evaporation or absorption into underlying strata. In the event of excessive rainfall, settlement pond to discharge through rock lined discharge point.



SCALE: 1" = 800'

Catfish Mine Expansion Pit Layout

for
Joe McGee Construction Co., Inc.
P.O. Box 340
Lake, MS 39092

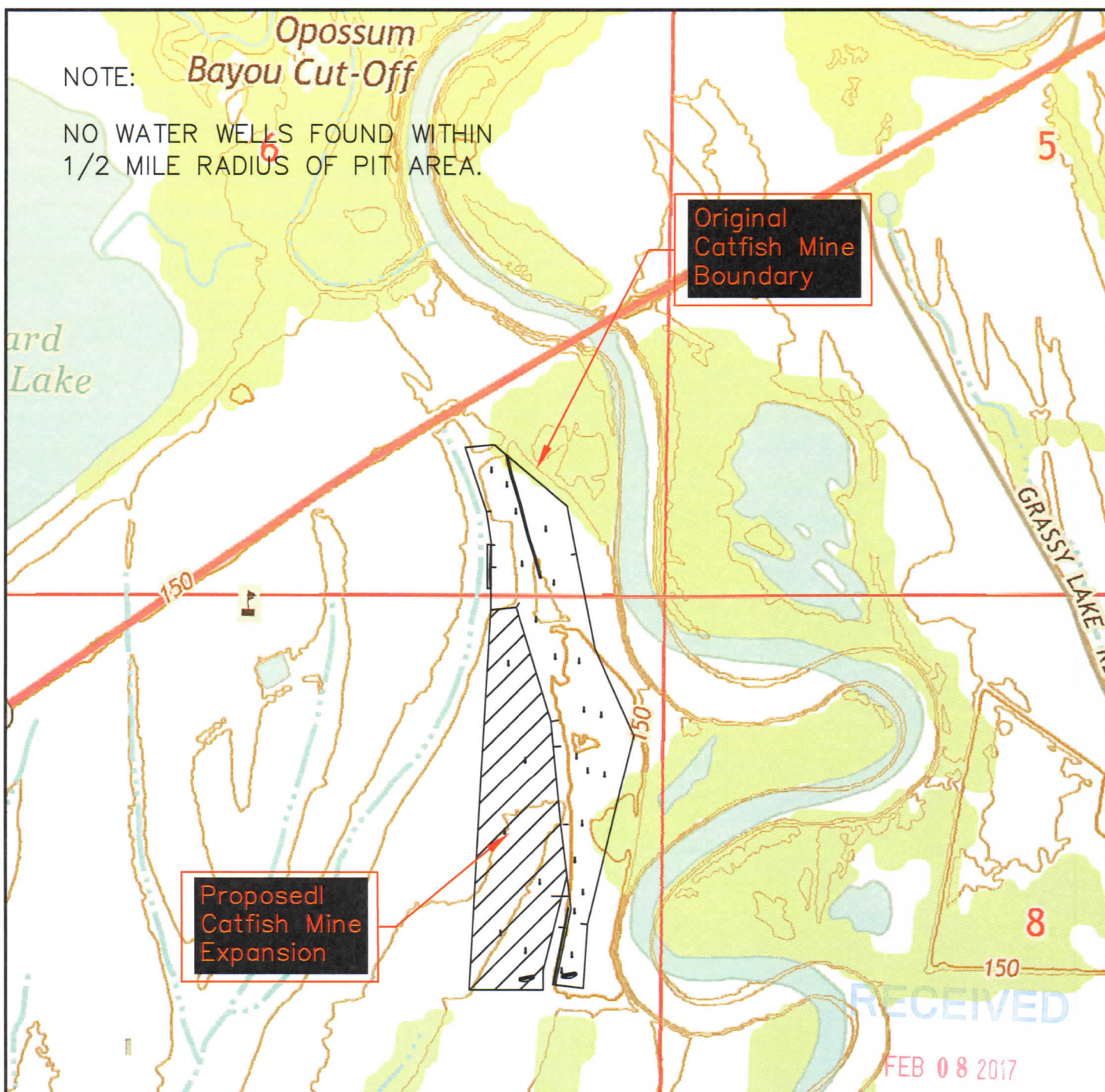

Catfish Mine Expansion is located in part of the SE 1/4 of Section 6, and part of the NE 1/4 of Section 7, Township 24 North, Range 1 East, Tallahatchie County, MS. and contains 30.0 acres more or less.

Mine Entrance is located at:
33° 58' 24.7" North, 90° 13' 48.8" West

Catfish Mine is located within the
Tippo Quadrangle.

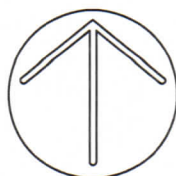

SCALE: 1" = 1000'

Catfish Mine Expansion Topographic Mapping

for
Joe McGee Construction Co., Inc.
P.O. Box 340
Lake, MS 39092

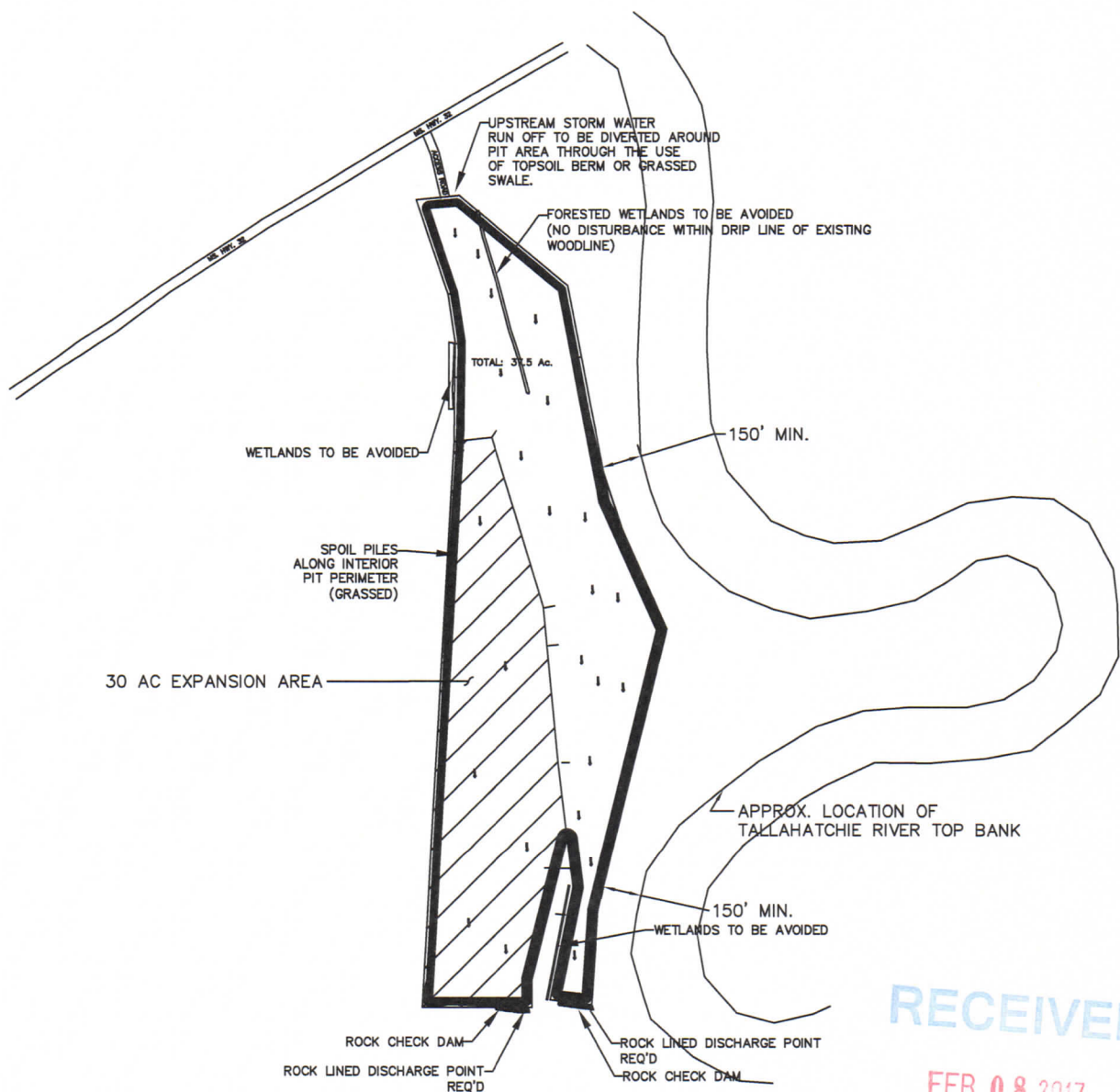

RECEIVED

FEB 08 2017

OFFICE OF GEOLOGY
DEPT OF ENVIRONMENTAL QUALITY

All disturbed areas to be graded to a maximum 3:1 slope and revegetated in accordance with mining permit reclamation plan.

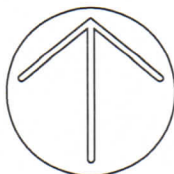

SCALE: 1" = 800'

Catfish Mine Expansion Reclamation Diagram

for
Joe McGee Construction Co., Inc.
P.O. Box 340
Lake, MS 39092