

Permit No. _____

STATE OF MISSISSIPPI

Application No. _____

A1999**SURFACE MINING PERMIT APPLICATION****AI#72958**MISSISSIPPI DEPARTMENT OF ENVIRONMENTAL QUALITY
OFFICE OF GEOLOGY / MINING & RECLAMATION DIVISION

P. O. Box 2279

Jackson, Mississippi 39225-2279

(601) 961-5515

Fax (601) 961-5521

For Office use only

Other permits required: Y/N Date
NPDES _____
State Operating Permit _____
Corps of Engineers _____City/County approval
Required Yes _____ No _____
Received Date: _____
County _____
City _____**A. GENERAL INFORMATION****RECEIVED****DEC 5 2017**OFFICE OF GEOLOGY
DEPT OF ENVIRONMENTAL QUALITY

1. Name of Applicant: WC Fore LLC
Mailing Address: Post Office Box 3058, Gulfport, MS 39505
E-mail Address: wcforetrucking@gmail.com
Phone No. 228-863-1314 Fax No. 228-864-0013
Authorized Representative Ross D. Williams
2. Engineering Firm, Consultant, etc.: Soiltech Consultants, Inc.
Mailing Address: 101 Business Park Drive, Suite A, Ridgeland, MS 39157
E-mail Address: rwilliams@soiltech consultants.com
Phone No. 601-952-2995 Fax No. 601-952-2944
3. Name of Mine: Redmond Road Mine Supervisor: WC Fore
Phone No. 228-863-1314 Fax No. 228-864-0013
4. Location of Operation (to nearest quarter-quarter section):
SE/4 of the NW/4 and the NE/4 of the SW/4 33 4N⁵ 11W Harrison
east of Redond Road Section Township Range County
5. Physical address of mine or nearest named road Redmond Road
6. Method of Operation ☒ Open Pit ☐ Strip ☐ Dredge ☐ Wash Operation, if so Water Source NA
Wash System Type ☐ Closed system ☐ Open system
7. Number of Acres to be Permitted:
Excavation 69
Haul roads, plant site, ponds, storage piles, etc. 1
TOTAL PERMITTED AREA 70
8. Is the Permit Area located: Yes No
a. within 100 feet of a public road? _____ X
b. within 100 feet of a cemetery? _____ X
c. within 300 feet of an occupied building? _____ X
If YES to a, b, or c, a letter must be filed with the Office giving permission from the owner or maintaining authority to mine within these distances to the subject property.
9. Materials to be Mined: Clayey sand

10. Has the applicant applied for, or have, any other permits or licenses that pertain to this or any other mining operation? Yes ☒ No ☐

If "YES," list them in the space provided on page 5, or attach separate pages, and give the current status of each, including any violations or penalties.

B. MINING PROCEDURE AND ENVIRONMENTAL ANALYSIS

1. Description of materials:
Thickness of overburden 1 ft.
(Topsoil **MUST** be stockpiled for use during reclamation)
Thickness of useable material 50 ft.
Total depth of excavation 35 ft.
Estimated annual production 75,000 tons
2. Anticipated Schedule (month/year)
Begin clearing 3 / 2018
Begin mining 4 / 2018
Complete mining 4 / 2023
Begin reclamation 4 / 2019
Complete reclamation 4 / 2025
3. Depth to ground water: 10-60 ft ft.
4. How will dust be controlled?
☒ Water on haul roads
☐ _____
5. Types of erosion control structures that will be utilized.
☒ Settling ponds ☒ Drainage ditches
☒ Diversion berms ☐ Terraced slopes
☐ _____
6. Describe the land to be affected by mining as it presently exists:
a. Land use Forest
b. Predominant vegetation Pine and privet
7. Will explosives be used? ☐ Yes ☒ No
8. Is test-boring data available? ☐ Yes ☒ No
9. Are toxic materials likely to be encountered at any time? ☐ Yes ☒ No
10. Will there be any discharge to local streams or other bodies of water? ☒ Yes ☐ No

If any of questions 7-10 are answered "YES," provide additional information on page 5, or attach separate pages.

C. RECLAMATION PLAN

NOTE: It is suggested that the county NRCS office be consulted for specific recommendations on the following items.

1. Describe the soil handling technique for the reclamation phase of the operation:
☒ Topsoil segregated ☐ Mixed strata ☐ _____
2. Describe the protection method for the stockpiled topsoil.
☒ berm around the storage pile
☒ grass cover on the pile (recommended)
☐ stored under a cover
☐ _____
3. How will highwalls, standing faces, and banks be reduced to minimize erosion? (All highwalls must be sloped, minimum 3 horizontal to 1 vertical.)
☐ slopes will be terraced
☒ sloped to a gradient of 3 to 1
☐ blended with surrounding contours
☐ _____

RECEIVED

DEC 5 2017

4. What is the general plan for reclamation?

- ☒ reforestation
☐ establish grass cover
☒ pond or lake
☐ _____

5. What planting method will be used?

- ☒ broadcast seed ☐ mechanical seeding
☒ seeding by manual labor
☐ _____

6. How will fertilizer and lime be applied and incorporated?

- ☐ harrowing ☒ broadcasting ☐ disking

7. Quantity of lime and fertilizer to be applied?

a. For initial planting

lime: 3 tons per acre

fertilizer: 13 - 13 - 13 (type) 400 pounds per acre

b. For successive years prior to 100% release

fertilizer: 13 - 13 - 13 (type) 150 pounds per acre

when: April-May (month)

RECEIVED
DEC 5 2017
OFFICE OF GEOLOGY
DEPT OF ENVIRONMENTAL QUALITY

8. Describe the planting schedule:

Tree or Seed Species	Tree spacing or lbs./acre	Planting Season
<u>Pine</u>	<u>250</u>	<u>November-March</u>
_____	_____	_____
_____	_____	_____
_____	_____	_____

9. Will the area be mulched? Yes ☒ No ☐ If yes, rate per acre NA

Method of holding in place: ☐ crimped ☐ Not applicable

10. How will the vegetation be maintained until the final bond release?

☐ watering

☐ mowing

times per year _____

approximate month(s) _____, _____, _____

☒ repairing gullies

☒ replanting eroded areas

☐ _____

11. How will debris be disposed of when the mine is finally closed?

- ☐ burying ☐ burning ☒ hauling away

12. Will a soil analysis be submitted for this site? Yes ☐ No ☒

NOTE: available from the Cooperative Extension Service through the applicant's County Agent

13. Estimated cost per acre for reclamation of this site: \$1,000.00 (minimum of \$1,000 per acre)

D. NAMES AND ADDRESSES OF PERSONS AFFECTED BY THIS OPERATION

1. Landowner(s) of area to be mined/leased

Name: WC Fore Trucking, Inc.
Address: 14270 Creosote Road
Gulfport, MS
Phone: 228-863-1314

Name: Not applicable
Address: _____
Phone: _____

2. Landowner(s) within 500 feet of the area

Name: Wanda Earlene R Crosby
Address: 14138 M Redmond Road
Saucier, MS 39574
Phone: Not readily availabel

Name: Joel Lamar Mallette
Address: 25459 Redmond Road
Saucier, MS 39574
Phone: Not readily available

Name: Luke and Kimberly Pyron
Address: 25625 Redmond Road
Saucier, MS 39574
Phone: Not readily available

Name: Eddie and Lora R. Delaney
Address: 21592 Redmond Road
Saucier, MS 39574
Phone: Not readily available

3. Person(s) living on permit area

Name: Not applicable
Address: _____
Phone: _____

Name: Not applicable
Address: _____
Phone: _____

RECEIVED
DEC 5 2017
OFFICE OF GEOLOGY
DEPT OF ENVIRONMENTAL QUALITY

I declare that I have knowledge of the facts presented in the preceding pages and in all of the items attached to this application; furthermore, I certify that they are true to the best of my knowledge.

11-20-17
date

WC Fore
signature

W. C. Fore

printed name

President/ Owner

But
title

Item
Number

Stormwater Coverage will be applied for through the MDEQ-Office of Pollution Control

OFFICE OF GEOLOGY
DEPT OF ENVIRONMENTAL QUALITY

5

Additional Landowners

William R Blackledge
c/o Robert Blackledge
934 Castle Kirk Road
Baton Rouge, LA

United States Government

David & Elizabeth A., Loree
25115 Redmond Road
Saucier, MS 39574

Joseph R. Vogle
15496 Broadus Road
Saucier, MS 39574

John W. Hatch, Jr.
15546 Broadus Road
Saucier, MS 39574

RECEIVED
DEC 5 2017
OFFICE OF GEOLOGY
DEPT OF ENVIRONMENTAL QUALITY

MISSISSIPPI

HARRISON COUNTY
MISSISSIPPI

SCALE
0 1 2 3 4 5
MILES

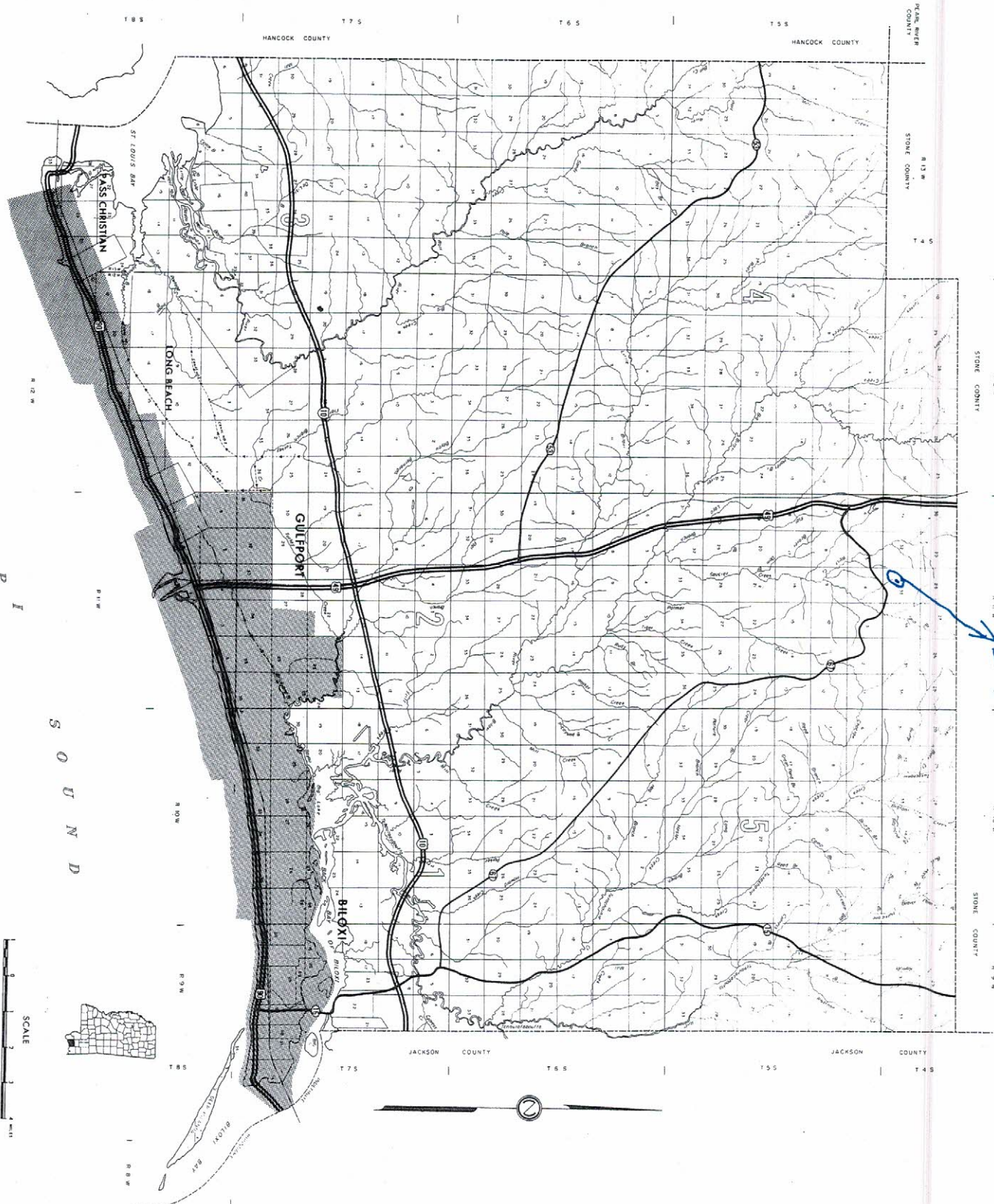

Location

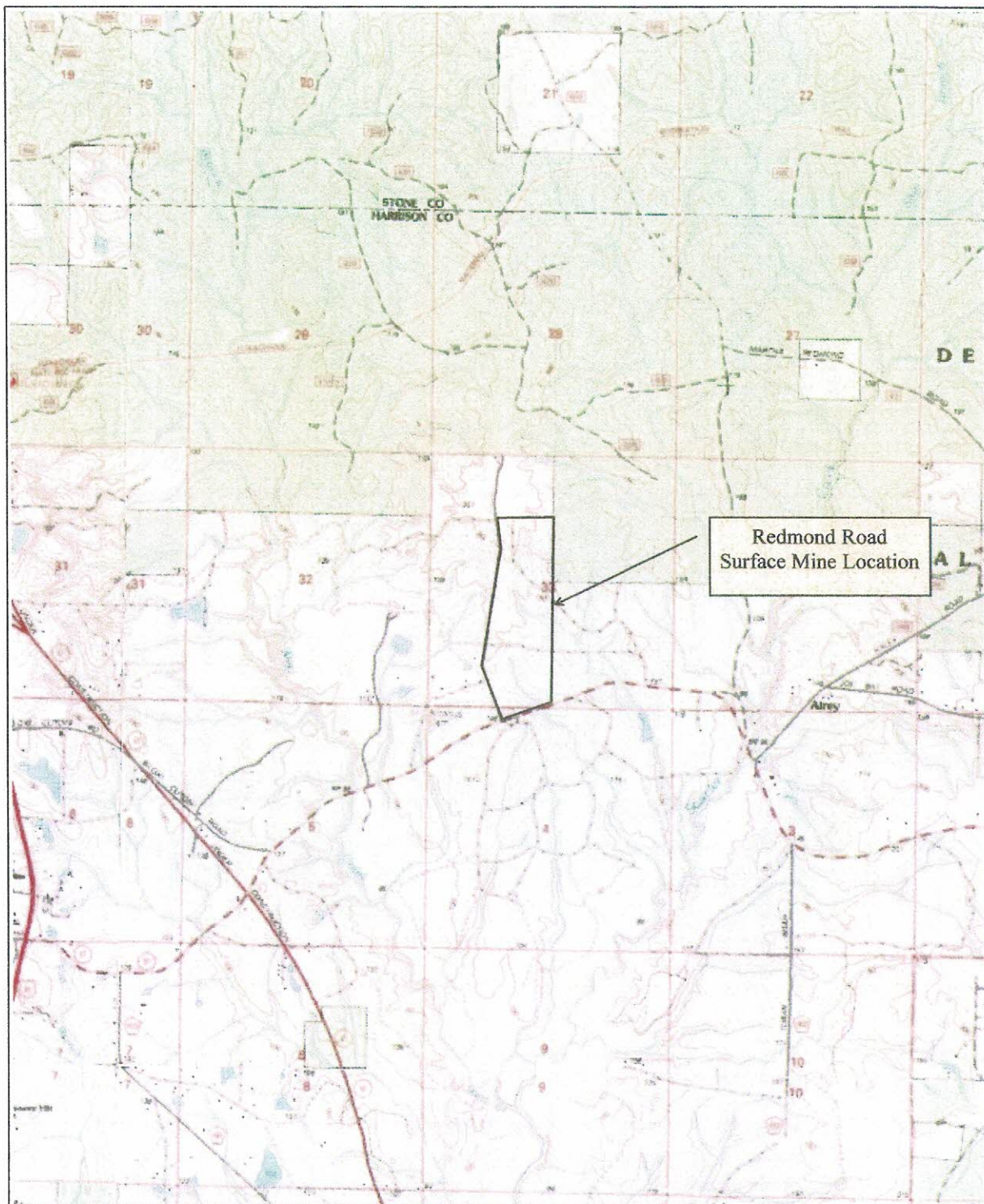

W. C. Fore Trucking Company
 Redmond Road Surface Mine
 Section 33, T4North, R11 West
 Saucier, Harrison County, Mississippi

SOILTECH CONSULTANTS
 Geotechnical Engineering

Figure 1
 Site Location Map
 Airey USGS Topographic
 Quadrangle, 2000

Created By:	RDW	11/10/17	SCALE
Checked By:	LR	11/15/17	1" ~ 3340'



RECEIVED

DEC 5 2017

OFFICE OF GEOLOGY
 DEPT OF ENVIRONMENTAL QUALITY

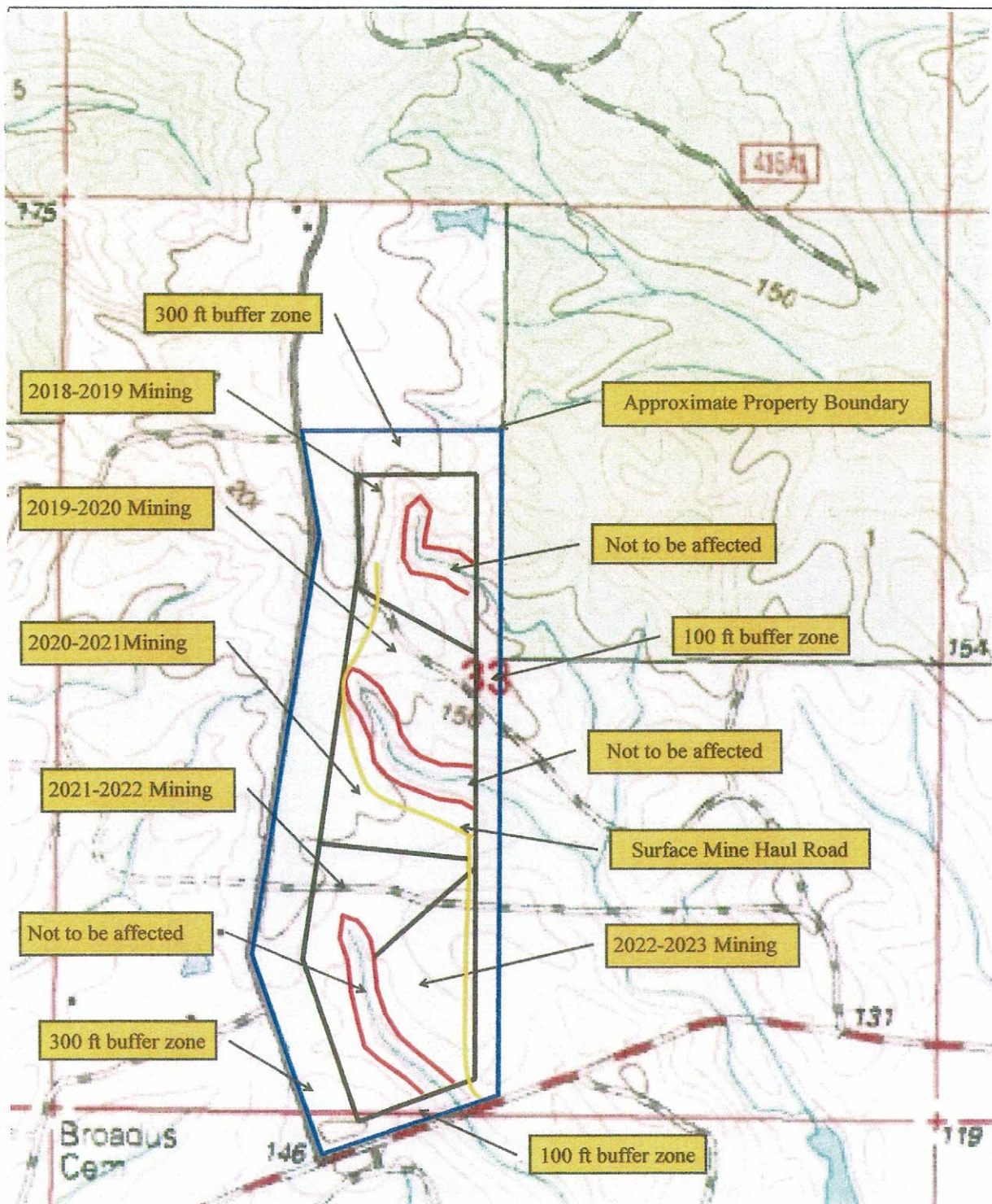

W. C. Fore Trucking Company
Redmond Road Surface Mine
Section 33, T4North, R11 West
Saucier, Harrison County, Mississippi

SOILTECH CONSULTANTS
Geotechnical Engineering

Figure 2
Mining Schedule Plan
Airey USGS Topographic
Quadrangle, 2000

Created By:	RDW	11/10/17	SCALE
Checked By:	LR	11/15/17	1" = 920'





RECEIVED

DEC 5 2017

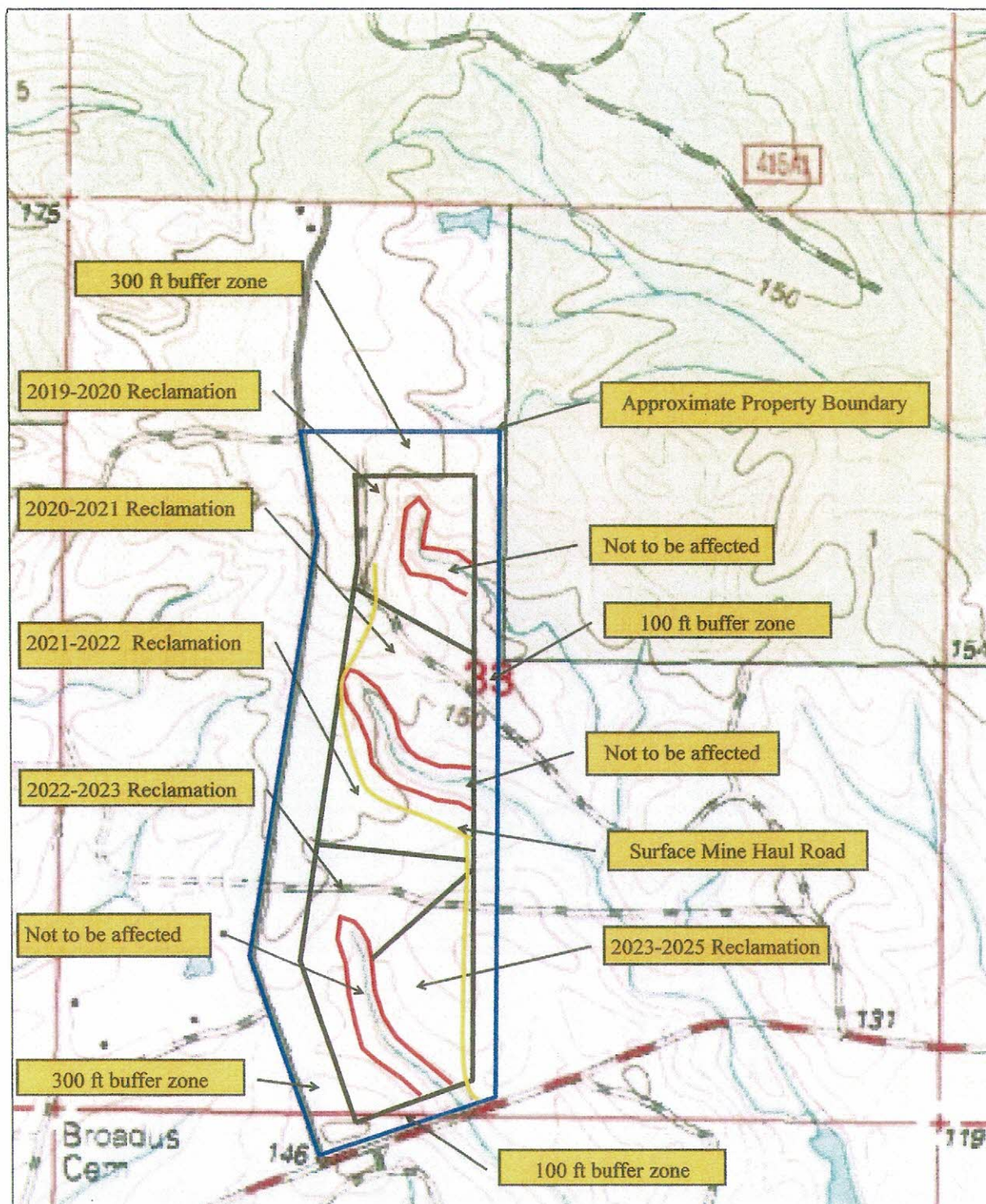
OFFICE OF GEOLOGY
DEPT OF ENVIRONMENTAL QUALITY



W. C. Fore Trucking Company Redmond Road Surface Mine Section 33, T4North , R11 West Saucier, Harrison County, Mississippi	 SOILTECH CONSULTANTS Geotechnical Engineering			Figure 3 Mining Reclamation Plan Airey USGS Topographic Quadrangle, 2000	
	Created By: RDW Checked By: LR	11/10/17 11/15/17	SCALE 1" = 920'		

RECEIVED

DEC 5 2017

OFFICE OF GEOLOGY
DEPT OF ENVIRONMENTAL QUALITY

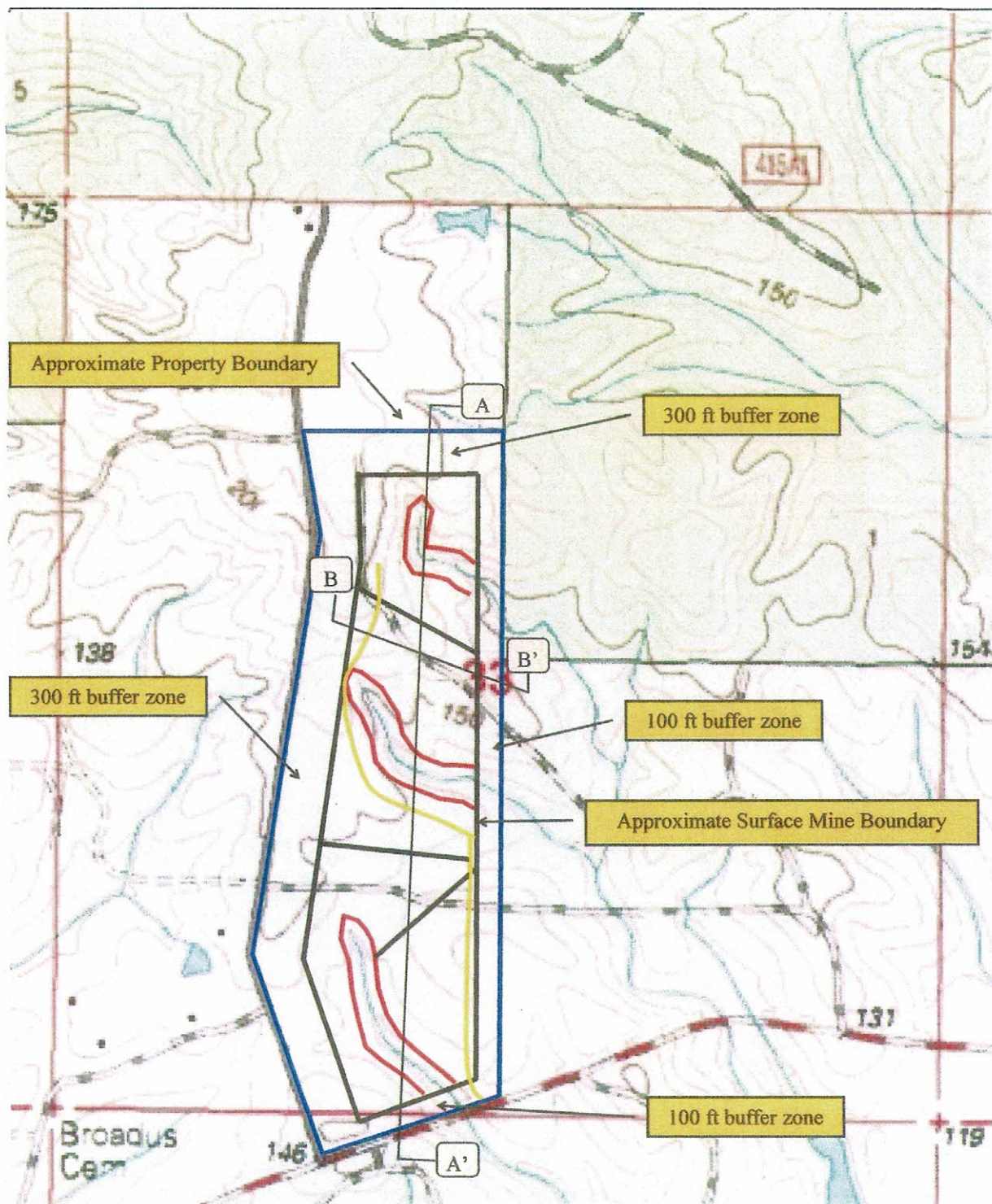

W. C. Fore Trucking Company
 Redmond Road Surface Mine
 Section 33, T4North, R11 West
 Saucier, Harrison County, Mississippi



Figure 4
 Mining Cross-Section
 Transect
 Airey USGS Topographic
 Quadrangle, 2000

Created By:	RDW	11/10/17	SCALE
Checked By:	LR	11/15/17	1" = 920'



RECEIVED

DEC 5 2017

OFFICE OF GEOLOGY
 DEPT OF ENVIRONMENTAL QUALITY

Redmond Road Surface Mine Cross Section B-B'

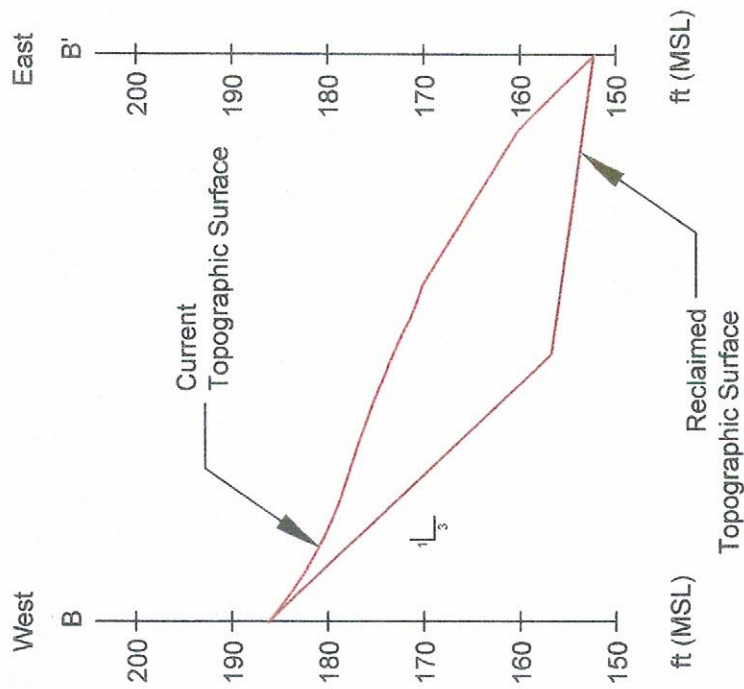

RECEIVED
 DEC 5 2017
 OFFICE OF GEOLOGY
 DEPT OF ENVIRONMENTAL QUALITY

REDMOND ROAD SURFACE MINE
 PERMIT APPLICATION
 HARRISON COUNTY, MISSISSIPPI

Project No.: ST.02514.000.001

SOILTECH CONSULTANTS, INC.
 GEOTECHNICAL ENGINEERING

Drawn By:	R.K.S.	Date:	11-09-17
Checked By:	R.D.W.	Scale:	1"=460'

CROSS SECTION B-B'

FIGURE 6

Redmond Road Surface Mine Cross Section A-A'

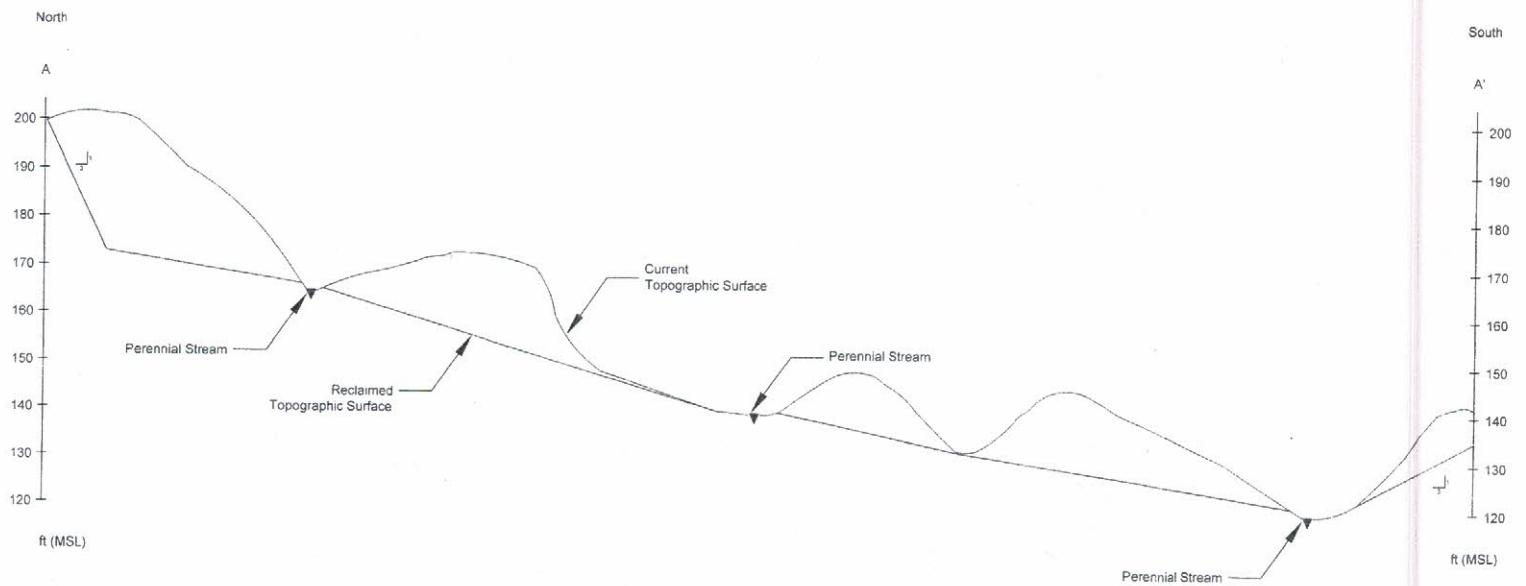

RECEIVED

DEC 5 2017

OFFICE OF GEOLOGY
DEPT OF ENVIRONMENTAL QUALITY

REDMOND ROAD SURFACE MINE
PERMIT APPLICATION
HARRISON COUNTY, MISSISSIPPI
Project No. ST 2014-202-001

SOILTECH CONSULTANTS, INC.
PROFESSIONAL ENGINEERING

CROSS SECTION A-A'

Drawn By	R.K.S.	Date	11-09-17
Checked By	R.D.W.	Scale	1"=460'

FIGURE 5