

AI #68647

MISSISSIPPI

APR 27 2018

MDEQ



RE-COVERAGE FORM

MINING STORM WATER, DEWATERING AND NO DISCHARGE GENERAL PERMIT

GENERAL PERMIT: MSR32 2 5 0 5. This coverage number must be completed for the referenced mining activity or this form will be considered incomplete and will be returned. The coverage number can be found at the bottom left corner of your previous Certificate of Coverage.

The submittal of this form is required to receive coverage under the reissued Mining Storm Water, Dewatering and No Discharge General Permit. This form must be completed and returned to MDEQ at the address printed at the bottom of this form within 30 days of the date of the Letter of Instruction for Re-Coverage.

Please indicate the activities to be covered by this Re-Coverage Form (check all that apply).

- Storm Water Discharges Associated with Mining
- Mine Dewatering
- Wastewater Recirculation System with No Discharge

The appropriate section of this form must be completed if the applicant proposes to operate a wastewater recirculation system with no discharge and/or discharge impounded mine water (dewatering).

If the company seeking coverage is a corporation, a limited liability company, a partnership, or a business trust, attach proof of its registration with the Mississippi Secretary of State and/or its Certificate of Good Standing. This registration or Certificate of Good Standing must be dated within twelve (12) months of the date of the submittal of this coverage form. Coverage will be issued in the company name as it is registered with the Mississippi Secretary of State.

ALL INFORMATION MUST BE COMPLETED (indicate "N/A" where not applicable)

APPLICANT INFORMATION

APPLICANT IS THE OWNER OPERATOR (Must check one or both)

OPERATOR CONTACT PERSON: Brian Moore

OPERATOR COMPANY NAME: APAC-Mississippi, Inc.

OPERATOR STREET OR P. O. BOX: P.O. Box 24508

OPERATOR CITY: Jackson STATE: MS ZIP: 39225

OPERATOR PHONE #: (601) 376-4000 OPERATOR EMAIL: brian.moore@apac.com

OWNER CONTACT PERSON: Brad Fouche

OWNER COMPANY: _____

OWNER STREET OR P. O. BOX: 2332 County Road 15

OWNER CITY: Winona STATE: MS ZIP: 38967

OWNER PHONE #: (662) 582-3276 OWNER EMAIL: fouchebrad@hotmail.com

MINE INFORMATION

MINE SITE NAME: Benton Mine

CONTACT NAME & POSITION: Brian Moore Environmental Manager

CONTACT PHONE NUMBER: (601) 376-4000

MINE PHYSICAL SITE ADDRESS (IF NOT AVAILABLE INDICATE NEAREST NAMED ROAD):
 STREET: 393 O'Reilly Road

CITY: Benton COUNTY: Yazoo ZIP: 39039

ATTACH A USGS QUAD MAP, EXTENDING 1/2 MILE BEYOND FACILITY, OUTLINING THE MINE BOUNDARIES (Maps can be obtained from the Mississippi Office of Geology. For information call 601-961-5523).
 All of NW Quarter, all of West 1/2 of NE Quarter, part of West 1/2 of SE 1/4 of NE 1/4, part of NW 1/4 of SE 1/4 and part of NW 1/4 of SW 1/4 of
 /4 OF /4 OF SECTION 21, TOWNSHIP 12N, RANGE 1W

LATITUDE: 32 DEGREES 52 MINUTES 23 SECONDS LONGITUDE: -90 DEGREES 17 MINUTES 57 SECONDS

LAT & LONG DATA SOURCE (GPS (PLEASE GPS ENTRANCE GATE) OR MAP INTERPOLATION): GPS Entrance Gate

TOTAL ACREAGE: 358 MATERIAL TO BE MINED: Sand and Gravel

ESTIMATED START DATE: YYYYY-MM-DD ESTIMATED END DATE: YYYYY-MM-DD

SIC CODE 1442 NAICS CODE 212321

STORM WATER POLLUTION PREVENTION PLAN (SWPPP)

THE GENERAL PERMIT REQUIRES THE SWPPP TO BE ONSITE OR LOCALLY AVAILABLE, UP-TO-DATE AND EFFECTIVE IN CONTROLLING STORM WATER POLLUTANTS. ACCORDINGLY, IN ADDITION TO THE PROJECT'S CURRENT BMPS, TWO (2) SPECIFIC BMPS (SEE BELOW) ARE REQUIRED TO BE IN THE SWPPP.

IS A COPY OF THE SWPPP AT THE PERMITTED SITE OR LOCALLY AVAILABLE? YES NO

DOES SWPPP CONTAIN AN UP-TO-DATE ASSESSMENT OF POTENTIAL STORM WATER POLLUTANT SOURCES AND IDENTIFY BMPS TO EFFECTIVELY CONTROL THEM? YES NO

IF A SEDIMENTATION BASIN IS A PROJECT BMP, DOES IT DISCHARGE ONLY FROM THE SURFACE OF THE BASIN? IF NO, THE BASIN MUST HAVE A SURFACE DISCHARGE IMMEDIATELY FROM THE DATE OF RECOVERAGE. YES or N.A. NO

IF TRUCK TRAFFIC LEAVES MINING SITE AND MOVES DIRECTLY ONTO PAVED PUBLIC ROAD, IS A CONSTRUCTION EXIT AN INSTALLED BMP? IF NO, A CONSTRUCTION EXIT MUST BE INSTALLED IMMEDIATELY OF THE DATE OF RECOVERAGE. IF A MINE IS CURRENTLY INACTIVE, BUT IS SUBMITTING A RECOVERAGE FORM, THE CONSTRUCTION EXIT MUST BE INSTALLED IMMEDIATELY OF THE MINE BECOMING ACTIVE. YES or N.A. NO

IS A WASTEWATER RECIRCULATION SYSTEM WITH NO DISCHARGE USED ON THE FACILITY? YES NO

IS MINE DEWATERING PRESENT ON SITE? YES NO

IF CHECKED YES TO WASTERWATER RECIRCULATION SYSTEM WITH NO DISCHARGE, FILL OUT BELOW

IS MINE COVERED UNDER VALID "NO DISCHARGE" STATE OPERATING PERMIT? YES NO

PERMIT NO. MS

DISTANCE BETWEEN RECIRCULATION POND(S) AND PROPERTY LINE: >150 (FT)
 (MUST BE AT LEAST 150 FEET)

NUMBER OF RECIRCULATION POND(S): 3

STORAGE CAPACITY OF EACH RECIRCULATION POND: Unknown (FT³)

IF CHECKED YES TO MINE DEWATERING, FILL OUT BELOW

IS MINE COVERED UNDER VALID NPDES DISCHARGE PERMIT FOR MINE DEWATERING?

YES

NO

PERMIT NO. MS _____

ESTIMATED DEWATERING VOLUME: only as needed (GAL/DAY)

NAME AND ADDRESS OF THE RECIPIENT OF THE DISCHARGE MONITORING REPORTS (DMRs), IF DIFFERENT FROM SIGNATORY:

Brian Moore

I certify under penalty of law that this document and all attachments were prepared under my direction or supervision in accordance with a system designed to assure that qualified personnel properly gathered and evaluated the information submitted. Based on my inquiry of the person or persons who manage the system, or those persons directly responsible for gathering the information, the information submitted is, to the best of my knowledge and belief, true, accurate and complete. I am aware that there are significant penalties for submitting false information, including the possibility of fine and imprisonment for knowing violations.

Brian Moore

Authorized Signature¹

4/25/18

Date

Brian Moore

Printed Name

Environmental Manager

Title

¹This application shall be signed according to the General Permit, Act 15, T-4 as follows:

- For a corporation, by a responsible corporate officer.
- For a partnership, by a general partner.
- For a sole proprietorship, by the proprietor.
- For a municipal, state or other public facility, by either a principal executive officer, the mayor, or ranking elected official.
- Duly Authorized Representative

Please submit this form to:

Chief, Environmental Permits Division
MDEQ, Office of Pollution Control
P.O. Box 2261
Jackson, Mississippi 39225

APAC -Mississippi Benton Pit
Yazoo County, MS

Section 21, Township 12 North, Range 1 West

Existing Permit Boundary (P15-020) @ 290 Acres plus Additional Amended Acres @ 68 Acres for a Total of 358 Acres

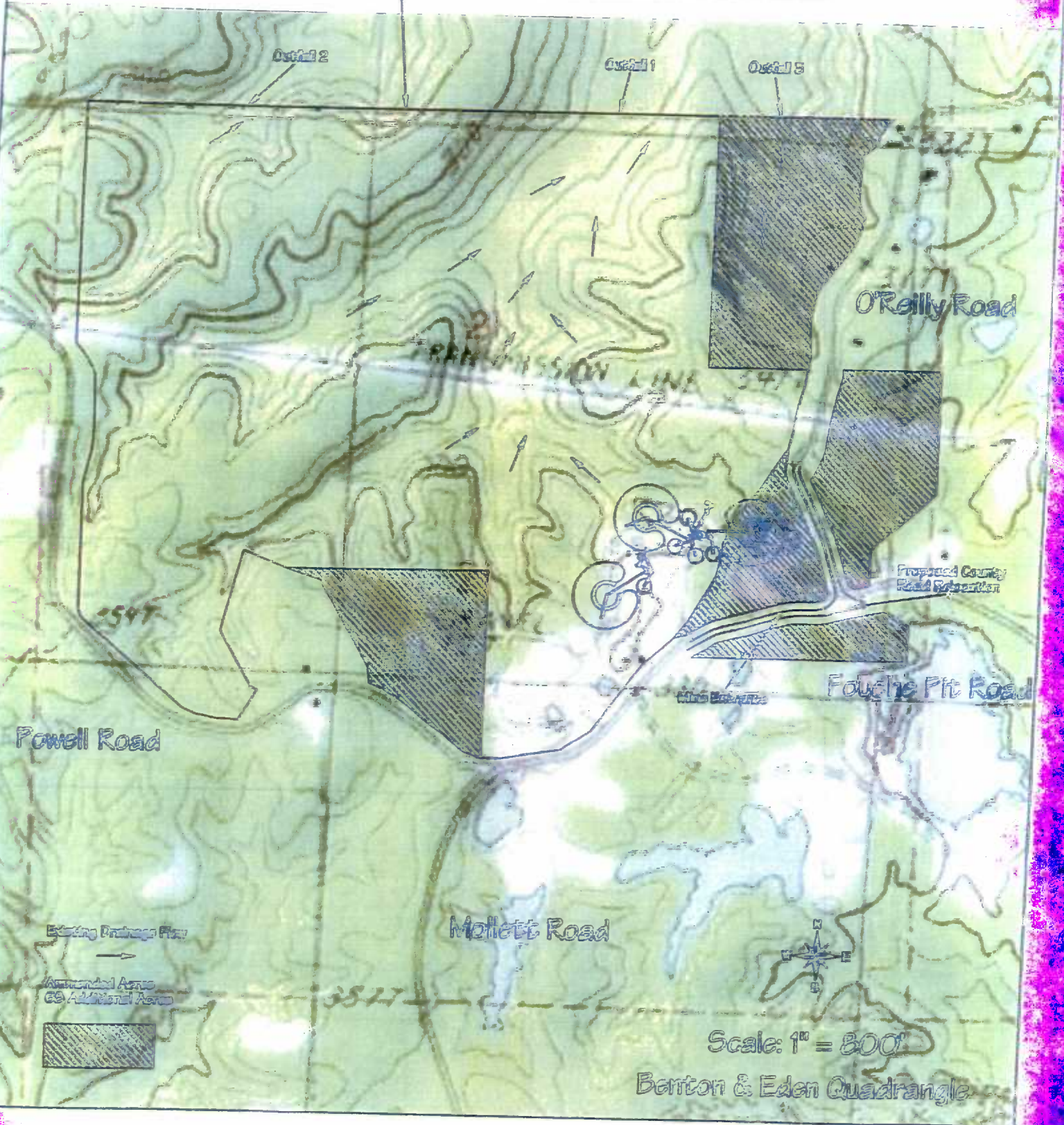

APAC - Mississippi Benton Pit
Yazoo County, MS
Section 21, Township 12 North, Range 1 West

Existing Permit Boundary (P15-020) @ 298 Acres plus Additional
Amended Acres @ 60 Acres for a Total of 358 Acres

