

AI #4005

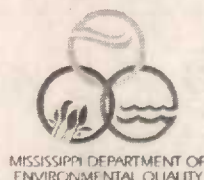

RECEIVED

MAY 01 2013

Dept. of Environmental Quality

RE-COVERAGE FORM

MINING STORM WATER, DEWATERING AND NO DISCHARGE GENERAL PERMIT

GENERAL PERMIT: MSR32 0684. This coverage number must be completed for the referenced mining activity or this form will be considered incomplete and will be returned. The coverage number can be found at the bottom left corner of your previous Certificate of Coverage.

The submittal of this form is required to receive coverage under the reissued Mining Storm Water, Dewatering and No Discharge General Permit. This form must be completed and returned to MDEQ at the address printed at the bottom of this form within 30 days of the date of the Letter of Instruction for Re-Coverage.

Please indicate the activities to be covered by this Re-Coverage Form (check all that apply).

- ☒ Storm Water Discharges Associated with Mining ☐ Mine Dewatering
- ☐ Wastewater Recirculation System with No Discharge

The appropriate section of this form must be completed if the applicant proposes to operate a wastewater recirculation system with no discharge and/or discharge impounded mine water (dewatering).

If the company seeking coverage is a corporation, a limited liability company, a partnership, or a business trust, attach proof of its registration with the Mississippi Secretary of State and/or its Certificate of Good Standing. This registration or Certificate of Good Standing must be dated within twelve (12) months of the date of the submittal of this coverage form. Coverage will be issued in the company name as it is registered with the Mississippi Secretary of State.

ALL INFORMATION MUST BE COMPLETED (indicate "N/A" where not applicable)

APPLICANT INFORMATION

APPLICANT IS THE	<input checked="" type="checkbox"/> OWNER	<input checked="" type="checkbox"/> OPERATOR	(Must check one or both)
OPERATOR CONTACT PERSON:	David Sanford		
OPERATOR COMPANY NAME:	Blain Sand and Gravel, LLC		
OPERATOR STREET OR P. O. BOX:	P.O. Box 1208		
OPERATOR CITY:	Maout Olive	STATE:	MS
		ZIP:	39119
OPERATOR PHONE #:	(601) 517-6748	OPERATOR EMAIL:	d.sanford@blain-co.com
OWNER CONTACT PERSON:	Same as above		
OWNER COMPANY:			
OWNER STREET OR P. O. BOX:			
OWNER CITY:		STATE:	
		ZIP:	
OWNER PHONE #:	()	OWNER EMAIL:	

IF CHECKED YES TO MINE DEWATERING, FILL OUT BELOW

IS MINE COVERED UNDER VALID NPDES DISCHARGE PERMIT FOR MINE DEWATERING?

☐ YES

☐ NO

PERMIT NO. MS _____

ESTIMATED DEWATERING VOLUME: _____ (GAL/DAY)

NAME AND ADDRESS OF THE RECIPIENT OF THE DISCHARGE MONITORING REPORTS (DMRs), IF DIFFERENT FROM SIGNATORY:

I certify under penalty of law that this document and all attachments were prepared under my direction or supervision in accordance with a system designed to assure that qualified personnel properly gathered and evaluated the information submitted. Based on my inquiry of the person or persons who manage the system, or those persons directly responsible for gathering the information, the information submitted is, to the best of my knowledge and belief, true, accurate and complete. I am aware that there are significant penalties for submitting false information, including the possibility of fine and imprisonment for knowing violations.

David Sanford
Authorized Signature¹

4-26-18
Date

David Sanford
Printed Name

Manager
Title

¹This application shall be signed according to the General Permit, Act 15, T-4 as follows:

- For a corporation, by a responsible corporate officer.
- For a partnership, by a general partner.
- For a sole proprietorship, by the proprietor.
- For a municipal, state or other public facility, by either a principal executive officer, the mayor, or ranking elected official.
- Duly Authorized Representative

Please submit this form to:

Chief, Environmental Permits Division
MDEQ, Office of Pollution Control
P.O. Box 2261
Jackson, Mississippi 39225



DELBERT HOSEMANN
Secretary of State

This is not an official certificate of good standing.

Name History

Name	Name Type
BLAIN SAND & GRAVEL, INC.	Legal

Business Information

Business Type:	Profit Corporation
Business ID:	410892
Status:	Good Standing
Effective Date:	10/06/1965
State of Incorporation:	Mississippi
Principal Office Address:	98 PEARCE ROAD, P O BOX 1208 MT OLIVE, MS 39119

Registered Agent

Name
W.W. BLAIN JR 98 PEARCE RD, PO BOX 1208 MT OLIVE, MS 39119

Officers & Directors

Name	Title
Norman G Stevens Jr 98 Pearce Rd Mt Olive, MS 39119	Incorporator
Robert Lee Stevens PO Box1208 Mt Olive, MS 39119	Director, President
Michael R Blain PO Box1208	Director, Vice President

MT. OLIVE, MS 39119

James W Brewer Jr
98 Pearce Rd
Mt Olive, MS 39119

Director, Secretary, Treasurer

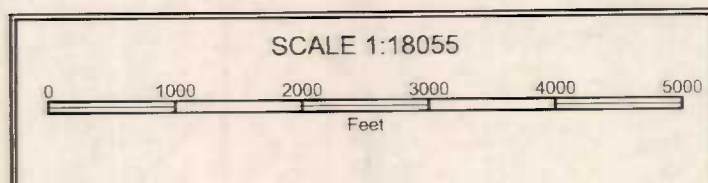
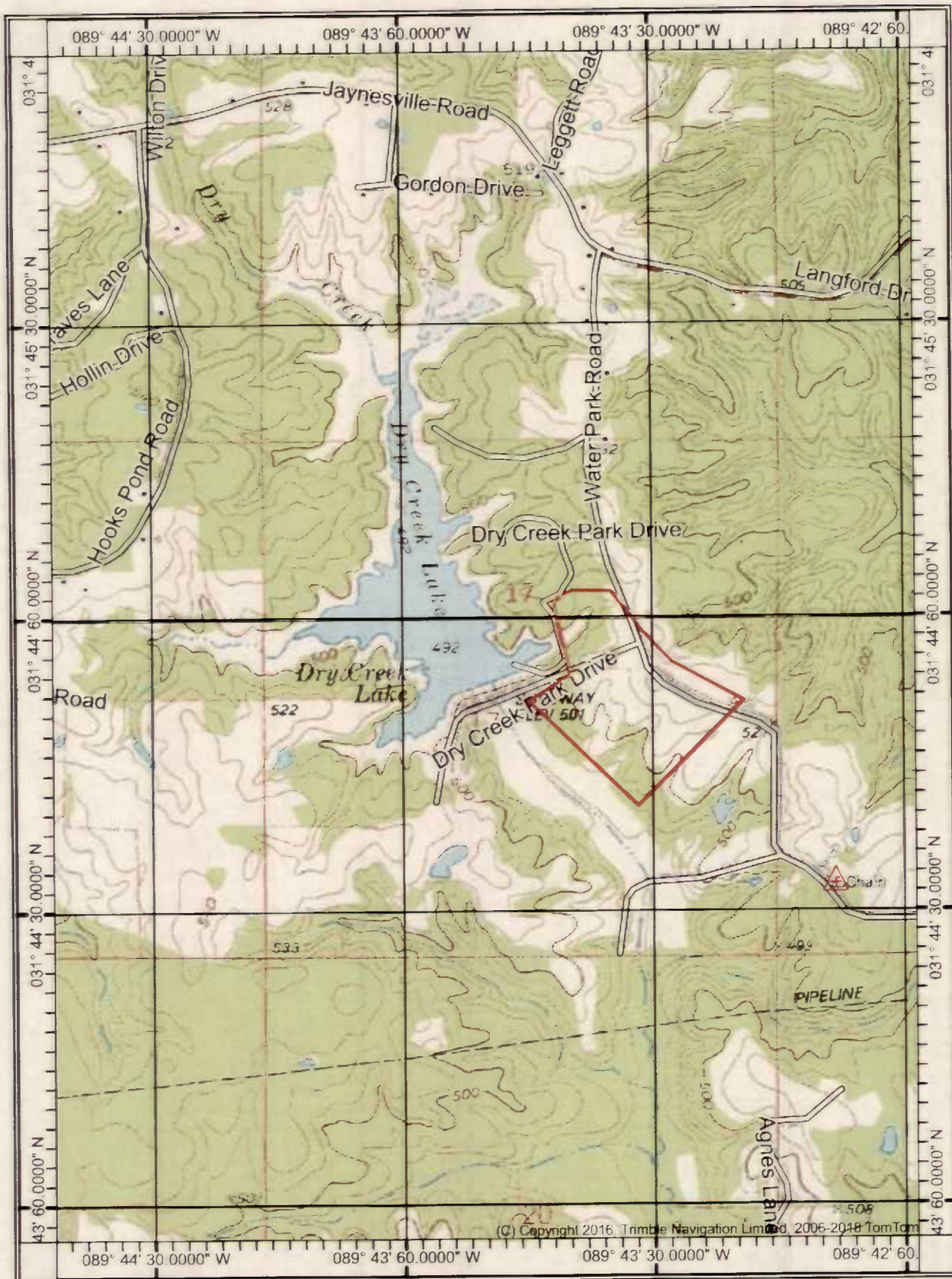

MINE INFORMATION

MINE SITE NAME: Polk Dry Creek

CONTACT NAME & POSITION: David Sanford Manager

CONTACT PHONE NUMBER: (601) 517-6748

MINE PHYSICAL SITE ADDRESS (IF NOT AVAILABLE INDICATE NEAREST NAMED ROAD):

STREET: Water Park Road

CITY: Mount Olive

COUNTY: Covington

ZIP: 39119

ATTACH A USGS QUAD MAP, EXTENDING 1/2 MILE BEYOND FACILITY, OUTLINING THE MINE BOUNDARIES (Maps can be obtained from the Mississippi Office of Geology. For information call 601-961-5523).

1/4 OF

1/4 OF SECTION

17

,

TOWNSHIP

9W

, RANGE

17W

LATITUDE: 31 DEGREES 44 MINUTES 53 SECONDS

LONGITUDE: 89 DEGREES 43 MINUTES 22 SECONDS

LAT & LONG DATA SOURCE (GPS (PLEASE GPS ENTRANCE GATE) OR MAP INTERPOLATION): GPS

TOTAL ACREAGE: 61

MATERIAL TO BE MINED: Sand and gravel

ESTIMATED START DATE: Present

YYYY-MM-DD

ESTIMATED END DATE: 12-10-20

YYYY-MM-DD

SIC CODE 1442

NAICS CODE

STORM WATER POLLUTION PREVENTION PLAN (SWPPP)

THE GENERAL PERMIT REQUIRES THE SWPPP TO BE ONSITE OR LOCALLY AVAILABLE, UP-TO-DATE AND EFFECTIVE IN CONTROLLING STORM WATER POLLUTANTS. ACCORDINGLY, IN ADDITION TO THE PROJECT'S CURRENT BMPS, TWO (2) SPECIFIC BMPS (SEE BELOW) ARE REQUIRED TO BE IN THE SWPPP.

IS A COPY OF THE SWPPP AT THE PERMITTED SITE OR LOCALLY AVAILABLE?

☒ YES

☐ NO

DOES SWPPP CONTAIN AN UP-TO-DATE ASSESSMENT OF POTENTIAL STORM WATER POLLUTANT SOURCES AND IDENTIFY BMPS TO EFFECTIVELY CONTROL THEM?

☒ YES

☐ NO

IF A SEDIMENTATION BASIN IS A PROJECT BMP, DOES IT DISCHARGE ONLY FROM THE SURFACE OF THE BASIN? IF NO, THE BASIN MUST HAVE A SURFACE DISCHARGE IMMEDIATELY FROM THE DATE OF RECOVERY.

☒ YES or N.A.

☐ NO

IF TRUCK TRAFFIC LEAVES MINING SITE AND MOVES DIRECTLY ONTO PAVED PUBLIC ROAD, IS A CONSTRUCTION EXIT AN INSTALLED BMP? IF NO, A CONSTRUCTION EXIT MUST BE INSTALLED IMMEDIATELY OF THE DATE OF RECOVERY. IF A MINE IS CURRENTLY INACTIVE, BUT IS SUBMITTING A RECOVERY FORM, THE CONSTRUCTION EXIT MUST BE INSTALLED IMMEDIATELY OF THE MINE BECOMING ACTIVE.

☒ YES or N.A.

☐ NO

IS A WASTEWATER RECIRCULATION SYSTEM WITH NO DISCHARGE USED ON THE FACILITY?

☐ YES

☒ NO

IS MINE DEWATERING PRESENT ON SITE?

☐ YES

☒ NO

IF CHECKED YES TO WASTEWATER RECIRCULATION SYSTEM WITH NO DISCHARGE, FILL OUT BELOW

IS MINE COVERED UNDER VALID "NO DISCHARGE" STATE OPERATING PERMIT?

☐ YES

☐ NO

PERMIT NO. MS

DISTANCE BETWEEN RECIRCULATION POND(S) AND PROPERTY LINE: _____ (FT)
(MUST BE AT LEAST 150 FEET)

NUMBER OF RECIRCULATION POND(S): _____

STORAGE CAPACITY OF EACH RECIRCULATION POND: _____ (FT³)