

AI # 69398



RECEIVED
MAY - 3 2018
Dept. of Environmental Quality

RE-COVERAGE FORM

MINING STORM WATER, DEWATERING AND NO DISCHARGE GENERAL PERMIT

GENERAL PERMIT: MSR32 2527. This coverage number must be completed for the referenced mining activity or this form will be considered incomplete and will be returned. The coverage number can be found at the bottom left corner of your previous Certificate of Coverage.

The submittal of this form is required to receive coverage under the reissued Mining Storm Water, Dewatering and No Discharge General Permit. This form must be completed and returned to MDEQ at the address printed at the bottom of this form within 30 days of the date of the Letter of Instruction for Re-Coverage.

Please indicate the activities to be covered by this Re-Coverage Form (check all that apply).

- Storm Water Discharges Associated with Mining
- Mine Dewatering
- Wastewater Recirculation System with No Discharge

The appropriate section of this form must be completed if the applicant proposes to operate a wastewater recirculation system with no discharge and/or discharge impounded mine water (dewatering).

If the company seeking coverage is a corporation, a limited liability company, a partnership, or a business trust, attach proof of its registration with the Mississippi Secretary of State and/or its Certificate of Good Standing. This registration or Certificate of Good Standing must be dated within twelve (12) months of the date of the submittal of this coverage form. Coverage will be issued in the company name as it is registered with the Mississippi Secretary of State.

ALL INFORMATION MUST BE COMPLETED (indicate "N/A" where not applicable)

APPLICANT INFORMATION

APPLICANT IS THE OWNER OPERATOR (Must check one or both)

OPERATOR CONTACT PERSON: Adam Stubblefield

OPERATOR COMPANY NAME: AHS Ventures, LLC

OPERATOR STREET OR P. O. BOX: 5255 Hwy 346

OPERATOR CITY: Pontotoc STATE: MS ZIP: 38863

OPERATOR PHONE #: (662) 419-0841 OPERATOR EMAIL: astubob@ahsconstructioncompany.com

OWNER CONTACT PERSON: Adam Stubblefield

OWNER COMPANY: AHS Ventures, LLC

OWNER STREET OR P. O. BOX: 5255 Hwy 346

OWNER CITY: Pontotoc STATE: MS ZIP: 38863

OWNER PHONE #: (662) 419-0841 OWNER EMAIL: astubob@ahsconstructioncompany.com

IF CHECKED YES TO MINE DEWATERING, FILL OUT BELOW

IS MINE COVERED UNDER VALID NPDES DISCHARGE PERMIT FOR MINE DEWATERING?

YES

NO

PERMIT NO. MS _____

ESTIMATED DEWATERING VOLUME: _____ (GAL/DAY)

NAME AND ADDRESS OF THE RECIPIENT OF THE DISCHARGE MONITORING REPORTS (DMRs), IF DIFFERENT FROM SIGNATORY:

I certify under penalty of law that this document and all attachments were prepared under my direction or supervision in accordance with a system designed to assure that qualified personnel properly gathered and evaluated the information submitted. Based on my inquiry of the person or persons who manage the system, or those persons directly responsible for gathering the information, the information submitted is, to the best of my knowledge and belief, true, accurate and complete. I am aware that there are significant penalties for submitting false information, including the possibility of fine and imprisonment for knowing violations.

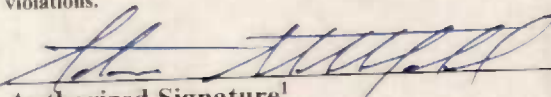

Authorized Signature¹

4/19/18

Date

Adam Stubblefield

Printed Name

owner/operator

Title

¹This application shall be signed according to the General Permit, Act 15, T-4 as follows:

- For a corporation, by a responsible corporate officer.
- For a partnership, by a general partner.
- For a sole proprietorship, by the proprietor.
- For a municipal, state or other public facility, by either a principal executive officer, the mayor, or ranking elected official.
- Duly Authorized Representative

Please submit this form to:

Chief, Environmental Permits Division
MDEQ, Office of Pollution Control
P.O. Box 2261
Jackson, Mississippi 39225

NOTE:
 THE TOTAL NUMBER OF ACRES TO BE PERMITTED
 IS 12.0 ACRES, WHICH INCLUDES 11.25 ACRES OF
 PROPOSED EXCAVATION AND 0.75 ACRE OF
 INGRESS/EGRESS ACCESS TO ENTER THE MINE
 FROM MARTIN STREET AND OLD HIGHWAY 15.

METAL FENCE POST SHALL BE SET AT ALL CORNERS OF PERMITTED AREA
 (TYPICAL)



SEE MAP 5 FOR PIT CROSS-SECTIONS

SITE GRADING NOTES:

1. AS INDICATED BY AERIAL PHOTOGRAPHY, THE MINE IS CURRENTLY IN OPERATION. THE MINE LIES ALONG AN EXISTING RIDGE (THE RIDGE BEING IN THE GENERAL VICINITY OF THE "B-B" CROSS SECTION LINE SHOWN).
2. EXISTING TOPOGRAPHY IS GENTLY SLOPING FROM THE TOP OF THE RIDGE IN THE DIRECTION OF THE DITCHES ALONG THE NORTH AND SOUTH BOUNDARIES OF THE PROPERTY, AS DEPICTED BY THE DRAINAGE ARROWS.
3. AS THE MINING OPERATIONS PROGRESS, STORM WATER RUNOFF WILL GENERALLY BE DIRECTED TO THE SOUTHWEST CORNER OF THE PERMITTED EXCAVATION AREA. APPROPRIATE EROSION CONTROL BMPs WILL BE INCORPORATED SUCH AS SILT FENCES, BRUSH BARRIERS AND SEDIMENT BASINS. THESE FEATURES ARE NOT SHOWN GRAPHICALLY, BUT THE MINE SUPERVISOR WILL USE THESE STRUCTURES WHERE APPROPRIATE TO PREVENT OFFSITE MIGRATION OF SEDIMENT.

MINE SUPERVISOR:

Adam Stubblefield
 AHS Ventures, LLC
 5255 Highway 346
 Pontotoc, MS 38863
 (662) 419-0841

astubbl@ahsconstructioncompany.com

SOURCE: GOOGLE EARTH

0 150 300 scale in feet

NE¼ and SE¼ of Sec. 12, T-8-S, R-4-W,
 Lafayette County, MS

www.pecorpms.com
 Oxford 662-234-8539



OLD HWY 15 MINE - Ecu, MS
 MAP #2

GENERAL SITE PLAN - EXISTING CONDITIONS

DRAWN BY:		CHECKED BY:		DATE:	
MSC		N/A		11-12-15	
NO.	DATE:	REVISIONS	BY:	SCALE:	
				AS-NOTED	
				DRAWING NO.:	PAGE NO.:
					1

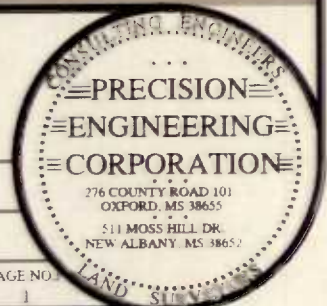

NOTE:
 THE TOTAL NUMBER OF ACRES TO BE PERMITTED
 IS 12.0 ACRES, WHICH INCLUDES 11.25 ACRES OF
 PROPOSED EXCAVATION AND 0.75 ACRE OF
 INGRESS/EGRESS ACCESS TO ENTER THE MINE
 FROM MARTIN STREET AND OLD HIGHWAY 15.

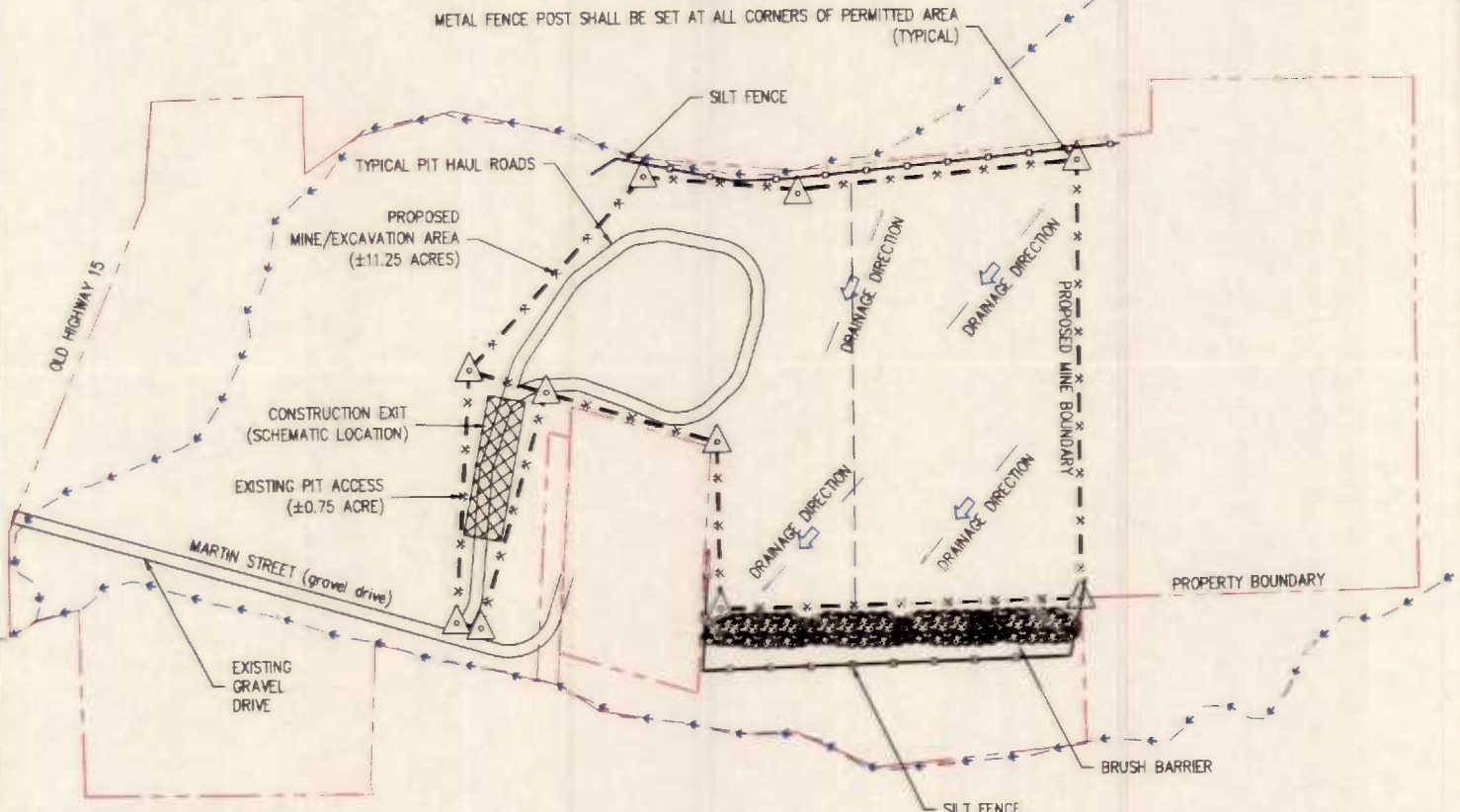

LEGEND

- HAY BALE (use as needed)
- HAY BALE CHECK (use as needed)
- SILT FENCE (short-term)
- HEAVY DUTY SILT FENCE (long-term) (MOOT TEC-1)
- RIP RAP
- BRUSH BARRIER
- CONSTRUCTION ENTRANCE

SWPPP NOTES:

1. **CONSTRUCTION ENTRANCE** - Currently the mine is accessed by a gravel driveway (also known as Martin Street) off of Old Highway 15. It also serves as a driveway for the the outparcel adjacent to the mine. A temporary construction entrance will be installed just north of the existing gravel driveway at the entrance to the mine. During wet weather, it may be necessary to wash vehicle tires at this location. Runoff coming from the proposed entrance towards the gravel driveway will be controlled by diversions, silt fencing and check dams as deemed appropriate during mining operations.
2. **LAND GRADING** - Soils will be borrowed from this site and reused as fill material on another site. The mine will be graded such that all storm water runoff will be directed via berms and swales toward the runoff BMPs that are installed. Temporary vegetation will be established on areas that will remain uncovered for lengthy periods of time. Reclaimed slopes will be no steeper than 3:1 (horizontal to vertical) and will have grass established as permanent vegetation.
3. **SILT FENCES** - Silt fences may be required during reclamation along the base of the slopes. Additional silt fencing will be installed as deemed necessary.
4. **STRAW BALE BARRIERS** - Straw bale barriers will be used in conjunction with silt fences where deemed necessary.
5. **BRUSH DIKES & RIP RAP CHECK DAMS** - If deemed necessary by the mine supervisor, brush dikes and/or rip-rap check dams will be constructed in lieu of placing silt fence/straw bale barrier.
6. **DIVERSIONS** - Temporary diversion terraces will be constructed throughout the site as the final grading is completed to protect steep slopes as deemed necessary by the mine supervisor.
7. **DUST CONTROL** - Dust control could be a problem due to the large area of exposure, and the residential areas around the site. Should excessive dust be generated, it will be controlled by sprinkling.
8. **SEDIMENT BASINS** - Currently there are not sediment basins shown within the permitted mine (with the exception of a ponding area within the interior of the haul loop). All runoff from disturbed areas within the mine will be directed toward sediment controls before leaving the site. When basins are used to trap sediment, they will be cleaned out when storage capacity has been reduced to 50% of the original capacity.

MINE SUPERVISOR:
 Adam Stubblefield
 AHS Ventures, LLC
 5255 Highway 346
 Pontotoc, MS 38863
 (662) 419-0841
 astubb@ahsconstructioncompany.com

SOURCE: GOOGLE EARTH

0 150 300 scale in feet

NE¼ and SE¼ of Sec. 12, T-8-S, R-4-W,
 Lafayette County, MS

www.pecorpms.com
 Oxford 662-234-8539

**OLD HWY 15 MINE - Ecu, MS
 MAP #8**

Storm Water Pollution Prevention Plan (SWPPP)

DRAWN BY: MSC	CHECKED BY: N/A	DATE: 11-12-15
NO. OF REVISIONS	REVISIONS	SCALE: AS-NOTED
		DRAWING NO.:
		PAGE NO.:

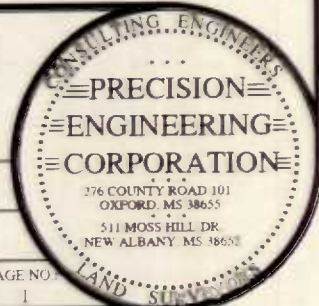

NOTE:
 THE TOTAL NUMBER OF ACRES TO BE PERMITTED
 IS 12.0 ACRES, WHICH INCLUDES 11.25 ACRES OF
 PROPOSED EXCAVATION AND 0.75 ACRE OF
 INGRESS/EGRESS ACCESS TO ENTER THE MINE
 FROM MARTIN STREET AND OLD HIGHWAY 15

METAL FENCE POST SHALL BE SET AT ALL CORNERS OF PERMITTED AREA
 (TYPICAL)



SEE MAP 5 FOR PIT CROSS-SECTIONS

SITE GRADING NOTES:

1. AS INDICATED BY AERIAL PHOTOGRAPHY, THE MINE IS CURRENTLY IN OPERATION. THE MINE LIES ALONG AN EXISTING RIDGE (THE RIDGE BEING IN THE GENERAL VICINITY OF THE "B-B" CROSS SECTION LINE SHOWN).
2. EXISTING TOPOGRAPHY IS GENTLY SLOPING FROM THE TOP OF THE RIDGE IN THE DIRECTION OF THE DITCHES ALONG THE NORTH AND SOUTH BOUNDARIES OF THE PROPERTY AS DEPICTED BY THE DRAINAGE ARROWS.
3. AS THE MINING OPERATIONS PROGRESS, STORM WATER RUNOFF WILL GENERALLY BE DIRECTED TO THE SOUTHWEST CORNER OF THE PERMITTED EXCAVATION AREA. APPROPRIATE EROSION CONTROL BMPs WILL BE INCORPORATED SUCH AS SILT FENCES, BRUSH BARRIERS AND SEDIMENT BASINS. THESE FEATURES ARE NOT SHOWN GRAPHICALLY, BUT THE MINE SUPERVISOR WILL USE THESE STRUCTURES WHERE APPROPRIATE TO PREVENT OFFSITE MIGRATION OF SEDIMENT.

MINE SUPERVISOR

Adam Subblefield
 AHS Ventures, LLC
 5255 Highway 346
 Pontotoc, MS 38863
 (662) 419-0841

astubb@ahsconstructioncompany.com

SOURCE: GOOGLE EARTH

0 150 300 scale in feet

NE¼ and SE¼ of Sec. 12, T-8-S, R-4-W,
 Lafayette County, MS

www.pecorpms.com
 Oxford 662-234-8539



**OLD HWY 15 MINE - Ecrú, MS
 MAP #2**

GENERAL SITE PLAN - EXISTING CONDITIONS

DRAWN BY:	CHECKED BY:	DATE:
MSC	N/A	11-12-15
NO. DATE	REVISIONS	BY:
DRAWING NO.:	PAGE NO.:	
	1	

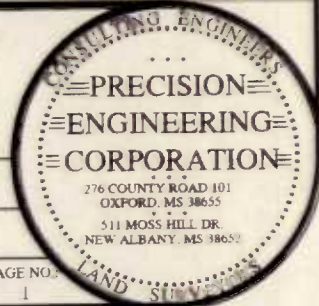

MINE INFORMATION

MINE SITE NAME: Old Hwy 15 Mine

CONTACT NAME & POSITION: Adam Stubblefield Owner/Operator

CONTACT PHONE NUMBER: 662, 488-0048

MINE PHYSICAL SITE ADDRESS (IF NOT AVAILABLE INDICATE NEAREST NAMED ROAD):

STREET: Old Hwy 15 + Martin Street

CITY: Ecorse

COUNTY: Pontotoc

ZIP: 38841

ATTACH A USGS QUAD MAP, EXTENDING 1/2 MILE BEYOND FACILITY, OUTLINING THE MINE BOUNDARIES (Maps can be obtained from the Mississippi Office of Geology. For information call 601-961-5523).

4 OF NE /4 OF SECTION 30, TOWNSHIP 08S, RANGE 03E

LATITUDE: 34 DEGREES 21 MINUTES 33 SECONDS

LONGITUDE: 89 DEGREES 01 MINUTES 25 SECONDS

LAT & LONG DATA SOURCE (GPS (PLEASE GPS ENTRANCE GATE) OR MAP INTERPOLATION):

TOTAL ACREAGE: 12.0

MATERIAL TO BE MINED: sand and clay

ESTIMATED START DATE: currently active

ESTIMATED END DATE:

SIC CODE 1442

YYYY-MM-DD

NAICS CODE 212321

YYYY-MM-DD

STORM WATER POLLUTION PREVENTION PLAN (SWPPP)

THE GENERAL PERMIT REQUIRES THE SWPPP TO BE ONSITE OR LOCALLY AVAILABLE, UP-TO-DATE AND EFFECTIVE IN CONTROLLING STORM WATER POLLUTANTS. ACCORDINGLY, IN ADDITION TO THE PROJECT'S CURRENT BMPS, TWO (2) SPECIFIC BMPS (SEE BELOW) ARE REQUIRED TO BE IN THE SWPPP.

IS A COPY OF THE SWPPP AT THE PERMITTED SITE OR LOCALLY AVAILABLE?

YES NO

DOES SWPPP CONTAIN AN UP-TO-DATE ASSESSMENT OF POTENTIAL STORM WATER POLLUTANT SOURCES AND IDENTIFY BMPS TO EFFECTIVELY CONTROL THEM?

YES NO

IF A SEDIMENTATION BASIN IS A PROJECT BMP, DOES IT DISCHARGE ONLY FROM THE SURFACE OF THE BASIN? IF NO, THE BASIN MUST HAVE A SURFACE DISCHARGE IMMEDIATELY FROM THE DATE OF RECOVERY.

YES or N.A. NO

IF TRUCK TRAFFIC LEAVES MINING SITE AND MOVES DIRECTLY ONTO PAVED PUBLIC ROAD, IS A CONSTRUCTION EXIT AN INSTALLED BMP? IF NO, A CONSTRUCTION EXIT MUST BE INSTALLED IMMEDIATELY OF THE DATE OF RECOVERY. IF A MINE IS CURRENTLY INACTIVE, BUT IS SUBMITTING A RECOVERY FORM, THE CONSTRUCTION EXIT MUST BE INSTALLED IMMEDIATELY OF THE MINE BECOMING ACTIVE.

YES or N.A. NO

IS A WASTEWATER RECIRCULATION SYSTEM WITH NO DISCHARGE USED ON THE FACILITY?

YES NO

IS MINE DEWATERING PRESENT ON SITE?

YES NO

IF CHECKED YES TO WASTERWATER RECIRCULATION SYSTEM WITH NO DISCHARGE, FILL OUT BELOW

IS MINE COVERED UNDER VALID "NO DISCHARGE" STATE OPERATING PERMIT?

YES NO

PERMIT NO. MS

DISTANCE BETWEEN RECIRCULATION POND(S) AND PROPERTY LINE: _____ (FT)
(MUST BE AT LEAST 150 FEET)

NUMBER OF RECIRCULATION POND(S): _____

STORAGE CAPACITY OF EACH RECIRCULATION POND: _____ (FT³)