

**Talbot Brothers Contracting Co. Inc. &  
Talbot Brothers Grading Co. Inc., AJV**

P.O. Box 364 Nesbit, MS 38651-0364  
Ph (662)429-7291

April 3, 2020

Office of Pollution Control  
Environmental Permits Division  
P. O. Box 2261  
Jackson, MS 39225

Re: Mining Operations

Dear Staff Member

I am submitting the attached MNOI, SWPPP, and a 7.5' USGS Quad Map showing the location of an area we plan on mining borrow soil from. This will be a less than four (4) acre mining operation and I am certifying that no runoff will be created for adjacent properties. I have already submitted the necessary forms to the Office of Geology. Please process accordingly and feel free to call for any additional information that is needed. Thanks in advance.

Sincerely,

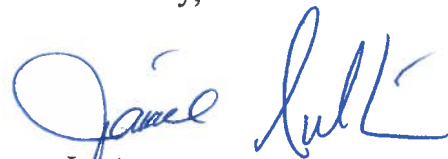

Jamie Sullivan, P.E.  
Vice President  
Talbot Brothers Grading Co., Inc.  
Cell# 901-831-0082



MISSISSIPPI DEPARTMENT OF  
ENVIRONMENTAL QUALITY

**MINING NOTICE OF INTENT (MNOI)  
FOR COVERAGE UNDER  
MINING STORM WATER, DEWATERING AND NO DISCHARGE  
GENERAL PERMIT MSR32 \_\_\_\_\_  
(Number to be assigned by State)**

**File at least 30 days prior to the commencement of mining; 15 days if a Storm Water Pollution Prevention Plan (SWPPP) is already on file and mine dewatering is not proposed. Lateral expansion of an existing mine that has general permit coverage requires the submittal of the Major Modification Form, not a new MNOI. However, modification of the existing SWPPP to include the expansion is required. Discharge of storm water or impounded water associated with mining or the operation of a wastewater recirculation system with no discharge without written notification of coverage from MDEQ is a violation of State Law.**

**If the company seeking coverage is a corporation, a limited liability company, a partnership, or a business trust, attach proof of its registration with the Mississippi Secretary of State and/or its Certificate of Good Standing. This registration or Certificate of Good Standing must be dated within twelve (12) months of the date of the submittal of this coverage form. Coverage will be issued in the company name as it is registered with the Mississippi Secretary of State.**

**Please indicate the activities to be covered by this MNOI (check all that apply).**

- ☒ Storm Water Discharges Associated with Mining      ☐ Mine Dewatering  
☐ Wastewater Recirculation System with No Discharge

**The appropriate section of the MNOI must be completed if the applicant proposes to discharge storm water, discharge impounded mine water (dewatering) and/or operate a wastewater recirculation system with no discharge.**

**A site-specific Storm Water Pollution Prevention Plan (SWPPP) developed in accordance with ACT5 of the General Permit and a United States Geological Survey (USGS) quadrangle map or photocopy, indicating the site location and outfalls must be included with the MNOI submittal. The name of the quadrangle map must be shown on all copies. Quadrangle maps can be obtained from the MDEQ, Office of Geology at 601-961-5523. Additional submittals may include the following (check all that apply).**

- ☐ Section 404 Documentation      ☒ Notice of Exempt Operations Form  
☐ Dam/Reservoir Safety Permit or Written Authorization

**ALL INFORMATION MUST BE COMPLETED (indicate "N/A" where not applicable)**

**MSR32** \_\_\_\_\_

(NUMBER TO BE ASSIGNED BY STATE)

APPLICANT IS THE: ☐ OWNER ☒ OPERATOR

**OWNER CONTACT INFORMATION**

OWNER CONTACT PERSON: Michael Hawks

OWNER COMPANY LEGAL NAME: \_\_\_\_\_

OWNER STREET OR P. O. BOX: 7005 Holly Springs Rd

OWNER CITY: Hernando STATE: MS ZIP: 38632

OWNER PHONE #: (901) 486-3446 OWNER EMAIL: \_\_\_\_\_

**OPERATOR CONTACT INFORMATION**

OPERATOR CONTACT PERSON: James C. Sullivan, Jr.

OPERATOR COMPANY LEGAL NAME: Talbot Brothers Grading Co.

OPERATOR STREET OR P. O. BOX: P.O. Box 364

OPERATOR CITY: Nesbit STATE: MS ZIP: 38651

OPERATOR PHONE #: (662) 429-7291 OPERATOR EMAIL: jamie.talbotbrothers@gmail.com

**MINE INFORMATION**

MINE NAME: Hawks HSR Mine

MINE SITE ADDRESS (If the physical address is not available, please indicate nearest named road.)

Street: Approximately 7005 Holly Springs Road

City: Hernando State: MS County: DeSoto Zip: 38632

NW \_\_\_\_\_ /4 OF SW \_\_\_\_\_ /4 OF SECTION 29, TOWNSHIP 3S, RANGE 6W

MINE SITE TRIBAL LAND ID (N/A If not applicable): N/A

ATTACH A USGS QUAD MAP, EXTENDING ½ MILE BEYOND FACILITY, OUTLINING THE MINE BOUNDARIES  
(Maps can be obtained from the Mississippi Office of Geology. For information call 601-961-5523).

LATITUDE: 34 degrees 47 minutes 39 seconds LONGITUDE: -89 degrees 51 minutes 43 seconds

LAT & LONG DATA SOURCE (GPS (Please GPS Entrance Gate) or Map Interpolation): Map Interpolation

TOTAL ACREAGE: 4 MATERIAL TO BE MINED: Borrow Dirt

WILL HYDRAULIC DREDGING BE USED? ☐ YES ☒ NO

WASHING OF SAND/GRAVEL? ☐ YES ☒ NO

ESTIMATED START DATE: 2020-05-1  
YYYY-MM-DD

ESTIMATED END DATE: 2022-03-15  
YYYY-MM-DD

SIC CODE \_\_\_\_\_

NAICS CODE \_\_\_\_\_

### RECEIVING STREAM INFORMATION

NEAREST NAMED RECEIVING STREAM: Jordan Creek

IS RECEIVING STREAM ON MISSISSIPPI'S 303(D) LIST OF IMPAIRED WATER BODIES? (The 303(d) list of impaired waters and TMDL stream segments may be found of MDEQ's website: [http://www.deq.state.ms.us/MDEQ.nsf/page/TWB\\_Total\\_Maximum\\_Daily\\_Load\\_Section](http://www.deq.state.ms.us/MDEQ.nsf/page/TWB_Total_Maximum_Daily_Load_Section)) ☐ YES ☒ NO

HAS A TMDL BEEN ESTABLISHED FOR THE RECEIVING STREAM SEGMENT? ☐ YES ☒ NO

### COMPLETE IF STORM WATER DISCHARGE IS PROPOSED

ATTACH A STORM WATER POLLUTION PREVENTION PLAN (SEE PERMIT FOR REQUIREMENTS)

IDENTIFY THE ASSOCIATION OR GENERIC SWPPP ON FILE AT MDEQ: N/A

### COMPLETE IF WASTEWATER RECIRCULATION SYSTEM WITH NO DISCHARGE IS PROPOSED

DISTANCE BETWEEN RECIRCULATION POND(S) AND PROPERTY LINE: N/A (FT)  
(MUST BE AT LEAST 150 FEET)

NUMBER OF RECIRCULATION POND(S): N/A

STORAGE CAPACITY OF EACH RECIRCULATION POND(S): N/A (FT<sup>3</sup>)

### COMPLETE IF MINE DEWATERING IS PROPOSED

ESTIMATED DEWATERING VOLUME: N/A (GAL/DAY)

NAME AND ADDRESS OF THE RECIPIENT OF THE DISCHARGE MONITORING REPORTS (DMRs), IF DIFFERENT FROM SIGNATORY: N/A

**DOCUMENTATION OF COMPLIANCE WITH OTHER REGULATIONS/REQUIREMENTS**  
Coverage under this general permit will not be granted until all other required MDEQ permits and approvals are addressed.

WILL THE CONSTRUCTION OR OPERATION OF THIS MINE INVOLVE THE RE-ROUTING, FILLING OR CROSSING OF A WATER CONVEYANCE OF ANY KIND? ☐ YES ☒ NO

If yes, contact the U.S. Army Corps of Engineers' Regulatory Branch for permitting requirements. If the mine requires a Corps of Engineers Section 404 permit, provide appropriate documentation with this MNOI that:

- The mine has been approved by individual permit, or
- The work will be covered by a nationwide permit and NO NOTIFICATION to the Corps is required, or
- The work will be covered by a nationwide or general permit and NOTIFICATION to the Corps is required.

LIST ANY NPDES PERMIT NO.(s). \_\_\_\_\_ GEOLOGY APPLICATION/PERMIT NO. \_\_\_\_\_

LIST OTHER GEOLOGY PERMIT NUMBERS THAT APPLY TO COVERAGE AREA \_\_\_\_\_

IS THE MINE LESS THAN 4 ACRES AND GREATER THAN 1320 FEET FROM ANOTHER MINE?

☒ YES A "Notice of Exempt Operations" Form must be included with the MNOI or proof of prior submission, if previously submitted to the Office of Geology.

☐ NO A "Notice of Intent to Mine Class I or Class II Materials" Form must be filed before coverage will be granted under the Mining General Permit. For information on Office of Geology requirements, call 601-961-5515.

LIST ANY LOCAL STORM WATER ORDINANCES WITH WHICH THE OPERATIONS MUST COMPLY AND SUBMIT ANY ASSOCIATED APPROVAL DOCUMENTATION. \_\_\_\_\_

IF IMPOUNDMENTS WILL BE CONSTRUCTED ABOVE NATURAL SURFACE ELEVATIONS, INDICATE WHICH, IF ANY, OF THE FOLLOWING APPLY.

- ☐ The impoundment will be constructed with a peripheral dam or levee 8 feet or greater in height, measured from the lowest elevation of its toe.
- ☐ The impoundment will have a maximum storage volume greater than 25 acre-feet.
- ☐ The impoundment will impound a watercourse with a continuous flow.
- ☐ The impoundment has the potential to threaten downstream lives or man-made structures.

If any of the impoundments meet any of the above criteria, the applicant will be required to obtain written authorization from MDEQ, Dam Safety Division before coverage will be granted under the Mining General Permit.

I certify under penalty of law that this document and all attachments were prepared under my direction or supervision in accordance with a system designed to assure that qualified personnel properly gathered and evaluated the information submitted. Based on my inquiry of the person or persons who manage the system, or those persons directly responsible for gathering the information, the information submitted is, to the best of my knowledge and belief, true, accurate and complete. I am aware that there are significant penalties for submitting false information, including the possibility of fine and imprisonment for knowing violations.

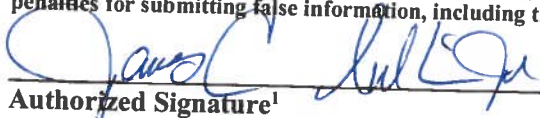
  
Authorized Signature

4/3/2020

Date

James C. Sullivan, Jr.

Operator

Printed Name

Title

This application shall be signed according to the General Permit, Act 15, T-4 as follows:

- For a corporation, by a responsible corporate officer.
- For a partnership, by a general partner.
- For a sole proprietorship, by the proprietor.
- For a municipal, state or other public facility, by either a principal executive officer, the mayor, or ranking elected official.
- Duly Authorized Representative

Please submit this form to: Chief, Environmental Permits Division  
MDEQ, Office of Pollution Control  
P.O. Box 2261  
Jackson, Mississippi 39225

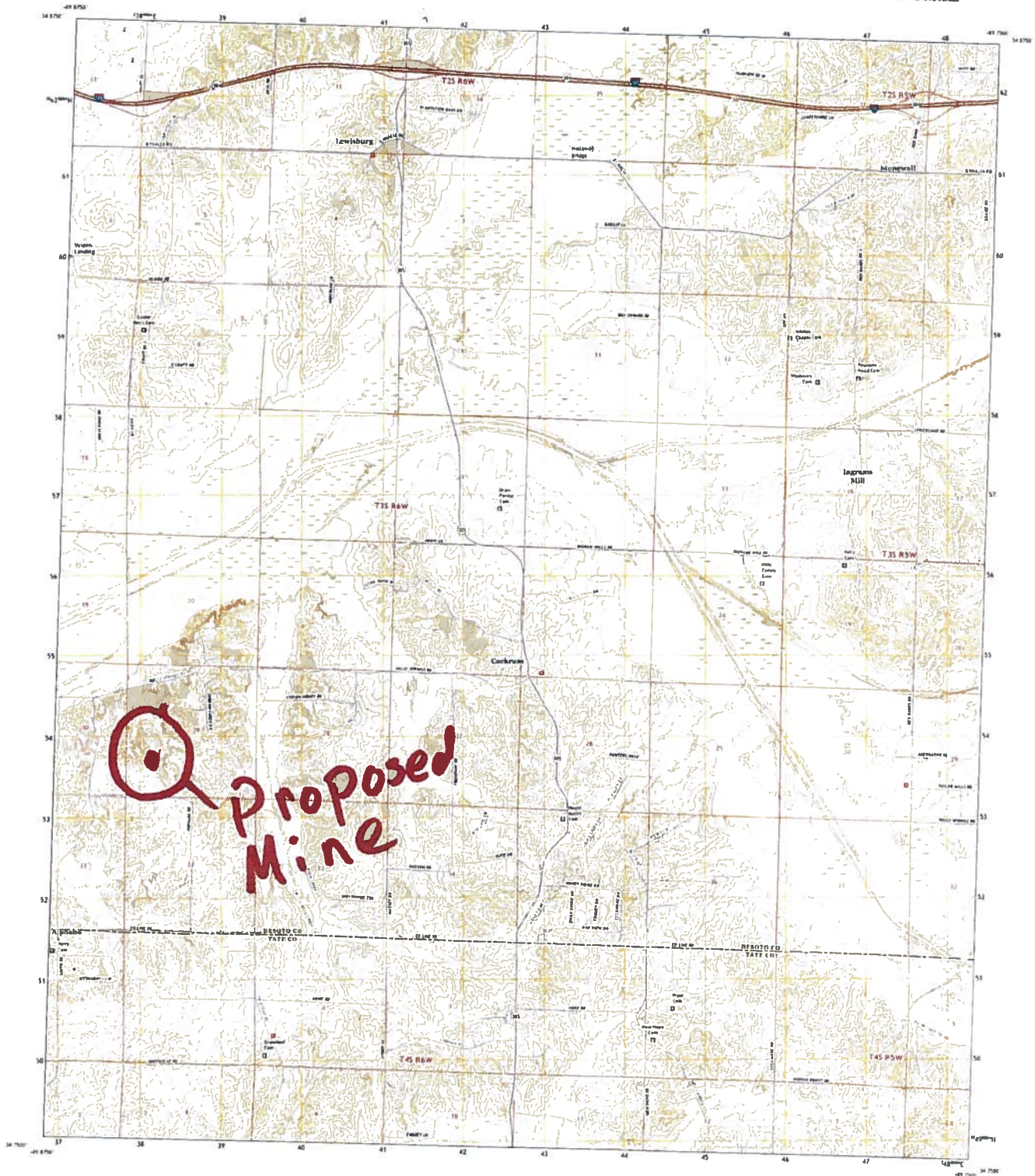
[illegible]

Imaging  
 Results  
 Summary  
 History/Notes  
 Comments  
 Recommendations  
 Public  
 Friends



LETTER FROM THE EDITOR

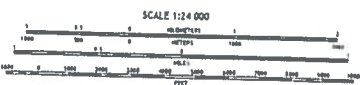

CONFIDENTIAL 10 TEXT  
 10/17/1960 10/17/1960 10/17/1960

This copy was produced to conform with the  
 National Communication Program of the Federal Bureau of Investigation  
 and is classified as CONFIDENTIAL



1 2 3  
4 5 6  
7 8 9

1  
2  
3  
4  
5  
6  
7  
8  
9

ROAD CLASSIFICATION

Expressway	_____	Local Freeway	_____
Secondary Freeway	_____	Local Road	_____
Ramp	_____	etc.	_____

 Interstate Route    US Route    State Route



## Stormwater Pollution Prevention Plan (SWPPP)

Name of Mine: Hawks HSR Mine

County: DeSoto

### SITE INFORMATION

This proposed is located at approximately 7005 Holly Springs Road Hernando, MS 38632. Its current state is open pasture. It is our intent to mine borrow dirt from the top of the hill, thereby, levelling the property for future development for a home site.

### SEDIMENT AND EROSION CONTROLS

**VEGETATIVE CONTROLS:** Clearing and grubbing areas will be minimized to comply with the buffer zones (minimum of 15 feet along the edge of the mine).

**VEGETATIVE PRACTICES:** Existing vegetation will be preserved where possible. Disturbed areas will be re-vegetated as soon as is practical upon completion of mining activities. Any disturbed area that is not actively being mined and will be left undisturbed for 30 days or more will have either temporary or permanent vegetation practices applied within seven calendar days.

**STRUCTURAL CONTROLS:** Gravel construction entrance/exit will be installed at access point to MS 178. Silt fence and silt berms will be installed as necessary as the mining progresses.

**HOUSEKEEPING PRACTICES:** Structural BMP's will be cleaned out when sediment reaches 1/3 to 1/2 of the height of the BMP. Once mining operations have begun, an area will be designated for equipment maintenance and repair. Waste receptacles will be provided at convenient locations, and waste will be regularly collected. Any storage areas will be protected and secondary containment will be provided around on-site tanks. Spill and leak prevention practices along with response procedures will be in place in case any leaks or spills do occur. Sanitary facilities will be provided and adequately maintained. Debris will be disposed of by loading it onto a dump truck and hauling it to a local landfill. In case of environmental emergency, the following will be contacted:

United State Environmental Services (USES)

Contact Name: Greg Baughan

1885 Veterans Drive

Southaven, MS 38671

662-280-3232

901-828-0182

**POST-CONSTRUCTION CONTROL MEASURES:** As construction is completed, permanent vegetative growth will be established on disturbed soils to improve soil stability and provide a buffer zone for loose material. Slopes will be established to be no greater than 3:1 prior to establishment of grass.

### IMPLEMENTATION SEQUENCE

Perimeter controls will be installed as necessary prior to Clearing, Grubbing and Stripping of Grass to prevent any loss of material to the adjacent property.

### MAINTENANCE PLAN

All erosion and sediment control practices will be checked for stability and operation following every rainfall but in no case less than once every week. Any needed repairs will be made immediately to maintain all practices as designed. Sediment will be removed from behind BMP's when it becomes about 1/3 to 1/2 height of BMP.

# Hawks HSR Mine

Write a description for your map.

## Legend

 Hawks HSR Mine Limits

Google Earth

©20 Google

Earth Point

300 ft

