



CHANGE REQUEST FORM

READY-MIX CONCRETE GENERAL PERMIT COVERAGE NUMBER MSG11 0 2 4 4



Instructions: For the following changes, notification must be provided to the DEQ at least 30 days prior to the change:

- Part A – Any planned changes in facility operations that may affect air emissions and/or water discharges.
- Part B – Any planned changes of ownership.
- Part C – Any changes in information previously submitted in the NOI or Recoverage Form.

Complete each Part of the Form, marking "N/A" if the section does not apply to the change requested.

Company Name: Delta Industries Facility Name: Cole Road
 Facility Street Address: 423 Cole Rd City: Hattiesburg County: Lamar
 Contact Person: Keith Musgrove Phone No.: 601-319-4906 Email: kmusgrove@delta-ind.com
 Mailing Address: PO Box 1292 City: Jackson State: MS Zip: 39215

PART A – CHANGE TO FACILITY OPERATIONS ☐ YES ☒ N/A

- Is the change a Major Modification (defined in ACT 7, Condition T-9)? ☐ YES ☐ NO
 - If yes to 1, have you completed the public notice requirements in ACT 2, Condition S-3? (See Public Notice Instructions for more information.) ☐ YES ☐ NO ☐ N/A
 - If yes to 1, have you notified the contiguous landowners per ACT 2, Condition S-2? ☐ YES ☐ NO ☐ N/A
- Will the change result in additional outfalls? ☐ YES ☐ NO
 - If yes to 2, have you notified the contiguous landowners per ACT 2, Condition S-2? ☐ YES ☐ NO ☐ N/A
- Does the change impact the design of the wastewater treatment facility? ☐ YES ☐ NO
 - If yes to 3, have you attached revised plans and specifications per ACT 2, Condition S-4? ☐ YES ☐ NO ☐ N/A

For all changes to facility operations, update the most recent version of the NOI or Recoverage Form, as needed, and attach it to this Form. Changes should also be outlined in a cover letter accompanying this form.

PART B – CHANGE OF OWNERSHIP ☐ YES ☒ N/A

Is the Request for Transfer Form complete and attached? ☐ YES ☐ NO

PART C – CHANGE OF INFORMATION PREVIOUSLY SUBMITTED ☒ YES ☐ N/A

Is the revised NOI or Recoverage Form attached reflecting any changes? ☒ YES ☐ NO

(The most recent NOI or Recoverage Form should be revised and completed in its entirety, with any updates made as needed to reflect changes to the facility. Changes should also be outlined in a cover letter accompanying this form.)

Based on my inquiry of the person or persons responsible for gathering the information, the information submitted is, to the best of my knowledge and belief, true, accurate and complete.

Authorized Signature of Responsible Official*

Thomas Anderson

Printed Name

Date

3/29/21
Director of Technical Services

Title

*A responsible official must be a corporate officer or facility manager delegated authorization to sign documents.

Submit signed form online at www.mdeq.ms.gov/rmcgpp or via hard copy to Water II Branch Manager, Environmental Permits Division, MDEQ, PO Box 2261, Jackson, MS 39225

m - received hardcopy 3.29.21



READY-MIX CONCRETE RECOVERY FORM

CURRENT COVERAGE NO.: MSG11 0 2 4 4

(Coverage number is located at the bottom left corner of your previous Certificate of Coverage)



Company Name: Delta Industries, Inc. Facility Name: Hattiesburg Cole Road Plant 87

Contact Name and Position: Les Howell, P.E., Senior VP and Chief Operating Officer

Contact Area Code and Phone Number: (601) 354 - 3804 Contact Email: Lhowell@delta-ind.com

Primary SIC Code: (3273) Primary NAICS Code (6-digit): (327320)

Physical Site Address - Street: 423 Cole Road

City: Hattiesburg State: MS Zip: 39402 County: Lamar

Mailing Address - Street: P.O. Box 1292

City: Jackson State: MS Zip: 39215

Plant Maximum Production Rate: 150 cubic yards/hr
(Maximum production rate must be based on the manufacturer's maximum rated plant capacity on an hourly basis.)

Will you own or operate a rock crusher at the site? ☐ Yes ☒ No
If a third party will own/operate a rock crusher at your site, mark "No." The third party is responsible for obtaining any necessary air permits to operate the rock crusher.

Rock Crusher Type / Rated Cumulative Capacity: ☐ Fixed: _____ tons/hr ☐ Portable: _____ tons/hr ☒ N/A

Will you operate stationary fuel burning equipment (e.g., engines, heaters, etc.) at the site? ☐ Yes* ☒ No
*If you marked "Yes" complete and submit the attached Fuel Burning Equipment Form & Compliance Plan.

Nearest Named Waterbody Which Storm Water Leaving the Site Will Enter: Perkins Creek

Is a Copy of the SWPPP at the Permitted Site? ☒ YES ☐ NO SWPPP Date: 01/2021

If the SWPPP is Based on the Industry Generic SWPPP, is it the Most Recent Copy? ☐ YES ☐ NO ☒ N/A

Does the SWPPP Meet the Requirements Listed in ACT5 of the RMCGP? ☒ YES ☐ NO*
*If No then Please Attach an Amended SWPPP.

Are construction activities (e.g., clearing, grading, etc.) still ongoing at the site? ☐ YES* ☒ NO
*If "yes," does the total acreage of the construction activities equal or exceed 5.0 acres? ☐ YES ☐ NO

I certify under penalty of law that this document and all attachments were prepared under my direction or supervision in accordance with a system designed to assure that qualified personnel properly gathered and evaluated the information submitted. Based on my inquiry of the person or persons who manage the system, or those persons directly responsible for gathering the information, the information submitted is, to the best of my knowledge and belief, true, accurate and complete. I am aware that there are significant penalties for submitting false information, including the possibility of fines and imprisonment for knowing violations.

I further certify that the project continues as described in the original notice of intent. Also, I certify that I understand when coverage is terminated I am no longer authorized to emit regulated air emissions and discharge wastewater or storm water associated with industrial activity under this general permit. I understand that discharging pollutants associated with industrial activity to waters of the state without NPDES coverage is in violation of state law.

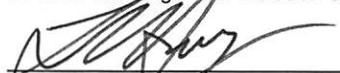
Authorized Signature (shall be signed according to ACT6, T-9 of the GP)

Les Howell, P.E.
Printed Name

3/29/2021
Date Signed
Senior VP and Chief Operating Officer
Title

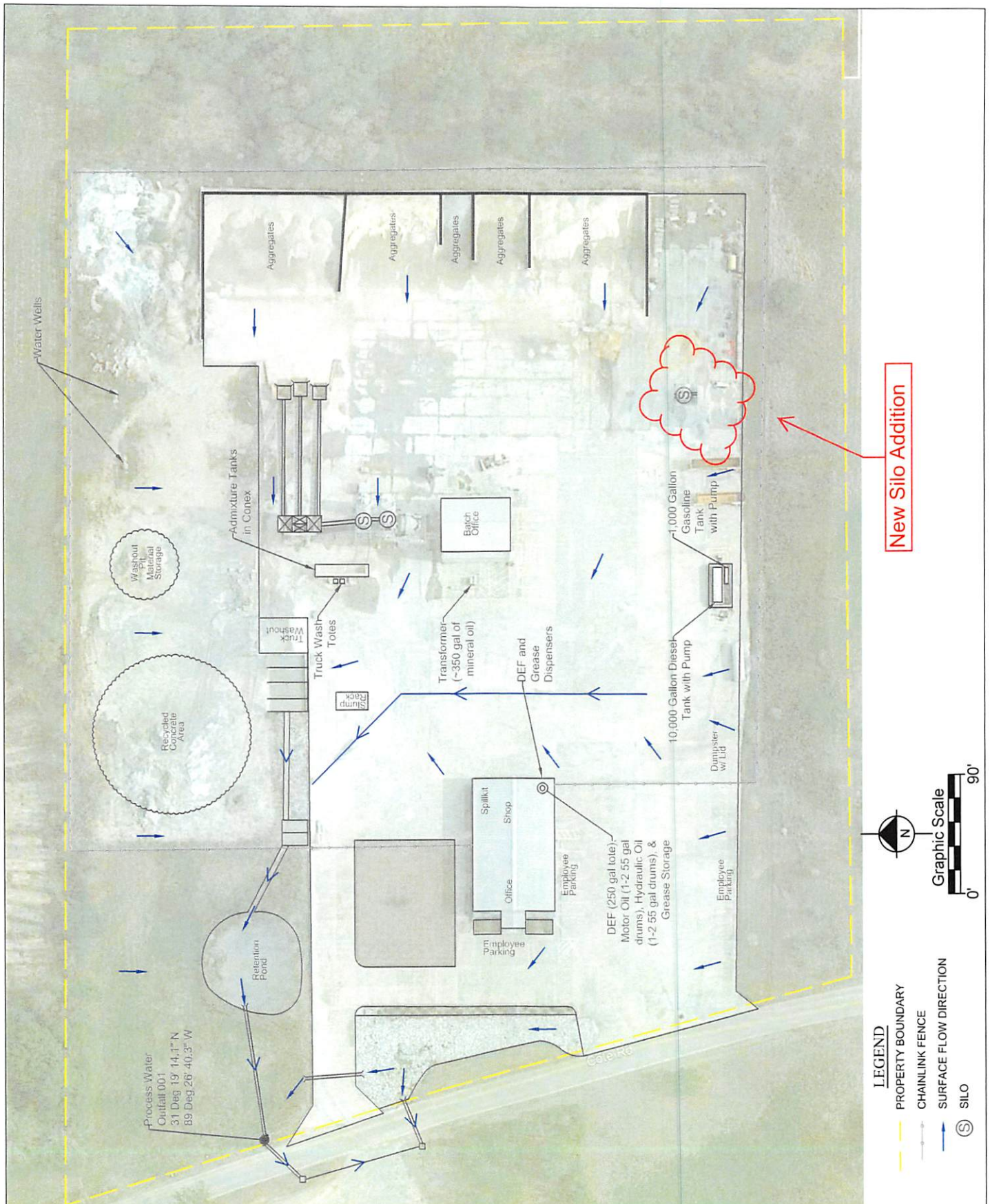



March 29, 2021

Chief, Environmental Permits Division
MS Department of Environmental Quality, Office of Pollution Control
P.O. Box 2261
Jackson, Mississippi 39225
HAND-DELIVERED

RE: Change Request for Permit MSG110244

To Whom It May Concern,

Please find attached a ***Change Request Form, Ready-Mix Concrete Recoverage Form, and updated Appendix C "Site Layout Drawing"*** for MDEQ Permit #: **MSG110244**. This letter and associated forms shall serve as notification to DEQ of our intention to place a new cement silo at our Cole Rd facility located at 423 Cole Rd Hattiesburg, MS in Lamar county. Our intention is to start work erecting the silo no earlier than May 1, 2021. We have included the forms and updated portion of the Site Layout Drawing. No other information from previously submitted material requires changes. If you need any additional information in this regard, please do not hesitate to contact me.

Sincerely,

Thomas Anderson
Director of Technical Services
Delta Industries, Inc.
601-354-3804

w/attachments

RECEIVED

MAR 29 REC'D

Dept. of Environmental Quality