

MSR10 8770

(NUMBER TO BE ASSIGNED BY STATE)

APPLICANT IS THE: ☒ OWNER ☐ PRIME CONTRACTOR

**OWNER CONTACT INFORMATION**

OWNER CONTACT PERSON: Salem Bunkheila  
 OWNER COMPANY LEGAL NAME: Hattiesburg Convention Commission  
 OWNER STREET OR P.O. BOX: One Convention Center Plaza  
 OWNER CITY: Hattiesburg STATE: MS ZIP: 39401  
 OWNER PHONE #: ( ) \_\_\_\_\_ OWNER EMAIL: sbunkheila@hattiesburg.org

**PREPARER CONTACT INFORMATION**

IF NOI WAS PREPARED BY SOMEONE OTHER THAN THE APPLICANT

CONTACT PERSON: Shelby Murray  
 COMPANY LEGAL NAME: Pickering Firm, Inc.  
 STREET OR P.O. BOX: 2001 Airport Road, Suite 201  
 CITY: Flowood, MS STATE: MS ZIP: 39232  
 PHONE # ( ) 601-956-3663 EMAIL: smurray@pickeringfirm.com

**PRIME CONTRACTOR CONTACT INFORMATION**

PRIME CONTRACTOR CONTACT PERSON: \_\_\_\_\_  
 PRIME CONTRACTOR COMPANY LEGAL NAME: \_\_\_\_\_  
 PRIME CONTRACTOR STREET OR P.O. BOX: \_\_\_\_\_  
 PRIME CONTRACTOR CITY: \_\_\_\_\_ STATE: \_\_\_\_\_ ZIP: \_\_\_\_\_  
 PRIME CONTRACTOR PHONE #: ( ) \_\_\_\_\_ PRIME CONTRACTOR EMAIL: \_\_\_\_\_

**FACILITY SITE INFORMATION**

FACILITY SITE NAME: Hattiesburg Water Park  
 FACILITY SITE ADDRESS (If the physical address is not available, please indicate the nearest named road. For linear projects indicate the beginning of the project and identify all counties the project traverses.)  
 STREET: 107 South 17th Avenue  
 CITY: Hattiesburg STATE: MS COUNTY: Forrest ZIP: 39401  
 FACILITY SITE TRIBAL LAND ID (N/A If not applicable): N/A  
 LATITUDE: 31 degrees 19 minutes 26 seconds LONGITUDE: 89 degrees 19 minutes 03 seconds  
 LAT & LONG DATA SOURCE (GPS (Please GPS Project Entrance/Start Point) or Map Interpolation): Map Interpolation  
 TOTAL ACREAGE THAT WILL BE DISTURBED <sup>1</sup>: 7

<b>IS THIS PART OF A LARGER COMMON PLAN OF DEVELOPMENT?</b>		YES <input type="checkbox"/>	NO <input checked="" type="checkbox"/>
<b>IF YES, NAME OF LARGER COMMON PLAN OF DEVELOPMENT:</b> _____			
<b>AND PERMIT COVERAGE NUMBER:</b> MSR10_____			
<b>ESTIMATED CONSTRUCTION PROJECT START DATE:</b>		2022-08-25 YYYY-MM-DD	
<b>ESTIMATED CONSTRUCTION PROJECT END DATE:</b>		2023-08-25 YYYY-MM-DD	
<b>DESCRIPTION OF CONSTRUCTION ACTIVITY:</b> <u>Construct Water Park and paved parking lot</u>			
<b>PROPOSED DESCRIPTION OF PROPERTY USE AFTER CONSTRUCTION HAS BEEN COMPLETED:</b> <u>Public Water Park with paved parking.</u>			

SIC Code: <u>1611</u>	NAICS Code: _____
-----------------------	-------------------

<b>NEAREST NAMED RECEIVING STREAM:</b> <u>Gordon's Creek</u>	
<b>IS RECEIVING STREAM ON MISSISSIPPI'S 303(d) LIST OF IMPAIRED WATER BODIES? (The 303(d) list of impaired waters and TMDL stream segments may be found on MDEQ's web site: <a href="http://www.deq.state.ms.us/MDEQ.nsf/page/TWB_Total_Maximum_Daily_Load_Section">http://www.deq.state.ms.us/MDEQ.nsf/page/TWB_Total_Maximum_Daily_Load_Section</a>)</b>	
YES <input type="checkbox"/>	NO <input checked="" type="checkbox"/>
<b>HAS A TMDL BEEN ESTABLISHED FOR THE RECEIVING STREAM SEGMENT?</b>	
YES <input type="checkbox"/>	NO <input type="checkbox"/>
<b>FOR WHICH POLLUTANT:</b>	
<b>ARE THERE RECREATIONAL STREAMS, PRIVATE/PUBLIC PONDS OR LAKES WITHIN 1/2 MILE DOWNSTREAM OF PROJECT BOUNDARY THAT MAY BE IMPACTED BY THE CONSTRUCTION ACTIVITY?</b>	
YES <input type="checkbox"/>	NO <input type="checkbox"/>
<b>EXISTING DATA DESCRIBING THE SOIL (for linear projects please describe in SWPPP):</b> <small>• Falkner-Susquehanna-Urban land complex (FsB)- 2 to 5 percent slopes, somewhat poorly drained with medium runoff class. • Prentiss-Urban land complex (Pu) -See SWPPP narrative</small>	
<b>WILL FLOCCULANTS BE USED TO TREAT TURBIDITY IN STORM WATER?</b>	
YES <input type="checkbox"/>	NO <input type="checkbox"/>
<b>IF YES, INDICATE THE TYPE OF FLOCCULANT.</b>	
<input type="checkbox"/>	<b>ANIONIC POLYACRYLAMIDE (PAM)</b>
<input type="checkbox"/>	<b>OTHER</b> _____
<b>IF YES, DOES THE SWPPP DESCRIBE THE METHOD OF INTRODUCTION, THE LOCATION OF INTRODUCTION AND THE LOCATION OF WHERE FLOCCULATED MATERIAL WILL SETTLE?</b>	
<b>IS A SDS SHEET INCLUDED FOR THE FLOCCULATE?</b>	
YES <input type="checkbox"/>	NO <input type="checkbox"/>
<b>WILL THERE BE A 50 FT BUFFER BETWEEN THE PROJECT DISTURBANCE AND THE WATERS OF THE STATE?</b>	
YES <input checked="" type="checkbox"/>	NO <input type="checkbox"/>
<b>IF NOT, PROVIDE EQUIVALENT CONTROL MEASURES IN THE SWPPP.</b>	

<sup>1</sup> Acreage for subdivision development includes areas disturbed by construction of roads, utilities and drainage. Additionally, a housesite of at least 10,000 ft<sup>2</sup> per lot (entire lot, if smaller) shall be included in calculating acreage disturbed.

## DOCUMENTATION OF COMPLIANCE WITH OTHER REGULATIONS/REQUIREMENTS

COVERAGE UNDER THIS PERMIT WILL NOT BE GRANTED UNTIL ALL OTHER REQUIRED  
MDEQ PERMITS AND APPROVALS ARE SATISFACTORILY ADDRESSED

IS LCNOI FOR A FACILITY THAT WILL REQUIRE OTHER PERMITS?

YES ☐

NO ☒

IF YES, CHECK ALL THAT APPLY:

☐ AIR

☐ HAZARDOUS WASTE

☐ PRETREATMENT

☐ WATER STATE OPERATING

☐ INDIVIDUAL NPDES

☐ OTHER: \_\_\_\_\_

IS THE PROJECT REROUTING, FILLING OR CROSSING A WATER CONVEYANCE  
OF ANY KIND? (If yes, contact the U.S. Army Corps of Engineers' Regulatory Branch for permitting requirements.)

YES ☐

NO ☒

IF THE PROJECT REQUIRES A CORPS OF ENGINEER SECTION 404 PERMIT, PROVIDE APPROPRIATE  
DOCUMENTATION THAT:

- The project has been approved by individual permit, or
- The work will be covered by a nationwide permit and NO NOTIFICATION to the Corps is required, or
- The work will be covered by a nationwide or general permit and NOTIFICATION to the Corps is required

IS THE PROJECT REROUTING, FILLING OR CROSSING A STATE WATER CONVEYANCE  
OF ANY KIND? (If yes, please provide an antidegradation report.)

YES ☐

NO ☒

IS A LAKE REQUIRING THE CONSTRUCTION OF A DAM BEING PROPOSED?

YES ☐

NO ☒

(If yes, provide appropriate approval documentation from MDEQ Office of Land and Water, Dam Safety.)

IF THE PROJECT IS A SUBDIVISION OR A COMMERCIAL DEVELOPMENT, HOW WILL SANITARY SEWAGE  
BE DISPOSED? Check one of the following and attach the pertinent documents.



Existing Municipal or Commercial System. Please attach plans and specifications for the collection system and the associated "Information Regarding Proposed Wastewater Projects" form or approval from County Utility Authority in Hancock, Harrison, Jackson, Pearl River and Stone Counties. If the plans and specifications can not be provided at the time of LCNOI submittal, MDEQ will accept written acknowledgement from official(s) responsible for wastewater collection and treatment that the flows generated from the proposed project can and will be transported and treated properly. The letter must include the estimated flow.



Collection and Treatment System will be Constructed. Please attach a copy of the cover of the NPDES discharge permit from MDEQ or indicate the date the application was submitted to MDEQ (Date: \_\_\_\_\_.)



Individual Onsite Wastewater Disposal Systems for Subdivisions Less than 35 Lots. Please attach a copy of the Letter of General Acceptance from the Mississippi State Department of Health or certification from a registered professional engineer that the platted lots should support individual onsite wastewater disposal systems.



Individual Onsite Wastewater Disposal Systems for Subdivisions Greater than 35 Lots. A determination of the feasibility of installing a central sewage collection and treatment system must be made by MDEQ. A copy of the response from MDEQ concerning the feasibility study must be attached. If a central collection and wastewater system is not feasible, then please attach a copy of the Letter of General Acceptance from the State Department of Health or certification from a registered professional engineer that the platted lots should support individual onsite wastewater disposal systems.

INDICATE ANY LOCAL STORM WATER ORDINANCE (I.E. MS4) WITH WHICH THE PROJECT MUST COMPLY:

\_\_\_\_\_  
\_\_\_\_\_

I certify under penalty of law that this document and all attachments were prepared under my direction or supervision in accordance with a system designed to assure that qualified personnel properly gathered and evaluated the information submitted. Based on my inquiry of the person or persons who manage the system, or those persons directly responsible for gathering the information, the information submitted is, to the best of my knowledge and belief, true, accurate and complete. I am aware that there are significant penalties for submitting false information, including the possibility of fine and imprisonment for knowing violations.

Signature of Applicant<sup>1</sup> (owner or prime contractor)

Date Signed

**Salem Bunkheila**

**Director of Operations**

Printed Name<sup>1</sup>

Title

<sup>1</sup>This application shall be signed as follows:

- For a corporation, by a responsible corporate officer.
- For a partnership, by a general partner.
- For a sole proprietorship, by the proprietor.

For a municipal, state or other public facility, by principal executive officer, mayor, or ranking elected official

Please submit the LCNOI form to:

Chief, Environmental Permits Division  
MS Department of Environmental Quality, Office of Pollution Control  
P.O. Box 2261  
Jackson, Mississippi 39225

Electronically:

<https://www.mdeg.ms.gov/construction-stormwater/>

Revised 3/23/22

## APPENDIX

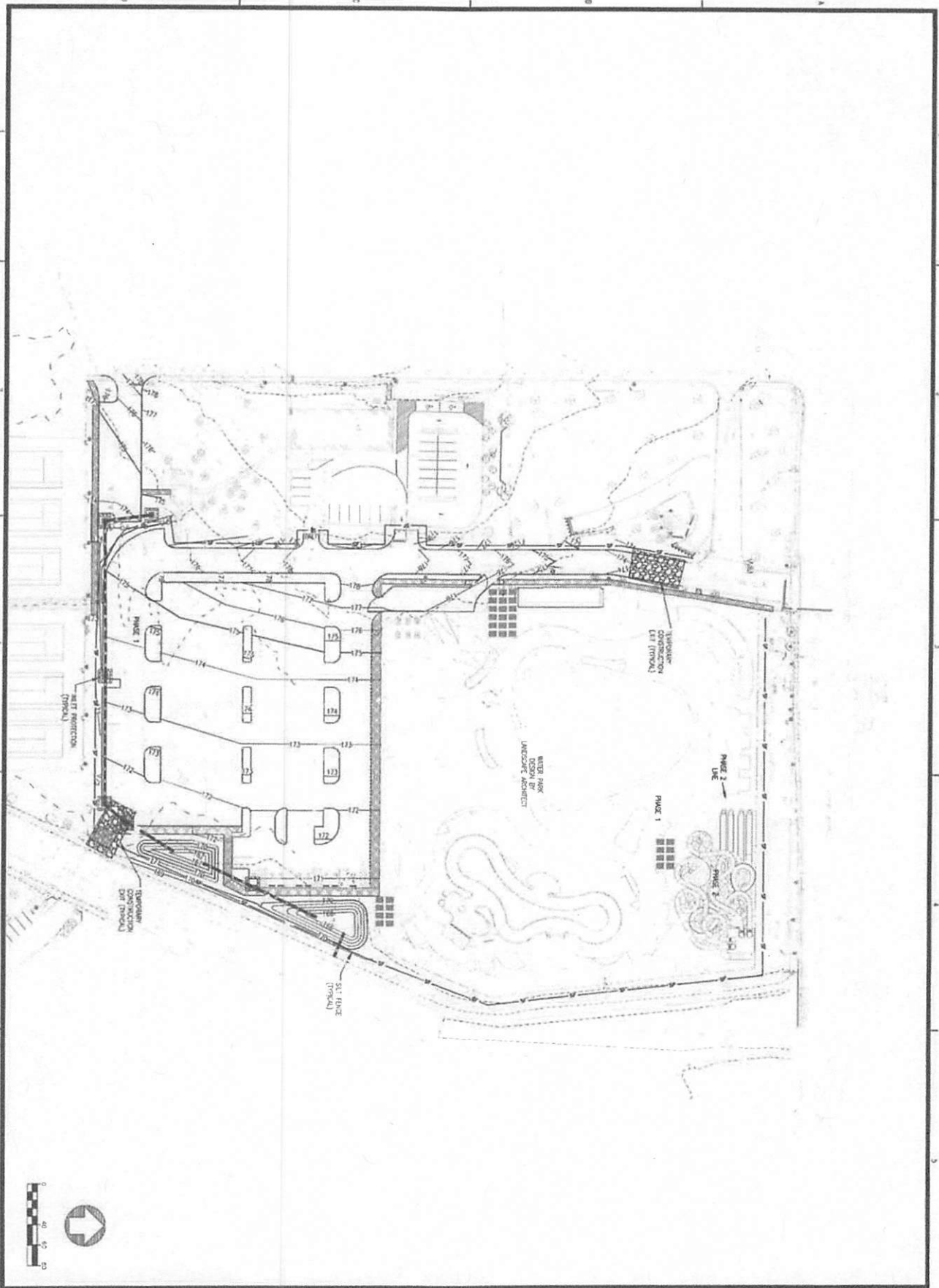

0 10 20 30 40 50 FEET 	<b>C5.0</b>	NOT FOR CONSTRUCTION FOR REVIEW ONLY	Hattiesburg Convention Commission Water Park 107 South 17th Avenue Hattiesburg, Mississippi	 <b>Pickering</b> Pickering Firm, Inc. Facility Design/Construction Engineering & Surveying Transportation • Water/Wastewater Resources 1011 Poplar Street, Suite 201 Biloxi, MS 39202 601.296.3633	SHEET # 26415.00	DATE 7-18-22	DRAWN BY SM	CHECKED BY SM	SCALE 1"=50'
					PROJECT NO. 26415	DATE 7-18-22	DRAWN BY SM	CHECKED BY SM	SCALE 1"=50'



7 EROSION CONTROL NOTES  
SCALE: NOT TO SCALE

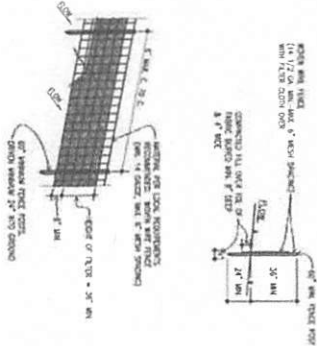
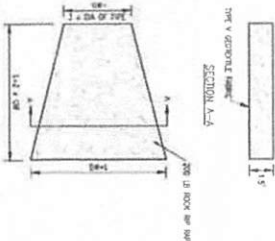

- [illegible]

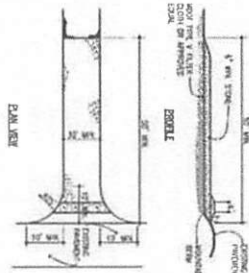

- 2 TEMPORARY CONSTRUCTION ROAD  
SCALE: NOT TO SCALE

- [illegible]

1. ALL DATA OF THE FIELD STUDY MUST BE KEPT IN A SECURE PLACE AND SHOULD BE KEPT FOR A PERIOD OF 10 YEARS.
2. THE DATA OF THE FIELD STUDY MUST BE KEPT IN A SECURE PLACE AND SHOULD BE KEPT FOR A PERIOD OF 10 YEARS.
3. THE DATA OF THE FIELD STUDY MUST BE KEPT IN A SECURE PLACE AND SHOULD BE KEPT FOR A PERIOD OF 10 YEARS.
4. THE DATA OF THE FIELD STUDY MUST BE KEPT IN A SECURE PLACE AND SHOULD BE KEPT FOR A PERIOD OF 10 YEARS.
5. THE DATA OF THE FIELD STUDY MUST BE KEPT IN A SECURE PLACE AND SHOULD BE KEPT FOR A PERIOD OF 10 YEARS.
6. THE DATA OF THE FIELD STUDY MUST BE KEPT IN A SECURE PLACE AND SHOULD BE KEPT FOR A PERIOD OF 10 YEARS.
7. THE DATA OF THE FIELD STUDY MUST BE KEPT IN A SECURE PLACE AND SHOULD BE KEPT FOR A PERIOD OF 10 YEARS.
8. THE DATA OF THE FIELD STUDY MUST BE KEPT IN A SECURE PLACE AND SHOULD BE KEPT FOR A PERIOD OF 10 YEARS.
9. THE DATA OF THE FIELD STUDY MUST BE KEPT IN A SECURE PLACE AND SHOULD BE KEPT FOR A PERIOD OF 10 YEARS.
10. THE DATA OF THE FIELD STUDY MUST BE KEPT IN A SECURE PLACE AND SHOULD BE KEPT FOR A PERIOD OF 10 YEARS.

4 SEDIMENT LOG INLET PROTECTION  
SCALE: NOT TO SCALE

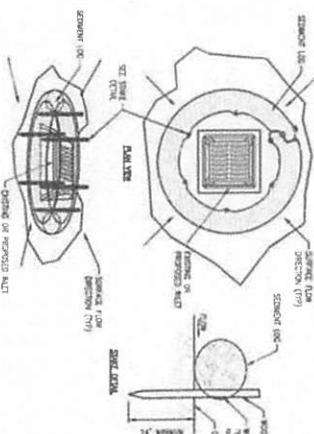

5 SEDIMENT LOG CULVERT SEDIMENT BARRIER  
SCALE N.T.S.

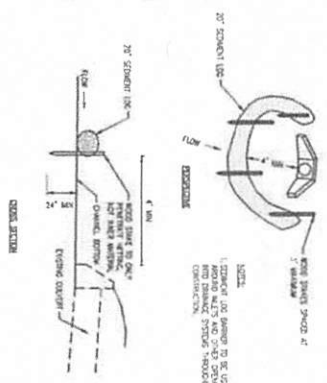

3  
SCALE: N.T.S.  
SEDIMENT LOG DITCH CHECK

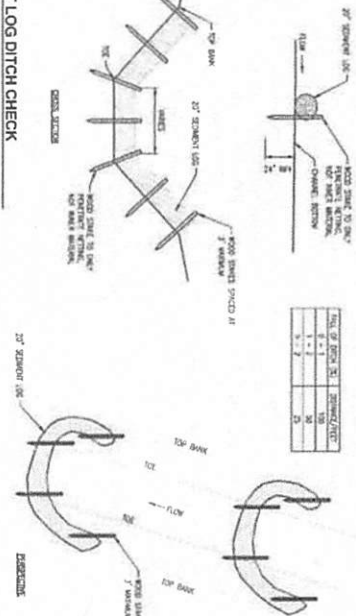

Seq. # from 25	Seq. # from 25
1	100
2	50
3	25

# STORM WATER POLLUTION PREVENTION PLAN (SWPPP)

FOR

Hattiesburg Convention Commission  
Hattiesburg Water Park

Hattiesburg, MS

July 2022

PREPARED BY:





## **TABLE OF CONTENTS**

- I. Introduction**
- II. Site Assessment**
  - A. Location**
  - B. Description of Work**
  - C. Potential Pollution Sources**
  - D. Non-Storm Water Solid Materials**
  - E. Drainage Patterns**
  - F. Soil Types**
  - G. Receiving Waters**
- III. Best Management Practices**
  - A. Design**
  - B. Spill Prevention and Response Procedures**
  - C. Operation and Maintenance**
  - D. Record Keeping**
  - E. Employee Training**
  - F. Controls for Individual Lots**
  - G. Housekeeping Practices**
- IV. Construction Sequence**
- V. Implementation Schedule**
  - A. Structural Measures**
  - B. Vegetative Measures**
- VI. Inspections and Reporting**
  - A. Inspections**
  - B. Reporting**
- VII. Revisions**
- VIII. Termination of Coverage**
- IX. Quadrangle Map**
- X. Soils Map**

### **APPENDIX**

**Large Construction Stormwater General Permit**  
**Large Construction Notice of Intent Form**  
**Erosion Control Plan Sheet**  
**Erosion Control Details Sheet**

## I. INTRODUCTION

The purpose of the Storm Water Pollution Prevention Plan (SWPPP) is to provide a site-specific description of the best management practices to prevent contamination of the storm water with potential pollutants from construction activities. The SWPPP has been prepared for **Hattiesburg Convention Commission** as required by the Mississippi Department of Environmental Quality (MDEQ) in compliance with the application regulations for coverage under the Construction Storm Water General NPDES Permit.

Pickering has developed this SWPPP to be incorporated into the routine construction activities at the proposed development. The potential sources of pollution have been identified at the site and are described in the plan. Several pollution control measures are specified in the plan to prevent contamination of storm water runoff from those sources. The plan also outlines implementation, inspection, and maintenance requirements. The erosion and sediment control practices should be monitored and the plan revised if the quality of storm water runoff is not satisfactory.

## II. SITE ASSESSMENT

- A. **Location:** The subject property is located in **Section 8, Township 4 North, Range 13 West, City of Hattiesburg, Forrest County, MS. The site physical address is 107 South 17<sup>th</sup> Avenue, Hattiesburg, MS 39401.**
- B. **Description of Work:** The construction activities will disturb **approximately 7 acres**. This project consists of clearing and grubbing, stripping and stockpiling of topsoil, placement of BMPs and erosion controls, earthwork, utility and pavement construction, and grassing of areas disturbed by such construction activities.
- C. **Potential Pollution Sources:** The most significant potential pollutants are soil particles subject to removal by storm water. Other potential pollutants subject to removal by storm water are spilled fuel and lubricants. Material may also be inadvertently tracked off-site or blown off-site when distributed by hauling equipment. The storm water which leaves the site shall meet the non-numeric limitations of being free from oil, scum, debris and other floating materials; eroded soils and other materials that will settle out of the storm water to form objectionable deposits in receiving waters; suspended solids, turbidity and color levels inconsistent with the receiving waters; chemicals in concentrations what would cause violations

of the State Water Quality Criteria in the receiving waters.

- D. **Non-Storm Water Solid Materials:** The on-site generation of solid materials will be minimal, and its proper disposal will be closely monitored. All solid waste will be taken off-site for proper disposal.  
**Prohibited Non-Storm Water Discharges:**

- (A) Wastewater from washout of concrete (unless managed by an appropriate control)
- (B) Wastewater from washout and cleanout of stucco, paint, form release oils, curing compounds and other construction materials
- (C) Fuels, oils, or other pollutants used in vehicle and equipment operation and maintenance
- (D) Soaps or solvents used in vehicle and equipment washing
- (E) Wastewater from sanitary facilities, including portable toilets

- E. **Drainage Patterns:** Most of the rainwater that falls on areas disturbed by construction activities will flow naturally into the drainage channels located on the property. Extensive measures shall be taken to protect this drain from silt and sediment contamination.

- F. **Soil Types:** The site contains primarily two different soil types according to the National Cooperative Soil Survey's Web Soil Survey:

- **Falkner-Susquehanna-Urban land complex (FsB)-** 2 to 5 percent slopes, somewhat poorly drained with medium runoff class.
- **Prentiss-Urban land complex (Pu)**

- G. **Receiving Waters:** **The nearest named tributary from the site is Gordon's Creek.**

### III. **BEST MANAGEMENT PRACTICES (BMP's)**

- A. **Design:** Below is a list of Best Management Practices that can be used to prevent the contamination of storm water. The BMP's selected for this project and their location is indicated on the attached site plan. The locations shown are not exclusive; additional BMP's may be required that are not shown on the plan. All BMP's shall conform to the specifications of the Mississippi SWPPP Guidance Manual.

- **Diversions:** Use diversions to direct runoff into sediment traps, and to minimize erosion during the construction phase.

- **Silt Fence:** Silt fences are used below disturbed areas to filter sediment from runoff. They may be placed in minor swales or ditches where the maximum contributing drainage area is no more than two acres and are not to be installed in live streams. The fence must be maintained and the sediment removed when deposits reach one-third to one-half the fence height. All sediment deposits shall be properly disposed. After the fence is no longer needed, the area should be graded, seeded, and mulched.
- **Sediment Basins:** For drainage locations (a drainage point at boundary of land disturbing activity) that serve an area with ten (10) or more disturbed acres at one time, a temporary (or permanent) sediment basin providing at least 3600 cubic feet (133 cubic yards) of storage per acre drained shall be provided until final stabilization of the site. Sediment basins must be installed before major site grading and utilize outlet structures that withdraw water from the surface and that are designed for a minimum 2-year, 24-hour storm event. Accumulated sediment shall be removed when the capacity has been reduced by 50% and the sediments shall be disposed of properly. If flocculants are being introduced, sediment basins must be downstream of the point of introduction and include baffles to increase sediment removal efficiency and turbidity reduction.
- Due to the unique characteristics of linear projects, such as the lack of space within project rights of way and having multiple, distributed discharge points, sedimentation basins are not common practices. Therefore, MDEQ will not require the use of sedimentation basins for linear projects disturbing ten (10) or more acres at one time. Appropriate alternate structural practices, such as sediment traps and check dams, must be included in the SWPPP if sediment basins are deemed infeasible.
- **Straw Wattles:** Straw Wattles are also used below small disturbed areas to capture sediment from sheet flow. The drainage area must be restricted to 1/8 acre per 100 feet of barrier. The barrier must be located so that the water depth does not exceed one foot at any point.
- **Brush Barriers:** Brush barriers can also be used to trap sediment from sheet flow from smaller drainage areas. They can form simply by stockpiling brush and small trees in the path of flow.
- **Buffer Zones:** Buffer zones of undisturbed areas will be maintained where possible to aid in the storm water filtration process, and also minimize noise and dust. Their size will vary, depending on available area.
- **Construction Entrance/Exit:** Graveled areas located at each construction entrance where vehicles enter and leave the project site will provide a

buffer for the deposition of mud and sediment. This will minimize pollution onto public roads or other off-site paved areas.

- **Dust Control:** Dust will be controlled as much as possible during construction by temporary seeding and spraying with water. The construction accesses shall be stabilized and monitored during high traffic times to minimize the dust on construction roads.
- **Grassed Waterways:** Grassed waterways can be used as a permanent control. These consist of grassed swales that direct runoff to underground drainage or detention areas as needed.
- **Seeding, Sodding, and Mulching:** **When a disturbed area will be left undisturbed for fourteen (14) days or more, the appropriate temporary or permanent vegetative practices shall be implemented immediately.** The vegetative practices should be fertilized at one half the initial rates at the beginning of the second growing season. Eroded areas should be shaped, smoothed and replanted at this time. Where practical, grassed areas should be clipped once annually. Mulching will be used at the time of permanent seeding. See the Mississippi SWPPP Guidance Manual for seeding, mulching, and fertilizing rates.
- **Tree Protection:** Efforts will be made to maintain tree buffer areas around the site as stated in the Buffer Zone section of this report. Grading around these sites will be minimal to insure the trees at these locations will remain as the buffer zone was designed.
- **Concrete Washout Facilities:** Concrete washout shall be permitted only at designated and approved locations, away from natural drains or streams. When possible, washouts should be performed at the concrete plant. Although washouts will most likely occur on site, truck backwashing is prohibited. Backwashing must be done at the concrete plant.
- **Fueling and Vehicle Maintenance Locations:** Fueling and vehicle maintenance areas shall use BMP's for industrial activities to ensure that pollutants do not impact the storm water runoff. Impervious dikes and berms shall be used to contain potential spills. Drums and containers for holding and transporting contaminated materials should be on site.
- **On-Site Burning:** Open burning will be limited to land-clearing debris from construction and will be performed in accordance with local and Mississippi air emission regulations. These regulations prohibit burning within 150 feet of a permanent residence, but permits mechanically-aided burning at a distance of 150-1500 feet from a permanent residence, and conventional burning at a distance of over 1500 feet from a permanent

residence.

- B. **Spill Prevention and Response Procedures:** If any fuel storage tanks are present on site a dike should be constructed around them in order to contain any accidental spillage. The name and number of a competent hazardous waste disposal contractor shall be posted in the office for use in the event of a spill. The site shall be kept free from the accumulation of solid waste and other good housekeeping procedures implemented.
- C. **Operation and Maintenance:** The best management practices once implemented must be maintained to ensure that satisfactory operation continues. The sediment traps and diversions should routinely have excess sediment removed. This may be required following each major storm event. This material should be stockpiled and protected from possible re-entry into the storm water until it can be used. Diversions require frequent inspection to ensure that traffic has not worn them down or that funneling waters have not washed them out. Vegetative growth on diversions must be checked frequently and action taken if the growth rate is not satisfactory.
- D. **Record Keeping:** Records shall be retained for three years of all maintenance activities, spills, and inspections, including a description of the quality and quantity of storm water.
- E. **Employee Training:** A staff meeting shall be held for the purpose of discussing the Storm Water Pollution Prevention Plan's components and goals.
- F. **Controls for Individual Lots:** After the general contractor has completed the construction of the improvements necessary for the proposed development on this site, the developer will retain responsibility for permit compliance ***unless*** the new owner of the individual lot(s):
  - a. Completes and submits the MDEQ Registration Form and develops/implements a sediment and erosion control plan for the specific lots OR
  - b. Completes and submits for approval a LCNOI and required documents, OR
  - c. Applies for an individual storm water permit.

The contractor intends to relinquish permit responsibility to the new owner and will provide the lot(s) new owner/operator with a copy of the Large Construction General Permit as well as a copy of the Registration Form. Although it is not required by MDEQ, it is recommended that the developer obtain signed documentation that these forms were given to the new lot owner(s) and that storm water responsibilities have been relinquished to



the new owner. It is then the new owner's responsibility to submit the required form(s) and to maintain the individual lot(s) according to MDEQ regulations.

G. **Housekeeping Practices:** Pollutants that may enter storm water from construction sites because of poor housekeeping include oils, grease, paints, gasoline, solvents, litter, debris, and sanitary waste. During construction activities, the contractor is required to:

- designate areas for equipment maintenance and repair
- provide waste receptacles at convenient locations and provide regular collection of waste
- provide protected storage areas for chemicals, paints, solvents, fertilizers, and other potentially toxic materials
- provide adequately maintained sanitary facilities

#### IV. CONSTRUCTION SEQUENCE

Below is a general construction sequence for projects of this nature. Not all of these items may be applicable to this project. This sequence may vary depending on the sequence of letting bids, contracting, etc. Updating construction activities can be submitted to MDEQ if needed.

1. Obtain plan approval and all other permits as needed.
2. Have a pre-construction conference to review all needed BMP's.
3. Install any construction entrances as needed and shown on the plans.
4. Install any sediment controls and sediment basins as needed. Brush barriers will be utilized when possible.
5. Perform weekly reviews of sediment, erosion, and sediment practices to insure compliance with the SWPPP. Inspection reports will be kept on site with an updated SWPPP.
6. Begin site work.
7. As site is cleared, maintain BMP's as needed to insure minimal erosion and sedimentation problems.
8. Perform any temporary seeding as needed and instructed throughout the construction process.
9. Final site works including all utilities, paving, etc.
10. Final grading, seeding, sodding, mulching, and fertilizing.
11. Removal of any temporary measures.
12. Final landscape and maintenance of existing facilities.

#### V. IMPLEMENTATION SCHEDULE

A. **Structural Measures:** The non-existing structural measures shall be

installed as the weather permits, and the existing measures shall be re-conditioned as well. General implementation principles are:

- install downslope and perimeter controls before other site work
- build sediment basins before major site grading if 10 or more acres to single drainage point
- divert upslope water around area before major site grading
- do not disturb an area until it is necessary
- time construction activities to limit impact from seasonal weather
- cover or stabilize disturbed area as soon as possible
- do not remove temporary controls until after site stabilization

- B. **Vegetative Measures:** Vegetative plantings will be performed in accordance with the planting and seeding schedule found in the Mississippi SWPPP Guidance Manual. Structural measures shall be grassed during the first open planting season after completion. Construction should be scheduled in order that unvegetated exposure is minimized.

The Storm Water Construction General Permit requires the coverage recipient to display proof of coverage. The information contained on this form must be completed and displayed at a place on site that is accessible to the public. This form must be laminated. A copy of this form is provided in the Appendix.

## **VI. INSPECTIONS AND REPORTING**

- A. **Inspections:** Inspections of the best management practices and other storm water pollution prevention plan requirements shall be performed as follows:

1. At least once every week, minimum 4 inspections per month.
2. Within 24 hours after commencement of a rainfall event that produces a discharge.
3. As often as necessary to ensure that appropriate erosion and sediment controls have been properly constructed and maintained.

The minimum inspection requirement in no way relieves the permittee of performing whatever inspections are needed to insure safe and pollution free facility operation. A copy of an inspection report is provided in the Appendix.

- B. **Reporting:** The contractor must inspect, as described in above section, and maintain controls and prepare monthly reports noting damages or deficiencies and corrective measures. These inspection reports are kept on-site until the Notice of Termination (NOT) form is submitted. At that

time these inspection reports will be submitted along with the NOT form to the Office of Pollution Control, Department of Environmental Quality, P. O. Box 10385, Jackson, MS 39289-0385, using the form provided in Part VIII of the permit.

As previously stated, all records, reports, and information resulting from activities required by this plan and the permit shall be retained for at least three years from the date of the CNOI, inspection or report.

A rain gauge shall be placed in a central location on the site and used to obtain rainfall amounts. This information will be needed for proper completion of the inspection report.

## **VII. REVISIONS**

The storm water pollution prevention plan will be kept current by the contractor and will be revised as changes in site conditions warrant. Factors that would compel the SWPPP to be modified include:

- Inadequacies revealed by routine inspections.
- Changes in identified sources, non-storm water discharges, or non-storm water solid wastes.
- Office of Pollution Control notification that the plan does not meet one or more of the minimum requirements.

A plan revision will be completed within 30 days of the date if determined that a revision is warranted. If the modification is in response to a request by the Office of Pollution Control, the permittee must submit to the OPC certification that the requested changes have been made.

## **VIII. TERMINATION OF COVERAGE**

Upon successful completion of all permanent erosion and sediment controls, the Office of Pollution Control Permit Board must be notified by submission of a Notice of Termination (NOT) form. The NOT form must be fully completed by both the owner and operator and include original signatures of both parties. Upon receiving the completed NOT the OPC will inspect the site. If no sediment and/or erosion control issues are identified, a letter will be sent to both owner and operator stating the permit has been terminated. At this point, the permitted parties are relieved of their responsibility. A copy of the NOT form is provided in the Appendix.

**IX. QUADRANGLE MAP**



**Pickering**

Pickering Firm, Inc.  
 Facility Design • Civil Engineering • Surveying •  
 Transportation • Natural / Water Resources  
 2001 Airport Road, Suite 201  
 Flowood, MS 39232  
 601.956.3663

**Hattiesburg Convention Commission-Water Park  
 Hattiesburg, MS  
 Quad Map**

SCALE  
 1"=2000'

DATE  
 JULY 2022

PROJECT #  
 26435.00



X. SOILS MAP



Area of Interest (AOI)

Soil Map

Soil Data Explorer

Download Soils Data

Shopping Cart (Free)

Search

Map Unit Legend

Forrest County, Mississippi (MS035)

Forrest County, Mississippi (MS035)

Map Unit Symbol	Map Unit Name	Acres in AOI	Percent of AOI
FsB	Falkner-Susquehanna-Urban land complex, 2 to 5 percent slopes	1.7	12.8%
Pu	Prentiss-Urban land complex	11.6	87.2%
<b>Totals for Area of Interest</b>		<b>13.3</b>	<b>100.0%</b>

Soil Map

Scale 1:1,500 ± 1 %







MISSISSIPPI DEPARTMENT OF  
ENVIRONMENTAL QUALITY

**LARGE CONSTRUCTION NOTICE OF INTENT (LCNOI)  
FOR COVERAGE UNDER THE LARGE CONSTRUCTION  
STORM WATER GENERAL NPDES PERMIT**

**INSTRUCTIONS**

The Large Construction Notice of Intent (LCNOI) is for coverage under the Large Construction General Permit for land disturbing activities of five (5) acres or greater; or for land disturbing activities, which are part of a larger common plan of development or sale that are initially less than five (5) acres but will ultimately disturb five (5) or more acres. Applicant must be the owner or operator. For construction activities, the operator is typically the prime contractor. The owner(s) of the property and the prime contractor associated with regulated construction activity on the property have joint and severable responsibility for compliance with the Large Construction Storm Water General Permit MSR10.

If the company seeking coverage is a corporation, a limited liability company, a partnership, or a business trust, attach proof of its registration with the Mississippi Secretary of State and/or its Certificate of Good Standing. This registration or Certificate of Good Standing must be dated within twelve (12) months of the date of the submittal of this coverage form. Coverage will be issued in the company name as it is registered with the Mississippi Secretary of State.

Completed LCNOIs should be filed at least thirty (30) days prior to the commencement of construction. Discharge of storm water from large construction activities without written notification of coverage is a violation of state law.

Submittals with this LCNOI must include:

- A site-specific Storm Water Pollution Prevention Plan (SWPPP) developed in accordance with ACT5 of the General Permit
- A detailed site-specific scaled drawing showing the property layout and the features outlined in ACT5 of the General Permit
- A United States Geological Survey (USGS) quadrangle map or photocopy, extending at least one-half mile beyond the facility property boundaries with the site location and outfalls outlined or highlighted. The name of the quadrangle map must be shown on all copies. Quadrangle maps can be obtained from the MDEQ, Office of Geology at 601-961-5523.

Additional submittals may include the following, if applicable:

- Appropriate Section 404 documentation from U.S. Army Corps of Engineers
- Appropriate documentation concerning future disposal of sanitary sewage and sewage collection system construction
- Appropriate documentation from the MDEQ Office of Land & Water concerning dam construction and low flow requirements
- Approval from County Utility Authority in Hancock, Harrison, Jackson, Pearl River and Stone Counties
- Antidegradation report for disturbance within Waters of the State

**ALL QUESTIONS MUST BE ANSWERED (Answer "NA" if the question is not applicable)**