



APAC - Mississippi, Inc.
A CRH Company

Post Office Box 24508
Jackson, MS 39225-4508
Tel: (601) 376-4000
Fax: (601) 376-4099

February 27, 2024

Ms. Ivelina Pilgrim
Environmental Permits Division
Office of Pollution Control
MS Department of Environmental Quality
P.O. Box 2261
Jackson, MS 39225

RE: APAC-Mississippi, Inc.
Modification to Greenville, MS Asphalt Plant
Permit # MSR700052

Dear Ms. Pilgrim,

APAC-Mississippi, Inc. was recently awarded a MDOT contract on the Greenville Bypass in Washington County, MS. This contract requires that a percentage of the asphalt mix be a Stone Matrix Asphalt (SMA) mixture which is a more durable mix that resist rutting. This SMA allows more stone-on-stone contact which requires a higher asphalt binder and mineral filler (fly ash) content along with the use of cellulose fibers. The mineral filler and cellulose fiber fill the voids between the stone-on-stone contact and keeps the asphalt binder in place. The use of these materials will require a modification of the above referenced asphalt plant.

The additional mineral filler (fly ash) will be introduced into the plant by use of a portable silo similar to the existing hydrated lime silo at the plant. The fly ash will be transported by enclosed auger and enter the mixing chamber at the same location as the baghouse fines. This fly ash silo does contain a separate baghouse.

Enclosed you will find the HMANOI and Change Request Forms along with the required public notice and contiguous landowner notification information. Also, you will find a specification sheet that details the components of the fly ash silo that will be installed.

If you need any additional information or have questions related to this request, you may call me at (601)-376-4000.

Sincerely,

APAC-Mississippi, Inc.

Brian Moore
Environmental Manager



MISSISSIPPI DEPARTMENT OF ENVIRONMENTAL QUALITY

HOT MIX ASPHALT NOTICE OF INTENT FORM

COVERAGE NO.: MSR70 0 0 5 2(Coverage number is located at the bottom left corner of your previous Certificate of Coverage.
Leave blank if applying for new coverage.)

MISSISSIPPI DEPARTMENT OF ENVIRONMENTAL QUALITY

COVERAGE ACTION REQUESTED

 New Recoverage Modification**If submitting a modification, include the Change Request Form available at www.mdeq.ms.gov/hmagp.

FACILITY INFORMATION

Company Name: APAC-Mississippi, Inc. Facility Name: Greenville Asphalt PlantContact Name: Brian Moore Contact Title: Environmental ManagerContact Phone: 601-376-4000 Contact Email: brian.moore@apac.comPhysical Site Address: Street: 2559 Harbor Front RoadCity: Greenville State: MS Zip: 38701Mailing Address: Street: P.O. Box 24508City: Jackson State: MS Zip: 39225

GPS Coordinates at Plant Entrance

GPS Coordinates (Degrees/Minutes/Seconds): Latitude: N33.36149 Longitude: W91.10889Collection Method (e.g., GPS, Google Earth, etc.): Google Earth

ASPHALT PLANT INFORMATION

Type of Asphalt Plant: Batch Drum Maximum Asphalt Production Rate: 350 tons/hr
(Maximum production rate should be based on the manufacturer's maximum rated plant capacity, on an hourly basis.)Manufactured Date of Asphalt Plant: 1997 Date plant was last relocated: N/A
(If a New Plant, enter "N/A" for manufactured date, date of last relocation, date of testing, etc.)Date of Most Recent Particulate Matter (PM) Stack Test on Asphalt Plant: 4/21/2022Is the Asphalt Plant currently at the site? YES NO If No, what date was it removed? _____ N/AAsphalt Dryer Rated Capacity: 120 MMBtu/hrDryer Fuels Used: Natural Gas LPG Fuel Oil On-Spec Used Oil Bio-derived Liquid
(Mark all applicable fuels which may be burned.)

ROCK / RECYCLED ASPHALT PAVEMENT (RAP) CRUSHER INFORMATION

Do you own or operate a rock or RAP crusher at the site? YES NO
(If YES, complete the remainder of this section. If only a third party will own/operate a rock/RAP crusher at your site, mark NO. The third party is responsible for obtaining any necessary air permits to operate the rock crusher.)Will crushed material be provided to a plant other than the co-located HMA plant? YES NO

ROCK / RECYCLED ASPHALT PAVEMENT (RAP) CRUSHER INFORMATION (continued)

Crusher Type & Rated Cumulative Capacity: Fixed: 30-40 tons/hr Portable: _____ tons/hr
 Date Rock/RAP Crusher Manufactured: 1997
 Date of modification/reconstruction of Rock/RAP Crusher: _____ N/A
 Is Rock/RAP Crusher controlled by a baghouse or fabric filter? YES NO
 Date of most recent Particulate Matter (PM) stack test on Rock/RAP Crusher: _____ or N/A
 Date of most recent Opacity (Method 9) Evaluation on Crusher and Transfer Points: 4/21/2022 or N/A

OTHER AIR EMISSION SOURCES

Will you operate stationary emergency engines or "nonroad engines" subject to ACT3 Condition L-7 or L-8 of the HMAGP? YES NO (If YES, complete the section below for each engine)
 (Note that stationary non-emergency engines are not allowed under this General Permit.)
 Number of emergency engines: _____ Number of nonroad engines: _____
 Type: Stationary Nonroad Fuel: _____ hp Mfd. Date: _____
 Type: Stationary Nonroad Fuel: _____ hp Mfd. Date: _____
 Type: Stationary Nonroad Fuel: _____ hp Mfd. Date: _____
 Will you operate a "gasoline dispensing facility" (see ACT6 of HMAGP for definition)? YES NO

STORMWATER FROM INDUSTRIAL AND CONSTRUCTION ACTIVITIES

Nearest named waterbody which stormwater leaving the site will enter: Lake Ferguson
 Is a copy of the SWPPP attached? YES NO If no, last Revision Date: 1/10/2024
 (A copy of the SWPPP must be attached for a New HMA plant.)
 If the SWPPP is based on the Industry Generic SWPPP, is it the most recent copy? YES NO N/A
 Does the SWPPP meet the requirements of ACT4 of the HMAGP? YES NO
 (If NO, an amended SWPPP must be submitted before the NOI can be processed.)
 Are construction activities (e.g., clearing, grading, etc.) required or ongoing at the site? YES NO
 If YES, does the total acreage of the construction activities equal or exceed 5.0 acres? YES NO

I certify under penalty of law that this document and all attachments were prepared under my direction or supervision in accordance with a system designed to assure that qualified personnel properly gathered and evaluated the information submitted. Based on my inquiry of the person or persons who manage the system, or those persons directly responsible for gathering the information, the information submitted is, to the best of my knowledge and belief, true, accurate and complete. I am aware that there are significant penalties for submitting false information, including the possibility of fines and imprisonment for knowing violations.

I further certify that the project continues as described in the original notice of intent. Also, I certify that I understand when coverage is terminated I am no longer authorized to emit regulated air emissions and discharge wastewater or storm water associated with industrial activity under this general permit. I understand that discharging pollutants associated with industrial activity to waters of the state without NPDES coverage is in violation of state law.

B. Moore
 Authorized Signature (shall be signed according to ACT5, T-5 of the GP) 2/26/24
 Date Signed
 Brian Moore Environmental Manager (601)-376-4000
 Printed Name Title Phone
 P.O. Box 24508, Jackson, MS 39225 brian.moore@apac.com
 Address Email



CHANGE REQUEST FORM

HOT MIX ASPHALT GENERAL PERMIT (HMAGP)



COVERAGE NUMBER MSR70 0 0 5 2

Instructions: For the following changes, notification must be provided to the DEQ at least 30 days prior to the change:

- **Part A – Any planned changes in facility operations, including removal of the hot mix plant or rock/RAP crusher, that may affect air emissions and/or water discharges.**
- **Part B – Any planned changes of ownership.**
- **Part C – Any changes in information previously submitted in the NOI or Recoverage Form.**

Complete each Part of the Form, marking "N/A" if the section does not apply to the change requested.

Company Name: APAC-Mississippi, Inc. Facility Name: APAC-Mississippi, Inc.- Greenville Asphalt Plant
 Facility Street Address: 2559 Harbor Front Road City: Greenville County: Washington
 Contact Person: Brian Moore Phone No.: 601-376-4000 Email: brian.moore@apac.com
 Mailing Address: P.O. Box 24508 City: Jackson State: MS Zip: 39225

PART A – CHANGE TO FACILITY OPERATIONS YES N/A

1. Is the change a Major Modification (defined in ACT 6, Condition T-15)? YES NO
 - a. If yes to 1, have you completed the public notice requirements in ACT 2, Condition S-3? (See Public Notice Instructions for more information.) YES NO
 - b. If yes to 1, have you notified the contiguous landowners per ACT 2, Condition S-2? YES NO
2. Will the change result in additional outfalls? YES NO
 - a. If yes to 2, is a revised SWPPP attached? YES NO
3. Does the change result in removal of the hot mix asphalt plant or rock/RAP crusher? YES NO
 - a. If yes to 3, indicate equipment being removed: _____

For all changes to facility operations, update the most recent version of the NOI or Recoverage Form, as needed, and attach it to this Form. Changes should also be outlined in a cover letter accompanying this form.

PART B – CHANGE OF OWNERSHIP YES N/A

Is the Request for Transfer Form complete and attached? YES NO

PART C – CHANGE OF INFORMATION PREVIOUSLY SUBMITTED YES N/A

Is the revised NOI or Recoverage Form attached reflecting any changes? YES NO

The most recent NOI or Recoverage Form should be revised and completed in its entirety, with any updates made as needed to reflect changes to the facility. Changes should also be outlined in a cover letter accompanying this form.

"I certify under penalty of law that this report is true, accurate, and complete, to the best of my knowledge and belief."

Brian Moore 2/16/24
 Authorized Signature of Responsible Official* Date
Brian Moore Environmental Manager
 Printed Name Title

* A responsible official must meet the requirements of 2022 HMAGP, ACT 5, Condition T-5.

Agostinelli, Nicholas (APAC)

From: Agostinelli, Nicholas (APAC)
Sent: Monday, February 26, 2024 2:37 PM
To: legals@ddtonline.com
Cc: Moore, Brian L (APAC)
Subject: APAC-Mississippi, Inc. Public Notice Greenville
Attachments: APAC-MS Greenville Public Notice.docx

Hello,

I called earlier today to see if I would be able to post the attached public notice in the Delta Democrat Times. I was told to send the public notice to this email. If you would, can you please send me a proof of publication when the notice is printed on the 6th.

Also, please let me know how you would like to receive payment for this post.

Thanks,

Colin Agostinelli
Environmental Representative
APAC Mississippi, Inc.

APAC Mississippi, Inc.
APAC-Tennessee, Inc.
101 Riverview Drive
Richland, MS 39218

O: 601-376-4000
C: 601-812-8693
E: nicholas.agostinelli@apac.com

-

www.apac-ms.com

Hot Mix Asphalt General Permit Public Notice
Mississippi Environmental Quality Permit Board
P. O. Box 2261 | Jackson, MS 39225
515 East Amite St. | Jackson, MS 39201
Telephone No. (601) 961-5171

Public Notice Start Date: 3/6/2024

APAC-Mississippi, Inc.- Greenville Asphalt Plant, located at 2559 Harbor Front Rd. in Greenville Washington County, Mississippi, (601)-376-4000 has applied to the Mississippi Department of Environmental Quality (MDEQ) for modification under MDEQ's Hot Mix Asphalt General Permit (MSR700052) to construct a fly ash storage silo as part of the existing asphalt facility.

The Hot Mix Asphalt General Permit has been developed to ensure compliance with all State and Federal regulations. Facilities granted coverage under this permit and adhering to the conditions contained therein should operate within State and Federal environmental laws and standards concerning the construction and operation of air emissions equipment and the discharge of storm water associated with industrial activities.

The proposed project consists of a major modification to the Hot Mix Asphalt facility as indicated in the Change Request Form. Under the General Permit, all Hot Mix Asphalt facilities must control emissions of particulate matter from the dryer and related silos and comply with other limitations regarding asphalt production, fuels combusted, and rock/RAP crusher operation. With these limitations, potential emissions will be below the Prevention of Significant Deterioration major source thresholds specified in the Mississippi Regulations for the Prevention of Significant Deterioration of Air Quality, 11 Miss. Admin. Code Pt. 2, Ch. 5. Potential emissions will also be below the Air Title V major source thresholds as specified in 11 Miss. Admin. Code Pt. 2, Ch. 6.

Persons wishing to comment upon or object to the proposed request for coverage are invited to submit comments in writing to the **Air 2 Branch Manager, Environmental Permits Division** at the Permit Board's address shown above or via email at www.mdeq.ms.gov/whitlock-jaricus no later than 30 days from the public notice start date. The deadline for comment shall be extending to the following calendar day should the 30-day period end on a weekend or State holiday. All comments received or postmarked by this date will be considered in the determination regarding coverage approval. After receipt of public comments and thorough consideration of all comments, MDEQ will formulate its recommendations regarding coverage approval.

Additional details about the proposed project are available by writing or calling the **Air 2 Branch Manager, Environmental Permits Division** at the above Permit Board address and telephone number. A copy of the Notice of Intent or Change Request Form and public notice are also available on the MDEQ's website at: <https://opcgis.deq.state.ms.us/ensearchonline/recently-received-general-permit-noi.aspx>. A copy of the Hot Mix Asphalt General Permit is available at www.mdeq.ms.gov/hmagp. This information is also available for review during normal business hours at the office of the MDEQ at the Permit Board address shown above. Please bring the foregoing to the attention of persons whom you know will be interested.

PORTABLE SELF ERECTING 750 BBL FILLER SILO
as per the following specifications:

1 DA-750 750 BBL Dry (Flyash) Additive System

The 750 bbl dry additive silo is designed for use with drum mix plants and can be used to store numerous additives such as hydrated lime, mineral filler, baghouse fines, granulated rubber, and others. Features include a 4" diameter fill line, loading receiver, 4" weatherproof vent, an 18" inspection port and high-low bin indicators. The silo spool is constructed with 3/16", A-36 steel, and the cone is constructed with 1/4" thick, A-36 steel plate. The cone has a 10" round discharge opening with manual shut-off valve to interrupt material flow. The 60° cone and a 2 HP aeration blower system contribute to excellent material flow from the bin. The blower package includes blower, 2 HP 1800 RPM motor, v-belt drive, filter silencer, pressure relief valve, canvas boot, eight (8) aerators, and 3/8" aerator tubing. The blower with drive is factory mounted on a small steel frame base. The silo is 11'-8" diameter.

Includes

- 1 OF.03 Ladder with harness and handrails atop silo
- 1 OF.05 Self-erect portability (Portable frame with running gear)
- 1 OF.07 Jet vent baghouse: 24 bag vent
- 1 OF.12 Mass flow weighing system (over 200 TPH)
- 1 OF.13SP 14" diameter x 24' dust auger
- 1 EO.04 PM- Electrical in power panel, cables
- 1 EO.05 Jet vent baghouse electrical
- 1 EO.10A PM 24' Dust auger electrical in power center, cables
- 1 EO.16A PM Mass flow electrical in power center, cables

Note:

The weighpot will be 50 cu ft. and the airlock will be 14" with a VFD drive. Cables are included from the Astec panel to the new components. The customer is responsible for incoming power and control wiring to our panel.

Net Price, FCA Astec, Inc. Factory:

\$202,000.00

TAS



Image Date: 2/17/24

Print Date: 2/26/24

Description: This map depicts the APAC-Mississippi, Inc. Greenville Asphalt Plant and the location of the proposed fly ash silo



APAC-Mississippi, Inc.
Greenville Asphalt Plant
2559 Harbor Front Road
Greenville, MS 38701

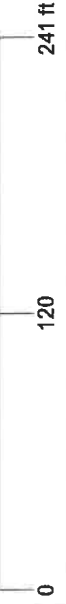

APAC-Mississippi, Inc.- Greenville Asphalt Plant

2559 Harbor Front Road, Greenville, MS 38701

	Owner	Address	Certified Mail #
1	APAC-Mississippi, Inc.	P.O. Box 24508, Jackson, MS 39225	
2	CHS Inc.	550 Cenex Drive, Inver Grove Heights, MN 55677	7022 0410 0001 7205 4942
3	Washington County	*P.O. Box 158 Greenville, MS 38702*	7022 0410 0001 7205 4928
4	Entergy Services, Inc.	P.O. Box 61000 New Orleans, LA 70161	7022 0410 0001 7205 4959
5	Nichols Marine Properties, LLC.	P.O. Box 539 Greenville, MS 38702	7022 0410 0001 7205 4935

No valid address found on Parcel Information. Letter was mailed to Washington County Board of Supervisors

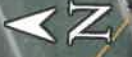

2000 ft

Google Earth

Image © 2024 Airbus

Map GIS Search

Parcel Number
629320000

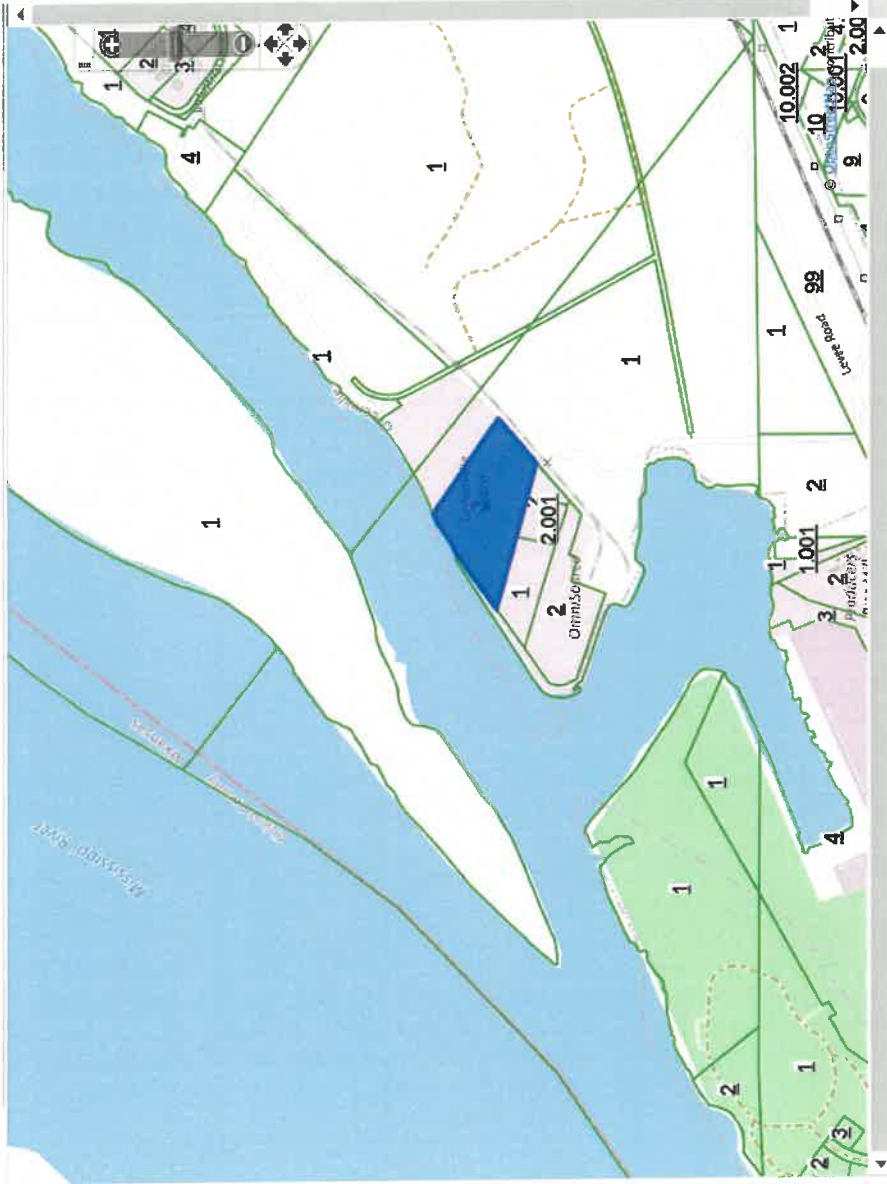

Details

Washington

Owner Name:	APAC MISSISSIPPI INC
Property Address:	2559 HARBOR FRONT RD.
Mailing Address:	2559 HARBOR FRONT RD, P O B
PPIN:	31755
Parcel Number:	629320000
Alternate Parcel Number:	07013-01-003000
Map Number:	070-13
Township-Range-Section:	18-09-13

Value

Total Value:	1300270
Improvement Value:	838570
Land Value:	461700
Total Acreage:	15.39
Tax District:	3184

Legal Description

Legal Description:	TRACT IN N PT OF 13
Deed Book:	2008
Deed Page:	441
Deed Date:	1998-6-22

Show PDF MAP Download PDF MAP

Parcel Info

Task Selection

Parcel Number
629310000

Map GIS Search

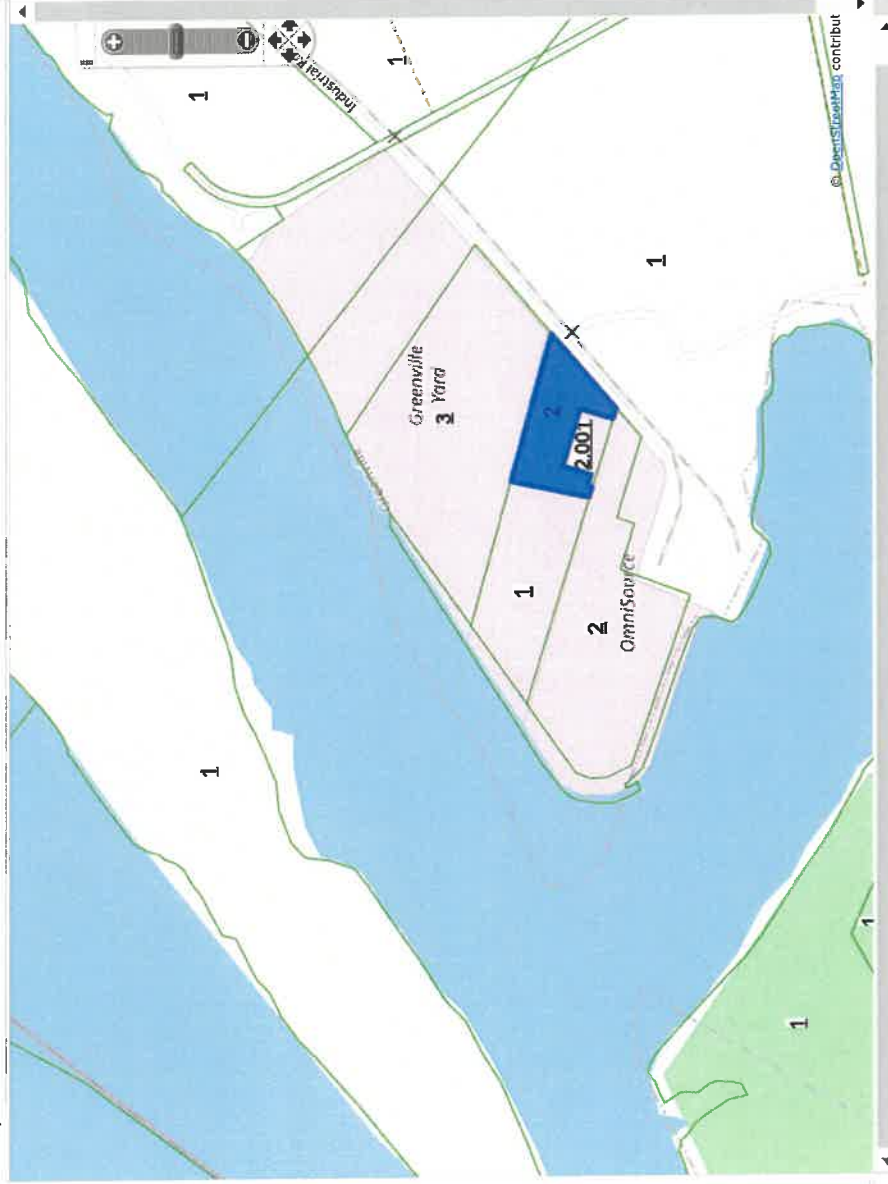

Task Selection

Details

Washington

Owner Name:	CHS INC
Property Address:	5500 CENEX DR, INVER GROVE
Mailing Address:	
PPIN:	30509
Parcel Number:	629310000
Alternate Parcel Number:	07013-01-002000
Map Number:	070-13
Township-Range-Section:	18-09-13

Value

Total Value:	2337240
Improvement Value:	2198640
Land Value:	138600
Total Acreage:	4.62
Tax District:	3184

Legal Description

Legal Description:	TRACT IN N PT	B
Deed Book:	2014	
Deed Page:	-01/721	
Deed Date:	2014-2-5	

Show PDF MAP Download PDF MAP

Parcel Info

Parcel Number
629300000

Map GIS Search

Task Selection

Details

Washington

Owner Name:	WASHINGTON COUNTY
Property Address:	CO RD 59
Mailing Address:	6810
PPIN:	629300000
Parcel Number:	07013-01-001000
Alternate Parcel Number:	070-13
Map Number:	18-09-13
Township-Range-Section:	

Value	
Total Value:	0
Improvement Value:	0
Land Value:	0
Total Acreage:	96.62
Tax District:	3184

Legal Description	
Legal Description:	PT OF SEC 13
Deed Book:	734
Deed Page:	360
Deed Date:	0-0-0

[Show PDF MAP](#) [Download PDF MAP](#)

Parcel Info

Parcel Number
629000000

Map GIS Search

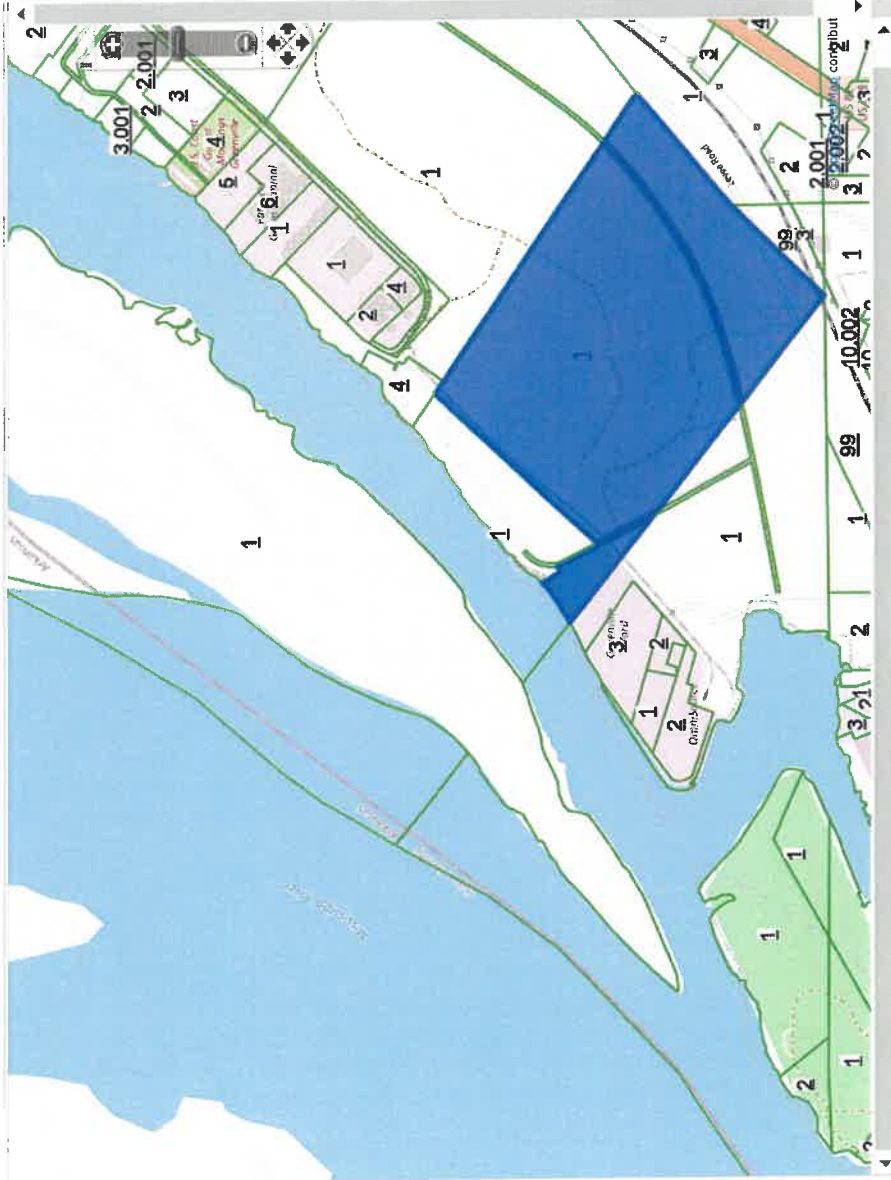

Task Selection

Details

Washington

Owner Name: WASHINGTON COUNTY
 Property Address: CO RD 59
 Mailing Address: 6806
 PPIN: 629000000
 Parcel Number: 07014-01-001000
 Alternate Parcel Number:
 Map Number: 070-14
 Township-Range-Section: 18-09-12

Value

Total Value: 0
 Improvement Value: 0
 Land Value: 0
 Total Acreage: 311.38
 Tax District: 3184

Legal Description

Legal Description: ALL SEC 12
 Deed Book: 734
 Deed Page: 358
 Deed Date: 0-0-0

Show PDF MAP Download PDF MAP

Parcel Info

Parcel Number
99900043000

Map GIS Search

Details

Washington

Owner Name: ENERGENCY SERVICES INC
 Property Address: P O BOX 61000, NEW ORLEANS, LA 70116
 Mailing Address: P O BOX 61000, NEW ORLEANS, LA 70116
 PPIN: 99900043000
 Parcel Number: 99900043000
 Alternate Parcel Number:
 Map Number:
 Township-Range-Section:

Value	
Total Value:	95430
Improvement Value:	0
Land Value:	95430
Total Acreage:	
Tax District:	1110

Legal Description

Legal Description: E 94 LOT 2 & LOTS 3 & 4
 Deed Book:
 Deed Page:
 Deed Date: 0-0-0

[Show PDF MAP](#) [Download PDF MAP](#)

Parcel Info

Task Selection

Parcel Number
99900043000

Map GIS Search

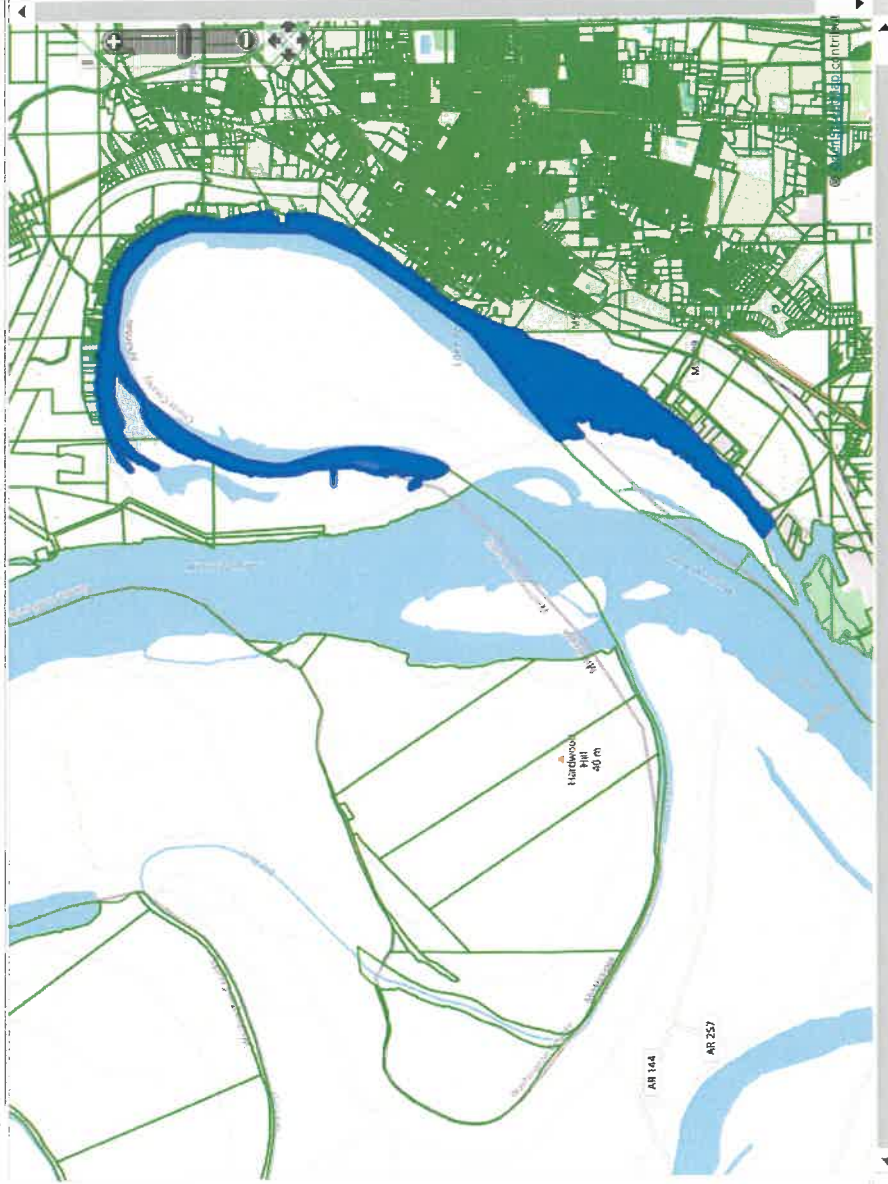

Details

Washington:

Owner Name: ENTERGY SERVICES INC
 Property Address: P O BOX 61000, NEW ORLEANS,
 Mailing Address: PPIN:
 Parcel Number: 99900043000
 Alternate Parcel Number:
 Map Number:
 Township-Range-Section:

Value:

Total Value: 95430
 Improvement Value: 0
 Land Value: 95430
 Total Acreage:
 Tax District: 1110

Legal Description

Legal Description: E 94 LOT 2 & LOTS 3 & 4
 Deed Book:
 Deed Page:
 Deed Date: 0-0-0

Show PDF MAP Download PDF MAP

Parcel Info

Task Selection

Parcel Number:
99900043000

Map GIS Search

© OpenStreetMap contributors

Task **Selection**

Details

Washington

Owner Name: ENERGY SERVICES INC

Property Address: P O BOX 61000, NEW ORLEANS, LA 70116

Mailing Address: P O BOX 61000, NEW ORLEANS, LA 70116

PPIN: 99900043000

Parcel Number: 99900043000

Alternate Parcel Number:

Map Number:

Township-Range-Section:

Value

Total Value: 95430

Improvement Value: 0

Land Value: 95430

Total Acreage:

Tax District: 1110

Legal Description

Legal Description: E 94 LOT 2 & LOTS 3 & 4

Deed Book:

Deed Page:

Deed Date: 0-0-0

Show PDF MAP Download PDF MAP

Parcel Info

Parcel Number
629010000

Map GIS Search

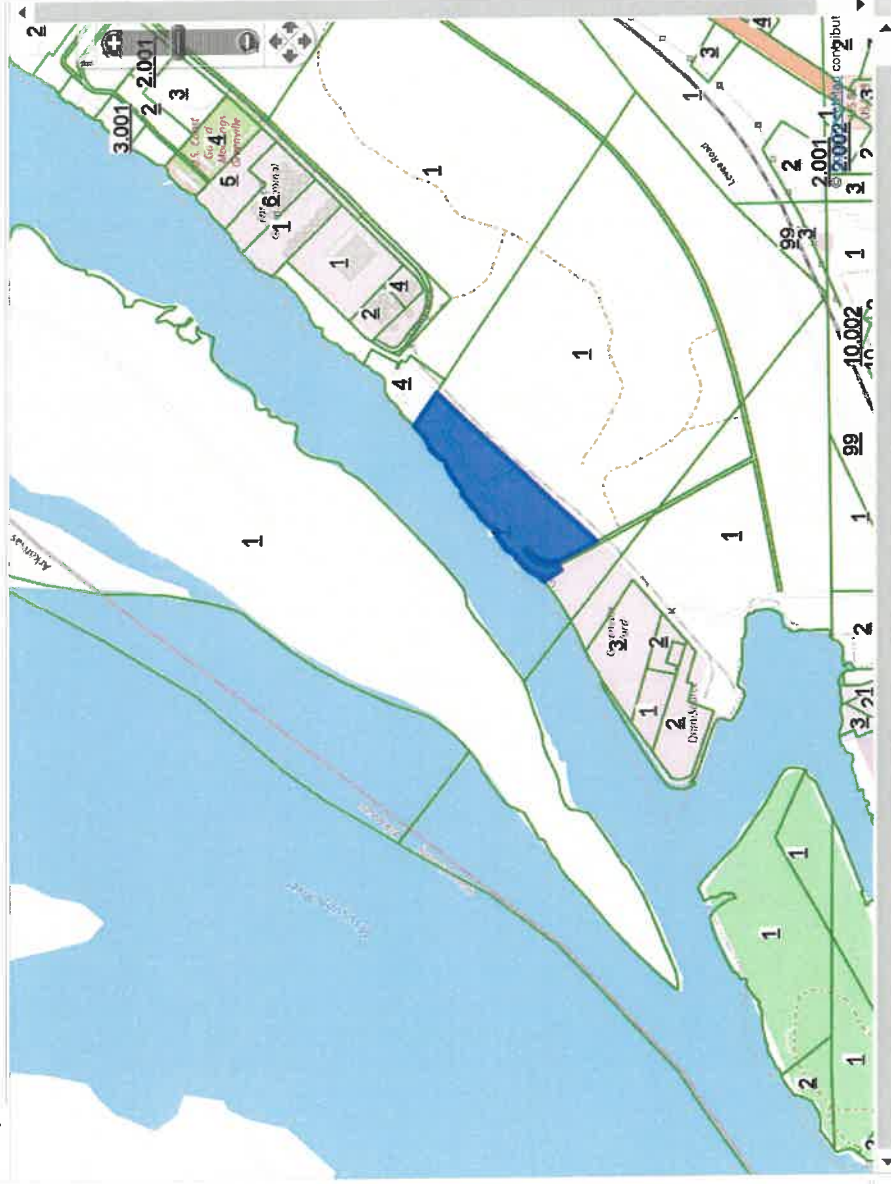

Details

Washington

Owner Name: NICHOLS MARINE PROPERTIES
 Property Address: P.O. BOX 539, GREENVILLE, MS
 Mailing Address: 36009
 PPIN: 629010000
 Parcel Number: 07009-01-001000
 Alternate Parcel Number:
 Map Number: 070-09
 Township-Range-Section: 18-09-12

Value

Total Value: 256950
 Improvement Value: 0
 Land Value: 256950
 Total Acreage: 12.3
 Tax District: 3184

Legal Description

Legal Description: TRACT W OF LEVEE
 Deed Book: 2510
 Deed Page: 13264
 Deed Date: 2009-12-21

Show PDF MAP Download PDF MAP

Parcel Info

Task Selection



Contiguous Landowner Notification of a Hot Mix Asphalt Facility



(See ACT 2, Condition S-2 of General Permit for Notification Requirements)

Certified Mail No.: 7022 0410 0001 7205 4959

Date mailed: 02-26-2024

Company Name: APAC- Mississippi, Inc.
(as registered with the MS Secretary of State)

Coverage No.: MSR70 0 0 5 2
(if currently permitted facility)

located at 2559 Harbor Front Road, Greenville, Washington County, MS
Physical Street Address City County

is proposing to:

- construct and operate a new hot mix asphalt facility.
- modify the existing hot mix asphalt facility resulting in an increase to the potential hourly asphalt production rate or rock/RAP crushing rate. *Add Fly Ash Storage Silo to existing Hot Mix Asphalt Facility for the Greenville Bypass Project*
- expand the footprint of an existing hot mix asphalt facility.
- relocate a hot mix asphalt plant or rock/RAP crusher to the existing permitted site.

This letter is to provide you notification of the proposed project and to provide you an opportunity to comment regarding environmental concerns about the project. The Mississippi Department of Environmental Quality (MDEQ) only has legal authority to consider environmental issues specified in the applicable laws and regulations. MDEQ does not have legal authority to consider matters outside of its jurisdiction; thus, comments regarding zoning, noise or traffic impacts, or other non-environmental related comments should be directed to the local zoning and planning authorities.

If you do not have environmental comments regarding the proposed project, then no response is necessary, and the permitting process will continue. If you have environmental-related comments regarding the proposed project, please notify MDEQ in writing within 30 days from the postmarked date of this notification or by the end of the 30-day public comment period, whichever is later. The online public notice of the project can be found at the following link: <https://opcgis.deq.state.ms.us/ensearchonline/recently-received-general-permit-noi.aspx>. When making written comments, please reference the Company Name and location using the information above and provide your contact phone number and address. If you would like to discuss concerns that you have regarding this project, please feel free to contact MDEQ at (601) 961-5171. Comments are to be mailed to the following address:

Chief, Environmental Permits Division
Mississippi Department of Environmental Quality
PO Box 2261
Jackson, MS 39225-2261

U.S. Postal Service™
CERTIFIED MAIL® RECEIPT
Domestic Mail Only

For delivery information, visit our website at www.usps.com®.

OFFICIAL USE

Certified Mail Fee
 \$ _____

Extra Services & Fees (check box, add fee as appropriate)

Return Receipt (hardcopy) \$ _____

Return Receipt (electronic) \$ _____

Certified Mail Restricted Delivery \$ _____

Adult Signature Required \$ _____

Adult Signature Restricted Delivery \$ _____

Postage
 \$ _____

Total
 \$ _____

Serial

Street

City

Postmark
 Here

Entergy Services, Inc.
 PO Box 61000
 New Orleans, LA 70161

PS Form 3800, April 2015 PSN 7530-02-000-9047 See Reverse for Instructions

U.S. Postal Service™
CERTIFIED MAIL® RECEIPT
Domestic Mail Only

For delivery information, visit our website at www.usps.com®.

OFFICIAL USE

Certified Mail Fee
 \$ _____

Extra Services & Fees (check box, add fee as appropriate)

Return Receipt (hardcopy) \$ _____

Return Receipt (electronic) \$ _____

Certified Mail Restricted Delivery \$ _____

Adult Signature Required \$ _____

Adult Signature Restricted Delivery \$ _____

Postage
 \$ _____

Total
 \$ _____

Serial

Street

City

Postmark
 Here

Entergy Services, Inc.
 PO Box 61000
 New Orleans, LA 70161

PS Form 3800, April 2015 PSN 7530-02-000-9047 See Reverse for Instructions

7022 0410 0001 7205 4959

SENDER: COMPLETE THIS SECTION	COMPLETE THIS SECTION ON DELIVERY
<ul style="list-style-type: none"> Complete items 1, 2, and 3. Print your name and address on the reverse so that we can return the card to you. Attach this card to the back of the mailpiece, or on the front if space permits. 	<p>A. Signature _____ <input type="checkbox"/> Agent <input checked="" type="checkbox"/> Addressee</p> <p>B. Received by (Printed Name) _____ C. Date of Delivery _____</p> <p>D. Is delivery address different from item 1? <input type="checkbox"/> Yes If YES, enter delivery address below: <input type="checkbox"/> No</p>
<p>1. Article Addressed to:</p> <p>Entergy Services, Inc. PO Box 61000 New Orleans, LA 70161</p> <p>9590 9402 8281 3094 0144 55</p> <p>2. Article Number (Transfer from service label) 7022 0410 0001 7205 4959</p>	<p>3. Service Type</p> <p><input type="checkbox"/> Adult Signature <input type="checkbox"/> Priority Mail Express®</p> <p><input type="checkbox"/> Adult Signature Restricted Delivery <input type="checkbox"/> Registered Mail™</p> <p><input type="checkbox"/> Certified Mail® <input type="checkbox"/> Registered Mail Restricted Delivery</p> <p><input type="checkbox"/> Certified Mail Restricted Delivery <input type="checkbox"/> Signature Confirmation™</p> <p><input type="checkbox"/> Collect on Delivery <input type="checkbox"/> Signature Confirmation Restricted Delivery</p> <p><input type="checkbox"/> Collect on Delivery Restricted Delivery <input type="checkbox"/> Registered Mail Restricted Delivery</p>
<p>PS Form 3811, July 2020 PSN 7530-02-000-9053</p>	<p>Domestic Return Receipt</p>



Contiguous Landowner Notification of a Hot Mix Asphalt Facility

(See ACT 2, Condition S-2 of General Permit for Notification Requirements)



Certified Mail No.: 7022 0410 0001 7205 4935

Date mailed: 02-26-2024

Company Name: APAC- Mississippi, Inc.
(as registered with the MS Secretary of State)

Coverage No.: MSR70 0 0 5 2
(if currently permitted facility)

located at 2559 Harbor Front Road, Greenville, Washington County, MS
Physical Street Address City County

is proposing to:

- construct and operate a new hot mix asphalt facility.
- modify the existing hot mix asphalt facility resulting in an increase to the potential hourly asphalt production rate or rock/RAP crushing rate. *Add Fly Ash Storage Silo to existing Hot Mix Asphalt Facility for the Greenville Bypass Project*
- expand the footprint of an existing hot mix asphalt facility.
- relocate a hot mix asphalt plant or rock/RAP crusher to the existing permitted site.

This letter is to provide you notification of the proposed project and to provide you an opportunity to comment regarding environmental concerns about the project. The Mississippi Department of Environmental Quality (MDEQ) only has legal authority to consider environmental issues specified in the applicable laws and regulations. MDEQ does not have legal authority to consider matters outside of its jurisdiction; thus, comments regarding zoning, noise or traffic impacts, or other non-environmental related comments should be directed to the local zoning and planning authorities.

If you do not have environmental comments regarding the proposed project, then no response is necessary, and the permitting process will continue. If you have environmental-related comments regarding the proposed project, please notify MDEQ in writing within 30 days from the postmarked date of this notification or by the end of the 30-day public comment period, whichever is later. The online public notice of the project can be found at the following link: <https://opcgis.deq.state.ms.us/ensearchonline/recently-received-general-permit-noi.aspx>. When making written comments, please reference the Company Name and location using the information above and provide your contact phone number and address. If you would like to discuss concerns that you have regarding this project, please feel free to contact MDEQ at (601) 961-5171. Comments are to be mailed to the following address:

Chief, Environmental Permits Division
Mississippi Department of Environmental Quality
PO Box 2261
Jackson, MS 39225-2261

U.S. Postal Service™
CERTIFIED MAIL® RECEIPT
 Domestic Mail Only

For delivery information, visit our website at www.usps.com®.

OFFICIAL USE

Certified Mail Fee

Extra Services & Fees (check box, add fee as appropriate)

Return Receipt (hardcopy) \$ _____

Return Receipt (electronic) \$ _____

Certified Mail Restricted Delivery \$ _____

Adult Signature Required \$ _____

Adult Signature Restricted Delivery \$ _____

Postage

\$ Total _____

\$ Sen _____

\$ Str _____

City _____

Nichols Marine Properties, LLC.
 PO Box 539
 Greenville, MS 38702

Postmark Here

PS Form 3800, April 2015 PSN 7530-02-000-9047 See Reverse for Instructions

7022 0410 0001 7205 4935

U.S. Postal Service™
CERTIFIED MAIL® RECEIPT
 Domestic Mail Only

For delivery information, visit our website at www.usps.com®.

OFFICIAL USE

Certified Mail Fee

Extra Services & Fees (check box, add fee as appropriate)

Return Receipt (hardcopy) \$ _____

Return Receipt (electronic) \$ _____

Certified Mail Restricted Delivery \$ _____

Adult Signature Required \$ _____

Adult Signature Restricted Delivery \$ _____

Postage

\$ Total _____

\$ Sen _____

\$ Str _____

City _____

Nichols Marine Properties, LLC.
 PO Box 539
 Greenville, MS 38702

Postmark Here

PS Form 3800, April 2015 PSN 7530-02-000-9047 See Reverse for Instructions

SENDER: COMPLETE THIS SECTION	COMPLETE THIS SECTION ON DELIVERY
<ul style="list-style-type: none"> Complete items 1, 2, and 3. Print your name and address on the reverse so that we can return the card to you. Attach this card to the back of the mailpiece, or on the front if space permits. 	<p>A. Signature <input type="checkbox"/> Agent <input type="checkbox"/> Addressee</p> <p>X</p> <p>B. Received by (Printed Name) C. Date of Delivery</p> <p>D. Is delivery address different from item 1? <input type="checkbox"/> Yes If YES, enter delivery address below: <input type="checkbox"/> No</p>
<p>1. Article Addressed to:</p> <p style="text-align: center;">Nichols Marine Properties, LLC. PO Box 539 Greenville, MS 38702</p>	<p>3. Service Type</p> <p><input type="checkbox"/> Adult Signature <input type="checkbox"/> Priority Mail Express®</p> <p><input type="checkbox"/> Adult Signature Restricted Delivery <input type="checkbox"/> Registered Mail™</p> <p><input type="checkbox"/> Certified Mail® <input type="checkbox"/> Registered Mail Restricted Delivery</p> <p><input type="checkbox"/> Certified Mail Restricted Delivery <input type="checkbox"/> Signature Confirmation™</p> <p><input type="checkbox"/> Collect on Delivery <input type="checkbox"/> Signature Confirmation Restricted Delivery</p> <p><input type="checkbox"/> Delivery Restricted Delivery <input type="checkbox"/> Restricted Delivery</p>
<p>2. Article Number (Transfer from carrier label)</p> <p style="text-align: center;">7022 0410 0001 7205 4935</p>	<p>(over \$500)</p>
<p>PS Form 3811, July 2020 PSN 7530-02-000-9053</p>	<p>Domestic Return Receipt</p>



Contiguous Landowner Notification of a Hot Mix Asphalt Facility

(See ACT 2, Condition S-2 of General Permit for Notification Requirements)



Certified Mail No.: 7022 0410 0001 7205 4928

Date mailed: 02-26-2024

Company Name: APAC- Mississippi, Inc.
(as registered with the MS Secretary of State)

Coverage No.: MSR70 0 0 5 2
(if currently permitted facility)

located at 2559 Harbor Front Road, Greenville, Washington County, MS
Physical Street Address City County

is proposing to:

- construct and operate a new hot mix asphalt facility.
- modify the existing hot mix asphalt facility resulting in an increase to the potential hourly asphalt production rate or rock/RAP crushing rate. *Add Fly Ash Storage Silo to existing Hot Mix Asphalt Facility for the Greenville Bypass Project*
- expand the footprint of an existing hot mix asphalt facility.
- relocate a hot mix asphalt plant or rock/RAP crusher to the existing permitted site.

This letter is to provide you notification of the proposed project and to provide you an opportunity to comment regarding environmental concerns about the project. The Mississippi Department of Environmental Quality (MDEQ) only has legal authority to consider environmental issues specified in the applicable laws and regulations. MDEQ does not have legal authority to consider matters outside of its jurisdiction; thus, comments regarding zoning, noise or traffic impacts, or other non-environmental related comments should be directed to the local zoning and planning authorities.

If you do not have environmental comments regarding the proposed project, then no response is necessary, and the permitting process will continue. If you have environmental-related comments regarding the proposed project, please notify MDEQ in writing within 30 days from the postmarked date of this notification or by the end of the 30-day public comment period, whichever is later. The online public notice of the project can be found at the following link: <https://opcgis.deq.state.ms.us/ensearchonline/recently-received-general-permit-noi.aspx>. When making written comments, please reference the Company Name and location using the information above and provide your contact phone number and address. If you would like to discuss concerns that you have regarding this project, please feel free to contact MDEQ at (601) 961-5171. Comments are to be mailed to the following address:

Chief, Environmental Permits Division
Mississippi Department of Environmental Quality
PO Box 2261
Jackson, MS 39225-2261

U.S. Postal Service™
CERTIFIED MAIL® RECEIPT
 Domestic Mail Only

For delivery information, visit our website at www.usps.com®.

OFFICIAL USE

Certified Mail Fee

Extra Services & Fees (check box, add fee as appropriate)

- Return Receipt (hardcopy) \$
- Return Receipt (electronic) \$
- Certified Mail Restricted Delivery \$
- Adult Signature Required \$
- Adult Signature Restricted Delivery \$

Postmark Here

Washington County
 PO Box 158
 Greenville, MS 38702

Form 3800, April 2015 PSN 7530-02-000-9047 See Reverse for Instructions

7022 0410 0001 7205 4928
 7022 0410 0001 7205 4928

U.S. Postal Service™
CERTIFIED MAIL® RECEIPT
 Domestic Mail Only

For delivery information, visit our website at www.usps.com®.

OFFICIAL USE

Certified Mail Fee

Extra Services & Fees (check box, add fee as appropriate)

- Return Receipt (hardcopy) \$
- Return Receipt (electronic) \$
- Certified Mail Restricted Delivery \$
- Adult Signature Required \$
- Adult Signature Restricted Delivery \$

Postmark Here

Washington County
 PO Box 158
 Greenville, MS 38702

PS Form 3800, April 2015 PSN 7530-02-000-9047 See Reverse for Instructions

SENDER: COMPLETE THIS SECTION

- Complete items 1, 2, and 3.
- Print your name and address on the reverse so that we can return the card to you.
- Attach this card to the back of the mailpiece, or on the front if space permits.

1. Article Addressed to:

Washington County
 PO Box 158
 Greenville, MS 38702

9590 9402 8281 3094 0144 24

2. Article Number (Transfer from service label)
 7022 0410 0001 7205 4928

PS Form 3811, July 2020 PSN 7530-02-000-9053

COMPLETE THIS SECTION ON DELIVERY

A. Signature
 X Agent
 Addressee

B. Received by (Printed Name) C. Date of Delivery

D. Is delivery address different from item 1? Yes
 If YES, enter delivery address below: No

3. Service Type

- Adult Signature
- Adult Signature Restricted Delivery
- Certified Mail®
- Certified Mail Restricted Delivery
- Collect on Delivery
- Collect on Delivery Restricted Delivery
- Mail Restricted Delivery
- Priority Mail Express®
- Registered Mail™
- Registered Mail Restricted Delivery
- Signature Confirmation™
- Signature Confirmation Restricted Delivery

Domestic Return Receipt



Contiguous Landowner Notification of a Hot Mix Asphalt Facility

(See ACT 2, Condition S-2 of General Permit for Notification Requirements)



Certified Mail No.: 7022 0410 0001 7205 4942

Date mailed: 02-26-2024

Company Name: APAC- Mississippi, Inc.
(as registered with the MS Secretary of State)

Coverage No.: MSR70 0 0 5 2
(if currently permitted facility)

located at 2559 Harbor Front Road, Greenville, Washington County, MS
Physical Street Address City County

is proposing to:

- construct and operate a new hot mix asphalt facility.
- modify the existing hot mix asphalt facility resulting in an increase to the potential hourly asphalt production rate or rock/RAP crushing rate. *Add Fly Ash Storage Silo to existing Hot Mix Asphalt Facility for the Greenville Bypass Project*
- expand the footprint of an existing hot mix asphalt facility.
- relocate a hot mix asphalt plant or rock/RAP crusher to the existing permitted site.

This letter is to provide you notification of the proposed project and to provide you an opportunity to comment regarding environmental concerns about the project. The Mississippi Department of Environmental Quality (MDEQ) only has legal authority to consider environmental issues specified in the applicable laws and regulations. MDEQ does not have legal authority to consider matters outside of its jurisdiction; thus, comments regarding zoning, noise or traffic impacts, or other non-environmental related comments should be directed to the local zoning and planning authorities.

If you do not have environmental comments regarding the proposed project, then no response is necessary, and the permitting process will continue. If you have environmental-related comments regarding the proposed project, please notify MDEQ in writing within 30 days from the postmarked date of this notification or by the end of the 30-day public comment period, whichever is later. The online public notice of the project can be found at the following link: <https://opcgis.deq.state.ms.us/ensearchonline/recently-received-general-permit-noi.aspx>. When making written comments, please reference the Company Name and location using the information above and provide your contact phone number and address. If you would like to discuss concerns that you have regarding this project, please feel free to contact MDEQ at (601) 961-5171. Comments are to be mailed to the following address:

Chief, Environmental Permits Division
Mississippi Department of Environmental Quality
PO Box 2261
Jackson, MS 39225-2261

U.S. Postal Service
CERTIFIED MAIL® RECEIPT
 Domestic Mail Only

For delivery information, visit our website at www.usps.com®.

OFFICIAL USE

Additional Mail Fee

Extra Services & Fees (check box, add fee as appropriate)

Return Receipt (hardcopy) \$ _____

Return Receipt (electronic) \$ _____

Certified Mail Restricted Delivery \$ _____

Adult Signature Required \$ _____

Adult Signature Restricted Delivery \$ _____

Postmark
Here

Postage

\$ _____

Total Postage

\$ _____

Sent To

Street Address

City, State

CHS, Inc.
 550 Cenex Drive
 Inver Grove Heights, MN. 55077

PS Form 3800, April 2015 PSN 7530-02-000-9047

See Reverse for Instructions

U.S. Postal Service™
CERTIFIED MAIL® RECEIPT
 Domestic Mail Only

For delivery information, visit our website at www.usps.com®.

OFFICIAL USE

Certified Mail Fee

Extra Services & Fees (check box, add fee as appropriate)

Return Receipt (hardcopy) \$ _____

Return Receipt (electronic) \$ _____

Certified Mail Restricted Delivery \$ _____

Adult Signature Required \$ _____

Adult Signature Restricted Delivery \$ _____

Postmark
Here

Postage

\$ _____

Total Postage

\$ _____

Sent To

Street Address

City, State

CHS, Inc.
 550 Cenex Drive
 Inver Grove Heights, MN. 55077

PS Form 3800, April 2015 PSN 7530-02-000-9047

See Reverse for Instructions

SENDER: COMPLETE THIS SECTION

- Complete items 1, 2, and 3.
- Print your name and address on the reverse so that we can return the card to you.
- Attach this card to the back of the mailpiece, or on the front if space permits.

1. Article Addressed to:

CHS, Inc.
 550 Cenex Drive
 Inver Grove Heights, MN 55077



9590 9402 8281 3094 0144 48

2. Article Number (Transfer from service label)

7022 0410 0001 7205 4942

COMPLETE THIS SECTION ON DELIVERY

A. Signature

X

Agent

Addressee

B. Received by (Printed Name)

C. Date of Delivery

D. Is delivery address different from item 1? Yes
 If YES, enter delivery address below: No

3. Service Type

- Adult Signature
- Adult Signature Restricted Delivery
- Certified Mail®
- Certified Mail Restricted Delivery
- Collect on Delivery
- Collect on Delivery Restricted Delivery

- Priority Mail Express®
- Registered Mail™
- Registered Mail Restricted Delivery
- Signature Confirmation™
- Signature Confirmation Restricted Delivery

PS Form 3811, July 2020 PSN 7530-02-000-9053

Domestic Return Receipt