

MSR32304

AI: 87292

RECEIVED
SEP 9 2024

MSR32 MDEQ

(NUMBER TO BE ASSIGNED BY STATE)

APPLICANT IS THE: OWNER OPERATOR

OWNER CONTACT INFORMATION

OWNER CONTACT PERSON: Michael Myerhoff
OWNER COMPANY LEGAL NAME: New Gen, LLC
OWNER STREET OR P. O. BOX: P.O. Box 665
OWNER CITY: Marion STATE: MS ZIP: 39342
OWNER PHONE #: (601) 482-1815 OWNER EMAIL: mm@dvdson.net

OPERATOR CONTACT INFORMATION

OPERATOR CONTACT PERSON: Michael Mayerhoff
OPERATOR COMPANY LEGAL NAME: Davidson Hauling, Inc.
OPERATOR STREET OR P. O. BOX: 989 Northeast Industrial Park Road
OPERATOR CITY: Meridian STATE: MS ZIP: 39301
OPERATOR PHONE #: (601) 934-6987 OPERATOR EMAIL: mm@dvdson.net

MINE INFORMATION

MINE NAME: Water Tower Mine
MINE SITE ADDRESS (If the physical address is not available, please indicate nearest named road.)
Street: Water Tower Road
City: Meridian State: MS County: Lauderdale Zip: 39307
NW 1 /4 OF SE 1 /4 OF SECTION 25, TOWNSHIP 7N, RANGE 16E
MINE SITE TRIBAL LAND ID (N/A If not applicable): N/A
ATTACH A USGS QUAD MAP, EXTENDING 1/2 MILE BEYOND FACILITY, OUTLINING THE MINE BOUNDARIES
(Maps can be obtained from the Mississippi Office of Geology. For information call 601-961-5523).
LATITUDE: 32 degrees 25 minutes 28 seconds LONGITUDE: 88 degrees 36 minutes 57 seconds
LAT & LONG DATA SOURCE (GPS (Please GPS Entrance Gate) or Map Interpolation): GPS
TOTAL ACREAGE: 4 MATERIAL TO BE MINED: Sand/Clay
WILL HYDRAULIC DREDGING BE USED? YES NO
WASHING OF SAND/GRAVEL? YES NO

DC

ESTIMATED START DATE: 2024-9-15

ESTIMATED END DATE: 2029-12-31

YYYY-MM-DD

YYYY-MM-DD

SIC CODE 1442

NAICS CODE 212321

RECEIVING STREAM INFORMATION

NEAREST NAMED RECEIVING STREAM: Unnamed tributary of Sowashee Creek

IS RECEIVING STREAM ON MISSISSIPPI'S 303(D) LIST OF IMPAIRED WATER BODIES? (The 303(d) list of impaired waters and TMDL stream segments may be found on MDEQ's website: http://www.deq.state.ms.us/MDEQ.nsf/page/TWB_Total_Maximum_Daily_Load_Section) YES NO

HAS A TMDL BEEN ESTABLISHED FOR THE RECEIVING STREAM SEGMENT? YES NO

COMPLETE IF STORM WATER DISCHARGE IS PROPOSED

ATTACH A STORM WATER POLLUTION PREVENTION PLAN (SEE PERMIT FOR REQUIREMENTS)

IDENTIFY THE ASSOCIATION OR GENERIC SWPPP ON FILE AT MDEQ: _____

See Attached

COMPLETE IF WASTEWATER RECIRCULATION SYSTEM WITH NO DISCHARGE IS PROPOSED

DISTANCE BETWEEN RECIRCULATION POND(S) AND PROPERTY LINE: _____ (FT)

(MUST BE AT LEAST 150 FEET)

NUMBER OF RECIRCULATION POND(S): _____

STORAGE CAPACITY OF EACH RECIRCULATION POND(S): _____ (FT³)

COMPLETE IF MINE DEWATERING IS PROPOSED

ESTIMATED DEWATERING VOLUME: _____ (GAL/DAY)

NAME AND ADDRESS OF THE RECIPIENT OF THE DISCHARGE MONITORING REPORTS (DMRs), IF DIFFERENT FROM SIGNATORY: _____

DOCUMENTATION OF COMPLIANCE WITH OTHER REGULATIONS/REQUIREMENTS

Coverage under this general permit will not be granted until all other required MDEQ permits and approvals are addressed.

WILL THE CONSTRUCTION OR OPERATION OF THIS MINE INVOLVE THE RE-ROUTING, FILLING OR CROSSING OF A WATER CONVEYANCE OF ANY KIND? YES NO

If yes, contact the U.S. Army Corps of Engineers' Regulatory Branch for permitting requirements. If the mine requires a Corps of Engineers Section 404 permit, provide appropriate documentation with this MNOI that:

- The mine has been approved by individual permit, or
- The work will be covered by a nationwide permit and NO NOTIFICATION to the Corps is required, or
- The work will be covered by a nationwide or general permit and NOTIFICATION to the Corps is required.

LIST ANY NPDES PERMIT NO(s). N/A GEOLOGY APPLICATION/PERMIT NO. Exempt Operation

LIST OTHER GEOLOGY PERMIT NUMBERS THAT APPLY TO COVERAGE AREA N/A

IS THE MINE LESS THAN 4 ACRES AND GREATER THAN 1320 FEET FROM ANOTHER MINE?

YES A "Notice of Exempt Operations" Form must be included with the MNOI or proof of prior submission, if previously submitted to the Office of Geology.

NO A "Notice of Intent to Mine Class I or Class II Materials" Form must be filed before coverage will be granted under the Mining General Permit. For information on Office of Geology requirements, call 601-961-5515.

LIST ANY LOCAL STORM WATER ORDINANCES WITH WHICH THE OPERATIONS MUST COMPLY AND SUBMIT ANY ASSOCIATED APPROVAL DOCUMENTATION. N/A

IF IMPOUNDMENTS WILL BE CONSTRUCTED ABOVE NATURAL SURFACE ELEVATIONS, INDICATE WHICH, IF ANY, OF THE FOLLOWING APPLY.

- The impoundment will be constructed with a peripheral dam or levee 8 feet or greater in height, measured from the lowest elevation of its toe.
- The impoundment will have a maximum storage volume greater than 25 acre-feet.
- The impoundment will impound a watercourse with a continuous flow.
- The impoundment has the potential to threaten downstream lives or man-made structures.

If any of the impoundments meet any of the above criteria, the applicant will be required to obtain written authorization from MDEQ, Dam Safety Division before coverage will be granted under the Mining General Permit.

I certify under penalty of law that this document and all attachments were prepared under my direction or supervision in accordance with a system designed to assure that qualified personnel properly gathered and evaluated the information submitted. Based on my inquiry of the person or persons who manage the system, or those persons directly responsible for gathering the information, the information submitted is, to the best of my knowledge and belief, true, accurate and complete. I am aware that there are significant penalties for submitting false information, including the possibility of fine and imprisonment for knowing violations.

Michael Mayerhoff
Authorized Signature

08-29-24
Date

Michael Mayerhoff
Printed Name

Vice President
Title

This application shall be signed according to the General Permit, Act 15, T-4 as follows:

- For a corporation, by a responsible corporate officer.
- For a partnership, by a general partner.
- For a sole proprietorship, by the proprietor.
- For a municipal, state or other public facility, by either a principal executive officer, the mayor, or ranking elected official.
- Duly Authorized Representative

Please submit this form to: Chief, Environmental Permits Division
MDEQ, Office of Pollution Control
P.O. Box 2261
Jackson, Mississippi 39225

Storm Water Pollution Prevention Plan

for

Non-Coal Surface Mining Operations in the

by

Davidson Hauling, Inc.

989 Northeast Industrial Park Road
Meridian, MS 39301

for

Water Tower Mine

Water Tower Road
Meridian, MS 39301

August 2024

Prepared by

Trademark Consulting of MS, LLC
9085A Pine Springs Road
Meridian, MS 39305

TABLE OF CONTENTS

Introduction.....	3
Site Description.....	3
General Requirements.....	4
Best Management Practices.....	5
Implementation Sequence.....	5
Post Construction Storm Water Management Measures.....	6
Housekeeping Practices.....	6
Implementation / Inspection.....	6
Certification.....	7
Quad Map.....	8
Mine Layout.....	9
BMP Details.....	10-15

INTRODUCTION

This document is the Storm Water Pollution Prevention Plan (SWPPP) for Non-Coal Surface Mining Operations by Davidson Hauling, Inc.. This plan is the criteria for compliance with the regulations set forth by the Environmental Protection Agency, National Pollutant Discharge Elimination System (NPDES) permit application regulations for storm water discharges regarding construction storm water.

The purpose of this SWPPP is the control and mitigation of pollution in storm water discharges associated with the non-coal surface mining operations.

SITE DESCRIPTION

This project consists of excavation necessary to create a non-coal surface mine. Proposed activities will include land clearing, topsoil stripping and storage, excavation, and finally, reclamation. Access to the mining area will be from Water Tower Road. Upon completion of excavation activities, the disturbed areas will be permanently vegetated.

Construction will disturb approximately 4 acres located in the Northwest ¼ of the Southeast ¼ of Section 26, Township 7 North, Range 16 East, Lauderdale County, Mississippi. The topography of the site is gently sloping throughout. Currently, surface runoff generally drains easterly toward an unnamed tributary of Sowashee Creek. From the Soil Survey of Lauderdale County, by the Soil Conservation Service, the majority of the existing soils appear to be LS (Sweatman Fine Sandy Loam), typically classified as a SC or SC-SM material according to the Unified Soil Classification System.

The majority of the project site described above is covered with timber. Storm water from this proposed site drains into an unnamed tributary of Sowashee Creek. **Sowashee Creek is listed on the 303(d) list for impairment as prescribed by MDEQ. However, runoff will discharge through rock filter check and discharge for mining operation must travel approximately 250' overland through heavy vegetation before entering a defined channel. Perimeter controls will further aid in eliminating potential contamination.**

Planned reclamation of this site is to slope all walls to a maximum 3:1 slope. All disturbed areas will be re-vegetated.

GENERAL REQUIREMENTS

This Storm Water Pollution Prevention Plan consists of various controls appropriate for this particular site. The purposes of these various controls shall:

- Divert upslope water around disturbed areas of the site.
- Limit the exposure of disturbed areas to the shortest time as practical.
- Minimize the amount of surface area that must be disturbed.
- Implement Best Management Practices to mitigate adverse impacts from storm water runoff.
- Remove sediment from storm water before it leaves the site using appropriate methods.

Erosion and sediment controls consisting of vegetative and structural practices shall be designed to preserve vegetation or timely revegetated, disturbed areas; divert flow from exposed soils; store flows or otherwise limit runoff from exposed areas.

Post mining measures shall include on-site infiltration, flow attenuation in vegetated swales and natural depressions. After mining is complete the area void of ground cover shall be re-vegetated. After re-vegetation is complete, temporary erosion control measures shall be removed. Velocity dissipation may be required at the outfall of swales and drainage structures to provide non-erosive flows.

BEST MANAGEMENT PRACTICES

The implementation of these practices shall begin immediately upon coverage and will be maintained through the life of this project. The controls of importance include but are not limited to:

- Installation of silt fencing.
- Construction of a settlement area within mine footprint to capture storm water and allow for settlement of solids in the event of excessive rainfall release.
- Construction of diversion berm along downslope perimeter to divert mine run-off into settlement area.
- Installation of diversion berms along upslope perimeter of mine area to divert upstream run-off around disturbed areas.
- Permanent re-vegetation shall occur after excavation to prevent erosion.

Mine operator shall implement controls to prevent erosion and adverse impacts on nearby streams and/or ponds. When work is not being performed in a disturbed area, appropriate temporary and/or vegetative and structural practices shall be initiated within seven calendar days.

IMPLEMENTATION SEQUENCE

The implementation sequence is as follows:

- Install silt fencing.
- Construct settlement area within mine footprint.
- Construct downslope diversion berm
- Construct upslope diversion berms
- Perform excavation and re-vegetate.

POST CONSTRUCTION/STORM WATER MANAGEMENT MEASURES

- Plate slopes with stockpiled topsoil and re-vegetate.
- Remove silt fencing and rock check dams after satisfactory vegetation cover is in place.

HOUSEKEEPING PRACTICES

The operator shall designate an area adjacent to the mine entrance for all equipment maintenance and repair. Runoff from this area will be directed away from natural drains and preparation will be made to remove any contaminants prior to release from subject property. Waste receptacles will be positioned as needed throughout site and be serviced on regular intervals. Adequately maintained sanitary facilities will be provided. All chemicals, solvents, fertilizers and other potentially toxic materials will be stored in enclosed storage units or off site.

IMPLEMENTATION/INSPECTION

The owner/operator of this site shall implement controls as noted above to prevent erosion and adverse impacts on the nearby creek. When a disturbed area not actively being mined will be left undisturbed for 30 days or more, the appropriate temporary or permanent vegetative practices shall be implemented within seven (7) calendar days.

All accumulated sediment shall be removed from structural controls when sediment deposits reach 1/3 to 1/2 the height of the control. All removed sediment deposits shall be properly disposed. Non-functioning controls shall be repaired, replaced or supplemented with functional controls within 24 hours of discovery or as soon as field conditions allow. Make all needed repairs within 24 hours. Maintain all vegetated areas to provide proper ground cover-reseed, fertilize and mulch as needed.

Inspections of all receiving streams (if feasible), outfalls, erosion and sediment controls, and other SWPPP requirements upon receipt of coverage and throughout permit coverage at least monthly, within 24 hours after commencement of a rainfall event equal to or greater than a 2-year, 24-hour storm event (approximately 6-inches on the Gulf Coast to 4 inches at the Mississippi-Tennessee State Line), and as necessary to ensure that erosion controls have been constructed, maintained, and function adequately to satisfy the requirements of this permit and to ensure that pollutants are not leaving the site.

These inspections should be reported in compliance with this permit. All records resulting from activities required shall be retained for a period of at least three years from the date of the inspection or report.

Within 30 days of final stabilization, a complete Request for Termination (RFT) of Coverage form shall be submitted to the Permit Board.

CERTIFICATION

I certify under penalty of law that this document and all attachments were prepared under my direction or supervision in accordance with a system designed to assure the qualified personnel properly gathered and evaluated the information submitted. Based on my inquiry of the person or persons who manage the system, or those persons directly responsible for gathering the information, the information submitted is, to the best of my knowledge and belief, true, accurate and complete. I am aware that there are significant penalties for submitting false information, including the possibility of fine and imprisonment for knowing violations.

Michael Mayhuff
Authorized Signature

8-30-24
Date

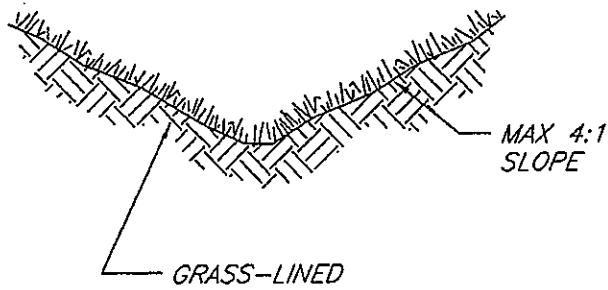

**TYPICAL V-SHAPED CHANNEL
CROSS-SECTION**

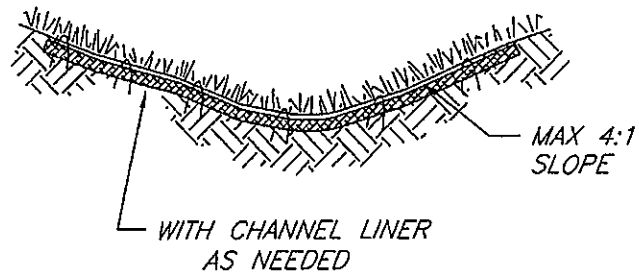

**TYPICAL PARABOLIC CHANNEL
CROSS-SECTION**

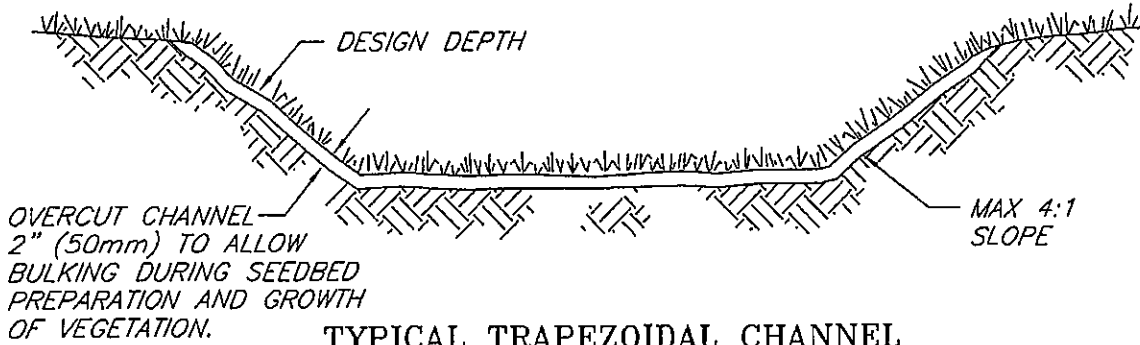

**TYPICAL TRAPEZOIDAL CHANNEL
CROSS-SECTION**

**GRASS-LINED CHANNEL
TYPICAL CROSS SECTIONS**

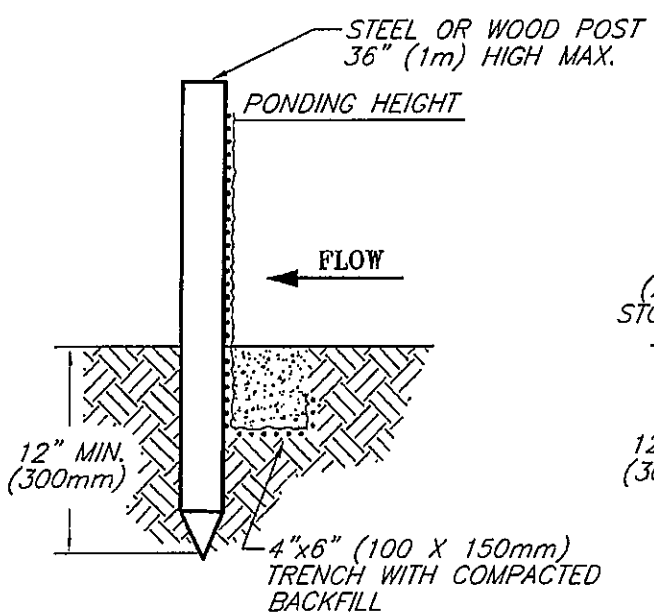
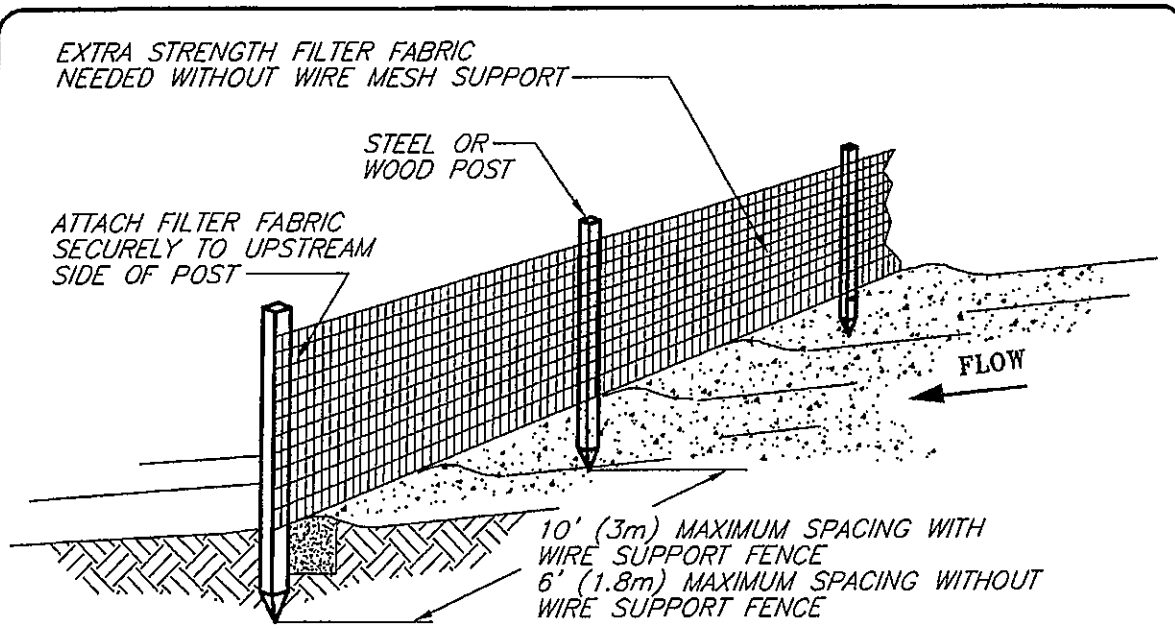

TRENCH DETAIL

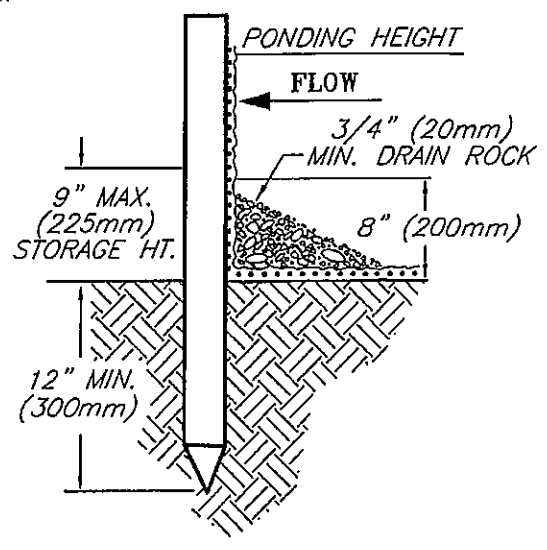

INSTALLATION WITHOUT TRENCHING

NOTES:

1. SILT FENCE SHALL BE PLACED ON SLOPE CONTOURS TO MAXIMIZE PONDING EFFICIENCY.
2. INSPECT AND REPAIR FENCE AFTER EACH STORM EVENT AND REMOVE SEDIMENT WHEN NECESSARY. 9" (225mm) MAXIMUM RECOMMENDED STORAGE HEIGHT.
3. REMOVED SEDIMENT SHALL BE DEPOSITED TO AN AREA THAT WILL NOT CONTRIBUTE SEDIMENT OFF-SITE AND CAN BE PERMANENTLY STABILIZED.

NOT TO SCALE

SILT FENCE

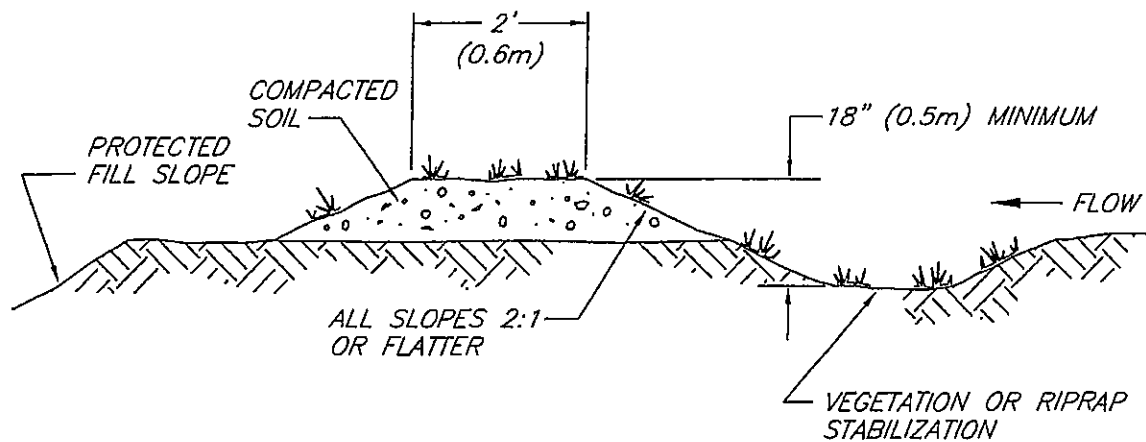

TYPICAL FILL DIVERSION

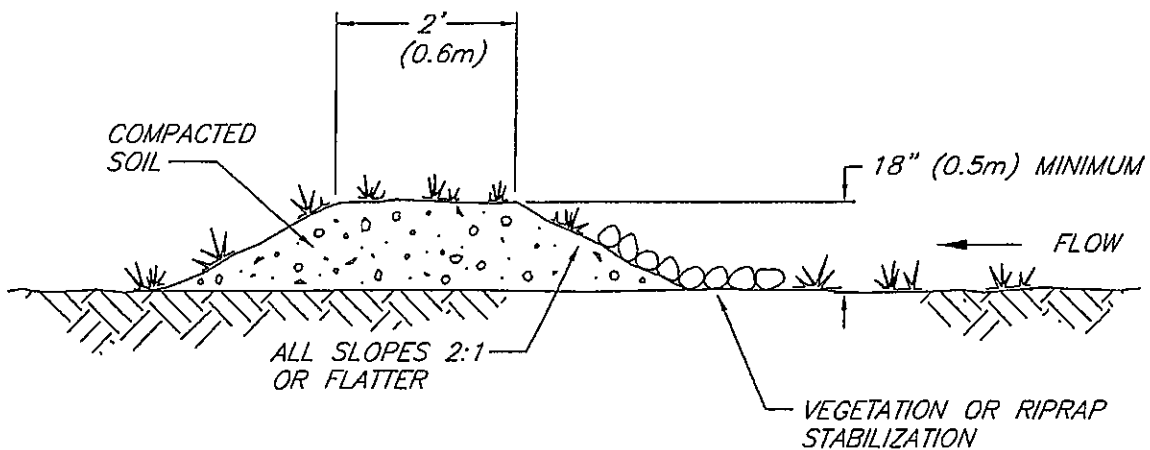

TYPICAL TEMPORARY DIVERSION DIKE

NOTES:

1. THE CHANNEL BEHIND THE DIKE SHALL HAVE POSITIVE GRADE TO A STABILIZED OUTLET.
2. THE DIKE SHALL BE ADEQUATELY COMPACTED TO PREVENT FAILURE.
3. THE DIKE SHALL BE STABILIZED WITH TEMPORARY OR PERMANENT SEEDING OR RIPRAP.

**TEMPORARY
DIVERSION DIKE**

© 1996 JOHN McCULLAH

FILE: TEMPDIKE

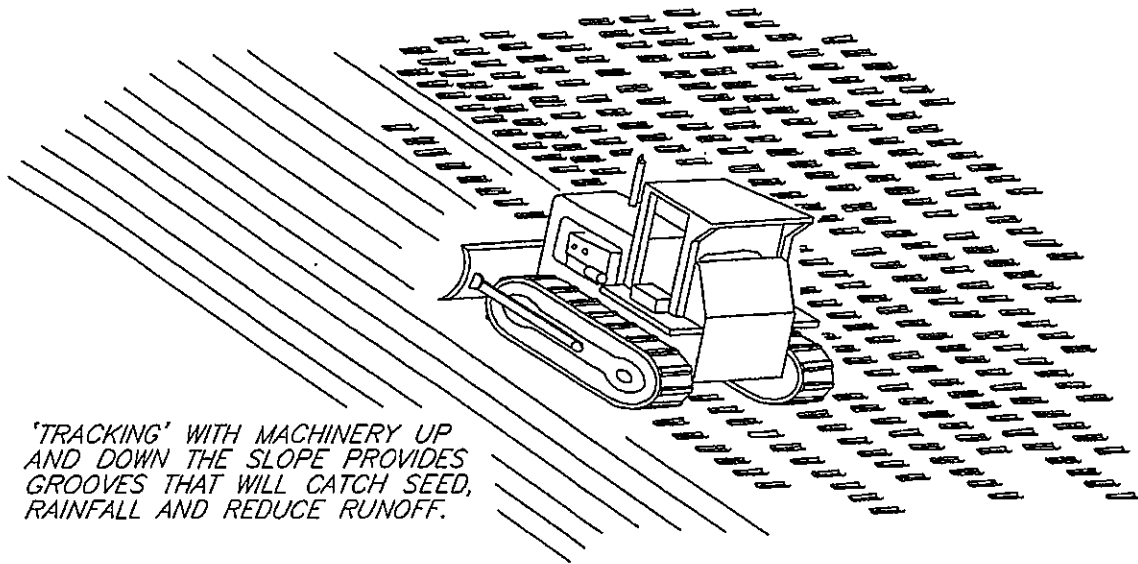

"TRACKING" WITH MACHINERY UP AND DOWN THE SLOPE PROVIDES GROOVES THAT WILL CATCH SEED, RAINFALL AND REDUCE RUNOFF.

TRACKING

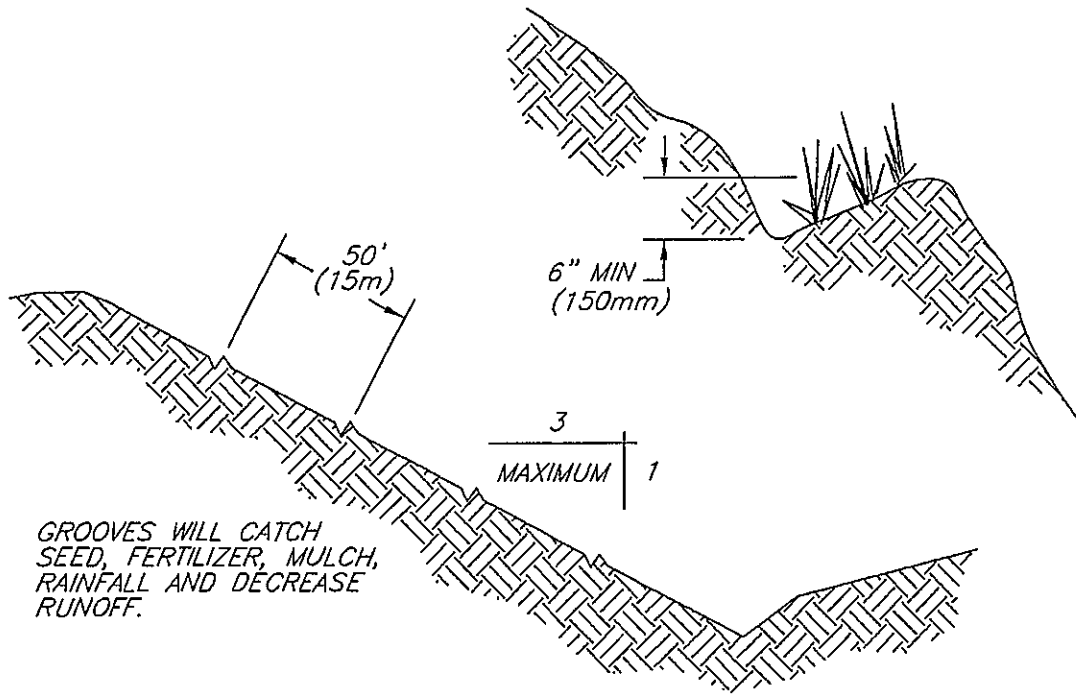

GROOVES WILL CATCH SEED, FERTILIZER, MULCH, RAINFALL AND DECREASE RUNOFF.

CONTOUR FURROWS

SURFACE ROUGHENING

DIVERSION RIDGE REQUIRED
WHERE GRADE EXCEEDS 2%

2% OR GREATER



SECTION A - A

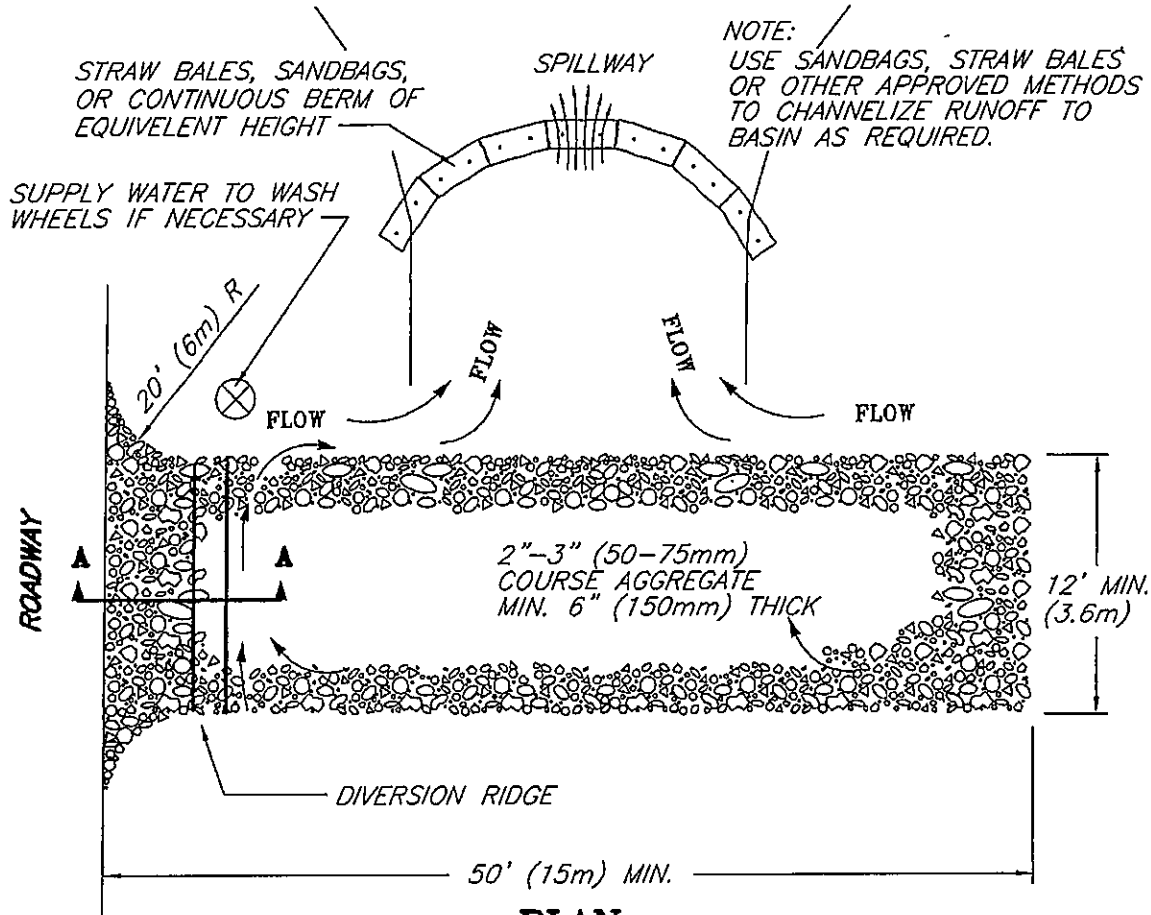

PLAN

NOTES:

1. THE ENTRANCE SHALL BE MAINTAINED IN A CONDITION THAT WILL PREVENT TRACKING OR FLOWING OF SEDIMENT ONTO PUBLIC RIGHT-OF-WAYS. THIS MAY REQUIRE TOP DRESSING, REPAIR AND/OR CLEANOUT OF ANY MEASURES USED TO TRAP SEDIMENT.
2. WHEN NECESSARY, WHEELS SHALL BE CLEANED PRIOR TO ENTRANCE ONTO PUBLIC RIGHT-OF-WAY.
3. WHEN WASHING IS REQUIRED, IT SHALL BE DONE ON AN AREA STABILIZED WITH CRUSHED STONE THAT DRAINS INTO AN APPROVED SEDIMENT TRAP OR SEDIMENT BASIN.

**TEMPORARY
GRAVEL
CONSTRUCTION
ENTRANCE/EXIT**

© 1994 JOHN McCULLAH
FILE: ENTRANCE

STATE	PROJECT NO.
MISS.	

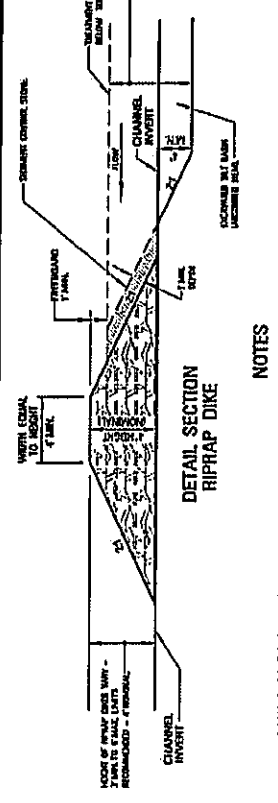
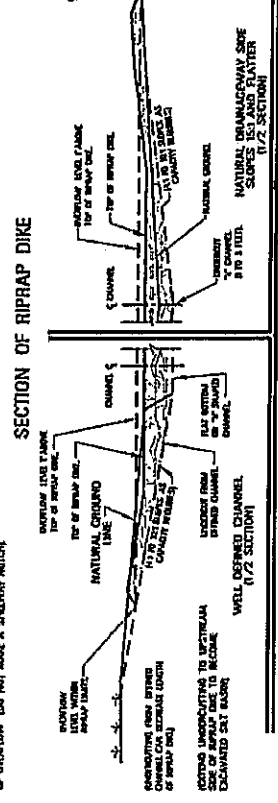
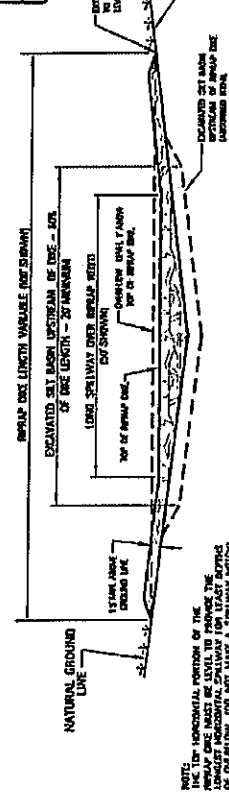

- NOTES**
1. RIPRAP DIKE SALT BARRIERS ARE TO BE PLACED BY SURFACE GRADES INCLUDING BELIEVED CROSS GRADES UNLESS OTHERWISE NOTED ON THIS SHEET. THE RIPRAP DIKE SHALL BE AS INSTALLED BY THE CONTRACTOR WHO SHALL MAINTAIN THE CROSS AND LONG GRADIENTS UNLESS OTHERWISE NOTED. THE RIPRAP DIKE SHALL BE AS INSTALLED BY THE CONTRACTOR WHO SHALL MAINTAIN THE CROSS AND LONG GRADIENTS UNLESS OTHERWISE NOTED. THE RIPRAP DIKE SHALL BE AS INSTALLED BY THE CONTRACTOR WHO SHALL MAINTAIN THE CROSS AND LONG GRADIENTS UNLESS OTHERWISE NOTED.
 2. THE REQUIRED SIZE/CAPACITY OF THE RIPRAP DIKE SALT BASIN IS TO BE DETERMINED BY THE CONTRACTOR WHO SHALL MAINTAIN THE CROSS AND LONG GRADIENTS UNLESS OTHERWISE NOTED. THE RIPRAP DIKE SHALL BE AS INSTALLED BY THE CONTRACTOR WHO SHALL MAINTAIN THE CROSS AND LONG GRADIENTS UNLESS OTHERWISE NOTED.
 3. THE CONTRACTOR SHALL BE REQUIRED TO FURNISH ALL MATERIALS AND LABOR FOR THE RIPRAP DIKE SALT BASIN. THE CONTRACTOR SHALL BE REQUIRED TO FURNISH ALL MATERIALS AND LABOR FOR THE RIPRAP DIKE SALT BASIN. THE CONTRACTOR SHALL BE REQUIRED TO FURNISH ALL MATERIALS AND LABOR FOR THE RIPRAP DIKE SALT BASIN.
 4. THE RIPRAP DIKE SALT BASIN SHALL BE CONSTRUCTED IN ACCORDANCE WITH THE REQUIREMENTS OF THE MISSISSIPPI DEPARTMENT OF TRANSPORTATION. THE RIPRAP DIKE SALT BASIN SHALL BE CONSTRUCTED IN ACCORDANCE WITH THE REQUIREMENTS OF THE MISSISSIPPI DEPARTMENT OF TRANSPORTATION.
 5. RIPRAP FOR THE TYPE B SALT BASIN SHALL BE 30" TO 48" DIAMETER AND SHALL BE PLACED ON A 4" TO 8" SAND BED.
 6. CONCRETE CONTROL STONE SHALL BE SIZE M.E.S.T. STONE AND SHALL BE PLACED IN ACCORDANCE WITH THE REQUIREMENTS OF THE MISSISSIPPI DEPARTMENT OF TRANSPORTATION.
 7. THE TEMPORARY EROSION CONTROL MEASURES SHOWN ON THIS SHEET SHALL BE MAINTAINED THROUGHOUT THE CONSTRUCTION PERIOD. THE TEMPORARY EROSION CONTROL MEASURES SHOWN ON THIS SHEET SHALL BE MAINTAINED THROUGHOUT THE CONSTRUCTION PERIOD.
 8. THE CONTRACTOR SHALL BE REQUIRED TO MAINTAIN THE CROSS AND LONG GRADIENTS UNLESS OTHERWISE NOTED. THE CONTRACTOR SHALL BE REQUIRED TO MAINTAIN THE CROSS AND LONG GRADIENTS UNLESS OTHERWISE NOTED.

MISSISSIPPI DEPARTMENT OF TRANSPORTATION	
TYPICAL TEMPORARY EROSION CONTROL MEASURES (TYPE "D" SILT BASIN) (RIPRAP DIKE SALT BASIN)	
PROJ. NO.:	
COUNTY:	
FILE NAME:	EROSION CONTROL (TYPE "D")
DATE:	

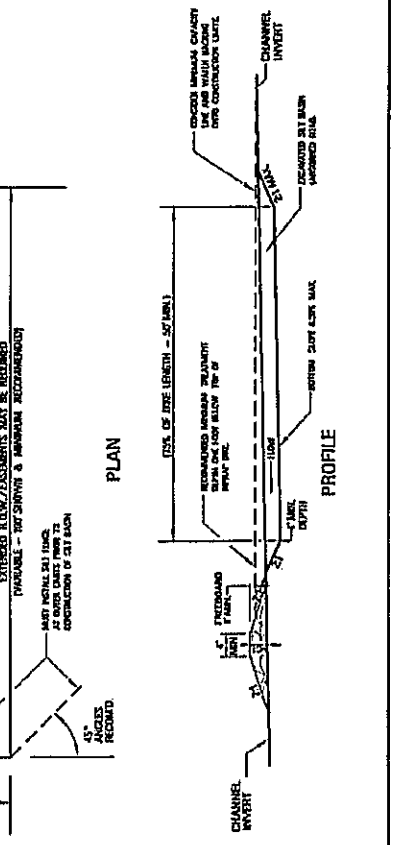
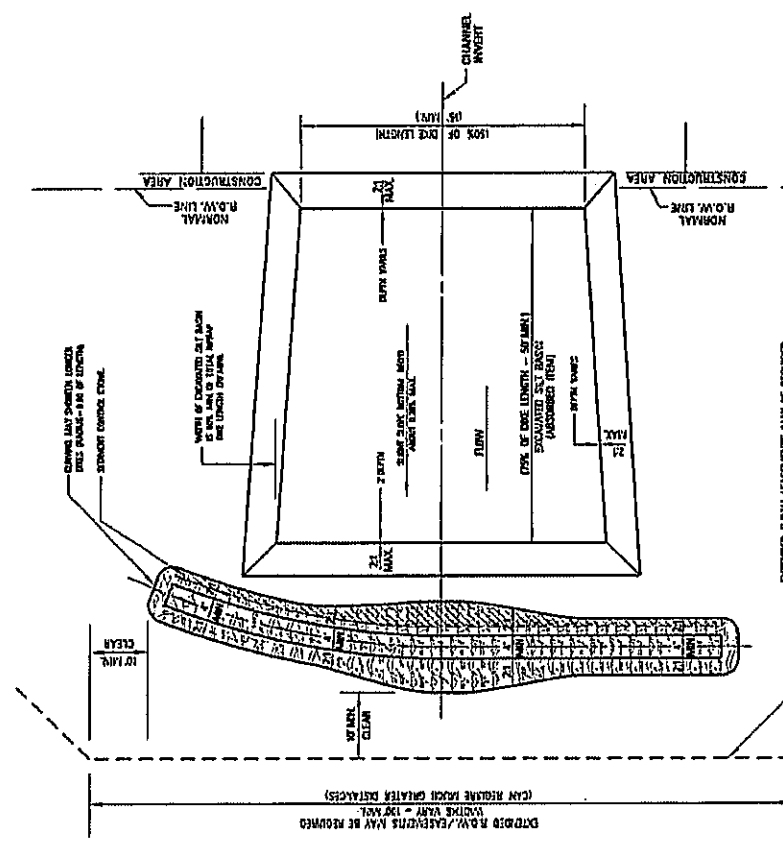

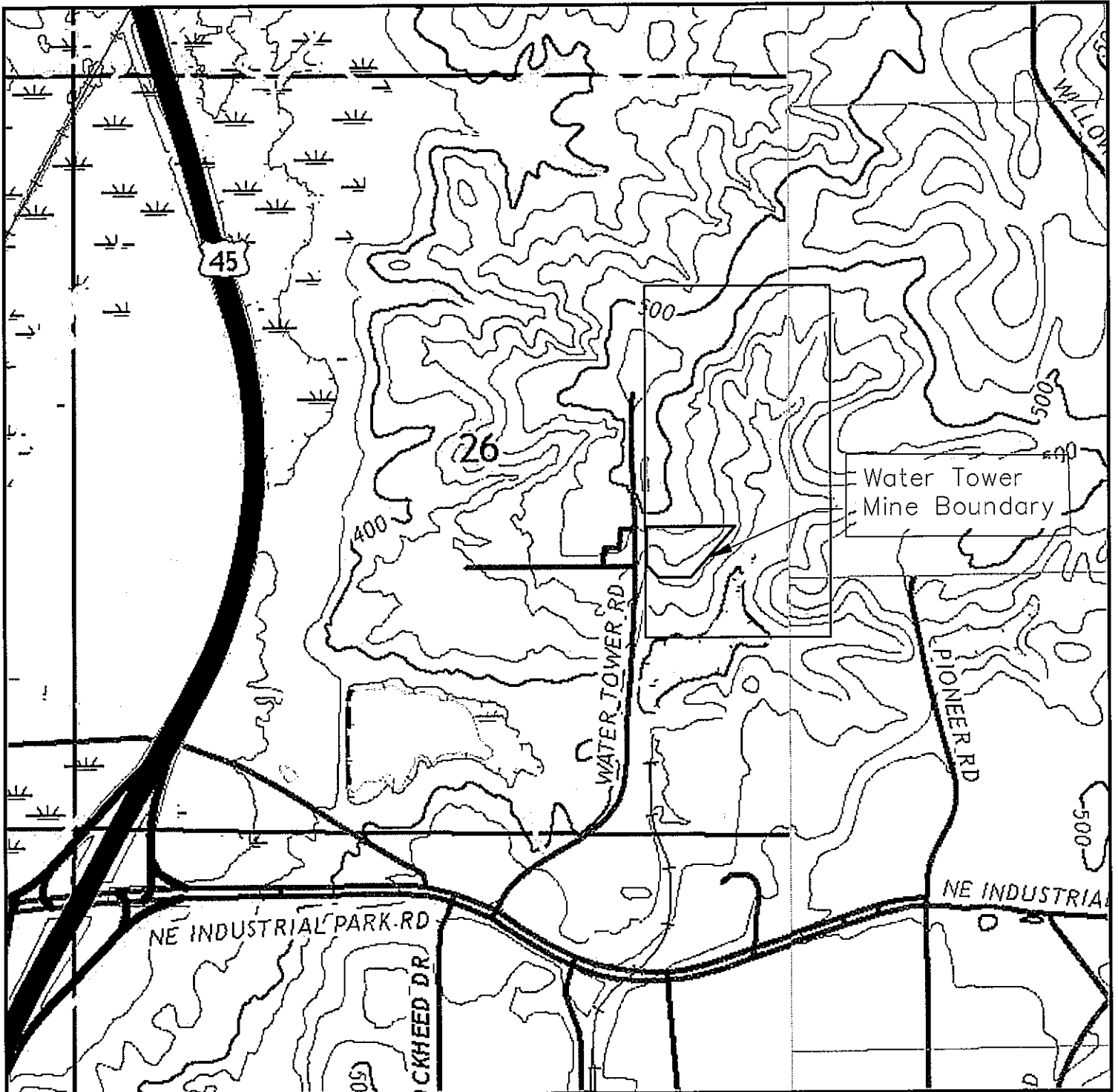

Water Tower Mine is located in part of the NW 1/4 of the SE 1/4 of Section 26, Township 7 North, Range 16 East, Lauderdale County, MS. and contains 4.0 acres more or less.

Entrance is located at:
32° 25' 10" North, 88° 37' 42" West

Water Tower Mine is located within the Meridian North Quadrangle.

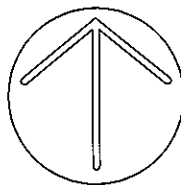

SCALE: 1" = 1000'

Water Tower Mine Topographic Mapping

for
Davidson Hauling, Inc..

UPON COMPLETION OF EXCAVATION,
AREA TO BE REVEGETATED.

ALL DISTURBED AREAS TO BE
GRADED TO A MAXIMUM 3:1 SLOPE
AND REVEGETATED.

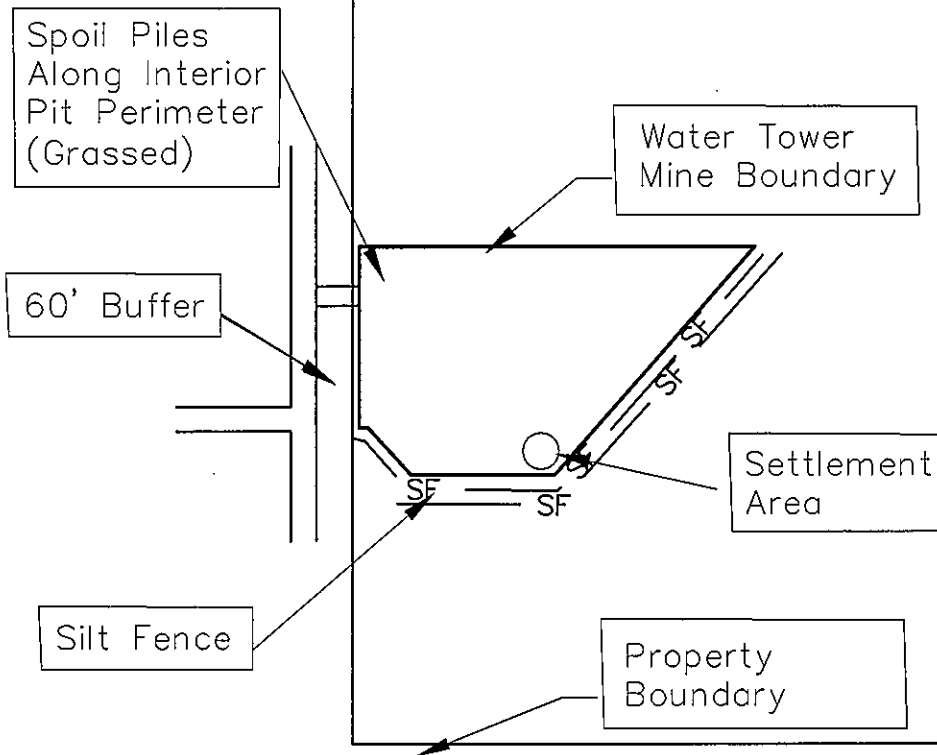

Subsequent to clearing and grubbing,
topsoil to be stripped and stockpiled
around perimeter of pit area. Storm
water runoff within pit area to be
collected in settlement area prior to
exiting mine footprint.

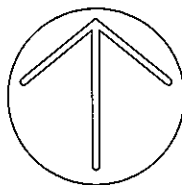

SCALE: 1" = 300'

Water Tower Mine Pit Layout

for
Davidson Hauling, Inc.

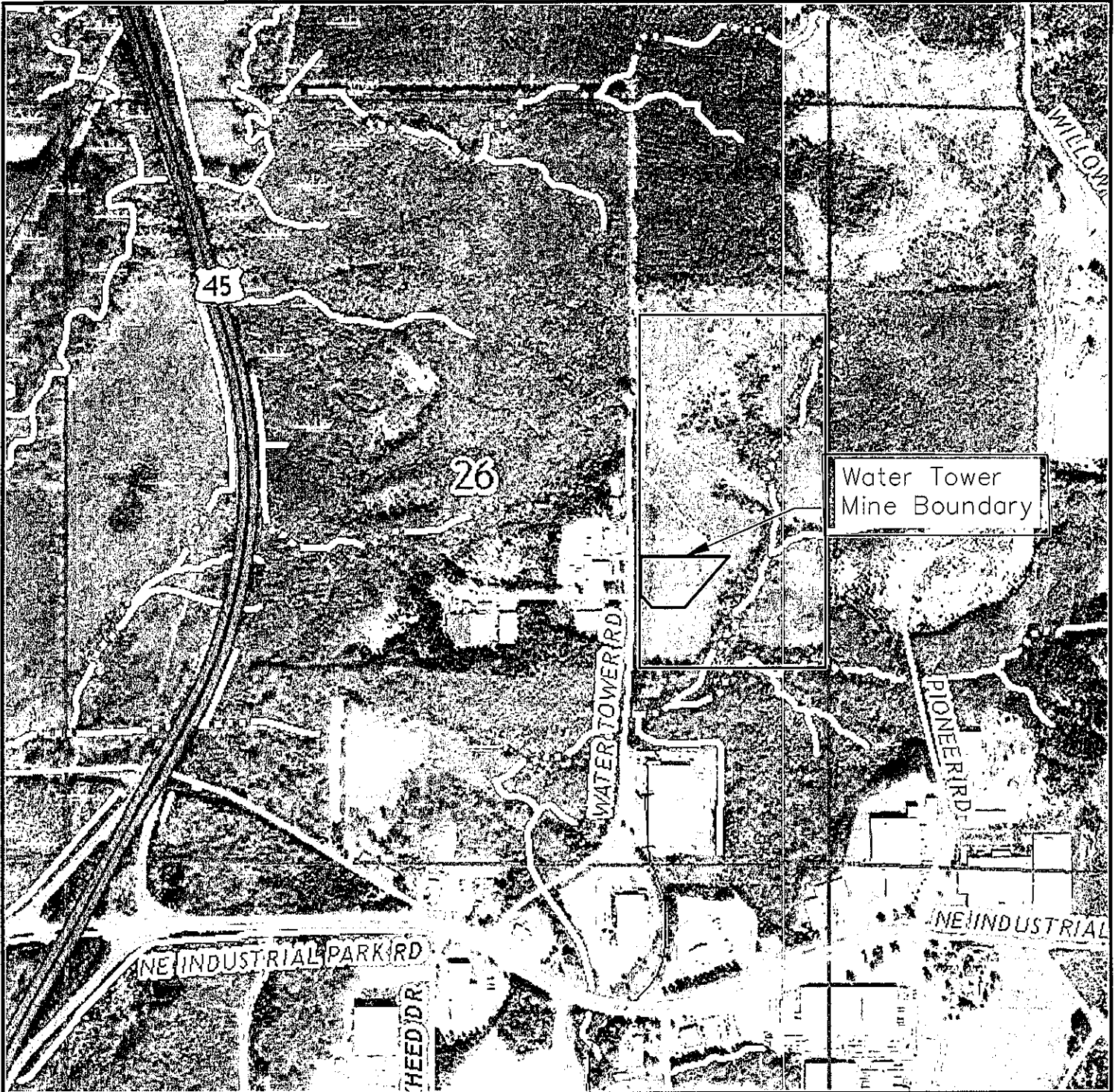

Water Tower Mine is located in part of the NW 1/4 of the SE 1/4 of Section 26, Township 7 North, Range 16 East, Lauderdale County, MS. and contains 4.0 acres more or less.

Entrance is located at:
32° 25' 10" North, 88° 37' 42" West

Water Tower Mine is located within the Meridian North Quadrangle.

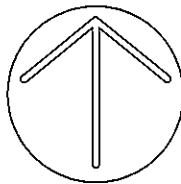

SCALE: 1" = 1000'

Water Tower Mine Aerial Mapping

for
Davidson Hauling, Inc.



MISSISSIPPI DEPARTMENT OF ENVIRONMENTAL QUALITY

**MINING NOTICE OF INTENT (MNOI)
FOR COVERAGE UNDER
MINING STORM WATER, DEWATERING AND NO DISCHARGE
GENERAL PERMIT MSR32 _____
(Number to be assigned by State)**

File at least 30 days prior to the commencement of mining; 15 days if a Storm Water Pollution Prevention Plan (SWPPP) is already on file and mine dewatering is not proposed. Lateral expansion of an existing mine that has general permit coverage requires the submittal of the Major Modification Form, not a new MNOI. However, modification of the existing SWPPP to include the expansion is required. Discharge of storm water or impounded water associated with mining or the operation of a wastewater recirculation system with no discharge without written notification of coverage from MDEQ is a violation of State Law.

If the company seeking coverage is a corporation, a limited liability company, a partnership, or a business trust, attach proof of its registration with the Mississippi Secretary of State and/or its Certificate of Good Standing. This registration or Certificate of Good Standing must be dated within twelve (12) months of the date of the submittal of this coverage form. Coverage will be issued in the company name as it is registered with the Mississippi Secretary of State.

Please indicate the activities to be covered by this MNOI (check all that apply).

- Storm Water Discharges Associated with Mining Mine Dewatering
- Wastewater Recirculation System with No Discharge

The appropriate section of the MNOI must be completed if the applicant proposes to discharge storm water, discharge impounded mine water (dewatering) and/or operate a wastewater recirculation system with no discharge.

A site-specific Storm Water Pollution Prevention Plan (SWPPP) developed in accordance with ACT5 of the General Permit and a United States Geological Survey (USGS) quadrangle map or photocopy, indicating the site location and outfalls must be included with the MNOI submittal. The name of the quadrangle map must be shown on all copies. Quadrangle maps can be obtained from the MDEQ, Office of Geology at 601-961-5523. Additional submittals may include the following (check all that apply).

- Section 404 Documentation Notice of Exempt Operations Form
- Dam/Reservoir Safety Permit or Written Authorization

ALL INFORMATION MUST BE COMPLETED (indicate "N/A" where not applicable)

RECEIVED

SEP 09 2024

Dept. of Environmental Quality