

Storm Water Pollution Prevention Plan

Preserve at Cedar Bluff Subdivision Phase 1

**Prepared
For
Astoria, LLC
5909 Shelby Oaks Drive, Ste 212
Memphis, TN 38134**

**Prepared
By
W. H. Porter Consultants, PLLC
6055 Primacy Parkway, Ste 115
Memphis, TN 38119**

Storm Water Pollution Prevention Plan Certification
Preserve at Cedar Bluff Subdivision
Phase 1
0 April Springs Drive
Olive Branch, MS

Site Owners/Developers sign this paragraph:

"I certify under penalty of law that this document and all attachments were prepared under my direction or supervision in accordance with a system designed to assure that qualified personnel properly gather and evaluate the information submitted. Based on my inquiry of the person or persons who manage the system, or those persons directly responsible for gathering the information, the information submitted is, to the best of my knowledge and belief, true, accurate, and complete. I am aware that there are significant penalties for submitting false information, including the possibility of fine and imprisonment for knowing violations."

Site Owner/Developer Signature

9/14/20
Date

Secondary Operators/Contractor's sign this paragraph:

"I certify under penalty of law that I have reviewed this document, any attachments, and the SWPPP referenced above. Based on my inquiry of the construction site owner/developer identified above and/or my inquiry of the person directly responsible for assembling this NOI and SWPPP, I believe the information submitted is accurate. I am aware that this NOI and SWPPP, if approved, makes the above-described construction activity subject to NPDES permit number MSR100000, and that certain of my activities on-site are thereby regulated. I am aware that there are significant penalties, including the possibility of fine and imprisonment for knowing violations and for failure to comply with these permit requirements."

Contractor Signature

Date

Contractor Signature

Date

Contractor Signature

Date

INTRODUCTION

W. H. Porter Consultants, PLLC has prepared this Storm Water Pollution Prevention Plan (S.W.P.P.P.) in conjunction with Mississippi Large Construction Storm Water General NPDES Permit (MSR100000) for Storm Water Discharges Associated with Construction Activity. Sound engineering practices were followed in the preparation of this plan. The control measures incorporated into this plan were designed based upon a 2-year, 24-hour storm event. NOAA Technical Paper No. 40 defines the 2-year, 24-hour storm as 4.93 inches of accumulated rainfall in a 24-hour period for DeSoto County.

A Storm Water Pollution Prevention Plan is required and a designated individual is to be responsible. At least one SWPPP shall be developed for each construction site covered by this permit. For more effective coordination of BMPs and opportunities for cost sharing, a cooperative effort by the different operators at a site to prepare and participate in a comprehensive SWPPP is encouraged. In instances where there are more than one SWPPP for a site, the permittees must ensure the storm water discharge controls and other measures are compatible with one another and do not prevent another operator from complying with permit conditions.

Attached you will find the drainage area map and related erosion and sediment controls information pertaining to this site.

EXISTING SITE CONDITIONS:

The site is located north of the existing Chateau Ridge Subdivision constructed around the 1970s, east of Oakwood Estates North, and south of I-22 in Olive Branch, Mississippi. The approximate Latitude and Longitude is 34°55'52" and -89°48'33", respectively. The site is approximately 17.15 acres and is characterized by some trees, and open field. The existing property is characterized by rolling terrain with grades ranging from 1% to 15% across the property. The major soil types represented on the site are Collins silt loam, Falaya silt loam, and Loring silt loam, which has a predominate Hydrologic Soil Group of C. The majority of the drainage generated from the property flows from the west property line approximately 5400 ft to a tributary of Camp Creek.

An environmental assessment was conducted for the site to determine if there are any jurisdictional streams and wetlands on the site. The concurrence from the Army Corp of Engineers is included in the appendix and the environmental assessment is available upon request.

PROJECT DESCRIPTION:

The project consists of developing the 17.15 acre parcel in 20 lots. The proposed grades on the site range between 0.5-6% within the lots with rear slopes up to 3H:1V. The proposed drainage system has been designed for approximately 3.5 cfs/acre. Silt fence will be placed along the perimeter of the disturbed area to mitigate sediment leaving the site. Onsite stormwater will be conveyed through the proposed storm drainage system before leaving the site at the detention basin, approximately 8.77 acres. The outlet of the detention basin will be protected with a rock filter dam to control sediment from leaving the basin. Rip-rap will be placed at the outlet of the detention basin to control erosive velocities.

Once final grading is established or when earth-moving activities are anticipated to cease for 14 days or more, the disturbed areas will be mulched and seeded or sodded immediately. No land disturbing activities may commence until **all** control measures are in place and functional. All control measures must be properly selected, installed, and maintained in accordance with the manufacturer's specifications. Limits of disturbance shall be delineated with construction fencing or other appropriate measures to ensure that earth moving activities are not conducted beyond the disturbance limits.

303(d):

There are no stream within a close proximity of the site that is included in the "Mississippi 2018 Section 303(D) List of Impaired Water Bodies."

Spills and Non-Storm Water Contingencies:

All fueling of equipment and vehicles on site will be conducted near the construction entrance off of the existing road that enters the site. Any spillage will be removed immediately. Contaminated soils will be placed on heavy plastic and covered or placed into approved containers to prevent contact with storm water. All fuel tanks will be stored in the construction trailer. Any spills in excess of two gallons will be reported to a representative of the construction company.

All trucks will be washed out at the designated area near the construction entrance. Each contractor is responsible to provide litter control for trash generated by his crew. A dumpster will be located near the construction trailer and is limited to garbage and paper trash only. Oil cans, used oil, and filters will be contained and disposed of by the contractor by taking them to an appropriate disposal center.

Sequencing of Construction

- 1.) Install stabilized construction entrance/exit
- 2.) Install perimeter silt fence
- 3.) Ensure all applicable EPSC measures are in place prior to beginning earth moving activities
- 4.) Clear and strip site
- 5.) Perform grading for lots and pavements
- 6.) Clear and grub site, stabilizing and denuded area where construction will cease for more than 14 days.
- 7.) All applicable EPSC measures shall be in place prior to beginning any earth moving operations and must be maintained throughout the construction period.
- 8.) Install infrastructure (i.e. sewer, drainage, and utilities.)
- 9.) Implement inlet protection
- 10.) Construct roads
- 11.) Stabilize site with seed (sod slopes 3:1 or greater)
- 12.) Apply/install final seeding and landscaping
- 13.) Stabilize any denuded areas (sod on slopes 3:1 and greater, see seeding mixtures and planting dates for other areas)
- 14.) Prepare for final seeding and landscaping. (notes: turf grass to be a Bermuda grass or equal)
- 15.) Lot clean-up

Planned Erosion, Sediment, and Storm Water Control Practices:

Construction Entrance

A temporary gravel construction entrance will be provided at Payne Lane to help reduce vehicle tracking of sediments.

Silt Fence

Silt fences are installed along the perimeter of the disturbed site. Silt fences should be inspected and maintained bi-weekly.

Culvert Protection

Culvert protection shall be installed at the outlet of the detention basin. Culvert protection shall be installed with two layers of geotextile fabric (type III) between the mineral aggregate layer and rip-rap layer. The measure shall be inspected bi-weekly and sediment shall be removed when it has accumulated to one-half the original height of the structure.

Soil Stabilization

Stabilization of disturbed areas must, at a minimum, be initiated immediately whenever any clearing, grading, excavation or other earth disturbing activities have temporarily or permanently ceased on any portion of the site and will resume for a period of 14 calendar days. The appropriate temporary or permanent vegetative practices shall be initiated immediately. For purposes of this permit, "immediately" is interpreted to mean no later than the next work day.

Stabilization measures, by means of mulching and seeding disturbed areas, will be initiated immediately where construction activities will temporarily or permanently ceased, but in no case more than 14 days after activities have ceased. Permanent stabilization with perennial vegetation will be initiated immediately whenever any clearing, grading, excavation or other earth disturbing activities have temporarily or permanently ceased on any portion of the site and will resume for a period of 14 calendar days.

All slopes 3:1 and steeper, shall be sodded and pegged

Existing vegetation will be preserved where possible.

Heavy equipment use in areas to be re-vegetated should be avoided. If compaction cannot be avoided, the top 4 inches of the soil bed should be tilled before re-vegetation. Any necessary fertilizer or other soil amendments should be added during the tilling process.

Inlet Protection

Inlet protection will be sustained by using a gravel silt barrier for inlets that are located on the paving surface and silt fence for inlets that are located in the unpaved area.

Buffer Zones

Buffer zones are not necessary on this project due to work taking place on a previously graded site.

***All control measures must be properly selected, installed, and maintained in accordance with the manufacturer's specifications. The Contractor shall be responsible for the implementation of all EPSC Measures.**

Maintenance:

- 1.) Any poorly functioning erosion controls or sediment control structures, non-compliant discharges, or any other deficiencies observed during the inspections required under this permit shall be corrected as soon as possible, but not to exceed 24 hours of the inspection unless prevented by unsafe weather conditions as documented on the inspection form.
- 2.) Areas found to be lacking adequate vegetation shall be re-seeded and fertilized.
- 3.) Where silt fences are found to have fallen down, they will be replaced with new fences. Where control measures have been reduced to 50% of their design capacities, the contractor will immediately remove accumulated sediment and repair the control measure.
- 4.) Pre-construction vegetative ground cover shall not be destroyed, removed or disturbed more than 14 days prior to grading or earth moving unless the area is seeded and/or mulched or other temporary cover is installed immediately.
- 5.) Washouts in grading will be re-graded, compacted, and seeded.
- 6.) Off-site vehicle tracking and the generation of dust shall be minimized.
- 7.) Qualified personnel shall perform inspections at least once every calendar week for a minimum of four inspections per month and as often as necessary.
- 8.) All inspections shall be documented and include the scope, name of the inspector, date of inspection, and major observations relating to the performance of any storm water control structure that failed to operate as designed or proved inadequate.
- 9.) Permittees shall maintain a rain gauge and daily rainfall records at the site, or use a reference site for a record of daily amount of precipitation.

- 10.) If there is an anticipated storm event, all litter, construction debris, and construction chemicals that are exposed to storm water shall be picked up prior to said event.
- 11.) The Sediment Basin shall be inspected at least once weekly and following a rainfall that produces a discharge. Sediment shall be properly disposed of when accumulation reaches 50 percent of the wet storage capacity. After rain events, inspect the dewatering device and remove debris and trash, if necessary. During routine inspections, check embankment, emergency spillway, and outlet for erosion damage, piping, settling, seepage, or slumping along the toe or around the barrel and repair immediately. Unanticipated breach of a sediment basin temporary containment measures shall be implemented within 24 hours after the inspection. Permanent corrective measure shall be implemented within five days of the inspection; however, if permanent corrective measures cannot be implemented within the timeframes provided herein the owner or operator shall contact MDEQ.
- 12.) Procedures shall provide that all controls and outfalls/discharge points are inspected after rain events that produce a discharge and at least weekly for a minimum of four inspections per month in accordance with ACT6, S-5.

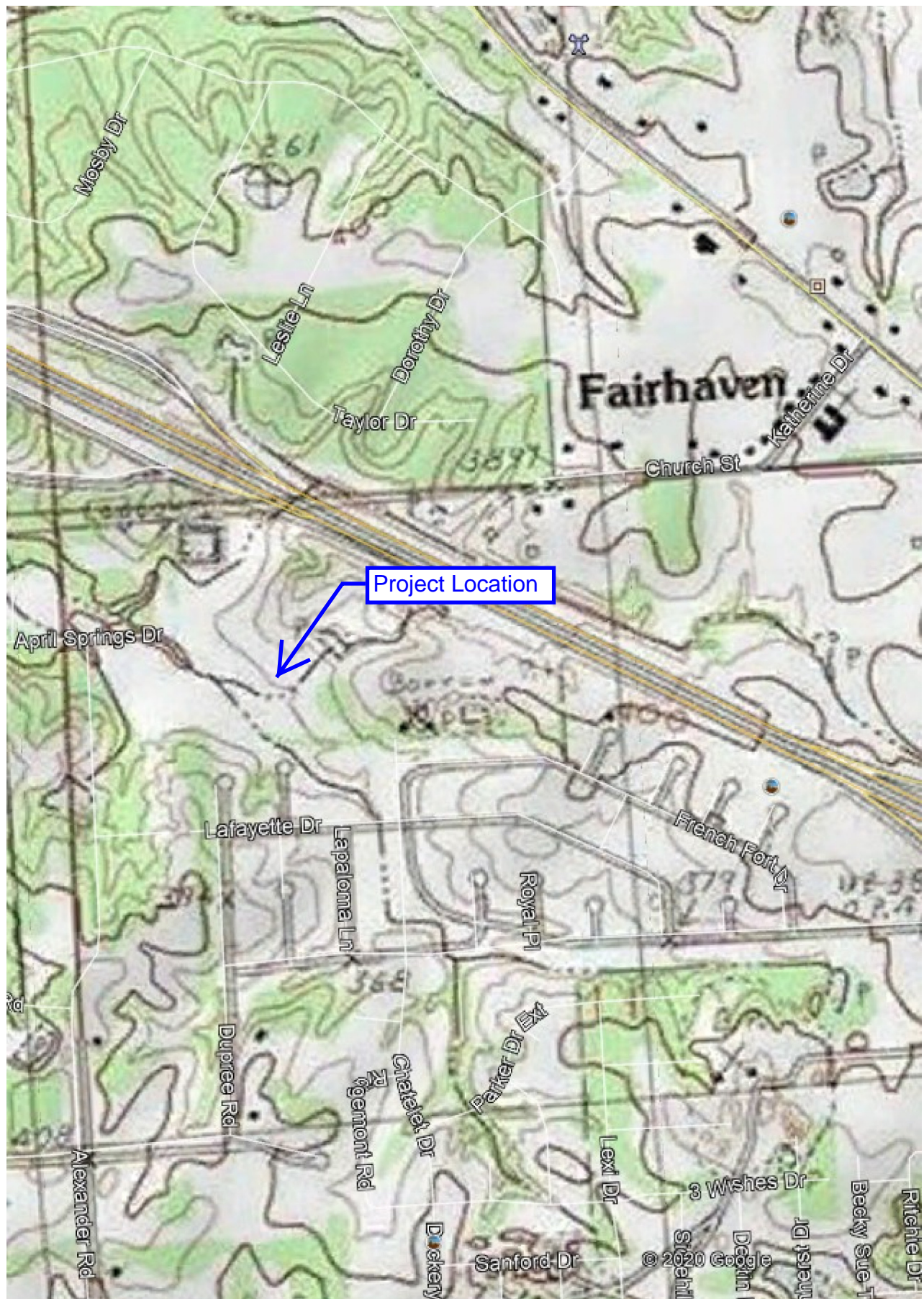

Large Construction Notice of Intent



MISSISSIPPI DEPARTMENT OF
ENVIRONMENTAL QUALITY

LARGE CONSTRUCTION NOTICE OF INTENT (LCNOI) FOR COVERAGE UNDER THE LARGE CONSTRUCTION STORM WATER GENERAL NPDES PERMIT

INSTRUCTIONS

The Large Construction Notice of Intent (LCNOI) is for coverage under the Large Construction General Permit for land disturbing activities of five (5) acres or greater; or for land disturbing activities, which are part of a larger common plan of development or sale that are initially less than five (5) acres but will ultimately disturb five (5) or more acres. Applicant must be the owner or operator. For construction activities, the operator is typically the prime contractor. The owner(s) of the property and the prime contractor associated with regulated construction activity on the property have joint and severable responsibility for compliance with the Large Construction Storm Water General Permit MSR10.

If the company seeking coverage is a corporation, a limited liability company, a partnership, or a business trust, attach proof of its registration with the Mississippi Secretary of State and/or its Certificate of Good Standing. This registration or Certificate of Good Standing must be dated within twelve (12) months of the date of the submittal of this coverage form. Coverage will be issued in the company name as it is registered with the Mississippi Secretary of State.

Completed LCNOIs should be filed at least thirty (30) days prior to the commencement of construction. Discharge of storm water from large construction activities without written notification of coverage is a violation of state law.

Submittals with this LCNOI must include:

- A site-specific Storm Water Pollution Prevention Plan (SWPPP) developed in accordance with ACT5 of the General Permit
- A detailed site-specific scaled drawing showing the property layout and the features outlined in ACT5 of the General Permit
- A United States Geological Survey (USGS) quadrangle map or photocopy, extending at least one-half mile beyond the facility property boundaries with the site location and outfalls outlined or highlighted. The name of the quadrangle map must be shown on all copies. Quadrangle maps can be obtained from the MDEQ, Office of Geology at 601-961-5523.

Additional submittals may include the following, if applicable:

- Appropriate Section 404 documentation from U.S. Army Corps of Engineers
- Appropriate documentation concerning future disposal of sanitary sewage and sewage collection system construction
- Appropriate documentation from the MDEQ Office of Land & Water concerning dam construction and low flow requirements
- Approval from County Utility Authority in Hancock, Harrison, Jackson, Pearl River and Stone Counties

ALL QUESTIONS MUST BE ANSWERED (Answer "NA" if the question is not applicable)

MSR10 _ _ _ _

(NUMBER TO BE ASSIGNED BY STATE)

APPLICANT IS THE: ☐ **OWNER** ☐ **PRIME CONTRACTOR**

OWNER CONTACT INFORMATION

OWNER CONTACT PERSON: _____

OWNER COMPANY LEGAL NAME: _____

OWNER STREET OR P.O. BOX: _____

OWNER CITY: _____ **STATE:** _____ **ZIP:** _____

OWNER PHONE #: (____) _____ **OWNER EMAIL:** _____

PRIME CONTRACTOR CONTACT INFORMATION

PRIME CONTRACTOR CONTACT PERSON: _____

PRIME CONTRACTOR COMPANY LEGAL NAME: _____

PRIME CONTRACTOR STREET OR P.O. BOX: _____

PRIME CONTRACTOR CITY: _____ **STATE:** _____ **ZIP:** _____

PRIME CONTRACTOR PHONE #: (____) _____ **PRIME CONTRACTOR EMAIL:** _____

FACILITY SITE INFORMATION

FACILITY SITE NAME: _____

FACILITY SITE ADDRESS (If the physical address is not available, please indicate the nearest named road. For linear projects indicate the beginning of the project and identify all counties the project traverses.)

STREET: _____

CITY: _____ **STATE:** _____ **COUNTY:** _____ **ZIP:** _____

FACILITY SITE TRIBAL LAND ID (N/A If not applicable): _____

LATITUDE: ____ degrees ____ minutes ____ seconds **LONGITUDE:** ____ degrees ____ minutes ____ seconds

LAT & LONG DATA SOURCE (GPS (Please GPS Project Entrance/Start Point) or Map Interpolation): _____

TOTAL ACREAGE THAT WILL BE DISTURBED ¹: _____

IS THIS PART OF A LARGER COMMON PLAN OF DEVELOPMENT? YES ☐ NO ☐

IF YES, NAME OF LARGER COMMON PLAN OF DEVELOPMENT: _____
AND PERMIT COVERAGE NUMBER: MSR10 _ _ _ _

ESTIMATED CONSTRUCTION PROJECT START DATE: _____
YYYY-MM-DD

ESTIMATED CONSTRUCTION PROJECT END DATE: _____
YYYY-MM-DD

DESCRIPTION OF CONSTRUCTION ACTIVITY: _____

PROPOSED DESCRIPTION OF PROPERTY USE AFTER CONSTRUCTION HAS BEEN COMPLETED: _____

SIC Code _ _ _ _ **NAICS Code** _ _ _ _

NEAREST NAMED RECEIVING STREAM: _____

IS RECEIVING STREAM ON MISSISSIPPI'S 303(d) LIST OF IMPAIRED WATER BODIES? (The 303(d) list of impaired waters and TMDL stream segments may be found on MDEQ's web site: http://www.deq.state.ms.us/MDEQ.nsf/page/TWB_Total_Maximum_Daily_Load_Section) YES ☐ NO ☐

HAS A TMDL BEEN ESTABLISHED FOR THE RECEIVING STREAM SEGMENT? YES ☐ NO ☐

ARE THERE RECREATIONAL STREAMS, PRIVATE/PUBLIC PONDS OR LAKES WITHIN ½ MILE DOWNSTREAM OF PROJECT BOUNDARY THAT MAY BE IMPACTED BY THE CONSTRUCTION ACTIVITY? YES ☐ NO ☐

EXISTING DATA DESCRIBING THE SOIL (for linear projects please describe in SWPPP):

WILL FLOCCULANTS BE USED TO TREAT TURBIDITY IN STORM WATER? YES ☐ NO ☐

IF YES, INDICATE THE TYPE OF FLOCCULANT. ☐ ANIONIC POLYACRYLAMIDE (PAM)
☐ OTHER _____

IF YES, DOES THE SWPPP DESCRIBE THE METHOD OF INTRODUCTION, THE LOCATION OF INTRODUCTION AND THE LOCATION OF WHERE FLOCCULATED MATERIAL WILL SETTLE? YES ☐ NO ☐

¹Acreage for subdivision development includes areas disturbed by construction of roads, utilities and drainage. Additionally, a housesite of at least 10,000 ft² per lot (entire lot, if smaller) shall be included in calculating acreage disturbed.

DOCUMENTATION OF COMPLIANCE WITH OTHER REGULATIONS/REQUIREMENTS
COVERAGE UNDER THIS PERMIT WILL NOT BE GRANTED UNTIL ALL OTHER REQUIRED
MDEQ PERMITS AND APPROVALS ARE SATISFACTORILY ADDRESSED

IS LCNOI FOR A FACILITY THAT WILL REQUIRE OTHER PERMITS?

YES ☐ NO ☐

IF YES, CHECK ALL THAT APPLY: ☐ AIR ☐ HAZARDOUS WASTE ☐ PRETREATMENT
☐ WATER STATE OPERATING ☐ INDIVIDUAL NPDES ☐ OTHER: _____

IS THE PROJECT REROUTING, FILLING OR CROSSING A WATER CONVEYANCE OF ANY KIND? (If yes, contact the U.S. Army Corps of Engineers' Regulatory Branch for permitting requirements.) YES ☐ NO ☐

IF THE PROJECT REQUIRES A CORPS OF ENGINEER SECTION 404 PERMIT, PROVIDE APPROPRIATE DOCUMENTATION THAT:

- The project has been approved by individual permit, or
- The work will be covered by a nationwide permit and NO NOTIFICATION to the Corps is required, or
- The work will be covered by a nationwide or general permit and NOTIFICATION to the Corps is required

IS A LAKE REQUIRING THE CONSTRUCTION OF A DAM BEING PROPOSED? YES ☐ NO ☐
(If yes, provide appropriate approval documentation from MDEQ Office of Land and Water, Dam Safety.)

IF THE PROJECT IS A SUBDIVISION OR A COMMERCIAL DEVELOPMENT, HOW WILL SANITARY SEWAGE BE DISPOSED? Check one of the following and attach the pertinent documents.

- ☐ Existing Municipal or Commercial System. Please attach plans and specifications for the collection system and the associated "Information Regarding Proposed Wastewater Projects" form or approval from County Utility Authority in Hancock, Harrison, Jackson, Pearl River and Stone Counties. If the plans and specifications can not be provided at the time of LCNOI submittal, MDEQ will accept written acknowledgement from official(s) responsible for wastewater collection and treatment that the flows generated from the proposed project can and will be transported and treated properly. The letter must include the estimated flow.
- ☐ Collection and Treatment System will be Constructed. Please attach a copy of the cover of the NPDES discharge permit from MDEQ or indicate the date the application was submitted to MDEQ (Date: _____.)
- ☐ Individual Onsite Wastewater Disposal Systems for Subdivisions Less than 35 Lots. Please attach a copy of the Letter of General Acceptance from the Mississippi State Department of Health or certification from a registered professional engineer that the platted lots should support individual onsite wastewater disposal systems.
- ☐ Individual Onsite Wastewater Disposal Systems for Subdivisions Greater than 35 Lots. A determination of the feasibility of installing a central sewage collection and treatment system must be made by MDEQ. A copy of the response from MDEQ concerning the feasibility study must be attached. If a central collection and wastewater system is not feasible, then please attach a copy of the Letter of General Acceptance from the State Department of Health or certification from a registered professional engineer that the platted lots should support individual onsite wastewater disposal systems.

INDICATE ANY LOCAL STORM WATER ORDINANCE WITH WHICH THE PROJECT MUST COMPLY:

I certify under penalty of law that this document and all attachments were prepared under my direction or supervision in accordance with a system designed to assure that qualified personnel properly gathered and evaluated the information submitted. Based on my inquiry of the person or persons who manage the system, or those persons directly responsible for gathering the information, the information submitted is, to the best of my knowledge and belief, true, accurate and complete. I am aware that there are significant penalties for submitting false information, including the possibility of fine and imprisonment for knowing violations.

Signature of Applicant (owner or prime contractor)

Date Signed

Printed Name¹

Title

¹This application shall be signed as follows:

- For a corporation, by a responsible corporate officer.
- For a partnership, by a general partner.
- For a sole proprietorship, by the proprietor.

For a municipal, state or other public facility, by principal executive officer, mayor, or ranking elected official

Please submit the LCN01 form to:

Chief, Environmental Permits Division
MS Department of Environmental Quality, Office of Pollution Control
P.O. Box 2261
Jackson, Mississippi 39225

Soil Map

Hydrologic Soil Group—DeSoto County, Mississippi



**Natural Resources
Conservation Service**

Web Soil Survey
National Cooperative Soil Survey

9/14/2020
Page 1 of 4

MAP LEGEND

Area of Interest (AOI)









 Area of Interest (AOI)

Soils

Soil Rating Polygons

 A
 A/D
 B
 B/D
 C
 C/D
 D
 Not rated or not available

Soil Rating Lines

 A
 A/D
 B
 B/D
 C
 C/D
 D
 Not rated or not available

Soil Rating Points

 A
 A/D
 B
 B/D

 C
 C/D
 D
 Not rated or not available

Water Features

 Streams and Canals

Transportation

 Rails
 Interstate Highways
 US Routes
 Major Roads
 Local Roads

Background

 Aerial Photography

MAP INFORMATION

The soil surveys that comprise your AOI were mapped at 1:24,000.

Warning: Soil Map may not be valid at this scale.

Enlargement of maps beyond the scale of mapping can cause misunderstanding of the detail of mapping and accuracy of soil line placement. The maps do not show the small areas of contrasting soils that could have been shown at a more detailed scale.

Please rely on the bar scale on each map sheet for map measurements.

Source of Map: Natural Resources Conservation Service
 Web Soil Survey URL:
 Coordinate System: Web Mercator (EPSG:3857)

Maps from the Web Soil Survey are based on the Web Mercator projection, which preserves direction and shape but distorts distance and area. A projection that preserves area, such as the Albers equal-area conic projection, should be used if more accurate calculations of distance or area are required.

This product is generated from the USDA-NRCS certified data as of the version date(s) listed below.

Soil Survey Area: DeSoto County, Mississippi
 Survey Area Data: Version 19, Jun 3, 2020

Soil map units are labeled (as space allows) for map scales 1:50,000 or larger.

Date(s) aerial images were photographed: Nov 2, 2019—May 9, 2020

The orthophoto or other base map on which the soil lines were compiled and digitized probably differs from the background imagery displayed on these maps. As a result, some minor shifting of map unit boundaries may be evident.

Hydrologic Soil Group

Map unit symbol	Map unit name	Rating	Acres in AOI	Percent of AOI
Cg	Collins silt loam (adler)	C	6.9	16.0%
Cl	Collins and Falaya silt loams, local alluvium phases	B	4.1	9.6%
Fc	Falaya and Waverly silt loams, local alluvium phases (arkabutla and rosebloom)	B/D	0.5	1.1%
Gf	Grenada silt loam, severely eroded sloping phase (loring)	C	0.0	0.0%
Gk	Gullied land, Loring soil material		21.9	51.1%
Lc	Loring silt loam, 2 to 5 percent slopes, moderately eroded, central	C	0.2	0.6%
Li	Loring silty clay loam, severely eroded gently sloping phase	C	8.0	18.7%
W	Water		1.2	2.9%
Totals for Area of Interest			42.8	100.0%

Description

Hydrologic soil groups are based on estimates of runoff potential. Soils are assigned to one of four groups according to the rate of water infiltration when the soils are not protected by vegetation, are thoroughly wet, and receive precipitation from long-duration storms.

The soils in the United States are assigned to four groups (A, B, C, and D) and three dual classes (A/D, B/D, and C/D). The groups are defined as follows:

Group A. Soils having a high infiltration rate (low runoff potential) when thoroughly wet. These consist mainly of deep, well drained to excessively drained sands or gravelly sands. These soils have a high rate of water transmission.

Group B. Soils having a moderate infiltration rate when thoroughly wet. These consist chiefly of moderately deep or deep, moderately well drained or well drained soils that have moderately fine texture to moderately coarse texture. These soils have a moderate rate of water transmission.

Group C. Soils having a slow infiltration rate when thoroughly wet. These consist chiefly of soils having a layer that impedes the downward movement of water or soils of moderately fine texture or fine texture. These soils have a slow rate of water transmission.

Group D. Soils having a very slow infiltration rate (high runoff potential) when thoroughly wet. These consist chiefly of clays that have a high shrink-swell potential, soils that have a high water table, soils that have a claypan or clay layer at or near the surface, and soils that are shallow over nearly impervious material. These soils have a very slow rate of water transmission.

If a soil is assigned to a dual hydrologic group (A/D, B/D, or C/D), the first letter is for drained areas and the second is for undrained areas. Only the soils that in their natural condition are in group D are assigned to dual classes.

Rating Options

Aggregation Method: Dominant Condition

Component Percent Cutoff: None Specified

Tie-break Rule: Higher

Corp of Engineers Jurisdictional Determination



DEPARTMENT OF THE ARMY
U.S. ARMY CORPS OF ENGINEERS, VICKSBURG DISTRICT
4155 CLAY STREET
VICKSBURG, MISSISSIPPI 39183-3435

July 24, 2020

Operations Division

SUBJECT: Jurisdictional Determination – Approximately 40-Acre Astoria Development Site, DeSoto County, Mississippi

Mr. Christopher Grow
Grow Environmental Solutions
5313 Edenshire Avenue
Memphis, Tennessee 38117

Dear Mr. Grow:

This is in response to your request for a jurisdictional determination for the subject property located east of April Springs Drive and northwest of French Fort Drive in DeSoto County, Mississippi.

Based upon the information provided and the current Navigable Waters Protection Rule (NWPR), there are jurisdictional wetlands and other waters of the United States located within the boundary of the property subject to regulation pursuant to Section 404 of the Clean Water Act. The approximate extent of jurisdictional waters of the United States is depicted on the enclosed map (enclosure 1). Any work involving the discharge of dredged or fill material (land clearing, ditching, filling, leveeing, culvert crossings, etc.) within the identified jurisdictional waters will require a Department of the Army Section 404 permit prior to beginning work. In addition, the ephemeral stream, certain wetlands and pond identified on enclosure 1, are not considered waters of the United States. For your information, I have enclosed a copy of the basis of our determination (enclosure 2) and an appeals form (enclosure 3).

This approved jurisdictional determination is valid for a period not to exceed five years from the date of this letter unless superseded by law or regulation. If the proposed work is not completed by this time, please contact this office for a reevaluation of permit requirements.

This determination of Department of the Army regulatory requirements does not convey any property rights, either in real estate or material or any exclusive privileges, and does not authorize any injury to property or invasion of rights or local laws or regulations, or obviate the requirement to obtain state or local assent required by law for the activity discussed herein.

The decision regarding this action is based on information found in the administrative record, which documents the District's decision-making process, the basis for decision, and the final decision.

For your convenience, I am enclosing a Department of the Army permit application package, with instructions (enclosure 4). Your application for any proposed work in wetlands or other waters of the United States should be submitted at least 120 days in advance of the proposed starting date. To expedite the evaluation process, please refer to Identification No. MVK-2020-209 when submitting the application.

If you have any questions, please contact Mr. Bryton Hixson, of this office, telephone (601) 631-5591, or e-mail address: bryton.k.hixson@usace.army.mil.

Sincerely,

Charles R. Allred, Jr.
Chief, Enforcement Section
Regulatory Branch

Enclosures

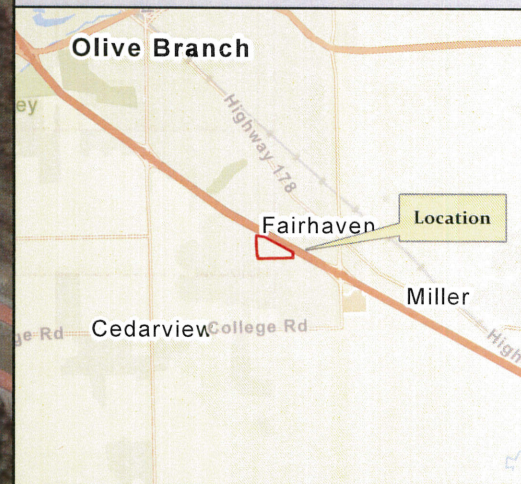
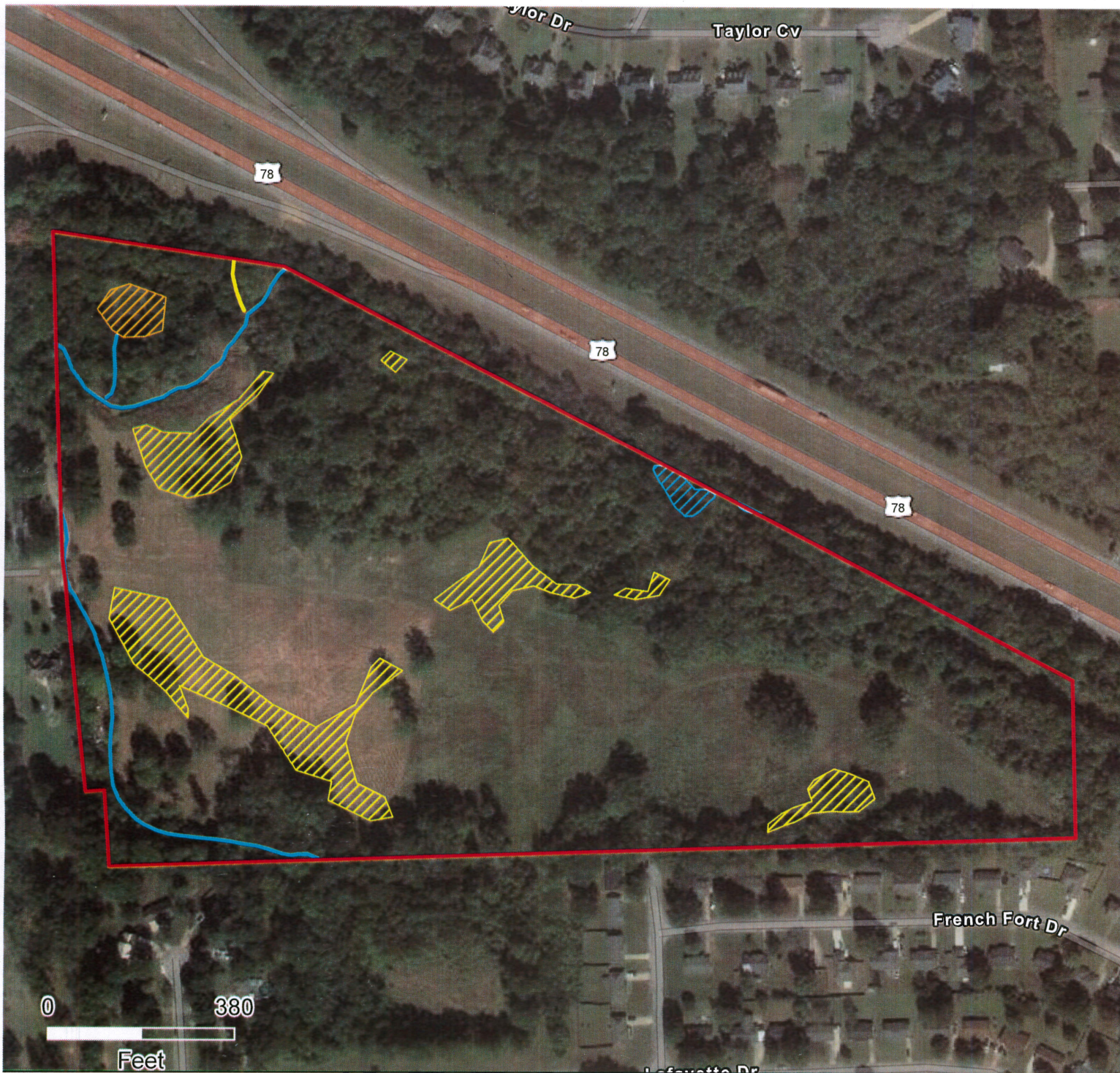

Legend

- Project Boundary
- Jurisdictional Streams (1843 LF)
- Non-Jurisdictional Stream (107 LF)
- Jurisdictional Wetlands (0.26 Acre)
- Non-Jurisdictional Wetlands (2.88 Acres)
- Non-Jurisdictional Ponds (0.15 Acre)

*There are jurisdictional wetlands and other waters of the United States within the project area. Any activity involving the discharge of dredged or fill material into said waters requires a permit.



MVK-2020-209
Astoria Development Site

Approved JD

24 July 2020
Bryton Hixson



Prime Contractor Certification Form

PRIME CONTRACTOR CERTIFICATION

LARGE CONSTRUCTION GENERAL PERMIT

Coverage No. MSR10 _____ County _____

(Fill in your Certificate of Coverage Number and County)



MISSISSIPPI DEPARTMENT OF
ENVIRONMENTAL QUALITY

By completing and submitting this form to MDEQ, the prime contractor is certifying that (1) they have operational control over the erosion and sediment control specifications (including the ability to make modifications to such specifications) or (2) they have day-to-day operational control of those activities at the site necessary to ensure compliance with the SWPPP and applicable permit conditions.

The owner(s) of the property and the prime contractor associated with regulated construction activity on the property have joint and severable responsibility for compliance with the permit. Notwithstanding any permit condition to the contrary, the coverage recipient and any person who causes pollution of waters of the state or places waste in a location where they are likely to cause pollution of any waters of the state shall remain responsible under applicable federal and state laws and regulations and applicable permits.

PRIME CONTRACTOR INFORMATION

PRIME CONTRACTOR CONTACT PERSON: _____ PHONE NUMBER: (____) _____

PRIME CONTRACTOR COMPANY: _____

PRIME CONTRACTOR STREET (P.O. BOX): _____

PRIME CONTRACTOR CITY: _____ STATE: _____ ZIP: _____

E-MAIL ADDRESS: _____

OWNER INFORMATION

OWNER CONTACT PERSON: _____ PHONE NUMBER: (____) _____

OWNER COMPANY NAME: _____

PROJECT INFORMATION

PROJECT NAME: _____

DESCRIPTION OF CONSTRUCTION ACTIVITY: _____

PHYSICAL SITE ADDRESS (If the physical address is not available indicate the nearest named road. For linear projects, indicate the beginning of the project and identify all counties the project traverses.)

STREET: _____

CITY: _____ COUNTY: _____

I certify that I am the prime contractor for this project and will comply with all the requirements in the above referenced general NPDES permit. I further certify under penalty of law that this document and all attachments were prepared under my direction or supervision in accordance with a system designed to assure that qualified personnel properly gathered and evaluated the information submitted. Based on my inquiry of the person or persons who manage the system, or those persons directly responsible for gathering the information, the information submitted is, to the best of my knowledge and belief, true, accurate and complete. I am aware that there are significant penalties for submitting false information, including the possibility of fine and imprisonment for knowing violations.

Prime Contractor Signature¹ _____

Date Signed _____

Printed Name¹ _____

Title _____

¹This application shall be signed as follows:

- For a corporation, by a responsible corporate officer.
- For a partnership, by a general partner.
- For a sole proprietorship, by the proprietor.
- For a municipal, state or other public facility, by principal executive officer, mayor, or ranking elected official.

This Prime Contractors Certification form shall be submitted to:

Chief, Environmental Permits Division
MS Department of Environmental Quality, Office of Pollution Control
P.O. Box 2261
Jackson, Mississippi 39225

Site Inspection and Certification Form

**LARGE CONSTRUCTION GENERAL PERMIT
SITE INSPECTION AND CERTIFICATION FORM
COVERAGE NUMBER (MSR10 _ _ _ _)**



INSTRUCTIONS

Results of construction storm water inspections required by ACT6 of this permit shall be recorded on this report form and kept with the Storm Water Pollution Prevention Plan (SWPPP) in accordance with the inspection documentation provisions of ACT9 of the this permit. Inspections shall be performed at least weekly for a minimum of four inspections per month. The coverage number must be listed at the top of all Inspection and Certification Forms.

COVERAGE RECIPIENT INFORMATION

OWNER/PRIME CONTRATOR NAME: _____
PROJECT NAME: _____
PROJECT STREET ADDRESS: _____
PROJECT CITY: _____ PROJECT COUNTY: _____
OWNER/PRIME CONTRACTOR MAILING ADDRESS: _____
MAILING CITY: _____ STATE: _____ ZIP: _____
CONTACT PERSON: _____ CONTACT PHONE NUMBER: (_____) _____
EMAIL ADDRESS: _____

INSPECTION DOCUMENTATION

DATE (mo/day/yr)	TIME (hr:min AM/PM)	ANY DEFICIENCIES? (CHECK IF YES)	INSPECTOR(S)
		<input type="checkbox"/>	
		<input type="checkbox"/>	
		<input type="checkbox"/>	
		<input type="checkbox"/>	
		<input type="checkbox"/>	
		<input type="checkbox"/>	

Deficiencies Noted During any Inspection (give date(s); attach additional sheets if necessary): _____

Corrective Action Taken or Planned (give date(s); attach additional sheets if necessary): _____

Based upon this inspection, which I or personnel under my direct supervision conducted, I certify that all erosion and sediment controls have been implemented and maintained, except for those deficiencies noted above, in accordance with the Storm Water Pollution Prevention Plan (SWPPP) and sound engineering practices as required by the above referenced permit. I further certify that the LCN01 and SWPPP information is up to date.

I certify under penalty of law that this document and all attachments were prepared under my direction or supervision in accordance with a system designed to assure that qualified personnel properly gather and evaluate the information submitted. Based on my inquiry of the person or persons responsible for gathering the information, the information submitted is, to the best of my knowledge and belief, true, accurate and complete. I am aware that there are significant penalties for submitting false information, including the possibility of fines and imprisonment for knowing violations.

Authorized Signature

Date

Printed Name

Title

Major Modification Form

**MAJOR MODIFICATION FORM
FOR LARGE CONSTRUCTION GENERAL PERMIT**
Coverage No. MSR10 _____ County _____



INSTRUCTIONS

Coverage recipients shall notify the Mississippi Department of Environmental Quality at least 30 days in advance of the following activities (check all that apply). This form should be submitted with a modified Storm Water Pollution Prevention Plan (SWPPP), updated USGS topographic map, Corps of Engineers Section 404 documentation and wastewater collection and treatment information, as appropriate.

- ☐ SWPPP details have been developed and are ready for MDEQ review for subsequent phases of an existing, covered project.
- ☐ "Footprint" identified in the original LCNOI is proposed to be enlarged.

This form must be signed by the current coverage recipient under Mississippi's Large Construction General Permit. A different developer of new phases of existing subdivisions must apply for separate permit coverage through the submittal of a new complete LCNOI package. Coverage recipients are authorized to discharge storm water associated with proposed expansions of existing subdivisions or subsequent phases, under the conditions of the General Permit, only upon receipt of written notification of approval by MDEQ. All other modifications, such as changes of erosion and sediment controls used, must be in accordance with ACT6, S-1 (6) and S-2 (7) of the General Permit.

ALL INFORMATION MUST BE COMPLETED (indicate "N/A" where not applicable)

COVERAGE RECIPIENT INFORMATION

COVERAGE RECIPIENT CONTACT NAME: _____ TEL # (____) _____

COMPANY NAME: _____

STREET OR P.O. BOX: _____

CITY: _____ STATE: _____ ZIP: _____ E-MAIL: _____

PROJECT INFORMATION

PROJECT NAME: _____

CITY: _____

ADDITIONAL ACREAGE TO BE DISTURBED: _____ TOTAL PROJECT ACREAGE: _____

I certify under penalty of law that this document and all attachments were prepared under my direction or supervision in accordance with a system designed to assure that qualified personnel properly gathered and evaluated the information submitted. Based on my inquiry of the person or persons who manage the system, or those persons directly responsible for gathering the information, the information submitted is, to the best of my knowledge and belief, true, accurate and complete. I am aware that there are significant penalties for submitting false information, including the possibility of fine and imprisonment for knowing violations.

Signature (must be signed by coverage recipient)

Date

Printed Name

Title

Please submit this form to:

Chief, Environmental Permits Division
MS Department of Environmental Quality, Office of Pollution Control
P.O. Box 2261
Jackson, Mississippi 39225

**Request for Transfer of Permit, General Permit Coverage,
and/or Name Change**

Environmental Permits for Industrial Facilities

Request for Transfer of Permit, General Permit Coverage and/or Name Change

Instructions: For Ownership Change-Complete all Items on Page 1 (except Item VIII) and Page 2 (reverse side).
For Name Change Only-Complete Items I, II, V, VI, VII, VIII, and Page 2 (reverse side).

Note-This form should be submitted to MDEQ when a transferal date is finalized but prior to the actual transfer.

<p>Item I.</p> <p>Facility Name: _____</p> <p>Location: (Do Not Use P.O. Box)</p> <p>Street: _____</p> <p>City: _____ State: <u>MS</u> Zip: _____</p> <p>County: _____</p> <p>Telephone: (_____) _____</p>	<p>Item II.</p> <p>Responsible official after transfer or name change:</p> <p>Name: _____</p> <p>Title: _____</p> <p>Mailing Address:</p> <p>Street/P.O. Box: _____</p> <p>City: _____ State: _____ Zip: _____</p> <p>Telephone (_____) _____</p>				
<p>Item III.</p> <p>Previous Permittee¹: _____</p> <p>Mailing Address:</p> <p>Street/P.O. Box: _____</p> <p>City: _____ State: _____ Zip: _____</p> <p>Telephone: (_____) _____</p>	<p>Item IV.</p> <p>New Permittee¹: _____</p> <p>Mailing Address:</p> <p>Street/P.O. Box: _____</p> <p>City: _____ State: _____ Zip: _____</p> <p>Telephone: (_____) _____</p>				
<p>Item V.</p> <p>Industrial Activity SIC Code: _____</p> <p>Brief Description: _____</p>	<p>Item VI.</p> <p>Will Facility Operations Change? Yes _____ No _____</p> <p>If yes, the appropriate applications and permits may require modification prior to change.</p>				
<p>Item VII.</p> <p>Will Facility Name Change? Yes _____ No _____</p> <p>If Yes, Provide New Name for Permit Coverage.</p> <p>New Name: _____</p>	<p>Item VIII.</p> <p>Signature for Name Change</p> <p>Print Name: _____</p> <p>Authorized Signature²: _____</p> <p>Title: _____ Date: _____</p>				
<p>Item IX.</p> <p>We the undersigned request transfer of permit(s) and/or permit coverage(s) listed on the backside of this form.</p> <p>From: _____</p> <p>To: _____ Acquisition Date: _____</p> <p>By signature below, the recipient certifies that: 1) they are aware of the requirements of the permit(s), 2) the applicant can demonstrate to the Permit Board it has the financial resources and operational expertise and 3) agrees to accept responsibility and liability for the permit(s) listed on the back of this document. By signature below, the previous permittee is requesting that the permit(s) and/or permit coverage(s) be transferred to the recipient. The transfer of the permit(s) or permit coverage(s) will be by written notification from the Office of Pollution Control (OPC). The OPC may require submittal of information regarding financial capability and past compliance history of the recipient.</p> <table style="width: 100%; margin-top: 20px;"> <tr> <td style="width: 50%;"> <p>_____ Print New Permittee¹ Name</p> <p>_____ New Authorized Signature²</p> <p>_____ Title</p> </td> <td style="width: 50%;"> <p>_____ Print Previous Permittee¹ Name</p> <p>_____ Previous Authorized Signature²</p> <p>_____ Title</p> </td> </tr> <tr> <td style="text-align: center;"> <p>_____ Date</p> </td> <td style="text-align: center;"> <p>_____ Date</p> </td> </tr> </table>		<p>_____ Print New Permittee¹ Name</p> <p>_____ New Authorized Signature²</p> <p>_____ Title</p>	<p>_____ Print Previous Permittee¹ Name</p> <p>_____ Previous Authorized Signature²</p> <p>_____ Title</p>	<p>_____ Date</p>	<p>_____ Date</p>
<p>_____ Print New Permittee¹ Name</p> <p>_____ New Authorized Signature²</p> <p>_____ Title</p>	<p>_____ Print Previous Permittee¹ Name</p> <p>_____ Previous Authorized Signature²</p> <p>_____ Title</p>				
<p>_____ Date</p>	<p>_____ Date</p>				

¹A Permittee is a company or individual that has been issued an individual permit or coverage under a general permit.

²Authorized Signature must be owner or in the case of a corporation, a corporate officer as defined in Regulations 11 Miss. Admin. Code Pt. 2, Ch. 2. and 11 Miss. Admin. Code Pt. 6, Ch. 1.

Mississippi Department of Environmental Quality/Office of Pollution Control
P.O. Box 2261
Jackson, Mississippi 39225
(601) 961-5171

<p>Item X. Storm Water</p> <p>(Check One)</p> <p><input type="checkbox"/> A Storm Water Pollution Prevention Plan (SWPPP) is not required for the site.</p> <p><input type="checkbox"/> The recipient certifies that they have received a copy of the Office of Pollution Control approved SWPPP from the original owner.</p> <p><input type="checkbox"/> The recipient is submitting a new SWPPP, which is attached to this form.</p> <p><input type="checkbox"/> A copy of the SWPPP cannot be obtained from the original owner.</p>	<p>Item XI. Hazardous Waste ID Number</p> <p>EPA ID No. _____</p> <p>(Check One)</p> <p><input type="checkbox"/> An EPA Hazardous Waste ID Number is not required for the site.</p> <p><input type="checkbox"/> The site's EPA ID Number is listed above and a Notification of Regulated Waste Activity Form is attached.</p>
<p>Item XII. Permit(s) and/or Coverage(s) to be Transferred</p>	
<p>Permit Type: _____</p> <p>Permit/Coverage No.: _____</p> <p>Permit Issuance Date: _____</p> <p>Date of General Permit Coverage: _____</p> <p>Permit Expiration Date: _____</p>	<p>Permit Type: _____</p> <p>Permit/Coverage No.: _____</p> <p>Permit Issuance Date: _____</p> <p>Date of General Permit Coverage: _____</p> <p>Permit Expiration Date: _____</p>
<p>Permit Type: _____</p> <p>Permit/Coverage No.: _____</p> <p>Permit Issuance Date: _____</p> <p>Date of General Permit Coverage: _____</p> <p>Permit Expiration Date: _____</p>	<p>Permit Type: _____</p> <p>Permit/Coverage No.: _____</p> <p>Permit Issuance Date: _____</p> <p>Date of General Permit Coverage: _____</p> <p>Permit Expiration Date: _____</p>
<p>Permit Type: _____</p> <p>Permit/Coverage No.: _____</p> <p>Permit Issuance Date: _____</p> <p>Date of General Permit Coverage: _____</p> <p>Permit Expiration Date: _____</p>	<p>Permit Type: _____</p> <p>Permit/Coverage No.: _____</p> <p>Permit Issuance Date: _____</p> <p>Date of General Permit Coverage: _____</p> <p>Permit Expiration Date: _____</p>
<p>Permit Type: _____</p> <p>Permit/Coverage No.: _____</p> <p>Permit Issuance Date: _____</p> <p>Date of General Permit Coverage: _____</p> <p>Permit Expiration Date: _____</p>	<p>OTHER INFORMATION:</p>

Inspeciton Suspension Form

INSPECTION SUSPENSION FORM

UNDER LARGE CONSTRUCTION STORM WATER GENERAL NPDES PERMIT MSR10



MISSISSIPPI DEPARTMENT OF
ENVIRONMENTAL QUALITY

INSTRUCTIONS

Coverage recipients under Mississippi's Large Construction Storm Water General Permit may temporarily suspend required weekly inspections of erosion and sediment controls and monthly record keeping by submission of this form. Inspections may be suspended only when land disturbing activities have ceased, no further land disturbing activities are planned for a period of at least six (6) months, the site is stable with no active erosion, and vegetative cover has been established (see ACT9, S-1). The coverage recipient is responsible for all permit conditions during the suspension period and nothing in this condition shall limit the rights of MDEQ to take enforcement or other actions against the coverage recipient. Once land disturbing activities resume MDEQ must be notified and all inspections and record keeping required by the permit must also resume. Color photographs, representative of the construction site, must be submitted with this inspection form.

COVERAGE RECIPIENT INFORMATION

COVERAGE RECIPIENT CONTACT PERSON: _____

COMPANY NAME: _____

STREET OR P.O. BOX: _____

CITY: _____ STATE: _____ ZIP: _____

PHONE # (INCLUDE AREA CODE): _____ E-MAIL: _____

PROJECT INFORMATION

CONSTRUCTION STORM WATER GENERAL PERMIT COVERAGE NUMBER: **MSR10** _ _ _ _

PROJECT NAME: _____

CITY: _____ COUNTY: _____

I certify under penalty of law that this document and all attachments were prepared under my direction or supervision in accordance with a system designed to assure that qualified personnel properly gathered and evaluated the information submitted. Based on my inquiry of the person or persons who manage the system, or those persons directly responsible for gathering the information, the information submitted is, to the best of my knowledge and belief, true, accurate and complete. I am aware that there are significant penalties for submitting false information, including the possibility of fine and imprisonment for knowing violations. **I further certify that: land disturbing activities have ceased, no further land disturbing activities are planned for a period of at least six (6) months, the site is stable with no active erosion, and vegetative cover has been established.**

Signature (must be signed by coverage recipient)

Date Signed

Printed Name

Title

Please submit this form to:

Chief, Environmental Permits Division
MS Department of Environmental Quality, Office of Pollution Control
P.O. Box 2261
Jackson, Mississippi 39225

Request for Termination of Coverage

Request for Termination (RFT) of Coverage



LARGE CONSTRUCTION GENERAL PERMIT
Coverage No. MSR10 _____ **County** _____
(Fill in your Certificate of Coverage Number and County)

This form must be submitted within thirty (30) days of achieving final stabilization (see ACT10, S-1 of general permit). Failure to submit this form is a violation of permit conditions.

The signatory of this form must be the owner or operator (prime contractor) who is the current coverage recipient (rather than the project manager or environmental consultant).

(Please Print or Type)

Project Name: _____

Physical Site Street Address (if not available, indicate nearest named road): _____

City: _____ **County:** _____ **Zip:** _____

Coverage Recipient Company Name: _____

Street Address / P.O. Box: _____

City: _____ **State:** _____ **Zip:** _____

Coverage Recipient Contact Name and Position: _____ **Tel. #: ()** _____

Has another owner(s) or operator(s) assumed control over all areas of the site that have not reached final stabilization?

RESIDENTIAL SUBDIVISIONS:

- ☐ **YES. A copy of the Registration Form for Residential Lot Coverage for each lot or out parcel that has been sold and a site map, indicating which lots have been sold, are attached.**
- ☐ **NO. Coverage may not be terminated until all areas have reached final stabilization.**

COMMERCIAL DEVELOPMENT:

- ☐ **YES. A copy of the site map, indicating which out-parcels have been sold, is attached.**
- ☐ **NO. Coverage may not be terminated until all areas have reached final stabilization.**

I certify under penalty of law that this document and all attachments were prepared under my direction or supervision in accordance with a system designed to assure that qualified personnel properly gathered and evaluated the information submitted. Based on my inquiry of the person or persons who manage the system, or those persons directly responsible for gathering the information, the information submitted is, to the best of my knowledge and belief, true, accurate and complete. I am aware that there are significant penalties for submitting false information, including the possibility of fines and imprisonment for knowing violations. I understand that by submitting this Request for Termination and receiving written confirmation, I will no longer be authorized to discharge storm water associated with construction activity under this general permit. Discharging pollutants associated with construction activity to waters of the State without proper permit coverage is a violation of state law. I also understand that the submittal of this Request for Termination does not release an owner or operator from liability for any violations of this permit or the Clean Water Act.

Authorized Name (Print)

Telephone

Signature

Date Signed

¹This application shall be signed according to the General Permit, ACT11, T-7 as follows:

- For a corporation, by a responsible corporate officer.
- For a partnership, by a general partner.
- For a sole proprietorship, by the proprietor.
- For a municipal, state or other public facility, by principal executive officer, mayor, or ranking elected official.

After signing please mail to: Chief, Environmental Permits Division
MS Department of Environmental Quality, Office of Pollution Control
P.O. Box 2261
Jackson, Mississippi 39225

EPSC Plans

