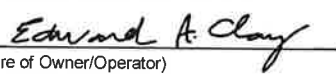
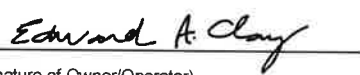

MISSISSIPPI ASBESTOS DEMOLITION/RENOVATION NOTIFICATION FORM

Mail notification to: MDEQ Asbestos and Lead Branch, 515 E. Amite Street, Jackson, MS 39201

MDEQ Use Only: <input checked="" type="checkbox"/> Email <input type="checkbox"/> Mail <input type="checkbox"/> Hand Delivery	Postmark (mail only)	Date Received 04-14-2024	AI Number
I. Type of Notification (O=Original R=Revised C=Canceled A= Annual): O			
II. TYPE OF OPERATION (D=Demo O= Ordered Demo R=Renovation E=Emer. Renovation): D			
III. FACILITY DESCRIPTION (Include building name, number and floor or room number):			
Bldg. Name: Budget Inn			
Address: 1673 Cecil Shelton Road			
City: Grenada	State: MS	Zip: 38901	
Site Location: 1st and 2nd Floor Guest Rooms Ceilings			Tel: 662-614-1512
Building Size: Appx.25,000 Sq Ft Present Use: VACANT	# of Floors: 2	Age in Years: Appx 40+	
Prior Use: Motel			
IV. FACILITY INFORMATION (Identify owner, asbestos removal contractor, and other operator)			
OWNER NAME Greater Grenada Partnership			
Address: 95 SW Frontge RD			
City: Grenada	State: MS	Zip: 38901	
Contact: Harrison Matthews			Tel: 662-229-9502
ASBESTOS REMOVAL CONTRACTOR: Edward Clay - EAC Environmental			
Address: 4546 Cal-Steens Road			
City: Caledonia	State: MS	Zip: 39740	
Contact: Edward Clay			Tel: 662-386-6386
Certification Number: ABC-00005192		Expiration Date: 11-03-24	
OTHER OPERATOR: Double S, Inc.			
Address: 200 Houston Road			
City: Grenada	State: MS	Zip: 38901	
Contact: Scooter Shields			Tel: 662-614-1512
V. WAS SITE INSPECTED TO DETERMINE PRESENCE OF ASBESTOS? (Yes/No): YES			
WAS ASBESTOS PRESENT? (Yes/No): Yes		Inspection Date: 07-08-23	
Inspector: Brad McKnight	Certification Number: ABI-00001685	Expiration Date: 06-07-24	
VI. SUSPECT MATERIALS SAMPLED AND PROCEDURES USED TO DETECT THE PRESENCE OF ASBESTOS :			
Ceiling Texture, VCT, Carpet with Mastic, Wallpaper with Mastic, Drywall Joint Compound, Exterior Stucco Analyzed by PLM see attached report			
VII. QUANTITY OF RACM TO BE REMOVED: Chrysotile Asbestos found in Ceiling Texture			
Pipes (LN FT):	Surface Area (SQ FT): Appx 22,400	Volume of Facility Components (CU FT):	
VIII. QUANTITY OF NONFRIABLE ASBESTOS NOT REMOVED:			
Category I:		Category II:	
IX. SCHEDULED DATES ASBESTOS REMOVAL (MM/DD/YY) Start: 05-10-24 Complete: 05-24-24			
X. SCHEDULED DATES DEMO/RENOVATION (MM/DD/YY) Start: 05-28-24 Complete: 06-28-24			

XI. DESCRIPTION OF PLANNED DEMOLITION OR RENOVATION WORK, AND METHOD(S) TO BE USED:		
Using "Wet Method" the ACM will be removed with hand tools		
XII. DESCRIPTION OF WORK PRACTICES AND ENGINEERING CONTROLS TO BE USED TO PREVENT EMISSIONS OF ASBESTOS AT THE DEMOLITION OR RENOVATION SITE:		
Containment, Negative Air Machines, Airless Sprayer using water and surfactant for Wet Method Removal, Double Bag ACM in 6 mil poly		
XIII. WASTE TRANSPORTER #1		
Name: EAC Environmental		
Address: 4564 Cal Steens RD		
City: Caledonia	State: MS	Zip: 39740
Contact Person: Ed Clay	Tel: 662-386-6386	
WASTE TRANSPORTER #2		
Name: Waste Pro		
Address: 1600 S 12th ST		
City: Columbus	State: MS	Zip: 39701
Contact Person: RuthAnn Farris	Tel:	
XIV. WASTE DISPOSAL SITE		
Name: RoBo Landfill		
Address: 6447 Wahalak Road		
City: Scooba	State: MS	Zip: 39358
Contact Person: Roland Edmonds	Tel: 662-798-4795	
XV. IF DEMOLITION ORDERED BY A GOVERNMENT AGENCY, PLEASE IDENTIFY THE AGENCY BELOW:		
Name:	Title:	
Authority:		
Date of Order (MM/DD/YY):	Date Ordered to Begin (MM/DD/YY):	
XVI. FOR EMERGENCY RENOVATIONS:		
Date and Hour of Emergency (MM/DD/YY):		
Description of the sudden unexpected event:		
Explanation of how the event caused unsafe conditions or would cause equipment damage or an unreasonable financial burden:		
XVII. DESCRIPTION OF PROCEDURES TO BE FOLLOWED IN THE EVENT THAT UNEXPECTED ASBESTOS IS FOUND OR PREVIOUSLY NONFRIABLE ASBESTOS MATERIAL BECOMES CRUMBLED, PULVERIZED, OR REDUCED TO POWDER:		
Contain material, notify owner, and MDEQ		
XVIII. I CERTIFY THAT AN INDIVIDUAL TRAINED IN THE PROVISIONS OF THIS REGULATION (40 CFR PART 61, SUBPART M) WILL BE ONSITE DURING THE DEMOLITION OR RENOVATION, AND EVIDENCE THAT THE REQUIRED TRAINING HAS BEEN ACCOMPLISHED BY THIS PERSON WILL BE AVAILABLE FOR INSPECTION DURING NORMAL BUSINESS HOURS.		
Edward A. Clay		04-14-24
Type or Print Name	(Signature of Owner/Operator)	(Date)
XIX. I CERTIFY THAT THE ABOVE INFORMATION IS CORRECT:		
Edward A. Clay		04-14-24
Type or Print Name	(Signature of Owner/Operator)	(Date)

Asbestos Survey Report

Cecil Shelton Properties – Knights Inn and Budget Inn
I-55 and Highway 8
Grenada, Mississippi

August 7, 2023 | Terracon Project No. EB237097



PREPARED FOR:

Greater Grenada Partnership
Grenada, Mississippi

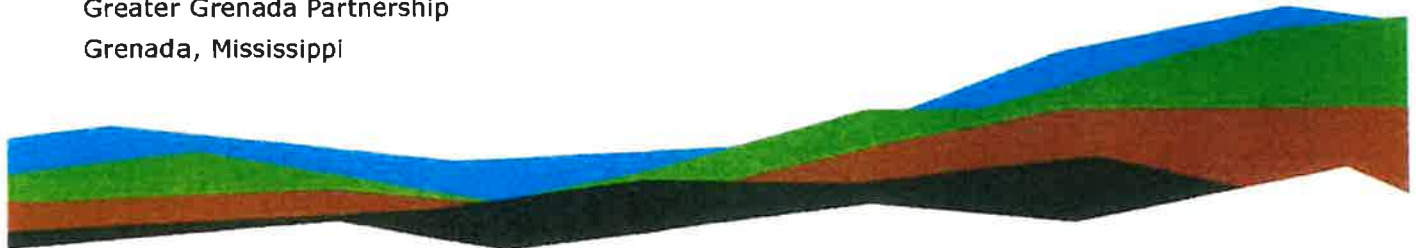

Prepared by:

Terracon Consultants, Inc.
Ridgeland, Mississippi



Nationwide
Terracon.com

- Facilities
- Environmental
- Geotechnical
- Materials



859 S. Pear Orchard Road
Ridgeland, Mississippi 39043
P (601) 956-4467
F (601) 956-9533
Terracon.com

August 7, 2023

Greater Grenada Partnership
95 SW Frontage Road
Grenada, Mississippi 38901

Attn: Mr. Matthew Harrison
P: (662) 229-9502
E: matthew@grenadameansbusiness.com

RE: **Asbestos Survey Report**
Cecil Shelton Properties - Knights Inn and Budget Inn
I-55 and Highway 8
Grenada, Mississippi
Terracon Project No. EB237097

Dear Mr. Harrison:

Terracon Consultants, Inc. (Terracon) is pleased to submit the attached report for the above referenced site to Greater Grenada Partnership. The purpose of this report is to present the results of an asbestos survey performed on July 8, 2023. This survey was conducted in general accordance with your proposal June 6, 2023. Terracon understands that this survey was requested due to planned demolition of the buildings.

Asbestos-containing materials (ACM) were identified in the suspect materials sampled and submitted for analysis from both buildings at the subject site. Please refer to the attached report for details.

Terracon appreciates the opportunity to provide this service to Greater Grenada Partnership. If you have any questions regarding this report, please contact the undersigned at (769) 233-2072.

Sincerely,
Terracon Consultants, Inc.

Brad McKnight, C.E.S.
Project Industrial Hygienist

for Alicia Coley, CIH
Authorized Project Reviewer

Attachments



TABLE OF CONTENTS

EXECUTIVE SUMMARY	1
1.0 INTRODUCTION.....	1
1.1 Project Objective.....	1
1.2 Reliance	1
2.0 BUILDING DESCRIPTION.....	2
3.0 ASBESTOS SURVEY.....	2
3.1 Field Activities	2
3 1.1 Visual Assessment	2
3 1.2 Physical Assessment	2
3 1.3 Sample Collection	3
3 1.4 Sample Analysis.....	3
4.0 REGULATORY OVERVIEW.....	3
5.0 FINDINGS.....	4
6.0 RECOMMENDATIONS	5
7.0 LIMITATIONS/GENERAL COMMENTS	5

APPENDICES

- APPENDIX A ASBESTOS SURVEY SAMPLE SUMMARY
- APPENDIX B ASBESTOS LABORATORY ANALYTICAL REPORT
- APPENDIX C PHOTOGRAPHS OF SAMPLED AREAS
- APPENDIX D SAMPLE LOCATION DRAWING
- APPENDIX E CERTIFICATIONS

EXECUTIVE SUMMARY

The purpose of this report is to present the results of an asbestos survey performed at the Knights Inn and Budget Inn located on I-55 and Highway 8 in Grenada, Mississippi. We understand that this survey was requested due to proposed demolition activities. Forty-eight (48) bulk samples were collected from identified suspect asbestos-containing materials (ACM). Based upon this survey, asbestos was identified in the samples collected from the Knights Inn in the joint compound of the wall board system, ceiling surface material, and the white 12" x 12" floor tile and black mastic. In the samples collected from the Budget Inn, asbestos was identified in the ceiling surface material.

1.0 INTRODUCTION

Terracon Consultants, Inc. (Terracon) conducted an asbestos survey of the Knights Inn and Budget Inn located at I-55 and Highway 8 in Grenada, Mississippi. The survey was conducted on July 8, 2023, by Brad McKnight and in general accordance with your proposal dated June 6, 2023. The buildings components were surveyed and homogeneous areas of suspect ACM were visually identified and documented. Although reasonable effort was made to survey accessible suspect materials, additional suspect but unsampled materials could be located in walls, in voids or in other concealed areas. The building's exterior and roofs were included in the survey.

Suspect ACM samples were collected in general accordance with the sampling protocols outlined in United States Environmental Protection Agency (EPA) 40 Code of Federal Regulations (CFR) Part 763 Subpart E 763, known as the Asbestos Hazard Emergency Response Act (AHERA). Samples were delivered to an accredited laboratory for analysis by Polarized Light Microscopy (PLM).

1.1 Project Objective

We understand this asbestos survey was requested due to planned demolition of the two existing hotel buildings located on the site. EPA regulation 40 CFR part 61, Subpart M of the asbestos National Emission Standards for Hazardous Air Pollutants (NESHAP) and Mississippi Administration Code Title 11, Part 2, Chapter 1, Rule 1.8, prohibits the release of asbestos fibers to the atmosphere during renovation or demolition activities. The asbestos NESHAP and MDEQ requires that potentially regulated ACM (RACM) be identified, classified and quantified prior to planned disturbances or demolition activities.

1.2 Reliance

This report is for the exclusive use of Greater Grenada Partnership for the project being discussed. Reliance by any other party is prohibited without the written authorization of Greater Grenada Partnership and Terracon. Reliance on this report by Greater Grenada

Partnership and all authorized parties will be subject to the terms, conditions, and limitations stated in proposal. The limitations of liability defined in Terracon's Agreement for Services are the aggregate limit of Terracon's liability to Greater Grenada Partnership.

2.0 BUILDING DESCRIPTION

The survey was comprised of the two (2) existing buildings located in Grenada, Mississippi. The buildings included the following:

- The Knights Inn an approximately 12,350 square foot two-story building
- The Budget Inn an approximately 11,550 square foot two-story building

The two buildings were similar in construction with similar suspect materials that were sampled during the survey. The interior walls consisted of gypsum wallboard. The floors consisted of carpeting or vinyl floor tile. The ceilings were finished textured gypsum wallboard. The exterior walls consisted of brick or stucco. The roof of both buildings is metal.

3.0 ASBESTOS SURVEY

3.1 Field Activities

The survey was conducted by Brad McKnight, a State of Mississippi licensed asbestos inspector. A copy of the asbestos inspector's license is attached as Appendix E. The survey was conducted in general accordance with the sample collection protocols established in USEPA 40 CFR Part 763, Subpart E, Section 763.86, AHERA. A summary of survey activities is provided below.

3.1.1 Visual Assessment

Survey activities were initiated with visual observations of the interior of the spaces to identify homogeneous areas of suspect ACM. A homogeneous area (HA) consists of building materials that appear similar throughout in terms of color and texture with consideration given to the date of application. The assessment was conducted in visually accessible areas of the building proposed for demolition. Materials identified as glass, wood, metal or rubber were not considered suspect ACM.

3.1.2 Physical Assessment

A physical assessment of each HA of suspect ACM was conducted to assess the friability and condition of the materials. A friable material is defined by the USEPA as a material

which can be crumbled, pulverized or reduced to powder by hand pressure when dry. Friability was assessed by physically touching suspect materials.

3.1.3 Sample Collection

Based on results of the visual observation, bulk samples of suspect ACM were collected in general accordance with USEPA AHERA sampling protocols. Samples of suspect materials were collected from randomly selected locations in each homogeneous area. The inspectors collected bulk samples using wet methods as applicable to reduce the potential for fiber release. Samples were placed in sealable containers and labeled with unique sample numbers using an indelible marker.

The selection of sample locations and frequency of sampling were based on Terracon's observations and the assumption that like materials in the same area are homogeneous in content.

Terracon collected forty-eight (48) samples from twelve (12) homogeneous areas (HA) of suspect ACM. A summary of suspect ACM samples collected are included as Appendix A. Photos of homogeneous materials sampled are included in Appendix C. A sample location figure is presented in Appendix D.

3.1.4 Sample Analysis

Bulk samples were submitted under chain of custody to Quantem Laboratories (QL) of Oklahoma City, Oklahoma, for analysis by polarized light microscopy with dispersion staining techniques per USEPA methodology 600/R-93/116. The percentage of asbestos, where applicable, was determined by microscopic visual estimation. Quantem Laboratories is accredited under the National Voluntary Laboratory Accreditation Program (NVLAP) Accreditation No. 101959-0.

4.0 REGULATORY OVERVIEW

The State of Mississippi utilizes the Mississippi Department of Environmental Quality (MDEQ) to regulate and enforce asbestos-related activity within the state. MDEQ requires that all individual or company performing an asbestos-related activity be accredited or licensed by the State of Mississippi, through the MDEQ. MDEQ requires each owner or operator of a demolition or renovation activity to notify at least 10 working days before asbestos stripping or removal work or any other activity begins that would break up, dislodge, or similarly disturb asbestos material. An asbestos-related activity consists of the disturbance (whether intentional or unintentional) or abatement of ACM, the performance of asbestos surveys, the development of management plans, asbestos project design, monitoring for airborne asbestos.

The asbestos NESHAP (40 CFR Part 61, Subpart M) regulates asbestos fiber emissions and asbestos waste disposal practices. The asbestos NESHAP regulation also requires the identification and classification of existing ACM according to friability prior to demolition or renovation activity. Friable ACM is a material containing more than 1% asbestos that, when dry, can be crumbled, pulverized or reduced to powder by hand pressure. All friable ACM is considered regulated asbestos containing material (RACM).

The asbestos NESHAP regulation classifies ACM as either RACM, Category I non-friable ACM or Category II non-friable ACM. RACM includes all friable ACM, along with Category I and Category II non-friable ACM that has become friable, will be or has been subjected to sanding, grinding, cutting or abrading, or ACM that has a high probability of becoming or has become crumbled, pulverized, or reduced to powder in the course of renovation or demolition activity. Category I non-friable ACM are exclusively asbestos-containing packings, gaskets, resilient floor coverings, resilient floor covering mastics and asphalt roofing products that contain more than 1% asbestos. Category II non-friable ACM and all other non-friable materials other than Category I non-friable ACM that contain more than 1% asbestos. Category II non-friable ACM generally includes but is not limited to cementitious material such as: cement pipes, cement siding, cement panels, glazing, mortar and grouts.

The United States Occupational Safety and Health Administration (USOSHA) asbestos standard for construction (29 CFR 1926.1101) regulates workplace exposure to asbestos. The USOSHA standard requires that employee exposure to airborne asbestos must not exceed 0.1 fibers per cubic centimeter of air (0.1 f/cc) as an eight-hour time weighted average (TWA) and not exceed 1.0 fibers per cubic centimeter of air (1.0 f/cc) over a 30-minute time period known as an excursion limit (EL). The TWA and EL are known as USOSHA's asbestos permissible exposure limits (PELs). The USOSHA standard classifies construction and maintenance activities which could disturb ACM and specifies work practices and precautions which employers must follow when engaging in each class of regulated work.

5.0 FINDINGS

Based upon this survey, asbestos was detected in several of the suspect materials sampled and submitted for analysis. Laboratory analytical reports are included as Appendix B.

Laboratory analysis confirmed the following asbestos-containing materials:

- **Knights Inn:** The joint compound located within the gypsum wallboard system, the ceiling surface material, and the 12"x12" white floor tile with black mastic.
- **Budget Inn:** The ceiling surface material.

It should be noted that suspect materials, other than those identified during this survey may exist within the buildings. Should suspect materials other than those which were identified during this survey be uncovered during the demolition process, those materials should be assumed asbestos containing until sampling and analysis can confirm or deny their asbestos content.

The State of Mississippi utilizes the MDEQ to regulate and enforce asbestos-related activity within the state. The MDEQ requires that an inspection be conducted by a person currently accredited as an MDEQ asbestos inspector.

A "State of Mississippi Notification of Demolition/Renovation Form" is required to be submitted to the MDEQ 10 days prior to commencing demolition activities or any renovation activity, including asbestos abatement, affecting at least 160 square feet, 260 linear feet, or 35 cubic feet of regulated asbestos-containing material. The form should be completed and signed by authorized site personnel and submitted to the MDEQ 10 days prior to the implementation of proposed renovation or demolition activities at the site.

6.0 RECOMMENDATIONS

Terracon recommends that the confirmed ACM be removed by a Mississippi-licensed asbestos abatement contractor prior to disturbance of this material.

Contractors performing the proposed demolition work should be advised of the locations of materials containing asbestos and their responsibilities with respect to protection of employee exposures to asbestos found in the OSHA Asbestos standard for construction (29 CFR 1926.1101).

7.0 LIMITATIONS/GENERAL COMMENTS

Terracon did not perform sampling which required demolition or destructive activities such as knocking holes in walls, dismantling of equipment or removal of protective coverings. Reasonable efforts to access suspect materials within known areas of restricted access (e.g., crawl spaces) were made; however, confined spaces or areas which may pose a health or safety risk to Terracon personnel were not sampled. Sampling did not include suspect materials which could not be safely reached with available ladders/man-lifts.

This asbestos survey was conducted in a manner consistent with the level of care and skill ordinarily exercised by members of the profession currently practicing under similar conditions in the same locale. The results, findings, conclusions and recommendations expressed in this report are based on conditions observed during our survey of the buildings. The information contained in this report is relevant to the date on which this



survey was performed and should not be relied upon to represent conditions at a later date.

This report has been prepared on behalf of and exclusively for use by Greater Grenada Partnership for specific application to their project as discusses. This report is not a bidding document. Contractors or consultants reviewing this report must draw their own conclusions regarding further investigation or remediation deemed necessary. Terracon does not warrant the work of regulatory agencies, laboratories or other third parties supplying information which may have been used in the preparation of this report. No warranty, express or implied, is made.

APPENDIX A
ASBESTOS SURVEY SAMPLE SUMMARY

TABLE 1.0
CONFIRMED ASBESTOS CONTAINING MATERIALS
CECIL SHELTON PROPERTIES
KNIGHT INN AND BUDGET INN
GRENADA, MISSISSIPPI
TERRACON PROJECT NO. EB237097

KNIGHTS INN						
HA	Material Description	Material Location	NESHAP Category	Condition	Lab Results	Quantity*
03	Gypsum Wallboard/ Joint Compound/Tape	Throughout Facility	Category II	Good	Texture: ND Adhesive: ND Joint Compound: 2% C Wallboard: ND Composite: <1% C	84,000 SF
04	White/Tan Ceiling Surface Material	Throughout Facility	Category II	Good	White Texture: ND Tan Texture: 2% C	24,000 SF
06	12" x 12" Floor Tile/Black Mastic	Maintenance Room/Laundry Are	Category I	Poor	Tile: 2% C Mastic: 4% C	2,500 SF
BUDGET INN						
HA	Material Description	Material Location	NESHAP Category	Condition	Lab Results	Quantity*
06	Ceiling Surface Material	Throughout Facility	Category II	Good	3% C	23,000 SF

*Quantities are estimates only and not to be used for bidding purposes

SF: Square Feet

C Chrysotile Asbestos

HA: Homogeneous Area

ND: No Asbestos Detected

TABLE 2.0
ASBESTOS SURVEY SAMPLE SUMMARY
 CECIL SHELTON PROPERTIES
 KNIGHT INN AND BUDGET INN
 GRENADA, MISSISSIPPI
 TERRACON PROJECT NO. EB237097
 KNIGHTS INN

HA	Material Description	Material Location	Condition	Sample Number	Lab Results
01	Exterior Brown/Gray Stucco	Exterior Walls	Fair	01-01	Asbestos Not Present
				01-02	Asbestos Not Present
				01-03	Asbestos Not Present
02	Brown Carpet with Adhesive	Throughout Interior	Fair	02-04	Asbestos Not Present
				02-05	Asbestos Not Present
				02-06	Asbestos Not Present
				03-07	Texture: ND Adhesive: ND Joint Compound: 2% C Wallboard: ND Composite: <1% C
03	Gypsum Wallboard/Joint Compound/Tape	Throughout	Good	03-08	Texture: ND Adhesive: ND Joint Compound: 2% C Wallboard: ND Composite: <1% C
				03-09	Texture: ND Adhesive: ND Joint Compound: 2% C Wallboard: ND Composite: <1% C
				04-10	White Texture: ND Tan Texture: 2% C
04	White/Tan Ceiling Surface Material	Throughout	Fair	04-11	White Texture: ND Tan Texture: 2% C
				04-12	White Texture: ND
				04-13	White Texture: ND Tan Texture: 2% C
				04-14	White Texture: ND
				04-15	White Texture: ND
				04-16	White Texture: ND
				04-17	White Texture: ND
				04-18	White Texture: ND
05	Wallpaper with Adhesive	Guest Restrooms	Fair	05-13	Asbestos Not Present
				05-14	Asbestos Not Present
				05-15	Asbestos Not Present

HA	Material Description	Material Location	Condition	Sample Number	Lab Results
06	12" x 12" Floor Tile and Black Mastic	Maintenance Room/Laundry Area	Poor	06-16	Tile: 2% C Mastic: 4% C
				06-17	Tile: 2% C Mastic: 4% C
				06-18	Tile: 2% C Mastic: 4% C

BUDGET INN

HA	Material Description	Material Location	Condition	Sample Number	Lab Results
01	Tan Stucco	Exterior Walls	Fair	01-01	Asbestos Not Present
				01-02	Asbestos Not Present
				01-03	Asbestos Not Present
				02-04	Asbestos Not Present
02	Green Carpet with Adhesive	Throughout Building	Fair	02-05	Asbestos Not Present
				02-06	Asbestos Not Present
				03-07	Asbestos Not Present
03	Gypsum Wallboard/Joint Compound/Tape	Throughout Building	Poor	03-08	Asbestos Not Present
				03-09	Asbestos Not Present
				04-10	Asbestos Not Present
04	Wallpaper with Adhesive	Guest Restrooms	Fair	04-11	Asbestos Not Present
				04-12	Asbestos Not Present
				05-13	Asbestos Not Present
05	White Caulking	Guest Restrooms	Good	05-14	Asbestos Not Present
				05-15	Asbestos Not Present
				06-16	3% C
				06-17	3% C
				06-18	3% C
06	Ceiling Surface Material	Throughout Building	Fair	06-19	3% C
				06-20	3% C
				06-21	3% C
				06-22	3% C
				06-23	3% C
				06-24	3% C

C: Chrysotile Asbestos
HA: Homogeneous Area
ND: No Asbestos Detected

APPENDIX B
ASBESTOS LABORATORY ANALYTICAL REPORT



2033 HERITAGE PARK DR, OKLAHOMA CITY, OK 73120 1.800.822.1650

Polarized Light Microscopy Asbestos Analysis Report

QuanTEM Lab No. 360273 Client: Terracon - Ridgeland
 Account Number: C085 Brad McKnight
 Date Received: 07/13/2023
 Received By: Baylie Longstreth
 Date Analyzed: 07/18/2023 Project: Knights Inn ACM Survey - REVISED
 Analyzed By: Benjamin Hill Project Location: Granada, MS
 Methodology: EPA/600/R-93/116 Project Number: EB237097

QuanTEM Sample ID	Client Sample ID	Composition	Color / Description	Asbestos (%)	Non-Asbestos Fiber (%)	Non Fibrous
007a		Layered	Tan Adhesive	Asbestos Not Present	NA	Glue
007b		Layered	Tan Joint Compound	Asbestos Present Chrysotile 2	NA	CaCO3
007c		Layered	White Wallboard	Asbestos Not Present	Cellulose Glass Fiber 10 2	Gypsum
007d		Composite	Tan/White Joint Compound/Wallboard	Asbestos Present Chrysotile <1	Cellulose Glass Fiber 10 2	CaCO3 Gypsum
008	03-08	Layered	White Texture	Asbestos Not Present	NA	CaCO3
008a		Layered	Tan Adhesive	Asbestos Not Present	NA	Glue

Unless otherwise noted, upon receipt the condition of the sample was acceptable for analysis.

QuanTEM is a NVLAP accredited Testing PLM laboratory (Lab Code: 101959-0). This report relates only to the specific items tested.
 NVLAP accreditation applies only to analysis performed utilizing EPA—40 CFR Appendix E to Subpart E of Part 763 and EPA/600/R-93/116 methods
 This report may not be used to claim product endorsement by NVLAP or any agency of the US Government
 This report may not be reproduced except in full, without the written approval of the laboratory



2033 HERITAGE PARK DR, OKLAHOMA CITY, OK 73120 TEL: 800.822.1650

Polarized Light Microscopy Asbestos Analysis Report

Quantem Lab No. 360273

Client: Terracon - Ridgeland
Brad McKnight

Account Number: C085

Date Received: 07/13/2023

Received By: Baylie Longstreth

Date Analyzed: 07/18/2023

Project: Knights Inn ACM Survey - REVISED

Analyzed By: Benjamin Hill

Project Location: Granada, MS

Methodology: EPA/600/R-93/116

Project Number: EB237097

Quantem Sample ID	Client Sample ID	Composition	Color / Description	Asbestos (%)	Non-Asbestos Fiber (%)	Non Fibrous
008b		Layered	Tan Joint Compound	Asbestos Present Chrysotile 2	NA	CaCO3
008c		Layered	White Wallboard	Asbestos Not Present	Cellulose 10 Glass Fiber 2	Gypsum
008d		Composite	Tan/White Joint Compound/Wallboard	Asbestos Present Chrysotile <1	Cellulose 10 Glass Fiber 2	CaCO3 Gypsum
009	03-09	Layered	White Texture	Asbestos Not Present	NA	CaCO3
009a		Layered	Tan Adhesive	Asbestos Not Present	NA	Glue
009b		Layered	Tan Joint Compound	Asbestos Present Chrysotile 2	NA	CaCO3
009c		Layered	White Wallboard	Asbestos Not Present	Cellulose 10 Glass Fiber 2	Gypsum

Unless otherwise noted, upon receipt the condition of the sample was acceptable for analysis.

Quantem is a NVLAP accredited Testing PLM laboratory (Lab Code: 101959-0). This report relates only to the specific items tested.
NVLAP accreditation applies only to analysis performed utilizing EPA-40 CFR Appendix E to Subpart E of Part 763 and EPA/600/R-93/116 methods
This report may not be used to claim product endorsement by NVLAP or any agency of the US Government.

This report may not be reproduced except in full, without the written approval of the laboratory



2033 HERITAGE PARK DR, OKLAHOMA CITY, OK 73120 1.800.822.1650

Polarized Light Microscopy Asbestos Analysis Report

Quantem Lab No. 360273

Client: Terracon - Ridgeland

Account Number: C085

Brad McKnight

Date Received: 07/13/2023

Received By: Baylie Longstreth

Date Analyzed: 07/18/2023

Project: Knights Inn ACM Survey - REVISED

Analyzed By: Benjamin Hill

Project Location: Granada, MS

Methodology: EPA/600/R-93/116

Project Number: EB237097

Quantem Sample ID	Client Sample ID	Composition	Color / Description	Asbestos (%)	Non-Asbestos Fiber (%)	Non Fibrous
009d		Composite	Tan/White Joint Compound/Wallboard	Asbestos Present Chrysotile <1	Cellulose 10 Glass Fiber 2	CaCO3 Gypsum
010	04-10	Layered	White Ceiling Texture	Asbestos Not Present	NA	CaCO3 Foam
010a		Layered	Tan Ceiling Texture	Asbestos Present Chrysotile 2	NA	CaCO3 Paint
011	04-11	Layered	White Ceiling Texture	Asbestos Not Present	NA	CaCO3 Foam
011a		Layered	Tan Ceiling Texture	Asbestos Present Chrysotile 2	NA	CaCO3 Paint
012	04-12	Homogeneous	White Ceiling Texture	Asbestos Not Present	NA	CaCO3 Foam

Unless otherwise noted, upon receipt the condition of the sample was acceptable for analysis.

Quantem is a NVLAP accredited Testing PLM laboratory (Lab Code: 101959-0) This report relates only to the specific items tested
 NVLAP accreditation applies only to analysis performed utilizing EPA—40 CFR Appendix E to Subpart E of Part 763 and EPA/600/R-93/116 methods
 This report may not be used to claim product endorsement by NVLAP or any agency of the US Government.

This report may not be reproduced except in full, without the written approval of the laboratory



2033 HERITAGE PARK DR, OKLAHOMA CITY, OK 73120 1.800.822.1650

Polarized Light Microscopy Asbestos Analysis Report

QuanTEM Lab No. 360273 Client: Terracon - Ridgeland
 Account Number: C085 Brad McKnight
 Date Received: 07/13/2023
 Received By: Baylie Longstreth
 Date Analyzed: 07/18/2023 Project: Knights Inn ACM Survey - REVISED
 Analyzed By: Benjamin Hill Project Location: Granada, MS
 Methodology: EPA/600/R-93/116 Project Number: EB237097

QuanTEM Sample ID	Client Sample ID	Composition	Color / Description	Asbestos (%)	Non-Asbestos Fiber (%)	Non Fibrous
013	04-13	Layered	White Ceiling Texture	Asbestos Not Present	NA	CaCO3 Foam
013a		Layered	Tan Ceiling Texture	Asbestos Present Chrysotile 2	NA	CaCO3 Paint
014	04-14	Homogeneous	White Ceiling Texture	Asbestos Not Present	NA	CaCO3 Foam
015	04-15	Homogeneous	White Ceiling Texture	Asbestos Not Present	NA	CaCO3 Foam
016	04-16	Homogeneous	White Ceiling Texture	Asbestos Not Present	NA	CaCO3 Foam
017	04-17	Homogeneous	White Ceiling Texture	Asbestos Not Present	NA	CaCO3 Foam
018	04-18	Homogeneous	White Ceiling Texture	Asbestos Not Present	NA	CaCO3 Foam

Unless otherwise noted, upon receipt the condition of the sample was acceptable for analysis.

QuanTEM is a NVLAP accredited Testing PLM laboratory (Lab Code: 101959-0). This report relates only to the specific items tested.
 NVLAP accreditation applies only to analysis performed utilizing EPA—40 CFR Appendix E to Subpart E of Part 763 and EPA/600/R-93/116 methods.
 This report may not be used to claim product endorsement by NVLAP or any agency of the US Government.
 This report may not be reproduced except in full, without the written approval of the laboratory



2033 HERITAGE PARK DR, OKLAHOMA CITY, OK 73120 . 800.822.650

Polarized Light Microscopy Asbestos Analysis Report

QuanTEM Lab No. 360273 Client: Terracon - Ridgeland
 Account Number: C085 Brad McKnight
 Date Received: 07/13/2023
 Received By: Baylie Longstreth
 Date Analyzed: 07/18/2023 Project: Knights Inn ACM Survey - REVISED
 Analyzed By: Benjamin Hill Project Location: Granada, MS
 Methodology: EPA/600/R-93/116 Project Number: EB237097

QuanTEM Sample ID	Client Sample ID	Composition	Color / Description	Asbestos (%)	Non-Asbestos Fiber (%)	Non Fibrous
019	05-19	Layered	White Surfacing	Asbestos Not Present	NA	CaCO3
019a		Layered	Tan Wall Paper	Asbestos Not Present	Cellulose 95	Binder
019b		Layered	Clear Adhesive	Asbestos Not Present	NA	Glue
020	05-20	Layered	White Surfacing	Asbestos Not Present	NA	CaCO3
020a		Layered	Tan Wall Paper	Asbestos Not Present	Cellulose 95	Binder
020b		Layered	Clear Adhesive	Asbestos Not Present	NA	Glue

Unless otherwise noted, upon receipt the condition of the sample was acceptable for analysis.

QuanTEM is a NVLAP accredited Testing P/M laboratory (Lab Code: 101959-0) This report relates only to the specific items tested.
 NVLAP accreditation applies only to analysis performed utilizing EPA—40 CFR Appendix E to Subpart F of Part 763 and EPA/600/R-93/116 methods.
 This report may not be used to claim product endorsement by NVLAP or any agency of the US Government.
 This report may not be reproduced except in full, without the written approval of the laboratory.



2033 HERITAGE PARK DR, OKLAHOMA CITY, OK 73120 1.800.822.1650

Polarized Light Microscopy Asbestos Analysis Report

QuanTEM Lab No. 360273 Client: Terracon - Ridgeland
 Account Number: C085 Brad McKnight
 Date Received: 07/13/2023
 Received By: Baylie Longstreth
 Date Analyzed: 07/18/2023 Project: Knights Inn ACM Survey - REVISED
 Analyzed By: Benjamin Hill Project Location: Granada, MS
 Methodology: EPA/600/R-93/116 Project Number: EB237097

QuanTEM Sample ID	Client Sample ID	Composition	Color / Description	Asbestos (%)	Non-Asbestos Fiber (%)	Non Fibrous
021	05-21	Layered	White Surfacing	Asbestos Not Present	NA	CaCO3
021a		Layered	Tan Wall Paper	Asbestos Not Present	Cellulose 95	Binder
021b		Layered	Clear Adhesive	Asbestos Not Present	NA	Glue
022	06-22	Layered	White Floor Tile	Asbestos Present Chrysotile 2	NA	CaCO3 Vinyl
022a		Layered	Black Mastic	Asbestos Present Chrysotile 4	NA	Tar
023	06-23	Layered	White Floor Tile	Asbestos Present Chrysotile 2	NA	CaCO3 Vinyl
023a		Layered	Black Mastic	Asbestos Present Chrysotile 4	NA	Tar

Unless otherwise noted, upon receipt the condition of the sample was acceptable for analysis.

QuanTEM is a NVLAP accredited Testing PLM laboratory (Lab Code: 101959-0). This report relates only to the specific items tested
 NVLAP accreditation applies only to analysis performed utilizing EPA—40 CFR Appendix E to Subpart F of Part 763 and EPA/600/R-93/116 methods
 This report may not be used to claim product endorsement by NVLAP or any agency of the US Government.
 This report may not be reproduced except in full, without the written approval of the laboratory



2033 HERITAGE PARK DR, OKLAHOMA CITY, OK 73120 1.800.822.1650

Polarized Light Microscopy Asbestos Analysis Report

QuanTEM Lab No. 360273 Client: Terracon - Ridgeland
 Account Number: C085 Brad McKnight
 Date Received: 07/13/2023
 Received By: Baylie Longstreth
 Date Analyzed: 07/18/2023 Project: Knights Inn ACM Survey - REVISED
 Analyzed By: Benjamin Hill Project Location: Granada, MS
 Methodology: EPA/600/R-93/116 Project Number: EB237097

QuanTEM Sample ID	Client Sample ID	Composition	Color / Description	Asbestos (%)	Non-Asbestos Fiber (%)	Non Fibrous
024	06-24	Layered	White Floor Tile	Asbestos Present Chrysotile 2	NA	CaCO3 Vinyl
024a		Layered	Black Mastic	Asbestos Present Chrysotile 4	NA	Tar

REVISED

Benjamin Hill

Benjamin Hill, Assistant Laboratory Manager

8/3/2023

Date of Report

Unless otherwise noted, upon receipt the condition of the sample was acceptable for analysis.

QuanTEM is a NVLAP accredited Testing PLM laboratory (Lab Code: 101959-0). This report relates only to the specific items tested.
 NVLAP accreditation applies only to analysis performed utilizing EPA—40 CFR Appendix E to Subpart E of Part 763 and EPA/600/R-93/116 methods
 This report may not be used to claim product endorsement by NVLAP or any agency of the US Government.

This report may not be reproduced except in full, without the written approval of the laboratory.



ASBESTOS CHAIN OF CUSTODY

2033 Heritage Park Drive, Oklahoma City, OK 73120-7502
 (800) 822-1650 • (405) 755-7272 • Fax: (405) 755-2058

LEGAL DOCUMENT - PLEASE PRINT LEGIBLY

For Lab Use Only
 Lab No. 360273
 Accept Reject
 Report Results one box
 QuanTEM Website
 Email bradmcknight@quantem.com
 Other _____

Contact Information		Project Information	
Company: Terracon/Ridgeland	Phone: (768) 233-2072	Project Name: Knights Inn ACM Survey	
Contact: Brad McKnight	Cell Phone: (601) 497-5795	Project Location: Grenada, MS	
Account #: CO-85	E-mail: bradmcknight@terracon.com	Project ID: EB237097	
SAMPLED BY: <i>Brad McKnight</i>	Date: 7/8/2023	P.O. Number: EB237097	

RELINQUISHED BY: <i>Brad McKnight</i>	DATE & TIME: 7/12/2023	VIA: <i>FEDEX</i>	RECEIVED BY: <i>[Signature]</i>	DATE & TIME: 7/13/23 9:10
---------------------------------------	------------------------	-------------------	---------------------------------	---------------------------

REQUESTED SERVICES (Please the Appropriate Boxes)

PLM	PLM		TEM		TURNAROUND TIME
	<input type="checkbox"/> Vermiculite Atmic Insulation (EPA 600/R-04/004)	<input type="checkbox"/> Other	<input type="checkbox"/> Air-AHERA	<input type="checkbox"/> Bulk- Presence / Absence EPA600/R-93/116	
<input checked="" type="checkbox"/> Bulk Analysis (EPA 600/R-93/116)				<input type="checkbox"/> Bulk- Presence / Absence (weight%) - Chatfield	Rush
<input type="checkbox"/> 400 Point Count				<input type="checkbox"/> Dust- Presence / Absence	Same Day
<input type="checkbox"/> 1000 Point Count				<input type="checkbox"/> Dust- Quantitative (fibers/cc,cm) - ASTM D5755	24 - Hour
<input type="checkbox"/> Gravimetric Preparation				<input type="checkbox"/> Other	3 - Day
<input type="checkbox"/> Particle ID					5 - Day

No.	Sample ID (10 Characters Max)	To Be Analyzed <input checked="" type="checkbox"/>	Color	Description	Volume / Area (as applicable)	Comments / Notes
1	01-01	<input checked="" type="checkbox"/>	Tan	Exterior Stucco		
2	01-02	<input checked="" type="checkbox"/>	Tan	Exterior Stucco		
3	01-03	<input checked="" type="checkbox"/>	Tan	Exterior Stucco		
4	02-04	<input checked="" type="checkbox"/>	Brown	Carpet w/Adhesive		
5	02-05	<input checked="" type="checkbox"/>	Brown	Carpet w/Adhesive		
6	02-06	<input checked="" type="checkbox"/>	Brown	Carpet w/Adhesive		
7	03-07	<input checked="" type="checkbox"/>	White	Gypsum Wallboard/Joint Compound/Tape		
8	03-08	<input checked="" type="checkbox"/>	White	Gypsum Wallboard/Joint Compound/Tape		
9	03-09	<input checked="" type="checkbox"/>	White	Gypsum Wallboard/Joint Compound/Tape		
10	04-10	<input checked="" type="checkbox"/>	White	Ceiling Surface Material		

ASBESTOS CHAIN OF CUSTODY

2033 Heritage Park Drive, Oklahoma City, OK 73120-7502
 (800) 822-1650 • (405) 755-7272 • Fax: (405) 755-2058

LEGAL DOCUMENT - PLEASE PRINT LEGIBLY



For Lab Use Only
 Lab No. 360273
 Accept Reject

Project Information		Project Name:	Project Location:			
Company: Terracon/Ridgeland		Knights Inn ACM Survey	Grenada, MS			
No.	Sample ID (10 Characters Max)	To Be Analyzed	Color	Description	Volume / Area (as applicable)	Comments / Notes
1	04-11	<input checked="" type="checkbox"/>	White	Ceiling Surface Material		
2	04-12	<input checked="" type="checkbox"/>	White	Ceiling Surface Material		
3	04-13	<input checked="" type="checkbox"/>	White	Ceiling Surface Material		
4	04-14	<input checked="" type="checkbox"/>	White	Ceiling Surface Material		
5	04-15	<input checked="" type="checkbox"/>	White	Ceiling Surface Material		
6	04-16	<input checked="" type="checkbox"/>	White	Ceiling Surface Material		
7	04-17	<input checked="" type="checkbox"/>	White	Ceiling Surface Material		
8	04-18	<input checked="" type="checkbox"/>	White	Ceiling Surface Material		
9	05-19	<input checked="" type="checkbox"/>	Tan/Clear	Wallpaper w/Adhesive		
10	05-20	<input checked="" type="checkbox"/>	Tan/Clear	Wallpaper w/Adhesive		
11	05-21	<input checked="" type="checkbox"/>	Tan/Clear	Wallpaper w/Adhesive		
12	06-22	<input type="checkbox"/>	White	12" x 12" Floor Tile w/Mastic		
13	06-23	<input type="checkbox"/>	White	12" x 12" Floor Tile w/Mastic		
14	06-24	<input type="checkbox"/>	White	12" x 12" Floor Tile w/Mastic		
15		<input type="checkbox"/>				
16		<input type="checkbox"/>				
17		<input type="checkbox"/>				
18		<input type="checkbox"/>				
19		<input type="checkbox"/>				
20		<input type="checkbox"/>				
21		<input type="checkbox"/>				
22		<input type="checkbox"/>				
23		<input type="checkbox"/>				
24		<input type="checkbox"/>				
25		<input type="checkbox"/>				
26		<input type="checkbox"/>				
27		<input type="checkbox"/>				
28		<input type="checkbox"/>				
29		<input type="checkbox"/>				
30		<input type="checkbox"/>				



2033 HERITAGE PARK DR, OKLAHOMA CITY, OK 73120 1.800.822.1650

Polarized Light Microscopy Asbestos Analysis Report

QuanTEM Lab No. 360271 Client: Terracon - Ridgeland
 Account Number: C085 Brad McKnight
 Date Received: 07/13/2023
 Received By: Baylie Longstreth
 Date Analyzed: 07/17/2023 Project: Budget Inn ACM Survey
 Analyzed By: Benjamin Hill Project Location: Grenada, MS
 Methodology: EPA/600/R-93/116 Project Number: EB237097

QuanTEM Sample ID	Client Sample ID	Composition	Color / Description	Asbestos (%)	Non-Asbestos Fiber (%)	Non Fibrous
001	01-01	Layered	White Stucco	Asbestos Not Present	NA	CaCO3 Sand Paint
001a		Layered	Gray Stucco	Asbestos Not Present	NA	CaCO3 Sand
002	01-02	Layered	White Stucco	Asbestos Not Present	NA	CaCO3 Sand Paint
002a		Layered	Gray Stucco	Asbestos Not Present	NA	CaCO3 Sand
003	01-03	Layered	White Stucco	Asbestos Not Present	NA	CaCO3 Sand Paint
003a		Layered	Gray Stucco	Asbestos Not Present	NA	CaCO3 Sand

Unless otherwise noted, upon receipt the condition of the sample was acceptable for analysis.

QuanTEM is a NVLAP accredited Testing PLM laboratory (Lab Code: 101959-0). This report relates only to the specific items tested.
 NVLAP accreditation applies only to analysis performed utilizing EPA—40 CFR Appendix E to Subpart E of Part 763 and EPA/600/R-93/116 methods.
 This report may not be used to claim product endorsement by NVLAP or any agency of the US Government.
 This report may not be reproduced except in full, without the written approval of the laboratory



2033 HERITAGE PARK DR, OKLAHOMA CITY, OK 73128 1 800 822 1650

Polarized Light Microscopy Asbestos Analysis Report

Quantem Lab No. 360271

Client: Terracon - Ridgeland

Account Number: C085

Brad McKnight

Date Received: 07/13/2023

Received By: Baylie Longstreth

Date Analyzed: 07/17/2023

Project: Budget Inn ACM Survey

Analyzed By: Benjamin Hill

Project Location: Grenada, MS

Methodology: EPA/600/R-93/116

Project Number: EB237097

Quantem Sample ID	Client Sample ID	Composition	Color / Description	Asbestos (%)	Non-Asbestos Fiber (%)	Non Fibrous
004	02-04	Layered	Green Carpet	Asbestos Not Present	Synthetic	90 Binder
004a		Layered	Cream Adhesive	Asbestos Not Present	NA	CaCO3 Glue
005	02-05	Layered	Green Carpet	Asbestos Not Present	Synthetic	90 Binder
005a		Layered	Cream Adhesive	Asbestos Not Present	NA	CaCO3 Glue
006	02-06	Layered	Green Carpet	Asbestos Not Present	Synthetic	90 Binder
006a		Layered	Cream Adhesive	Asbestos Not Present	NA	CaCO3 Glue
007	03-07	Homogeneous	White Wallboard	Asbestos Not Present	Cellulose	15 Gypsum

Unless otherwise noted, upon receipt the condition of the sample was acceptable for analysis

Quantem is a NVLAP accredited Testing PLM laboratory (Lab Code: 101959-0) This report relates only to the specific items tested. NVLAP accreditation applies only to analysis performed utilizing EPA—40 CFR Appendix E to Subpart E of Part 763 and EPA/600/R-93/116 methods. This report may not be used to claim product endorsement by NVLAP or any agency of the US Government. This report may not be reproduced except in full, without the written approval of the laboratory



2033 HERITAGE PARK DR., OKLAHOMA CITY, OK 73120 1.800.822.1650

Polarized Light Microscopy Asbestos Analysis Report

QuanTEM Lab No. 360271 Client: Terracon - Ridgeland
 Account Number: C085 Brad McKnight
 Date Received: 07/13/2023
 Received By: Baylie Longstreth
 Date Analyzed: 07/17/2023 Project: Budget Inn ACM Survey
 Analyzed By: Benjamin Hill Project Location: Grenada, MS
 Methodology: EPA/600/R-93/116 Project Number: EB237097

QuanTEM Sample ID	Client Sample ID	Composition	Color / Description	Asbestos (%)	Non-Asbestos Fiber (%)	Non Fibrous
008	03-08	Homogeneous	White Wallboard	Asbestos Not Present	Cellulose 15	Gypsum
009	03-09	Homogeneous	White Wallboard	Asbestos Not Present	Cellulose 15	Gypsum
010	04-10	Layered	Tan Wall Paper	Asbestos Not Present	Synthetic 35	Vinyl
010a		Layered	Tan/Clear Adhesive	Asbestos Not Present	NA	Glue
011	04-11	Layered	Tan Wall Paper	Asbestos Not Present	Synthetic 35	Vinyl
011a		Layered	Tan/Clear Adhesive	Asbestos Not Present	NA	Glue

Unless otherwise noted, upon receipt the condition of the sample was acceptable for analysis.

Quantem is a NVLAP accredited Testing PLM laboratory (Lab Code: 101959-0). This report relates only to the specific items tested.
 NVLAP accreditation applies only to analysis performed utilizing EPA—40 CFR Appendix E to Subpart E of Part 763 and EPA/600/R-93/116 methods.
 This report may not be used to claim product endorsement by NVLAP or any agency of the US Government.
 This report may not be reproduced except in full, without the written approval of the laboratory



2033 HERITAGE PARK DR., OKLAHOMA CITY, OK 73120 1.800.822.1650

Polarized Light Microscopy Asbestos Analysis Report

Quantem Lab No. 360271
Account Number: C085

Client: Terracon - Ridgeland
Brad McKnight

Date Received: 07/13/2023
Received By: Baylie Longstreth
Date Analyzed: 07/17/2023
Analyzed By: Benjamin Hill
Methodology: EPA/600/R-93/116

Project: Budget Inn ACM Survey
Project Location: Grenada, MS
Project Number: EB237097

Quantem Sample ID	Client Sample ID	Composition	Color / Description	Asbestos (%)	Non-Asbestos Fiber (%)	Non Fibrous
012	04-12	Layered	Tan Wall Paper	Asbestos Not Present	Synthetic 35	Vinyl
012a		Layered	Tan/Clear Adhesive	Asbestos Not Present	NA	Glue
013	05-13	Homogeneous	White Caulk	Asbestos Not Present	NA	CaCO3 Binder
014	05-14	Homogeneous	White Caulk	Asbestos Not Present	NA	CaCO3 Binder
015	05-15	Homogeneous	White Caulk	Asbestos Not Present	NA	CaCO3 Binder
016	04-16	Homogeneous	White Ceiling Texture	Asbestos Present Chrysotile 3	NA	CaCO3 Mica Paint
017	04-17	Homogeneous	White Ceiling Texture	Asbestos Present Chrysotile 3	NA	CaCO3 Mica Paint

Unless otherwise noted, upon receipt the condition of the sample was acceptable for analysis.

Quantem is a NVLAP accredited Testing PLM laboratory (Lab Code: 101959-0). This report relates only to the specific items tested. NVLAP accreditation applies only to analysis performed utilizing EPA—40 CFR Appendix E to Subpart E of Part 763 and EPA/600/R-93/116 methods. This report may not be used to claim product endorsement by NVLAP or any agency of the US Government. This report may not be reproduced except in full, without the written approval of the laboratory.



2033 HERITAGE PARK DR, OKLAHOMA CITY, OK 73120 1.800.822.1650

Polarized Light Microscopy Asbestos Analysis Report

Quantem Lab No. 360271	Client: Terracon - Ridgeland
Account Number: C085	Brad McKnight
Date Received: 07/13/2023	
Received By: Baylic Longstreth	
Date Analyzed: 07/17/2023	Project: Budget Inn ACM Survey
Analyzed By: Benjamin Hill	Project Location: Grenada, MS
Methodology: EPA/600/R-93/116	Project Number: EB237097

Quantem Sample ID	Client Sample ID	Composition	Color / Description	Asbestos (%)	Non-Asbestos Fiber (%)	Non Fibrous
018	04-18	Homogeneous	White Ceiling Texture	Asbestos Present Chrysotile 3	NA	CaCO3 Mica Paint
019	05-19	Homogeneous	White Ceiling Texture	Asbestos Present Chrysotile 3	NA	CaCO3 Mica Paint
020	05-20	Homogeneous	White Ceiling Texture	Asbestos Present Chrysotile 3	NA	CaCO3 Mica Paint
021	05-21	Homogeneous	White Ceiling Texture	Asbestos Present Chrysotile 3	NA	CaCO3 Mica Paint
022	06-22	Homogeneous	White Ceiling Texture	Asbestos Present Chrysotile 3	NA	CaCO3 Mica Paint
023	06-23	Homogeneous	White Ceiling Texture	Asbestos Present Chrysotile 3	NA	CaCO3 Mica Paint

Unless otherwise noted, upon receipt the condition of the sample was acceptable for analysis.

Quantem is a NVLAP accredited Testing PLM laboratory (Lab Code: 101959-0). This report relates only to the specific items tested. NVLAP accreditation applies only to analysis performed utilizing EPA—40 CFR Appendix E to Subpart E of Part 763 and EPA/600/R-93/116 methods. This report may not be used to claim product endorsement by NVLAP or any agency of the US Government. This report may not be reproduced except in full, without the written approval of the laboratory.



2033 HERITAGE PARK DR, OKLAHOMA CITY, OK 73120 1.800.822.1650

Polarized Light Microscopy Asbestos Analysis Report

Quantem Lab No. 360271
 Account Number: C085

Client: Terracon - Ridgeland
 Brad McKnight

Date Received: 07/13/2023

Received By: Baylie Longstreth

Date Analyzed: 07/17/2023

Project: Budget Inn ACM Survey

Analyzed By: Benjamin Hill

Project Location: Grenada, MS

Methodology: EPA/600/R-93/116

Project Number: EB237097

Quantem Sample ID	Client Sample ID	Composition	Color / Description	Asbestos (%)	Non-Asbestos Fiber (%)	Non Fibrous
024	06-24	Homogeneous	White Ceiling Texture	Asbestos Present Chrysotile 3	NA	CaCO3 Mica Paint

Benjamin Hill

Benjamin Hill, Assistant Laboratory Manager

7/18/2023

Date of Report

Unless otherwise noted, upon receipt the condition of the sample was acceptable for analysis.

Quantem is a NVLAP accredited Testing PLM laboratory (Lab Code: 101959-0). This report relates only to the specific items tested. NVLAP accreditation applies only to analysis performed utilizing EPA—40 CFR Appendix E to Subpart E of Part 763 and EPA/600/R-93/116 methods.

This report may not be used to claim product endorsement by NVLAP or any agency of the US Government.

This report may not be reproduced except in full, without the written approval of the laboratory



ASBESTOS CHAIN OF CUSTODY

2033 Heritage Park Drive, Oklahoma City, OK 73120-7502
 (800) 822-1650 • (405) 755-7272 • Fax: (405) 755-2058

LEGAL DOCUMENT - PLEASE PRINT LEGIBLY

For Lab Use Only

Lab No. 360271

Accept Reject

Report Results one box
 QuantEM Website
 Email brad.mcknight@terracon.com
 Other

Contact Information		Project Information	
Company: Terracon/Ridgeland	Phone: (769) 233-2072	Project Name: Budget Inn ACM Survey	
Contact: Brad McKnight	Cell Phone: (601) 497-5795	Project Location: Grenada, MS	
Account #: CO-85	E-mail: brad.mcknight@terracon.com	Project ID: EB237097	
SAMPLED BY: Brad McKnight	Date: 7/18/2023	P.O. Number: EB237097	

RELINQUISHED BY: <i>[Signature]</i>	DATE & TIME: 7/19/2023	VIA: FEDEX	RECEIVED BY: <i>[Signature]</i>	DATE & TIME: 7/13/23 9:10
-------------------------------------	-------------------------------	-------------------	---------------------------------	----------------------------------

REQUESTED SERVICES (Please the Appropriate Boxes)

No.	Sample ID (10 Characters Max)	To Be Analyzed	PLM		TEM		TEM	TURNAROUND TIME
			<input type="checkbox"/> Bulk Analysis (EPA 600/R-93/116)	<input type="checkbox"/> Vermiculite Attic Insulation (EPA 600/R-04/004)	<input type="checkbox"/> Air- AHERA	<input type="checkbox"/> Air- NIOSH 7402		
<input type="checkbox"/>	400 Point Count	<input type="checkbox"/>	<input type="checkbox"/>	Other	<input type="checkbox"/>	<input type="checkbox"/>	<input type="checkbox"/>	Rush
<input type="checkbox"/>	1000 Point Count	<input type="checkbox"/>	<input type="checkbox"/>		<input type="checkbox"/>	<input type="checkbox"/>	<input type="checkbox"/>	Same Day
<input type="checkbox"/>	Gravimetric Preparation	<input type="checkbox"/>	PCM		<input type="checkbox"/>	<input type="checkbox"/>	<input type="checkbox"/>	24 - Hour
<input type="checkbox"/>	Particle ID	<input type="checkbox"/>	NIOSH 7400		<input type="checkbox"/>	<input type="checkbox"/>	<input checked="" type="checkbox"/>	3 - Day
					<input type="checkbox"/>	<input type="checkbox"/>	<input type="checkbox"/>	5 - Day

No.	Sample ID (10 Characters Max)	To Be Analyzed	Description	Volume / Area (as applicable)	Comments / Notes
	01-01	<input checked="" type="checkbox"/>	Exterior Stucco		
	01-02	<input checked="" type="checkbox"/>	Exterior Stucco		
	01-03	<input checked="" type="checkbox"/>	Exterior Stucco		
	02-04	<input checked="" type="checkbox"/>	Carpet w/Adhesive		
	02-05	<input checked="" type="checkbox"/>	Carpet w/Adhesive		
	02-06	<input checked="" type="checkbox"/>	Carpet w/Adhesive		
	03-07	<input checked="" type="checkbox"/>	Gypsum Wallboard/Joint Compound/Tape		
	03-08	<input checked="" type="checkbox"/>	Gypsum Wallboard/Joint Compound/Tape		
	03-09	<input checked="" type="checkbox"/>	Gypsum Wallboard/Joint Compound/Tape		
	04-10	<input checked="" type="checkbox"/>	Wallpaper w/Adhesive		



ASBESTOS CHAIN OF CUSTODY

2033 Heritage Park Drive, Oklahoma City, OK 73120-7502
 (800) 822-1650 • (405) 755-7272 • Fax: (405) 755-2058

LEGAL DOCUMENT - PLEASE PRINT LEGIBLY

For Lab Use Only

Lab No. Accept Reject

Project Information

Company: **Terracon/Ridgeland**

Project Name: **Budget Inn ACM Survey**

Project Location: **Grenada, MS**

No	Sample ID (10 Characters Max)	To Be Analyzed	Color	Description	Volume / Area (as applicable)	Comments / Notes
04	04-11	<input checked="" type="checkbox"/>	Tan/Clear	Wallpaper w/Adhesive		
04	04-12	<input checked="" type="checkbox"/>	Tan/Clear	Wallpaper w/Adhesive		
05	05-13	<input checked="" type="checkbox"/>	White	Restroom Caulking		
05	05-14	<input checked="" type="checkbox"/>	White	Restroom Caulking		
05	05-15	<input checked="" type="checkbox"/>	White	Restroom Caulking		
06	06-16	<input checked="" type="checkbox"/>	White	Ceiling Surface Material		
06	06-17	<input checked="" type="checkbox"/>	White	Ceiling Surface Material		
06	06-18	<input checked="" type="checkbox"/>	White	Ceiling Surface Material		
05	05-19	<input checked="" type="checkbox"/>	White	Ceiling Surface Material		
06	06-20	<input checked="" type="checkbox"/>	White	Ceiling Surface Material		
06	06-21	<input checked="" type="checkbox"/>	White	Ceiling Surface Material		
06	06-22	<input checked="" type="checkbox"/>	White	Ceiling Surface Material		
06	06-23	<input type="checkbox"/>	White	Ceiling Surface Material		
06	06-24	<input checked="" type="checkbox"/>	White	Ceiling Surface Material		
06		<input type="checkbox"/>				
06		<input type="checkbox"/>				
06		<input type="checkbox"/>				
06		<input type="checkbox"/>				
06		<input type="checkbox"/>				
06		<input type="checkbox"/>				

APPENDIX C
PHOTOGRAPHS OF HOMOGENEOUS AREAS



Photo 1: Knights Inn Exterior Stucco (HA-01)



Photo 2: Knights Inn Brown Carpet (HA-02)



Photo 3: Knights Inn Gypsum Wallboard System (HA-03)



Photo 4: Knights Inn Ceiling Surface Material (HA-04)



Photo 6: Knights Inn 12" x 12" Floor Tile with Mastic (HA-06)



Photo 8: Budget Inn Green Carpet (HA-02)



Photo 5: Knights Inn Wallpaper with Adhesive (HA-05)



Photo 7: Budget Inn Exterior Stucco (HA-01)



Photo 9: Budget Inn Gypsum Wallboard System (HA-03)



Photo 10: Budget Inn Wallpaper with Adhesive (HA-04)

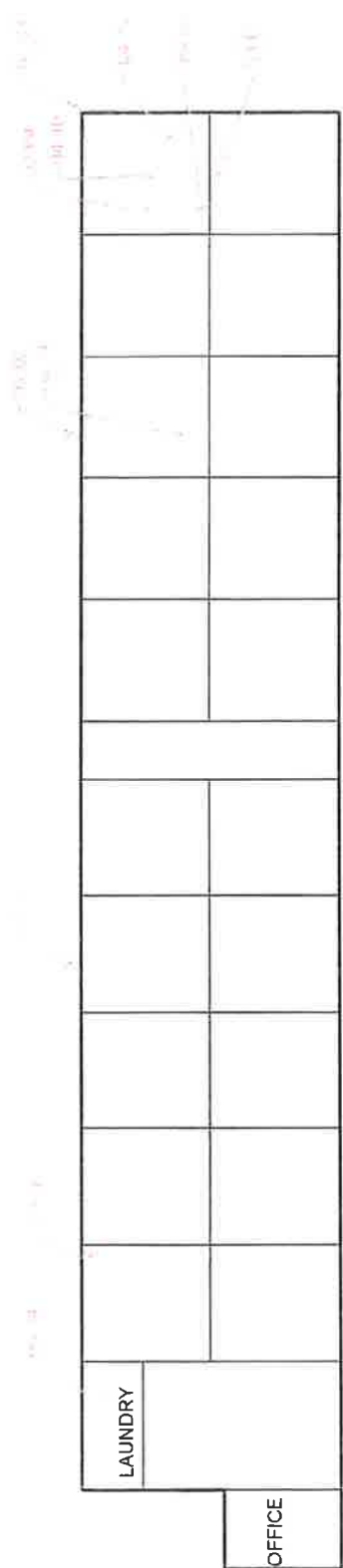

Photo 11: Budget Inn Restroom Caulking (HA-05)

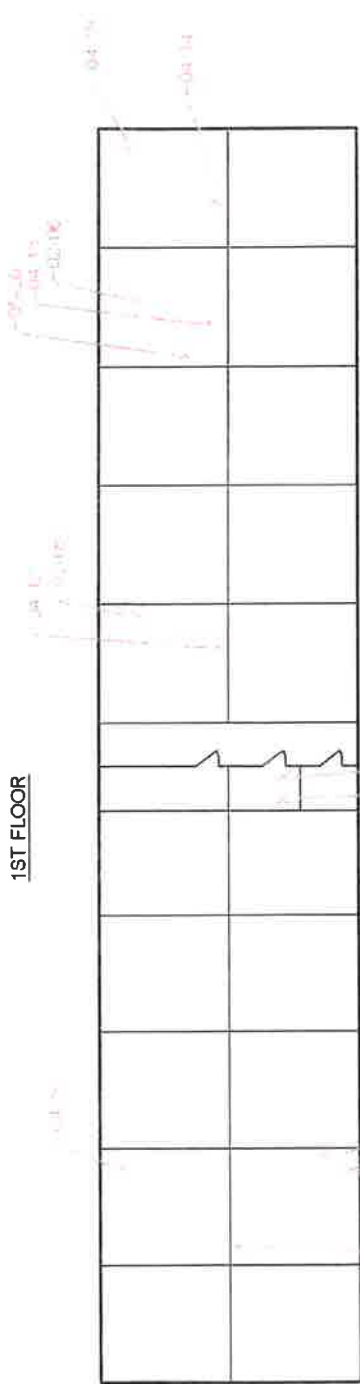

Photo 12: Budget Inn Ceiling Surface Material (HA-06)

APPENDIX D
SAMPE LOCATION DRAWING



1ST FLOOR



2ND FLOOR

EXHIBIT
1

ACM SAMPLE LOCATION MAP
KNIGHTS INN
1-55 AND HIGHWAY 8
GRENDA, MISSISSIPPI



Project No.	EB237097
Approved By	NTS
Checked By	08/04/2023
Created By	BM
Created Date	DBM

LEGEND
SAMPLE LOCATION
THIS MAP IS INTENDED FOR GENERAL INFORMATION ONLY. IT IS NOT TO BE USED FOR CONSTRUCTION PURPOSES. LOCATIONS ARE SUBJECT TO CHANGE.

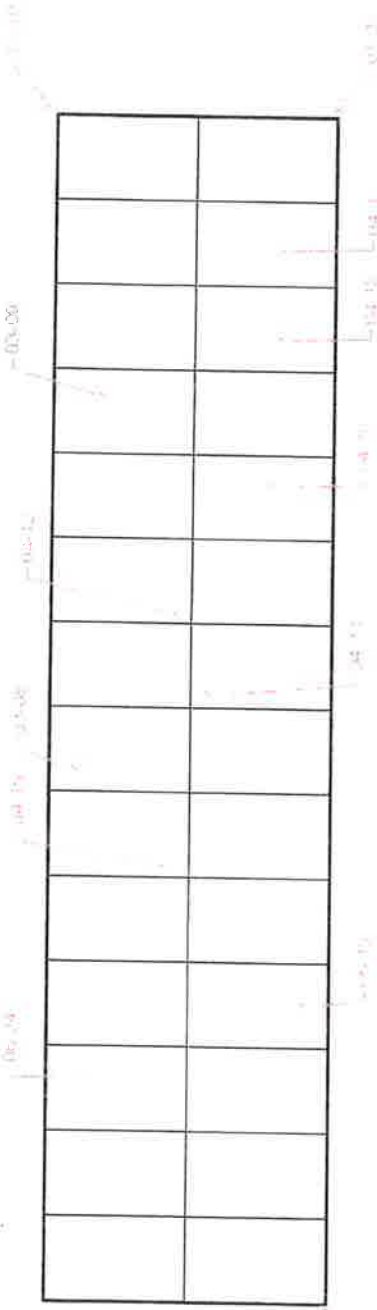

1ST FLOOR



2ND FLOOR

EXHIBIT
2

ACM SAMPLE LOCATION MAP
BUDGET INN
1-56 AND HIGHWAY 8
GRENA, MISSISSIPPI



Project No.	EB237097
Scale	NTS
Date	08/04/2023
Drawn By	J. J. JONES
Checked By	
Approved By	

Project No.	EB237097
Scale	NTS
Date	08/04/2023
Drawn By	J. J. JONES
Checked By	
Approved By	

LEGEND

SAMPLE LOCATION

THIS MAP IS FOR INFORMATIONAL PURPOSES ONLY AND IS NOT TO BE USED FOR CONSTRUCTION APPROVALS

APPENDIX E
CERTIFICATIONS

State of Mississippi

*Department of Environmental Quality
Office of Pollution Control*

Certificate of Licensure

In accordance with the Asbestos Abatement Accreditation and Certification Act.
Enacted as 1989 Mississippi Law, Chapter 505

Be it known that

Brad McKnight

Having submitted acceptable evidence of qualifications and
training and other appropriate information, is hereby granted this

***Asbestos Inspector
Certification***



***Certificate No.: ABI-00001685
Expiration Date: Jun 7th, 2024
Training Expires on Jun 7th, 2024***

Chief, Asbestos & Lead Branch

41468 LIC20230001