

AI # 4612



MSR32 0010
MAY 10 2018
MDEQ

RE-COVERAGE FORM

MINING STORM WATER, DEWATERING AND NO DISCHARGE GENERAL PERMIT

GENERAL PERMIT: MSR32 0 0 1 0. This coverage number must be completed for the referenced mining activity or this form will be considered incomplete and will be returned. The coverage number can be found at the bottom left corner of your previous Certificate of Coverage.

The submittal of this form is required to receive coverage under the reissued Mining Storm Water, Dewatering and No Discharge General Permit. This form must be completed and returned to MDEQ at the address printed at the bottom of this form within 30 days of the date of the Letter of Instruction for Re-Coverage.

Please indicate the activities to be covered by this Re-Coverage Form (check all that apply).

- Storm Water Discharges Associated with Mining
- Mine Dewatering
- Wastewater Recirculation System with No Discharge

The appropriate section of this form must be completed if the applicant proposes to operate a wastewater recirculation system with no discharge and/or discharge impounded mine water (dewatering).

If the company seeking coverage is a corporation, a limited liability company, a partnership, or a business trust, attach proof of its registration with the Mississippi Secretary of State and/or its Certificate of Good Standing. This registration or Certificate of Good Standing must be dated within twelve (12) months of the date of the submittal of this coverage form. Coverage will be issued in the company name as it is registered with the Mississippi Secretary of State.

ALL INFORMATION MUST BE COMPLETED (indicate "N/A" where not applicable)

APPLICANT INFORMATION

APPLICANT IS THE OWNER OPERATOR (Must check one or both)

OPERATOR CONTACT PERSON: Dwight A. Schipke

OPERATOR COMPANY NAME: PROFILE Products LLC

OPERATOR STREET OR P. O. BOX: 7250 Highway 15

OPERATOR CITY: Blue Mountain STATE: MS ZIP: 38610

OPERATOR PHONE #: (662) 685-4741 OPERATOR EMAIL: dschipke@profileproducts.com

OWNER CONTACT PERSON: Dwight A. Schipke

OWNER COMPANY: PROFILE Products LLC

OWNER STREET OR P. O. BOX: 7250 Highway 15

OWNER CITY: Blue Mountain STATE: MS ZIP: 38610

OWNER PHONE #: (662) 685-4741 OWNER EMAIL: dschipke@profileproducts.com

MINE INFORMATION

MINE SITE NAME: Blue Mountain Mine No. 1

CONTACT NAME & POSITION: Dwight A. Schipke, Director of Manufacturing

CONTACT PHONE NUMBER: (662) 685-4741

MINE PHYSICAL SITE ADDRESS (IF NOT AVAILABLE INDICATE NEAREST NAMED ROAD):
 STREET: CR 706

CITY: Blue Mountain COUNTY: Tippah ZIP: 38610

ATTACH A USGS QUAD MAP, EXTENDING 1/2 MILE BEYOND FACILITY, OUTLINING THE MINE BOUNDARIES (Maps can be obtained from the Mississippi Office of Geology. For information call 601-961-5523).
All /4 OF NE /4 OF SECTION 5, TOWNSHIP 5S, RANGE 3E

LATITUDE: 34 DEGREES 41 MINUTES 10 SECONDS LONGITUDE: 89 DEGREES 00 MINUTES 21 SECONDS

LAT & LONG DATA SOURCE (GPS (PLEASE GPS ENTRANCE GATE) OR MAP INTERPOLATION): Google Earth

TOTAL ACREAGE: 290.0 MATERIAL TO BE MINED: Clay

ESTIMATED START DATE: 1978/07/15 ESTIMATED END DATE: 2023/09/30
YYYY-MM-DD

SIC CODE 3295 NAICS CODE 212325
YYYY-MM-DD

STORM WATER POLLUTION PREVENTION PLAN (SWPPP)

THE GENERAL PERMIT REQUIRES THE SWPPP TO BE ONSITE OR LOCALLY AVAILABLE, UP-TO-DATE AND EFFECTIVE IN CONTROLLING STORM WATER POLLUTANTS. ACCORDINGLY, IN ADDITION TO THE PROJECT'S CURRENT BMPS, TWO (2) SPECIFIC BMPS (SEE BELOW) ARE REQUIRED TO BE IN THE SWPPP.

IS A COPY OF THE SWPPP AT THE PERMITTED SITE OR LOCALLY AVAILABLE? YES NO

DOES SWPPP CONTAIN AN UP-TO-DATE ASSESSMENT OF POTENTIAL STORM WATER POLLUTANT SOURCES AND IDENTIFY BMPS TO EFFECTIVELY CONTROL THEM? YES NO

IF A SEDIMENTATION BASIN IS A PROJECT BMP, DOES IT DISCHARGE ONLY FROM THE SURFACE OF THE BASIN? IF NO, THE BASIN MUST HAVE A SURFACE DISCHARGE IMMEDIATELY FROM THE DATE OF RECOVERY. YES or N.A. NO

IF TRUCK TRAFFIC LEAVES MINING SITE AND MOVES DIRECTLY ONTO PAVED PUBLIC ROAD, IS A CONSTRUCTION EXIT AN INSTALLED BMP? IF NO, A CONSTRUCTION EXIT MUST BE INSTALLED IMMEDIATELY OF THE DATE OF RECOVERY. IF A MINE IS CURRENTLY INACTIVE, BUT IS SUBMITTING A RECOVERY FORM, THE CONSTRUCTION EXIT MUST BE INSTALLED IMMEDIATELY OF THE MINE BECOMING ACTIVE. YES or N.A. NO

IS A WASTEWATER RECIRCULATION SYSTEM WITH NO DISCHARGE USED ON THE FACILITY? YES NO

IS MINE DEWATERING PRESENT ON SITE? YES NO

IF CHECKED YES TO WASTERWATER RECIRCULATION SYSTEM WITH NO DISCHARGE, FILL OUT BELOW

IS MINE COVERED UNDER VALID "NO DISCHARGE" STATE OPERATING PERMIT? YES NO

PERMIT NO. MS

DISTANCE BETWEEN RECIRCULATION POND(S) AND PROPERTY LINE: _____ (FT)
 (MUST BE AT LEAST 150 FEET)

NUMBER OF RECIRCULATION POND(S): _____

STORAGE CAPACITY OF EACH RECIRCULATION POND: _____ (FT³)

IF CHECKED YES TO MINE DEWATERING, FILL OUT BELOW

IS MINE COVERED UNDER VALID NPDES DISCHARGE PERMIT FOR MINE DEWATERING?

YES

NO

PERMIT NO. MS _____

ESTIMATED DEWATERING VOLUME: _____ (GAL/DAY)

NAME AND ADDRESS OF THE RECIPIENT OF THE DISCHARGE MONITORING REPORTS (DMRs), IF DIFFERENT FROM SIGNATORY:

I certify under penalty of law that this document and all attachments were prepared under my direction or supervision in accordance with a system designed to assure that qualified personnel properly gathered and evaluated the information submitted. Based on my inquiry of the person or persons who manage the system, or those persons directly responsible for gathering the information, the information submitted is, to the best of my knowledge and belief, true, accurate and complete. I am aware that there are significant penalties for submitting false information, including the possibility of fine and imprisonment for knowing violations.

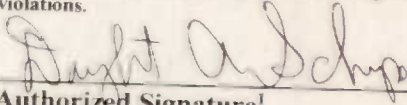

Authorized Signature¹

May 7, 2018

Date

Dwight A. Schipke

Printed Name

Director of Manufacturing

Title

¹This application shall be signed according to the General Permit, Act 15, T-4 as follows:

- For a corporation, by a responsible corporate officer.
- For a partnership, by a general partner.
- For a sole proprietorship, by the proprietor.
- For a municipal, state or other public facility, by either a principal executive officer, the mayor, or ranking elected official.
- Duly Authorized Representative

Please submit this form to:

Chief, Environmental Permits Division
MDEQ, Office of Pollution Control
P.O. Box 2261
Jackson, Mississippi 39225

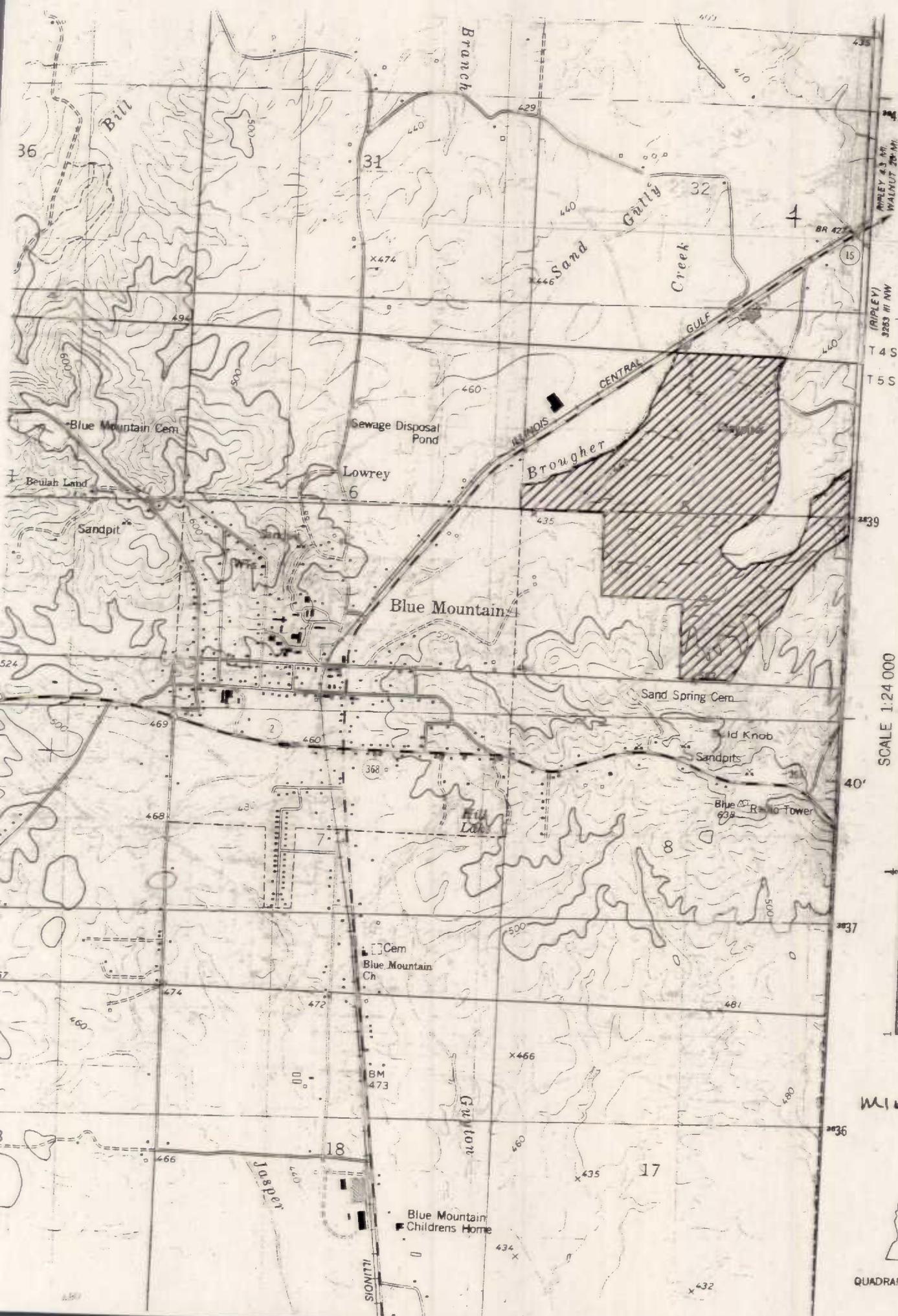

BLUE MOUNTAIN, MISS.
 NE 1/4 BLUE MOUNTAIN 15' QUADRANGLE
 N3437.5-W8900/7.5

DMA SURV II NR-SEPT 1982
 1982

TRIPLE
 3283 M AW
 4.3 MI
 WALNUT 20 MI

T 4 S
 T 5 S

SCALE 1:24 000

1 MILE
 1 KILOMETER

WIDE # 1



QUADRANGLE LOCATION

CONTOUR INTERVAL 20 FEET
 DOTTED LINES REPRESENT 10-FOOT CONTOURS