

MAJOR MODIFICATION FORM FOR HOT MIX ASPHALT GENERAL PERMIT MSR70



INSTRUCTIONS

Coverage recipients shall notify the Mississippi Department of Environmental Quality of plans to expand the acreage or "footprint" of an existing hot mix asphalt facility, waive the siting criteria of an existing operation, or construct a new air emissions source. This form must be submitted when any of the following activities is/are being proposed (check all that apply). Copies of the signed Return-Receipts and Contiguous Landowner Notification Forms shall accompany this Major Modification Form in accordance with ACT4, S-7 of the General Permit.

- "Footprint" identified in the original HMANOI is proposed to be enlarged (a modified SWPPP and an updated USGS topographic map must be submitted).
- Applicant requests waiver of facility siting criteria prescribed in ACT5 of the General Permit.
- Applicant intends to construct new air emissions source(s)

This form must be signed by the current coverage recipient under Mississippi's Hot Mix Asphalt General Permit. A different operator must have general permit coverage transferred prior to coverage being modified. Coverage recipients are authorized to implement the proposed modifications, under the conditions of the General Permit, only upon receipt of written notification of approval by the MDEQ.

ALL INFORMATION MUST BE COMPLETED (indicate "N/A" where not applicable)

COVERAGE RECIPIENT INFORMATION

COVERAGE RECIPIENT CONTACT PERSON: Brian Moore

COMPANY NAME: APAC-Mississippi, Inc.

STREET OR P.O. BOX: P.O. Box 24508

CITY: Jackson STATE: MS ZIP: 39225

PHONE # (INCLUDE AREA CODE): 601-376-4020

PROJECT INFORMATION

HOT MIX ASPHALT GENERAL PERMIT COVERAGE NUMBER: MSR70 0 0 6 3

ADDITIONAL ACREAGE TO BE DISTURBED: 2 acres TOTAL ACREAGE: 30 acres total

DESCRIBE PROPOSED SITING CRITERIA WAIVER: N/A

LIST NEW AIR EMISSIONS SOURCES: see attached sheet explaining modification request

FACILITY NAME: APAC-Mississippi, Inc. Tupelo Asphalt Plant

CITY: Tupelo COUNTY: Lee

I certify under penalty of law that this document and all attachments were prepared under my direction or supervision in accordance with a system designed to assure that qualified personnel properly gathered and evaluated the information submitted. Based on my inquiry of the person or persons who manage the system, or those persons directly responsible for gathering the information, the information submitted is, to the best of my knowledge and belief, true, accurate and complete. I am aware that there are significant penalties for submitting false information, including the possibility of fine and imprisonment for knowing violations.

Brian Moore
Signature (must be signed by coverage recipient)

8/27/2021
Date

Brian Moore
Printed Name

Environmental Manager
Title

Please submit this form to: Chief, Environmental Permits Division
MS Department of Environmental Quality, Office of Pollution Control
P.O. Box 2261
Jackson, Mississippi 39225

ml - received via mail 10/26/21

Map Name: TUPELO
Scale: 1 inch = 1,000 ft.

Map Center: 034° 15' 56.50" N 088° 38' 57.56" W

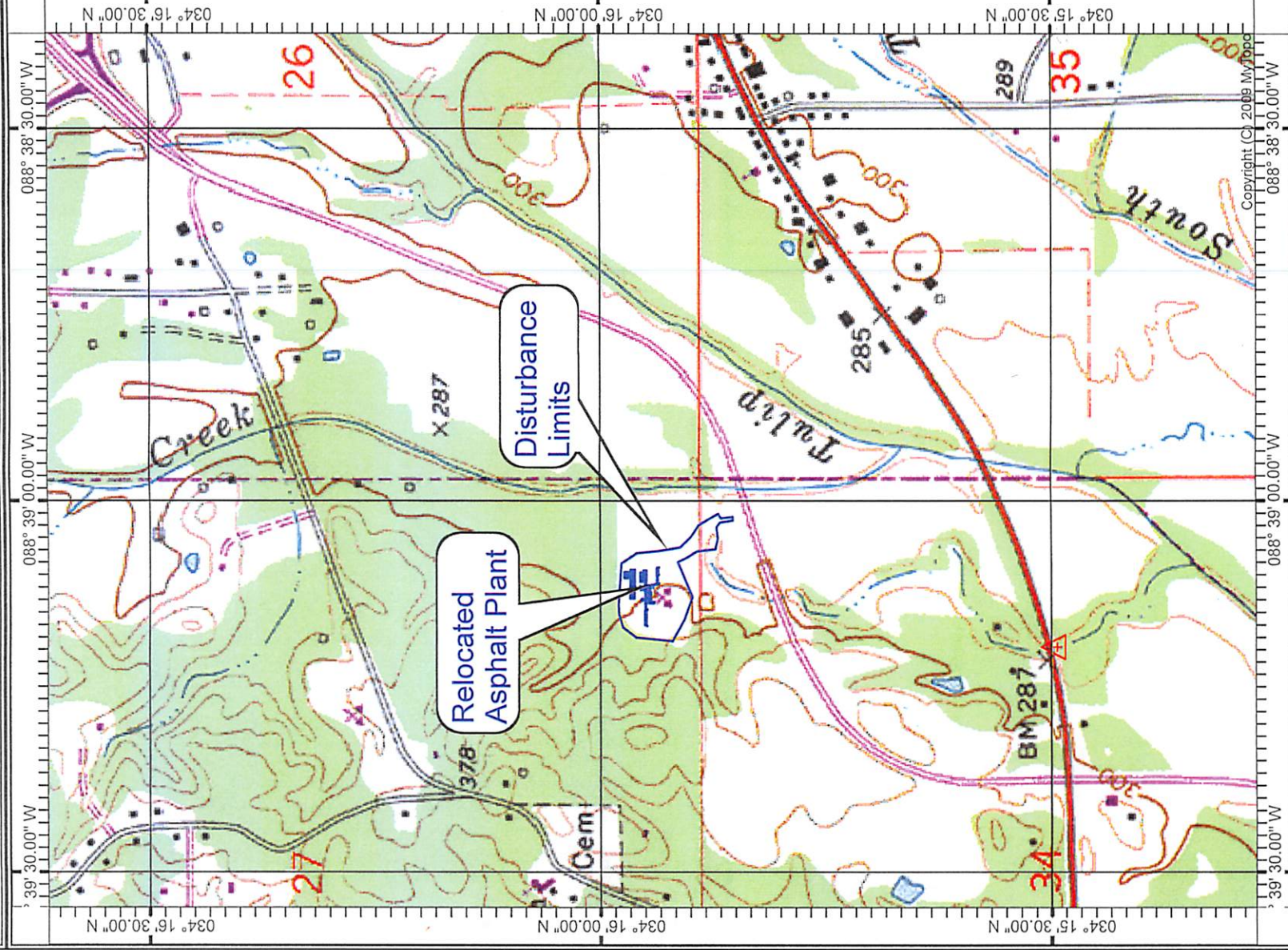

Copyright (C) 2009 MyTopo



SCALE 1:12000

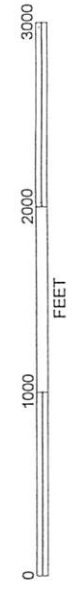

APAC-MS
AUBURN PLANT
TUPELO, MS

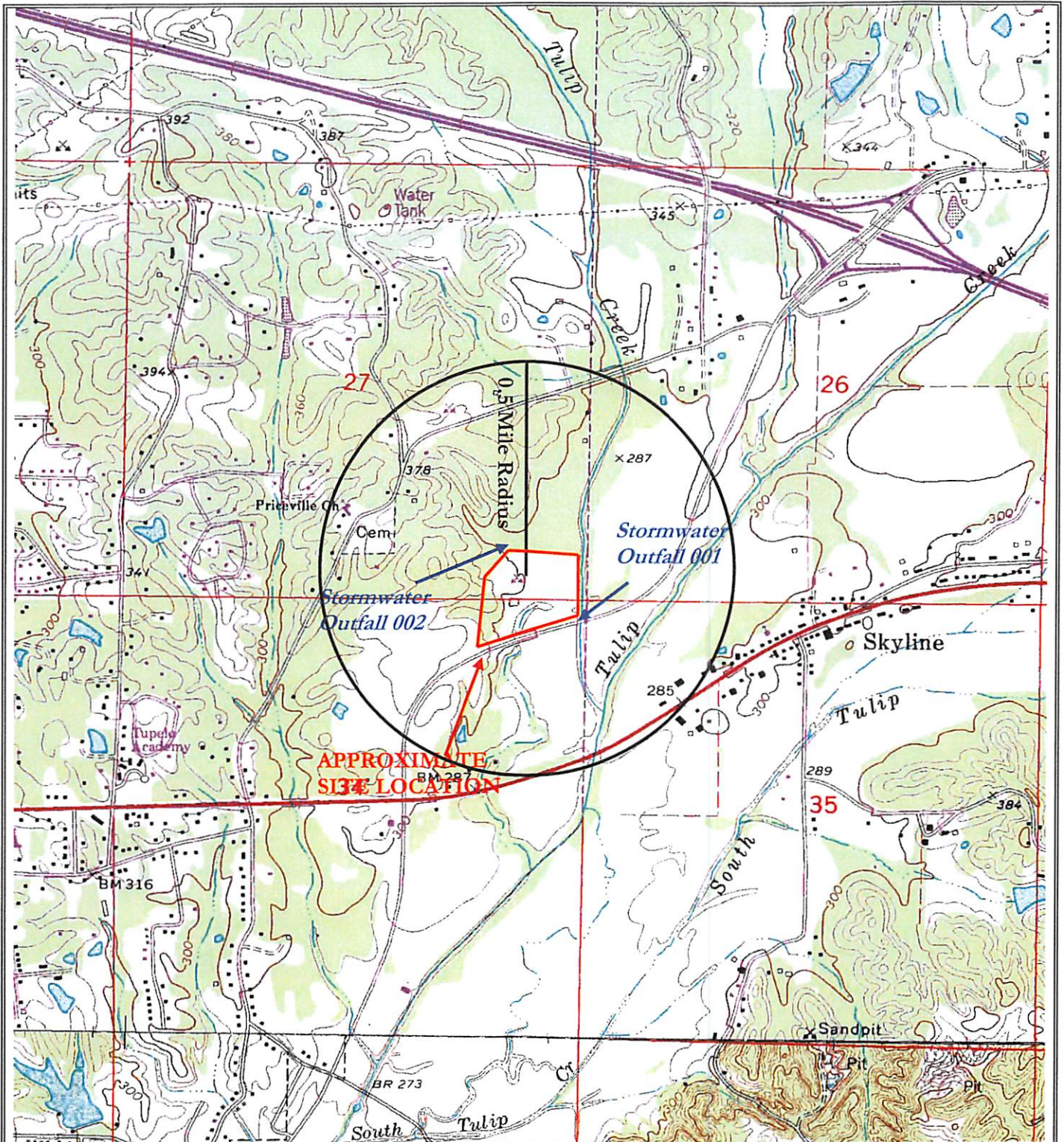

APAC-Mississippi, Inc.

Tupelo Facility
 459 North Eason Blvd., Tupelo, MS 38802

FC&E Engineering, LLC

Brandon, MS 39042
 (601) 824-1860



**FIGURE 1 - USGS Quad Map
 SITE LOCATION**

Tupelo, Mississippi

Lee County

Scale 1" = 1,740 feet

Map Info: Tupelo, MS, 1995

August 27, 2021

Lee County Library
219 N. Madison Street
Tupelo, MS 38804-3807
Attn: Jeff Tomlinson

RE: APAC-Mississippi, Inc.
Tupelo, MS

Dear Librarian,

Enclosed is a copy of the public notice for comment on the request by APAC-Mississippi, Inc. to modify its current operating permit under the State of Mississippi's Hot Mix Asphalt Facility Multimedia General Permit MSR700063 located at the 459 Eason Boulevard, Tupelo, MS 38802. Please post this notice in the library.

Also, enclosed is a copy of the information pertinent to the above request. This information should be kept on hand for review by the public until October 1st, 2021, after which it may be discarded. The public may photocopy all or any portion of this information, but it should not leave the library.

Finally, enclosed please find a duplication of this letter with a place for your signature and the date acknowledging your receipt of the package and your agreement to carry out our request.

We are attempting to better keep the public informed of and involved in this action regarding permitting of new and expanding industry. Since access to the public library is so convenient for so many we hope to use these facilities as often as possible. Your cooperation in this matter is greatly appreciated.

If you have any questions, please contact me at (601) 376-4000 or contact the Construction and Building Materials Branch of the Mississippi Department of Environmental Quality at (601) 961-5171.

Sincerely,

APAC-Mississippi, Inc.

Brian Moore

Attachment

Received & Agreed to by:

(Signature)

Jeff Tomlinson
(Printed Name)

8-30-21
(Date)

Director
(Title)



STATE OF MISSISSIPPI, LEE COUNTY:

Personally appeared before me, Kallen A. Donald, Notary Public, in and for said County and State, William H. Bronson, III, Publisher, of a newspaper printed and published in the City of Tupelo, Lee County, Mississippi, called The Northeast Mississippi Daily Journal, who being duly sworn, deposes and says that the publication of a certain notice, a true copy of which is hereunto attached, has been made in said newspaper for 1 weeks consecutively to-wit:

Vol. 148. No. 153 Date Aug 31st 20 21
Vol. _____ . No. _____ Date _____ 20 _____
Vol. _____ . No. _____ Date _____ 20 _____
Vol. _____ . No. _____ Date _____ 20 _____
Vol. _____ . No. _____ Date _____ 20 _____
Vol. _____ . No. _____ Date _____ 20 _____

William H. Bronson, III, Publisher

Witness my hand and seal this 31st day

of August 20 21

Kallen A. Donald Notary

#1563013
LEGAL NOTICE
Public Notice
Mississippi Environmental Quality
Permit Board
P. O. Box 2261
Jackson, MS. 39225
Telephone NO. 601 961-5171
APAC-Mississippi, Inc. at 101 Riverview Drive in Richland, MS has applied to the Mississippi Department of Environmental Quality (MDEQ) to modify its current operating permit under MDEQ's Multimedia Hot Mix Asphalt Facility General Permit MSR 700063 to construct and operate an asphalt plant at 459 Eason Boulevard, Tupelo, MS 38802. Such construction and operation may involve the clearing, grading and excavation of land, and will involve the discharge of storm water and the operation of air emissions equipment during the operation of the facility.
General Permit MSR70 has been developed to ensure compliance with all State and Federal regula-

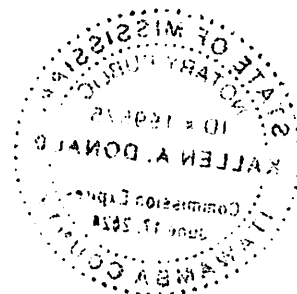

APAC-Mississippi, Inc.
Tupelo Asphalt Plant
Major Modification Request

APAC proposes to modify the Hot Mix Asphalt General Permit MSR700063 by dismantling the existing asphalt plant on site and replacing the plant with a more modern and efficient plant. This site modification will consist of installing some new plant components along with moving some existing plant components from an existing plant in Memphis. The plant component modification will consist of:

- Dryer/Mixing Drum-Moved from Memphis Plant (Rated at 500 tons/hour) 45 Feet Long and 9 feet in Diameter
- Burner-Moved from Memphis Plant- Manufactured by Hauck-Starjet 750 and rated at 150 MM BTU/HRBTU/Hour
- Baghouse with Cyclone-Moved from Memphis Plant-75,000 Cubic Feet Per Minute
- Virgin Aggregate Cold Feed Bins and Gathering Conveyor-Purchased New
- Virgin Aggregate Screen-Moved from Memphis plant
- Recycled Asphalt Pavement (RAP) Feeder Bins, Screen, Impact Crusher and Conveyors-Purchased New
- Asphalt Storage Silos-(2-200 Ton Silos purchased new) and (2-300 tons Silos moved from Memphis Plant)
- Hydrated Lime Silo-Moved from existing APAC Shannon Plant
- Lime Mixer-Purchase New
- Fly Ash Silo-Use Existing Silo at Tupelo Plant
- Liquid Asphalt Tanks-Use 1 existing tank from Tupelo Plant and Purchase 1 new tank
- Fuel Oil Tanks-Natural Gas will be primary fuel source, will install existing Fuel Oil tanks from Tupelo Plant for use as back up fuel
- Hot Oil Heater-Purchase New
- Liquid Asphalt Unloading Pumps and Metering System-Purchase New
- New Control Tower and Scales

The emission point and plant components will be relocated on the site about 200 feet to the Northwest. Some site construction will take place at the site to expand the site to allow for increased stockpile storage and a different truck route within the site.

RECEIVED

OCT 26 2010