

MSR10 8747

(NUMBER TO BE ASSIGNED BY STATE)

APPLICANT IS THE:  OWNER  PRIME CONTRACTOR

**OWNER CONTACT INFORMATION**

OWNER CONTACT PERSON: John Lewis, VP  
 OWNER COMPANY LEGAL NAME: South Point of Mississippi, LLC  
 OWNER STREET OR P.O. BOX: 1002 W 23rd St, Ste. 400  
 OWNER CITY: Panama City STATE: FL ZIP: 32405  
 OWNER PHONE #: (850) 914-3262 OWNER EMAIL: john.lewis@royalamerican.com

**PRIME CONTRACTOR CONTACT INFORMATION**

PRIME CONTRACTOR CONTACT PERSON: \_\_\_\_\_  
 PRIME CONTRACTOR COMPANY LEGAL NAME: \_\_\_\_\_  
 PRIME CONTRACTOR STREET OR P.O. BOX: \_\_\_\_\_  
 PRIME CONTRACTOR CITY: \_\_\_\_\_ STATE: \_\_\_\_\_ ZIP: \_\_\_\_\_  
 PRIME CONTRACTOR PHONE #: ( ) \_\_\_\_\_ PRIME CONTRACTOR EMAIL: \_\_\_\_\_

**FACILITY SITE INFORMATION**

FACILITY SITE NAME: South Pointe - Phase 5  
 FACILITY SITE ADDRESS (If the physical address is not available, please indicate the nearest named road. For linear projects indicate the beginning of the project and identify all counties the project traverses.)  
 STREET: South Pointe - Phase 5, is located South of Bida-Evans Road, East of Emerald Lakes Subdivision, North of South Pointe - Phase 3C and West of Southmarsh Drive in Section 7, Township 8 South, Range 7 West, Jackson County, Mississippi.  
 CITY: \_\_\_\_\_ STATE: Mississippi COUNTY: Jackson ZIP: 39564  
 FACILITY SITE TRIBAL LAND ID (N/A if not applicable): N/A  
 LATITUDE: 30 degrees 21 minutes 42 seconds LONGITUDE: 88 degrees 43 minutes 42 seconds  
 LAT & LONG DATA SOURCE (GPS (Please GPS Project Entrance/Start Point) or Map Interpolation): Google Earth  
 TOTAL ACREAGE THAT WILL BE DISTURBED <sup>1</sup>: 19.45 +/-  
 IS THIS PART OF A LARGER COMMON PLAN OF DEVELOPMENT? YES  NO   
 IF YES, NAME OF LARGER COMMON PLAN OF DEVELOPMENT: \_\_\_\_\_  
 AND PERMIT COVERAGE NUMBER: MSR10 \_\_\_\_\_  
 ESTIMATED CONSTRUCTION PROJECT START DATE: \_\_\_\_\_  
 ESTIMATED CONSTRUCTION PROJECT END DATE: \_\_\_\_\_  
 DESCRIPTION OF CONSTRUCTION ACTIVITY: Construction of roads, sewer, water, drainage  
 PROPOSED DESCRIPTION OF PROPERTY USE AFTER CONSTRUCTION HAS BEEN COMPLETED:  
Single Family Residential  
 SIC Code \_\_\_\_\_ NAICS Code \_\_\_\_\_

m - received via email 7.25.22

NEAREST NAMED RECEIVING STREAM: Mississippi Sound

IS RECEIVING STREAM ON MISSISSIPPI'S 303(d) LIST OF IMPAIRED WATER BODIES? (The 303(d) list of impaired waters and TMDL stream segments may be found on MDEQ's web site: [http://www.dcq.state.ms.us/MDEQ.nsf/page/TWB\\_Total\\_Maximum\\_Daily\\_Load\\_Section](http://www.dcq.state.ms.us/MDEQ.nsf/page/TWB_Total_Maximum_Daily_Load_Section)) YES  NO

HAS A TMDL BEEN ESTABLISHED FOR THE RECEIVING STREAM SEGMENT? YES  NO

ARE THERE RECREATIONAL STREAMS, PRIVATE/PUBLIC PONDS OR LAKES WITHIN 1/2 MILE DOWNSTREAM OF PROJECT BOUNDARY THAT MAY BE IMPACTED BY THE CONSTRUCTION ACTIVITY? YES  NO

EXISTING DATA DESCRIBING THE SOIL (for linear projects please describe in SWPPP):  
Sandy Loam

WILL FLOCCULANTS BE USED TO TREAT TURBIDITY IN STORM WATER? YES  NO

IF YES, INDICATE THE TYPE OF FLOCCULANT.  ANIONIC POLYACRYLIMIDE (PAM)  
 OTHER \_\_\_\_\_

IF YES, DOES THE SWPPP DESCRIBE THE METHOD OF INTRODUCTION, THE LOCATION OF INTRODUCTION AND THE LOCATION OF WHERE FLOCCULATED MATERIAL WILL SETTLE? YES  NO

<sup>1</sup> Acreage for subdivision development includes areas disturbed by construction of roads, utilities and drainage. Additionally, a housesite of at least 10,000 ft<sup>2</sup> per lot (entire lot, if smaller) shall be included in calculating acreage disturbed.

**DOCUMENTATION OF COMPLIANCE WITH OTHER REGULATIONS/REQUIREMENTS**  
 COVERAGE UNDER THIS PERMIT WILL NOT BE GRANTED UNTIL ALL OTHER REQUIRED  
 MDEQ PERMITS AND APPROVALS ARE SATISFACTORILY ADDRESSED

**IS LCNOI FOR A FACILITY THAT WILL REQUIRE OTHER PERMITS?** YES  NO

**IF YES, CHECK ALL THAT APPLY:**  AIR  HAZARDOUS WASTE  PRETREATMENT  
 WATER STATE OPERATING  INDIVIDUAL NPDES  OTHER: \_\_\_\_\_

**IS THE PROJECT REROUTING, FILLING OR CROSSING A WATER CONVEYANCE OF ANY KIND?** (If yes, contact the U.S. Army Corps of Engineers' Regulatory Branch for permitting requirements.) YES  NO

**IF THE PROJECT REQUIRES A CORPS OF ENGINEER SECTION 404 PERMIT, PROVIDE APPROPRIATE DOCUMENTATION THAT:**

- The project has been approved by individual permit, or
- The work will be covered by a nationwide permit and NO NOTIFICATION to the Corps is required, or
- The work will be covered by a nationwide or general permit and NOTIFICATION to the Corps is required

**IS A LAKE REQUIRING THE CONSTRUCTION OF A DAM BEING PROPOSED?** YES  NO   
 (If yes, provide appropriate approval documentation from MDEQ Office of Land and Water, Dam Safety.)

**IF THE PROJECT IS A SUBDIVISION OR A COMMERCIAL DEVELOPMENT, HOW WILL SANITARY SEWAGE BE DISPOSED?** Check one of the following and attach the pertinent documents.

- Existing Municipal or Commercial System. Please attach plans and specifications for the collection system and the associated "Information Regarding Proposed Wastewater Projects" form or approval from County Utility Authority in Hancock, Harrison, Jackson, Pearl River and Stone Counties. If the plans and specifications can not be provided at the time of LCNOI submittal, MDEQ will accept written acknowledgement from official(s) responsible for wastewater collection and treatment that the flows generated from the proposed project can and will be transported and treated properly. The letter must include the estimated flow.
- Collection and Treatment System will be Constructed. Please attach a copy of the cover of the NPDES discharge permit from MDEQ or indicate the date the application was submitted to MDEQ (Date: \_\_\_\_\_.)
- Individual Onsite Wastewater Disposal Systems for Subdivisions Less than 35 Lots. Please attach a copy of the Letter of General Acceptance from the Mississippi State Department of Health or certification from a registered professional engineer that the platted lots should support individual onsite wastewater disposal systems.
- Individual Onsite Wastewater Disposal Systems for Subdivisions Greater than 35 Lots. A determination of the feasibility of installing a central sewage collection and treatment system must be made by MDEQ. A copy of the response from MDEQ concerning the feasibility study must be attached. If a central collection and wastewater system is not feasible, then please attach a copy of the Letter of General Acceptance from the State Department of Health or certification from a registered professional engineer that the platted lots should support individual onsite wastewater disposal systems.

**INDICATE ANY LOCAL STORM WATER ORDINANCE WITH WHICH THE PROJECT MUST COMPLY:**

Jackson County Utility Authority  
 \_\_\_\_\_  
 \_\_\_\_\_

I certify under penalty of law that this document and all attachments were prepared under my direction or supervision in accordance with a system designed to assure that qualified personnel properly gathered and evaluated the information submitted. Based on my inquiry of the person or persons who manage the system, or those persons directly responsible for gathering the information, the information submitted is, to the best of my knowledge and belief, true, accurate and complete. I am aware that there are significant penalties for submitting false information, including the possibility of fine and imprisonment for knowing violations.



Signature of Applicant<sup>1</sup> (owner or prime contractor)

06.15.2022  
Date Signed

John W. Lewis  
Printed Name<sup>1</sup>

Vice President  
Title

<sup>1</sup>This application shall be signed as follows:

- For a corporation, by a responsible corporate officer.
- For a partnership, by a general partner.
- For a sole proprietorship, by the proprietor.

For a municipal, state or other public facility, by principal executive officer, mayor, or ranking elected official

Please submit the LCNOI form to:

Chief, Environmental Permits Division  
MS Department of Environmental Quality, Office of Pollution Control  
P.O. Box 2261  
Jackson, Mississippi 39225

<b>FOR OPC USE ONLY</b>	
AI NO.	_____
PLA NO.	_____

**INFORMATION REGARDING PROPOSED WASTEWATER PROJECTS  
TO: THE MISSISSIPPI OFFICE OF POLLUTION CONTROL**

The South Point of Mississippi, LLC  
(Name of Body Making Application, i.e. Individual, Corporation, Municipality, Developer, etc.)

whose mailing address is 1002 West 23<sup>rd</sup> St Ste 400, Panama City, FL, 32405  
(Street and Number) (City) (State) (Zip)

whose responsible official is John Lewis, Manger  
(Name) (Title)

and whose phone number is (850) 914-3262,

Herewith submits for consideration of the OPC plans, specifications, and other necessary data prepared by

Rumsey Consulting Engineering, Inc  
(Engineer or Firm)

Lawrence C. Rumsey  
(Firm's Project Contact Person, if applicable)

910 Howard Ave.  
(Mailing Address)

Biloxi, MS 39530  
(City, State, Zip)

(228) 432-9344  
(Phone Number)

who is hereby authorized to represent the applicant in the engineering features of this project for the construction of Extension

\_\_\_\_\_  
(Clearly Describe Project: New System, Modification, Extension, Rehabilitation, Treatment, etc.)

to serve South Pointe Subdivision Phase 5 (Single Family Residential)  
(Subdivision, Plant, School, Other)

located at Section 7, Township 8 South, Range 7 West, Jackson, MS  
(Approximate Location, Including Section, Township, and Range)



in or near the City of Ocean Springs in the County of Jackson, State of Mississippi, as required by the regulations of the OPC and herewith make application to the OPC for the approval of this project. We understand through the regulations of the OPC that this approval is required prior to the initiation of construction activities.

Upon construction, these facilities will be owned and maintained by Jackson County Utility Authority

(Name of Utility Company, Municipality, Owner, Developer, etc.)

whose mailing address is 11100 Highway 57, Vancleave, MS, 39565.  
(Street and Number) (City) (State) (Zip)

**NOTE: IF THIS PROJECT DOES NOT ADD ANY NEW CONNECTIONS OR ADDITIONAL FLOWS TO THE COLLECTION SYSTEM, YOU MAY OMIT SECTIONS A. THROUGH E. BELOW.**

**A. EXISTING SEWAGE COLLECTION SYSTEM**

1. The facilities collecting the sewage from this proposed project are owned by \_\_\_\_\_  
Jackson County Utility Authority.  
(Utility Company, Municipality, etc.)
2. The number of connections existing are 1500.
3. The length of sanitary sewers existing are 10,000 lf.
4. The number of existing lift stations are 5.
5. Additional facilities that collect sewage from this proposed project, i.e. a regional wastewater authority, are owned by Jackson County Utility Authority.

**B. CERTIFICATION(S) FROM COLLECTION ENTITIES**

The official(s) responsible for the wastewater collection facilities denoted in Section A. above, that will serve the proposed project, do hereby certify that we agree to transport the wastewater flows generated from the proposed project. We also hereby certify that we have determined that our collection system(s) have the capacity available to transport properly the wastewater flows generated from the proposed project.

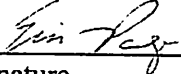
  
Signature  
Executive Director  
Title  
Jackson County Utility Authority  
Entity

\_\_\_\_\_  
Signature  
\_\_\_\_\_  
Title  
\_\_\_\_\_  
Entity

**C. EXISTING SEWAGE TREATMENT WORKS**

1. The facilities responsible for treatment of the sewage from this proposed project are owned by Jackson County Utility Authority  
(Utility Company, Municipality, etc.)
2. The OPC Permit Number for this wastewater facility is MS 004 5446.
3. The capacity for this wastewater treatment facility is 7mgd.
4. The treatment type of this wastewater treatment facility is Contstructed Wetland Treatment.  
(Activated Sludge, Aerated Lagoon, etc.)
5. The present population served by the treatment facility is 40,000.
6. The operator in charge will be Brian Davis, who is a  
Class 3 wastewater operator, holding certificate number 6321-III.

**D. CERTIFICATION FROM WASTEWATER TREATMENT ENTITY**

The official responsible for the wastewater treatment facility denoted in Section C. above, that will serve the proposed project, does hereby certify that we agree to treat the wastewater flows generated from the proposed project. We also hereby certify that we have determined that our treatment facility has the capacity available to treat properly the wastewater flows generated from the proposed project.

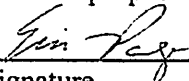
  
Signature

Executive Director  
Title

Jackson County Utility Authority  
Entity

**E. PROPOSED PROJECT DETAILS**

1. The ultimate population to be served by this proposed project is 246.
2. The number of connections to be added are 77.
3. Per capita discharge 70 gpcd: Infiltration 0 gpcd. (Estimate, if unknown)
4. Area Served in Acres 19.45 Design Population Per Acre 12.64
5. The area water is supplied by Jackson County Utility Authority  
1110 Highway 57, Vanleave, MS 39565.

(Name and Address of Water Utility)

6. Proposed Sewage Pumping Stations

Location or Number	Units Served	Pump Capacity (gpm)	Influent Flow (gpm)	
			Avg.	Peak

F. ADDITIONAL CLEARANCES

**NOTE: APPROVAL OF THIS PROJECT SHALL NOT BE GRANTED UNTIL ALL THE MDEQ PERMITS, COVERAGES, AND APPROVALS DENOTED BELOW ARE SATISFACTORILY ADDRESSED.**

1. The total area of ground disturbance by clearing, grading, and excavating for utilities, roadways, lots, etc. is 19.45 acres.
2. For construction projects disturbing five or more acres, have you applied to MDEQ or an MDEQ approved local authority for construction stormwater permit coverage?

Yes       Not applicable

If not applicable, why? \_\_\_\_\_

**NOTE: IF YOU ARE DISTURBING MORE THAN ONE ACRE BUT LESS THAN FIVE ACRES AFTER MARCH 10, 2003, YOU MUST FOLLOW THE REQUIREMENTS OF MDEQ'S SMALL CONSTRUCTION STORM WATER GENERAL PERMIT. ALSO, AFTER MARCH 10, 2003, IF YOU ARE IN AN AREA THAT HAS AN MDEQ APPROVED LOCAL AUTHORITY YOU MUST APPLY FOR APPROVAL FOR 1-5 ACRE CONSTRUCTION PROJECTS. SOME LOCAL AUTHORITIES MAY REQUIRE APPROVAL FOR DISTURBANCE LESS THAN ONE ACRE.**

3. Have determinations/authorizations been received from the Corps of Engineers regarding the need for a Section 404 Permit, General Permit or Nationwide Permit for stream or intermittent drain crossings, stream re-routing, or for placing fill material into wetlands?

Yes       Pending       Not applicable

If not applicable, why? \_\_\_\_\_



**G. ADDITIONAL CERTIFICATIONS**

We hereby certify that we are the applicants for this project, that we are familiar with the information contained in this form, and that, to the best of our knowledge and belief, such information is true, complete, and accurate.

*John Lewis* For John Lewis  
Signature of Responsible Official for Body Making Application

John Lewis, Manager  
Printed Name and Title of Above

I hereby certify that the engineering documents for this project were prepared by myself or under my direct supervision, that I am familiar with the information contained in this form, and that, to the best of my knowledge and belief, such information is true, complete, and accurate.

*Lawrence C. Rumsy*  
Signature of Engineer Registered Under Mississippi Laws

Lawrence C. Rumsy, P.E. #7404  
Typed Name and Registration Number

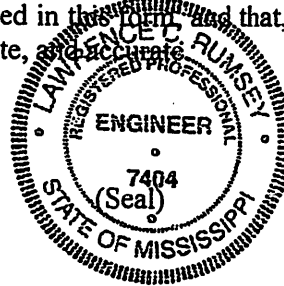

**THE APPLICANTS AGREE THAT NO CHANGES IN OR DEVIATION FROM THE PLANS AND SPECIFICATIONS APPROVED BY THE OPC WILL BE MADE EXCEPT WITH THE PRIOR CONSENT AND APPROVAL OF THE OPC.**

COMMENTS: \_\_\_\_\_  
\_\_\_\_\_  
\_\_\_\_\_  
\_\_\_\_\_



**JACKSON COUNTY UTILITY AUTHORITY**  
*Serving the People...Protecting the Environment*

Directors

Thomas Eldridge • Jackson County  
Andrew J. Elly • Moss Point  
William Lanham • Gautier  
Frank Mallette • Jackson County  
Guy Moore • Pascagoula  
Jerry Munro • Ocean Springs  
Rickey Murphy • Jackson County

June 1, 2022

Doc#42893

Mr. Larry Rumsey  
Rumsey Consulting Engineering, Inc.  
910 Howard Avenue  
Biloxi, MS 39530

RE: South Pointe, Phase V (77 Lots)  
South Pointe S/D, Jackson County, MS

Dear Mr. Rumsey:

The Jackson County Utility Authority (JCUA) has reviewed the referenced project plan submitted May 12, 2022, that includes the development of 77 residential lots along in South Pointe S/D in Jackson County, MS. The Authority has received confirmation the stipulations in Document #42892 have been met, therefore the Authority has no objection to the proposed water and wastewater system improvements, provided construction is completed in accordance to the requirements of the MDEQ, MSDH, and the Jackson County Utility Authority.

This approval does not relieve the owner of other permitting responsibilities as required. Should you have any questions or concerns, please do not hesitate to contact me.

Sincerely,

Jerod Martin, P.E.  
Project Engineer, JCUA



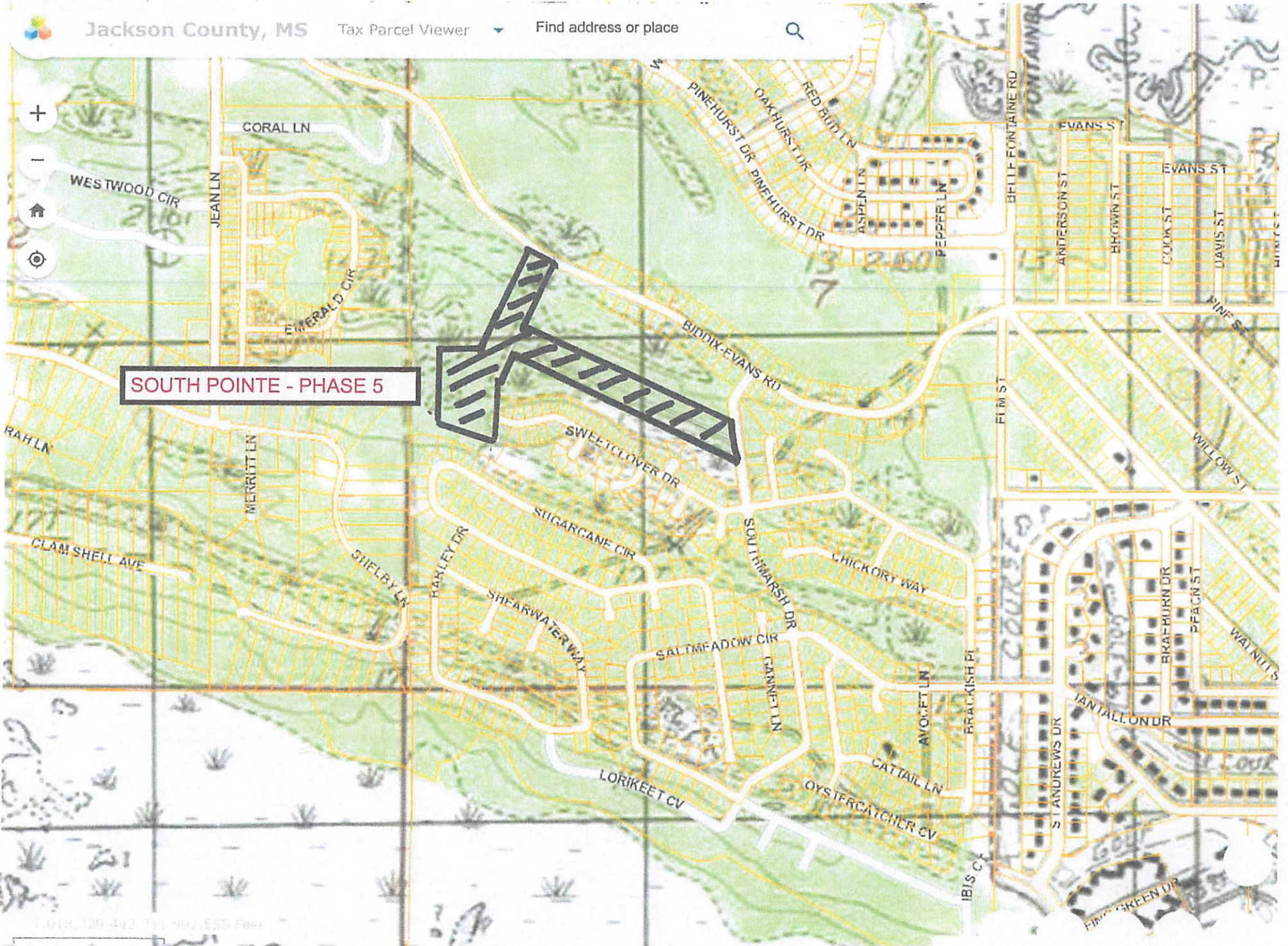

**SOUTH POINTE - PHASE 5**



FOR OPC USE ONLY
AGENCY INTEREST NO. _____
PLANS NO. _____
COVERAGE NO. _____

**COASTAL COUNTY UTILITY AUTHORITY ENVIRONMENTAL CLEARANCE  
FORM TO THE MISSISSIPPI OFFICE OF POLLUTION CONTROL**

This form is required to be completed and submitted to the Mississippi Office of Pollution Control for all proposed projects applying for wastewater approval or construction stormwater coverage in the following counties: Hancock, Harrison, Jackson, Pearl River, and Stone.

PROJECT NAME: South Pointe - Phase 5

ENTITY MAKING APPLICATION: South Point of Mississippi LLC

RESPONSIBLE OFFICIAL: John Lewis, Vice President

COUNTY WHERE PROJECT IS LOCATED: Jackson

**The portions below are to be completed by the appropriate County Utility Authority(CUA)**

1. Is this project consistent with the requirements of the CUA?  
 Yes     No
  
2. Is this project connecting to a facility funded by Community Development Block Grant (CDBG) funds under the Mississippi Gulf Region Water and Wastewater Plan?  
 Yes     No  
 If yes, complete Item 3.; if no, skip Item 3.
  
3. Has this project been coordinated with the U.S. Fish and Wildlife Service to identify the need for a Section 7 consultation for impacts to threatened and/or endangered species?  
 Yes     No  
 If yes, a copy of the consultation clearance letter from the U.S. Fish and Wildlife Service must be attached to this form. If no, this project can not be considered by the Office of Pollution Control.

I hereby certify that I am the official responsible with the Jackson County Utility Authority in these matters, that I am familiar with the information contained in this form, and that, to the best of my knowledge and belief, such information is true, complete, and accurate.

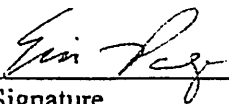
  
 Signature

06/01/2022  
 Date

Executive Director  
 Title

Jackson County Utility Authority  
 Entity

**Rumsey Consulting Engineering, Inc.**

Planning, Surveying, Design

90 Howard Avenue

Biloxi, Mississippi 39530

(228) 432-9344 FAX (228) 432-1189

email: rce@rumseyengineering.com

PROJECT SOUTH PLAINS - PHASE 5

DATE 01-13-20

CALCULATION OF FLOWS TO TRIPLE 13" x 22" RCAPS UNDER SOUTH PLAINS DR.

**DRAIN AREA CALCS.**

<u>A1</u>	<u>A2</u>	<u>A3</u>	<u>A4</u>
A = 4.49 ac	A = 8.52 ac	A = 5.21 ac	A = 6.93 ac
C = 0.40	C = 0.20	C = 0.40	C = 0.40
L = 2068'	L = 1855'	L = 1948'	L = 2145'
S = (15.17 - 13.82) = 0.17%	S = (12.82 - 13.82) = -0.08% <small>USE 0.10%</small>	S = (12.54 - 13.82) = -0.19%	S = (17.51 - 14.47) = 0.14%
tc = 59 min	tc = 149 min	tc = 75 min	tc = 82 min
i = 3.8 in/hr	i = 2.2 in/hr	i = 3.5 in/hr	i = 3.2 in/hr
Q25 = 6.82 cfs	Q25 = 3.75 cfs	Q25 = 7.29 cfs	Q25 = 8.87 cfs

<u>A5</u>	<u>A6</u>	<u>A7</u>	
A = 2.74 ac	A = 4.71 ac	A = 0.90 ac	A =
C = 0.20	C = 0.40	C = 0.50	C =
L = 2045'	L = 1963'	L = 672'	L =
S = (14.64 - 14.47) = 0.01% <small>USE 0.10%</small>	S = (10.58 - 14.47) = -0.11%	S = (14.53 - 13.82) = 0.10%	S =
tc = 252 min	tc = 85 min	tc = 44 min	tc =
i = 1.6 in/hr	i = 3.2 in/hr	i = 4.4 in/hr	i =
Q25 = 2.48 cfs	Q25 = 6.03 cfs	Q25 = 1.98 cfs	Q25 =

<u>A8</u>	<u>A9</u>	<u>A10</u>	<u>A11</u>
A =	A =	A =	A =
C =	C =	C =	C =
L =	L =	L =	L =
S =	S =	S =	S =
tc =	tc =	tc =	tc =
i =	i =	i =	i =
Q25 =	Q25 =	Q25 =	Q25 =

TOTAL CFS TO 3 EA 13" x 22" RCAPS = 37.22 CFS  
 CAPACITY OF 13" x 22" RCAPS = 29.00 CFS < 37.22 CFS

A4, A5, A6 FLOW THROUGH 12" US 11 PIPES UNDER PHASE 5 TIE-IN TO SOUTH PLAINS DR.  
 Q25 = 17.38 ; 13" x 22" @ 0.11% = 3.02 CFS



**Rumsey Consulting Engineering, Inc.**

Planning, Surveying, Design

910 Howard Avenue • Biloxi, MS 39530  
Tel: (228) 432-9344 • Fax: (228) 432-1189  
e-mail: rcei@rumseyengineering.com

June 15, 2022

Mississippi Department of Environmental Quality  
Office of Pollution Control  
P.O. Box 2261  
Jackson, MS 39225

Attn: Mr. Bradley Crain, PE, Chief Municipal and Private Facilities Branch  
Environmental Permits Division

Re: South Pointe – Phase 5, Jackson County, Mississippi

Subject: Preliminary Plans

Dear Mr. Crain:

Please find enclosed in this email the Preliminary Plans and Specifications in PDF for the above referenced project for your review and approval. As requested, the LCNOI Form, OPC Form, Will-Serve Letter, Quad Map, Environmental Clearance Form and Drainage Calculations.

If you need any additional information or if I can be of further assistance, please contact our office at your earliest convenience.

Sincerely,

RUMSEY CONSULTING ENGINEERING, INC.



Lawrence C. Rumsey, P.E.

Attachments