

MIDWAY CONSTRUCTION INC.

P.O. BOX 330 / 230 Beach Rd

ROXIE, MS 39661

PHONE: 601.322.9996

E-mail: office@midwayinc.net

January 10, 2023

~~Paul Devine~~

Chief Environmental Permits Division

MDEQ, Office of Pollution Control

P. O. Box 2261

Jackson, MS 39225

Reference: MINING PERMIT

Mr. Devine,

Please see the enclosed request for a mining permit for a proposed dirt pit in Wilkinson County, MS.

If you have questions or concerns please let me know. I have enclosed my card with all my information on it.

Sincerely,



Eddie Beach,

President

Cell: 601-807-4723

EB/nr

At: 83068

Hard copy
Rec'd 01/10/2023

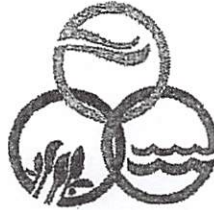

MISSISSIPPI DEPARTMENT OF
ENVIRONMENTAL QUALITY

**MINING NOTICE OF INTENT (MNOI)
FOR COVERAGE UNDER
MINING STORM WATER, DEWATERING AND NO DISCHARGE
GENERAL PERMIT MSR32 2997**

(Number to be assigned by State)

File at least 30 days prior to the commencement of mining; 15 days if a Storm Water Pollution Prevention Plan (SWPPP) is already on file and mine dewatering is not proposed. Lateral expansion of an existing mine that has general permit coverage requires the submittal of the Major Modification Form, not a new MNOI (modification of the existing SWPPP to include the expansion is required). Discharge of storm water or impounded water associated with mining or the operation of a wastewater recirculation system with no discharge without written notification of coverage from MDEQ is a violation of State Law.

Please indicate the activities to be covered by this MNOI (check all that apply).

- ☒ Storm Water Discharges Associated with Mining ☐ Mine Dewatering
☐ Wastewater Recirculation System with No Discharge

The appropriate section of the MNOI must be completed if the applicant proposes to discharge storm water, discharge impounded mine water (dewatering) and/or operate a wastewater recirculation system with no discharge. A USGS quadrangle map, or a copy, indicating the site location and outfalls, and a SWPPP must be included with the MNOI submittal. Additional submittals may include the following (check all that apply):

- ☒ Notice of Exempt Operations Form ☐ Section 404 Documentation
☐ Dam/Reservoir Safety Permit or Written Authorization

ALL INFORMATION MUST BE COMPLETED (indicate "N/A" where not applicable)

APPLICANT IS THE:

☒ OPERATOR

☐ LANDOWNER

(Must check one or both)

OPERATOR INFORMATION

OPERATOR CONTACT PERSON: Eddie Beach
OPERATOR COMPANY NAME: Midway Construction Inc
OPERATOR STREET OR P. O. BOX: P.O. Box 330
OPERATOR CITY: Roxie STATE: MS ZIP: 39661
OPERATOR PHONE NUMBER (601) 907-4723 EMAIL ADDRESS: eb@midwayinc.net

LANDOWNER INFORMATION

LANDOWNER CONTACT PERSON: Donald Enis
LANDOWNER COMPANY: N/A
LANDOWNER STREET OR P. O. BOX: 201-399 Big Piney Ln.
LANDOWNER CITY: Woodville STATE: MS ZIP: 39669
LANDOWNER PHONE NUMBER: (601) 334-1312 EMAIL ADDRESS: N/A

Oc

MINE INFORMATION

NAME OF MINE: <u>Enis mine</u>	
STREET ADDRESS OR NEAREST NAMED ROAD: <u>Hwy 61</u>	
NEAREST CITY: <u>Woodville MS</u>	COUNTY: <u>Wilkinson</u>
<u>NW</u> 1/4 OF <u>NW</u> 1/4 OF SECTION <u>4</u>	TOWNSHIP <u>5-N</u> RANGE <u>4-W</u>
ATTACH A USGS QUAD MAP, EXTENDING 1/4 MILE BEYOND FACILITY, OUTLINING THE MINE BOUNDARIES (Maps can be obtained from the Mississippi Office of Geology. For information call 601-961-5523).	
LATITUDE: <u>31</u> degrees <u>27</u> minutes <u>70.40</u> seconds	LONGITUDE: <u>91</u> degrees <u>32</u> minutes <u>54.70</u> seconds
METHOD USED TO DETERMINE LAT & LONG (GPS (Please GPS Entrance Gate) or Map Interpolation): _____	
TOTAL ACREAGE: <u>6.5</u>	MATERIAL TO BE MINED: <u>Dirt</u>
WILL HYDRAULIC DREDGING BE USED? <input type="checkbox"/> YES <input checked="" type="checkbox"/> NO	WASHING OF SAND/GRAVEL? <input type="checkbox"/> YES <input checked="" type="checkbox"/> NO
RECEIVING STREAM: <u>Big Piney Creek</u>	
IS RECEIVING STREAM ON MISSISSIPPI'S 303(d) LIST OF IMPAIRED WATER BODIES? (The 303(d) list of impaired waters and TMDL stream segments may be found on MDEQ's web site: http://www.deq.state.ms.us/MDEQ.nsf/page/TWB_Total_Maximum_Daily_Load_Section)	
<input type="checkbox"/> YES <input type="checkbox"/> NO	
HAS A TMDL BEEN ESTABLISHED FOR THE RECEIVING STREAM SEGMENT?	
<input type="checkbox"/> YES <input type="checkbox"/> NO	
ESTIMATED START DATE: <u>2/6/23</u> HUC CODE (FOR MDEQ USE ONLY): _____	

COMPLETE IF STORM WATER DISCHARGE IS PROPOSED

STANDARD INDUSTRIAL CLASSIFICATION (SIC) CODE: _____
ATTACH A STORM WATER POLLUTION PREVENTION PLAN (SEE PERMIT FOR REQUIREMENTS)
IDENTIFY THE ASSOCIATION OR GENERIC SWPPP ON FILE AT MDEQ: _____

COMPLETE IF WASTEWATER RECIRCULATION SYSTEM WITH NO DISCHARGE IS PROPOSED

DISTANCE BETWEEN RECIRCULATION POND(S) AND PROPERTY LINE: _____ (FT) (MUST BE AT LEAST 150 FEET)
NUMBER OF RECIRCULATION POND(S): _____
STORAGE CAPACITY OF EACH RECIRCULATION POND(S): _____ (FT ³)

COMPLETE IF MINE DEWATERING IS PROPOSED

ESTIMATED DEWATERING VOLUME: _____ (GAL/DAY)
NAME AND ADDRESS OF THE RECIPIENT OF THE DISCHARGE MONITORING REPORTS (DMRs), IF DIFFERENT FROM SIGNATORY:

DOCUMENTATION OF COMPLIANCE WITH OTHER REGULATIONS/REQUIREMENTS

Coverage under this general permit will not be granted until all other required MDEQ permits and approvals are addressed.

WILL THE CONSTRUCTION OR OPERATION OF THIS MINE INVOLVE THE RE-ROUTING, FILLING OR CROSSING OF A WATER CONVEYANCE OF ANY KIND? ☐ YES ☒ NO

If yes, contact the U.S. Army Corps of Engineers' Regulatory Branch for permitting requirements. If the mine requires a Corps of Engineers Section 404 permit, provide appropriate documentation with this MNOI that:

- The mine has been approved by individual permit, or
- The work will be covered by a nationwide permit and NO NOTIFICATION to the Corps is required, or
- The work will be covered by a nationwide or general permit and NOTIFICATION to the Corps is required.

LIST ANY NPDES PERMIT NO(s). _____ GEOLOGY APPLICATION/PERMIT NO. _____

LIST OTHER GEOLOGY PERMIT NUMBERS THAT APPLY TO COVERAGE AREA _____

IS THE MINE LESS THAN 4 ACRES AND GREATER THAN 1320 FEET FROM ANOTHER MINE?

☒ YES A "Notice of Exempt Operations" Form must be included with the MNOI or proof of prior submission, if previously submitted to the Office of Geology.

☐ NO A "Notice of Intent to Mine Class I or Class II Materials" Form must be filed before coverage will be granted under the Mining General Permit. For information on Office of Geology requirements, call 601-961-5527.

LIST ANY LOCAL STORM WATER ORDINANCES WITH WHICH THE OPERATIONS MUST COMPLY AND SUBMIT ANY

ASSOCIATED APPROVAL DOCUMENTATION. _____

IF AN IMPOUNDMENT WILL BE CONSTRUCTED ABOVE NATURAL SURFACE ELEVATIONS, INDICATE WHICH, IF ANY, OF THE FOLLOWING APPLY.

☐ The impoundment will be constructed with a peripheral dam or levee 8 feet or greater in height, measured from the lowest elevation of its toe.

☐ The impoundment will have a maximum storage volume greater than 25 acre-feet.

☐ The impoundment will impound a watercourse with a continuous flow.

☐ The impoundment has the potential to threaten downstream lives or man-made structures.

If the impoundment meets any of the above criteria, the applicant will be required to obtain written authorization from MDEQ, Dam Safety Division before coverage will be granted under the Mining General Permit.

I certify under penalty of law that this document and all attachments were prepared under my direction or supervision in accordance with a system designed to assure that qualified personnel properly gathered and evaluated the information submitted. Based on my inquiry of the person or persons who manage the system, or those persons directly responsible for gathering the information, the information submitted is, to the best of my knowledge and belief, true, accurate and complete. I am aware that there are significant penalties for submitting false information, including the possibility of fine and imprisonment for knowing violations.

Eddie Beach
Authorized Signature

1/10/23
Date

Eddie Beach
Printed Name

President
Title

This application shall be signed according to the General Permit, Act 15, T-4 as follows:

- For a corporation, by a responsible corporate officer.
- For a partnership, by a general partner.
- For a sole proprietorship, by the proprietor.
- For a municipal, state or other public facility, by either a principal executive officer, the mayor, or ranking elected official.

Please submit this form to:

Chief, Environmental Permits Division
MDEQ, Office of Pollution Control
P.O. Box 2261
Jackson, Mississippi 39225

1:11



Inset C
TIN RLC

R 2 W

T 5 N

R 3 W

ADAMS COUNTY

T 4 N

R 4 W

ADAMS COUNTY

Proposed Dirt Pit
(See Next sheet)

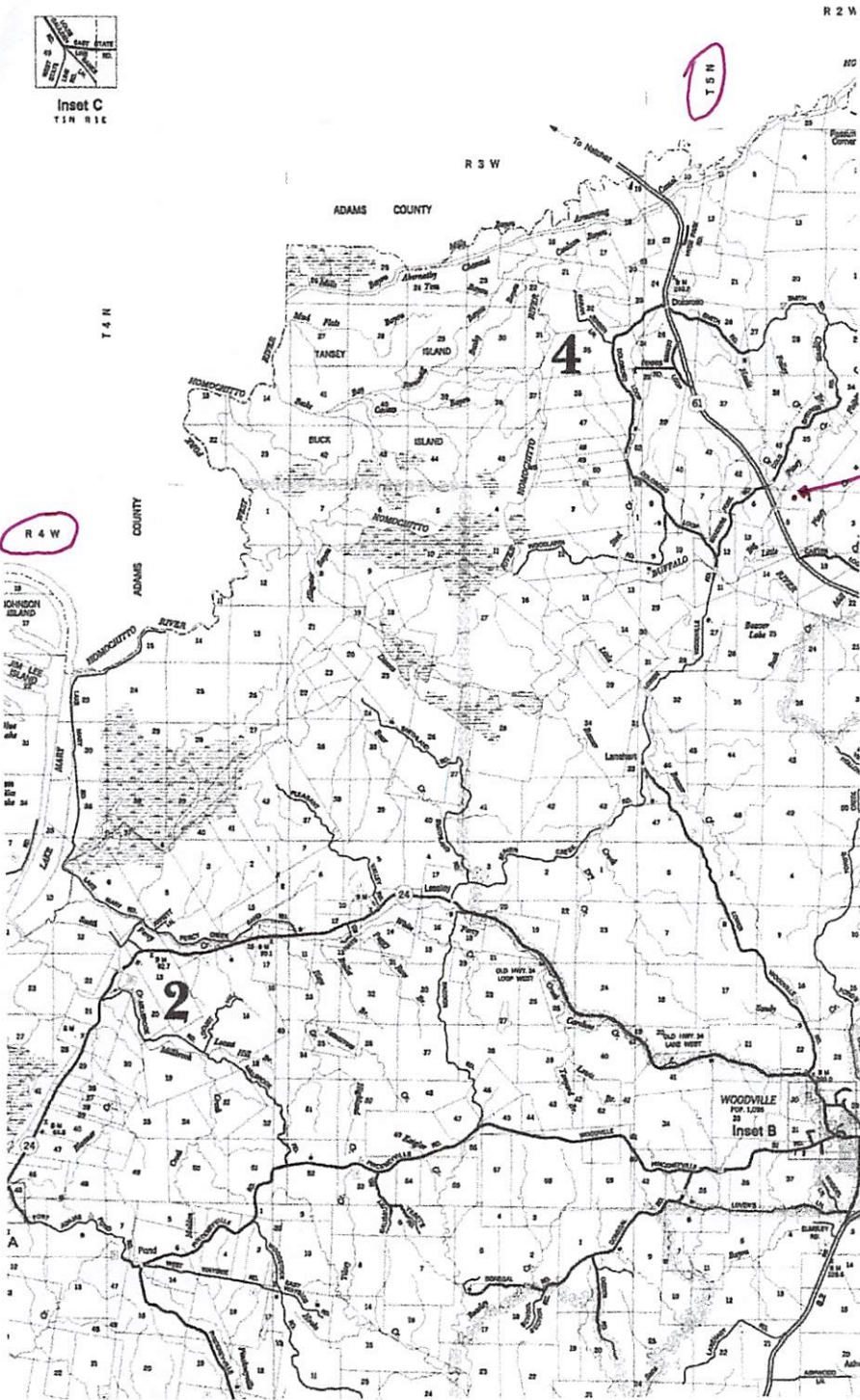

Not Secure — son.co.ms.gov ↻

Eddie Beach
Midway Construction Inc.



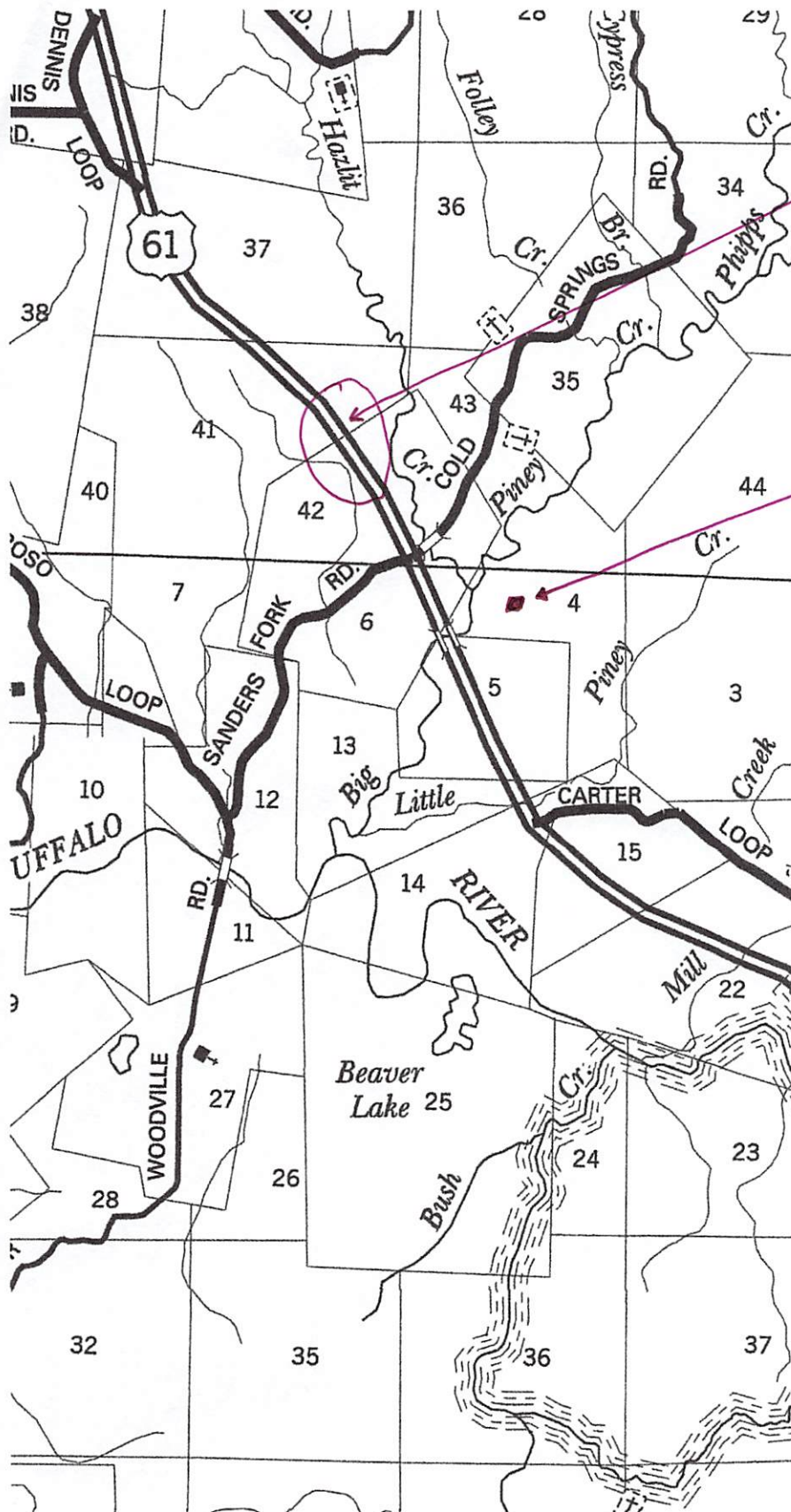

Proposed Dirt Pit
ENIS MINE

Eddie Beach
Midway Construction Inc.

Lat. $31^{\circ} - 27' - 70.40''$
 Lon $91^{\circ} - 32' - 54.70''$

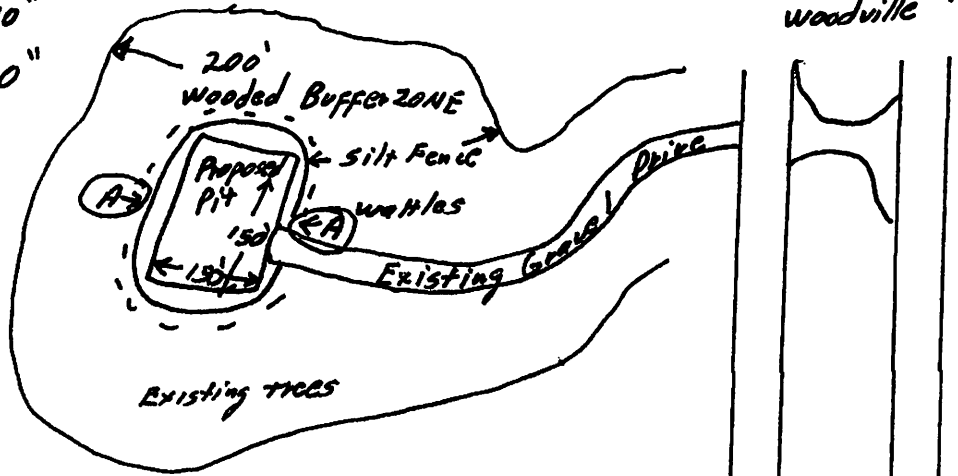
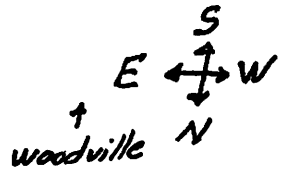

Section A-A

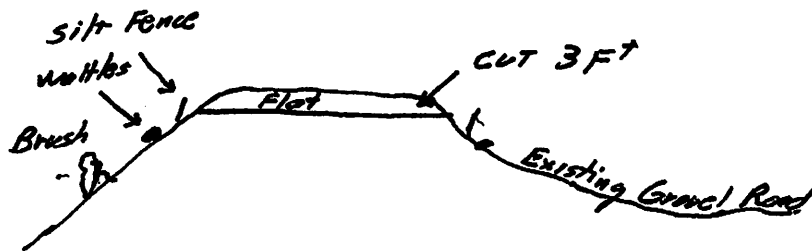

Section AA
Detail

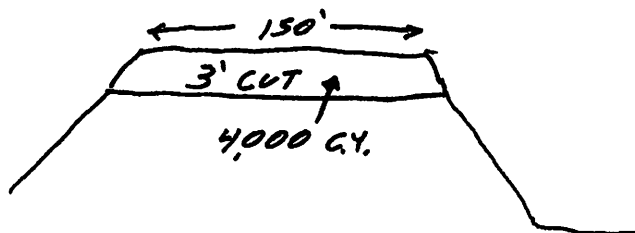

Enis mine
 Wilkinson County MS.

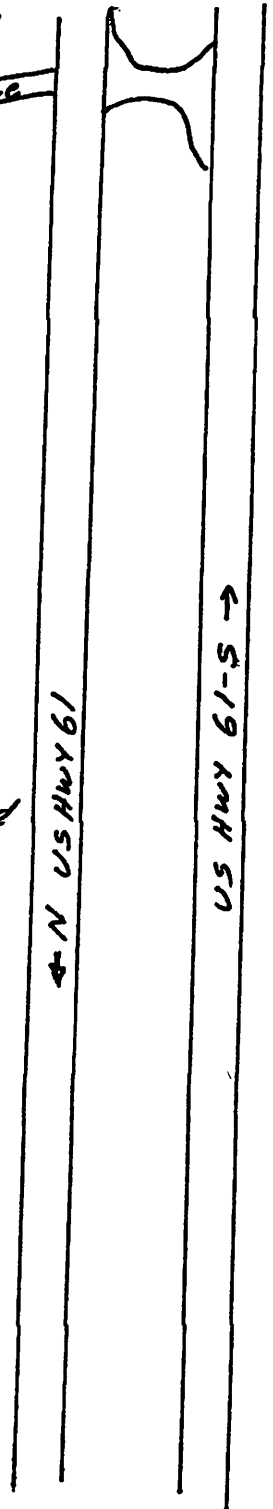

Eddie Beal
 Midway Construction Inc.
 1/10/23

STORM WATER POLLUTION PREVENTION PLAN (SWPPP)

ENIS MINE WILKINSON COUNTY

SITE INFORMATION

This site will be used as a dirt pit for road projects in Wilkinson County. Access to site will be on existing roadways. The site is located Section 4, T5-N, R 4-W, R1-W. Lat. 31-27' 54.70". Long. 91-32' -54-70".

SEDIMENT AND EROSION CONTROLS

Vegetative controls: A 200 (two hundred) foot vegetative buffer zone consisting of grass and trees will be maintained at all sides of property where runoff will be flowing. Existing trees will be preserved where possible. Any disturbed areas that will be left undisturbed for 30 (thirty) days will be seeded (temporary seeded) within 7 (seven) calendar days. After final grading all disturbed areas will be seeded (permanent seeding) within 7 (seven) calendar days.

Structural Controls: Wattles and silt fence will be placed on all sides of the property where storm water runoff will be directed. A construction entrance will be built and any accumulation of mud on vehicle tires will be washed as needed, during muddy conditions. Road will be swept also, if needed, during muddy conditions.

Housekeeping practices: All equipment maintenance and repair will be done off site. Trash bags will be stored in supervisors' pick-ups. No toxic materials will be stored on this site. Portable sanitary facilities will be provided for construction workers.

Post construction Control Measures: Upon completion of construction, pit area will be nearly level, which will be grassed immediately to combat post construction erosion.

IMPLEMENTATION SEQUENCE

1. Build construction entrance/exit
2. Silt fence/Wattles placed on all sides
3. Finish grading the pit and slopes
4. Seed site (permanent seeding)
5. After site is stabilized and grass growing, all silt fence will be removed.

MAINTENANCE PLAN: Check all disturbed areas, erosion and sediment controls after each significant rainfall but not less than one per week. Make needed repairs within 24 (twenty four) hours. Maintain all vegetated areas to provided proper ground cover-reseed, fertilize, and mulch as needed.

Eddie Beach

Prime Contractor's Signature

1/10/23

Date

Eddie Beach

Printed Name

1/10/23

Date