

MISSISSIPPI ASBESTOS DEMOLITION/RENOVATION NOTIFICATION FORM

Mail notification to: **MDEQ Asbestos and Lead Branch, 515 E. Amite Street, Jackson, MS 39201**

MDEQ Use Only: <input checked="" type="checkbox"/> Email <input type="checkbox"/> Mail <input type="checkbox"/> Hand Delivery		Postmark (mail only)	Date Received 3/18/2024	AI Number
I. Type of Notification (O=Original R=Revised C=Canceled A= Annual) Original				
II. TYPE OF OPERATION (D=Demo O= Ordered Demo R=Renovation E=Emer. Renovation) Demo				
III. FACILITY DESCRIPTION (Include building name, number and floor or room number)				
Bldg. Name:				
Address: 421 West Woodrow Wilson Ave				
City: Jackson		State: MS	Zip:	County: Hinds
Site Location:			Tel:	
Building Size: 45'x200' 150'x200'		# of Floors: 1	Age in Years: 80	
Present Use: unoccupied		Prior Use: uniform provider		
IV. FACILITY INFORMATION (Identify owner, asbestos removal contractor, and other operator)				
OWNER NAME: Aramark Uniform				
Address: 115 N. First. St.				
City: Burbank		State: CA	Zip: 91502	
Contact: Quinton McDonald			Tel: 615-579-8724	
ASBESTOS REMOVAL CONTRACTOR: Eagle Construction				
Address: 1450 Old Brandon Rd				
City: Brandon		State: MS	Zip: 39232	
Contact: Chuck Womack			Tel: 601-940-5411	
Certification Number: ABC-1799			Expiration Date: 3-3-24	
OTHER OPERATOR: Faircloth Demolition				
Address: P.O. Box 1296				
City: Clinton		State: MS	Zip: 39056	
Contact: Mark Parkman			Tel: 601-573-3762	
V. WAS SITE INSPECTED TO DETERMINE PRESENCE OF ASBESTOS? (Yes/No):				
WAS ASBESTOS PRESENT? <input checked="" type="radio"/> Yes <input type="radio"/> No:			Inspection Date: 11/29/2007	
Inspector: Christiana Woodall		Certification Number:	Expiration Date:	
VI. SUSPECT MATERIALS SAMPLED AND PROCEDURES USED TO DETECT THE PRESENCE OF ASBESTOS MATERIAL: see attached				
VII. QUANTITY OF RACM TO BE REMOVED: 100 lf. Window Glazing - 150 SF Floor Tile/Mastic - 65 SF Linoleum - 150 lf. Roof Tar/Flashing				
Pipes (LN FT):		Surface Area (SQ FT):	Volume of Facility Components (CU FT):	
VIII. QUANTITY OF NONFRIABLE ASBESTOS NOT REMOVED:				
Category I:			Category II:	
IX. SCHEDULED DATES ASBESTOS REMOVAL (MM/DD/YY) Start: 4-1-24			Complete: 4-2-24	
X. SCHEDULED DATES DEMO/RENOVATION (MM/DD/YY) Start: 4-2-24			Complete: 4-22-24	

XI. DESCRIPTION OF PLANNED DEMOLITION OR RENOVATION WORK, AND METHOD(S) TO BE USED:

Demo with trackhoe

XII. DESCRIPTION OF WORK PRACTICES AND ENGINEERING CONTROLS TO BE USED TO PREVENT EMISSIONS OF ASBESTOS AT THE DEMOLITION OR RENOVATION SITE:

Wet Demo

XIII. WASTE TRANSPORTER #1

Name: American Disposal Service

Address: P.O. Box 1296

City: Clinton

State: MS

Zip: 39060

Contact Person: Mark Parkman

Tel: 601-573-3762

WASTE TRANSPORTER #2

Name: Eagle Construction

Address: 1450 Old Brandon Rd

City: Flowood

State: MS

Zip: 39232

Contact Person: Chuck Womack

Tel: 601-940-5411

XIV. WASTE DISPOSAL SITE

Name: Faircloth Rubbish Landfill

Little Dixie Landfill
1716 N. County Line Rd
Ridgeland, MS 39157

Address: 1312 Springridge Rd

City: Clinton

State: MS

Zip: 39056

Contact Person: Mark Parkman

Tel: 601-922-5632

XV. IF DEMOLITION ORDERED BY A GOVERNMENT AGENCY, PLEASE IDENTIFY THE AGENCY BELOW:

Name:

Title:

Authority:

Date of Order (MM/DD/YY):

Date Ordered to Begin (MM/DD/YY):

XVI. FOR EMERGENCY RENOVATIONS:

Date and Hour of Emergency (MM/DD/YY):

Description of the sudden unexpected event:

Explanation of how the event caused unsafe conditions or would cause equipment damage or an unreasonable financial burden:

XVII. DESCRIPTION OF PROCEDURES TO BE FOLLOWED IN THE EVENT THAT UNEXPECTED ASBESTOS IS FOUND OR PREVIOUSLY NONFRIABLE ASBESTOS MATERIAL BECOMES CRUMBLLED, PULVERIZED, OR REDUCED TO POWDER:

stop work and call asbestos contractor

XVIII. I CERTIFY THAT AN INDIVIDUAL TRAINED IN THE PROVISIONS OF THIS REGULATION (40 CFR PART 61, SUBPART M) WILL BE ONSITE DURING THE DEMOLITION OR RENOVATION, AND EVIDENCE THAT THE REQUIRED TRAINING HAS BEEN ACCOMPLISHED BY THIS PERSON WILL BE AVAILABLE FOR INSPECTION DURING NORMAL BUSINESS HOURS.

Mark Parkman

Type or Print Name

[Signature]

(Signature of Owner/Operator)

3-18-24

(Date)

XIX. I CERTIFY THAT THE ABOVE INFORMATION IS CORRECT:

Mark Parkman

Type or Print Name

[Signature]

(Signature of Owner/Operator)

3-18-24

(Date)



Summary of Findings:

Mold Investigation

Mold air samples collected throughout the building and offices revealed elevated spore counts in all locations.

Lead Survey

Paint analyzed with a Niton XRF revealed Lead Based Paint to be present in the Girls Restroom. No other painted surface in the building was found to contain lead.

Note:

An attempt was made to screen all uniquely painted surfaces at the property. The majority of painted sources were screened. However, there maybe surfaces that were concealed or inaccessible at the time of this assessment that were not screened for lead.

Asbestos Survey

Building materials found to contain asbestos are as follows:

- Window Putty Glazing in the Mechanical Building
- 9x9 Brown Floor Tile and Black Mastic in the Vault
- Black Mastic under the Vinyl Floor Sheeting in Restroom #2
- Roof Tar

These materials can either be left in place or removed. Any actions taken to remove the identified asbestos containing materials should be done in such a manner as to keep the asbestos in a non-friable state. Once properly removed, the non-friable asbestos containing materials should be able to be disposed of in an asbestos landfill.

Sincerely,

Christiana Woodall
Industrial Hygienist
RGA Environmental, Inc.
111 Veterans Memorial Blvd.
Suite 810
Metairie, LA 70005

Summary of Findings

Asbestos Survey
11/29/07

Field I.D.	Material Description	FRI	Sample Location	Estimated % Asbestos (< = less than)			Miscellaneous Notes
				AMOS	CHRY	CROC	
ENVMA-112907-A-01	1X1CT White (holes)	F	Hall, Office 4, Office 2				
ENVMA-112907-A-02	1X1 FT Gray	N	Under Floor in Offices				
ENVMA-112907-A-03	9x9 Ft/Black Mastic	N	Vault		3%		Brown Hard Tile & Mastic
ENVMA-112907-A-04	Rock Wall (old Vers. Of GWB)	F	Office 1, Office 2 Behind DW				
ENVMA-112907-A-05	2x4 CT	F	Upstairs Office				
ENVMA-112907-A-06	2x4 CT	F	Upstairs Office				
ENVMA-112907-A-07	Vinyl Sheeting	N	RR2		3%		Black Mastic
ENVMA-112907-A-08	Insulation	F	In Office Walls				
ENVMA-112907-A-09	Plaster Walls	N	Vault				
ENVMA-112907-A-10	GWB	F	Behind Office Walls				
ENVMA-112907-A-11	Vinyl Sheeting	N	Office 3,4				
ENVMA-112907-A-12	1x1 CT Brown	F	Office 2				
ENVMA-112907-A-13	1x1 Ct White (Pattern)	F	Hall, Office 2				
ENVMA-112907-A-14	1x1 FT over Gray Painted Concrete	N	Kitchen 2				
ENVMA-112907-A-15	Window Caulking	N	Kitchen 2				
ENVMA-112907-A-16	Cove Base Glue	N	Office 5				
ENVMA-112907-A-17	Cove Base Glue	N	Office, Kitchen 2				
ENVMA-112907-A-18	AC Duct Gil Wrap	N	Office 5				
ENVMA-112907-A-19	1x1 CT Plain White	F	Office 9 (Up)				
ENVMA-112907-A-20	Window Putty	N	Car Sales Office				
ENVMA-112907-A-21	Plaster/Concrete Walls	N	Car Sales Office				

RGA Environmental
111 Veterans Memorial Blvd.
Suite 810
Metairie, LA 70005

Summary of Findings

Asbestos Survey
11/29/07

Field I.D.	Material Description	FRI	Sample Location	Estimated % Asbestos (< = less than)			Miscellaneous Notes
				AMOS	CHRY	CROC	
ENVMA-112907-A-22	Tank Drain Pipe Wrap	F	1" Pipe Boiler Room 1				
ENVMA-112907-A-23	Pipe Wrap	F	2" Pipe Boiler Room 1				
ENVMA-112907-A-24	6" Pipe	F	Boiler Room 1				
ENVMA-112907-A-25	6" Elbow Pipe Wrap	F	Boiler Room 1				
ENVMA-112907-A-26	8" Pipe Wrap	F	Boiler Room 1				
ENVMA-112907-A-27	8" Elbow Pipe Wrap	F	Boiler Room 1				
ENVMA-112907-A-28	18" Patch Wrap	F	Boiler Room 1				
ENVMA-112907-A-29	4" Pipe Wrap	F	Boiler Room 1				
ENVMA-112907-A-30	3" Pipe Wrap	F	Boiler Room 1				
ENVMA-112907-A-31	3" Elbow	F	Boiler Room 1				
ENVMA-112907-A-32	Silver Paint in Boiler	N	Boiler Room 2				
ENVMA-112907-A-33	Insulation on Boiler	F	Boiler Room 2				
ENVMA-112907-A-34	Insulation - Sprayed In	N	Garage				
ENVMA-112907-A-35	Lining In Pit	N	Mechanical				
ENVMA-112907-A-36	CT 1x1	F	Mechanical Storage				
ENVMA-112907-A-37	Window Putty	N	Mechanical Storage		2%		Window Putty
ENVMA-112907-A-38	Silver Paint in Boiler	N	Mechanical				
ENVMA-112907-A-39	Tar Paper	F	Roof				
ENVMA-112907-A-40	Vent Insulation	F	Roof				
ENVMA-112907-A-41	Patch Tar	N	Roof				
ENVMA-112907-A-42	Roof Tar	N	Roof				

RGA Environmental
111 Veterans Memorial Blvd.
Suite 810
Metairie, LA 70005

Summary of Findings

Asbestos Survey
11/29/07

Field I.D.	Material Description	FRI	Sample Location	Estimated % Asbestos (< = less than)			Miscellaneous Notes
				AMOS	CHRY	CROC	
ENVMA-112907-A-43	Roof Tar	N	Roof		5%		Roof Tar
ENVMA-112907-A-44	Silver Lined Insulation	F	Mechanical				

limit = 1% by volume.

NA=Not analyzed

NAD=No Asbestos Detected

NQ=Not Quantified

SF=Square Feet

LF=Linear Feet

Ace=Accessibility

S=Staff Only

M=Moderate

E=Easy

Environmental Management and Engineering

Samples Tested Positive

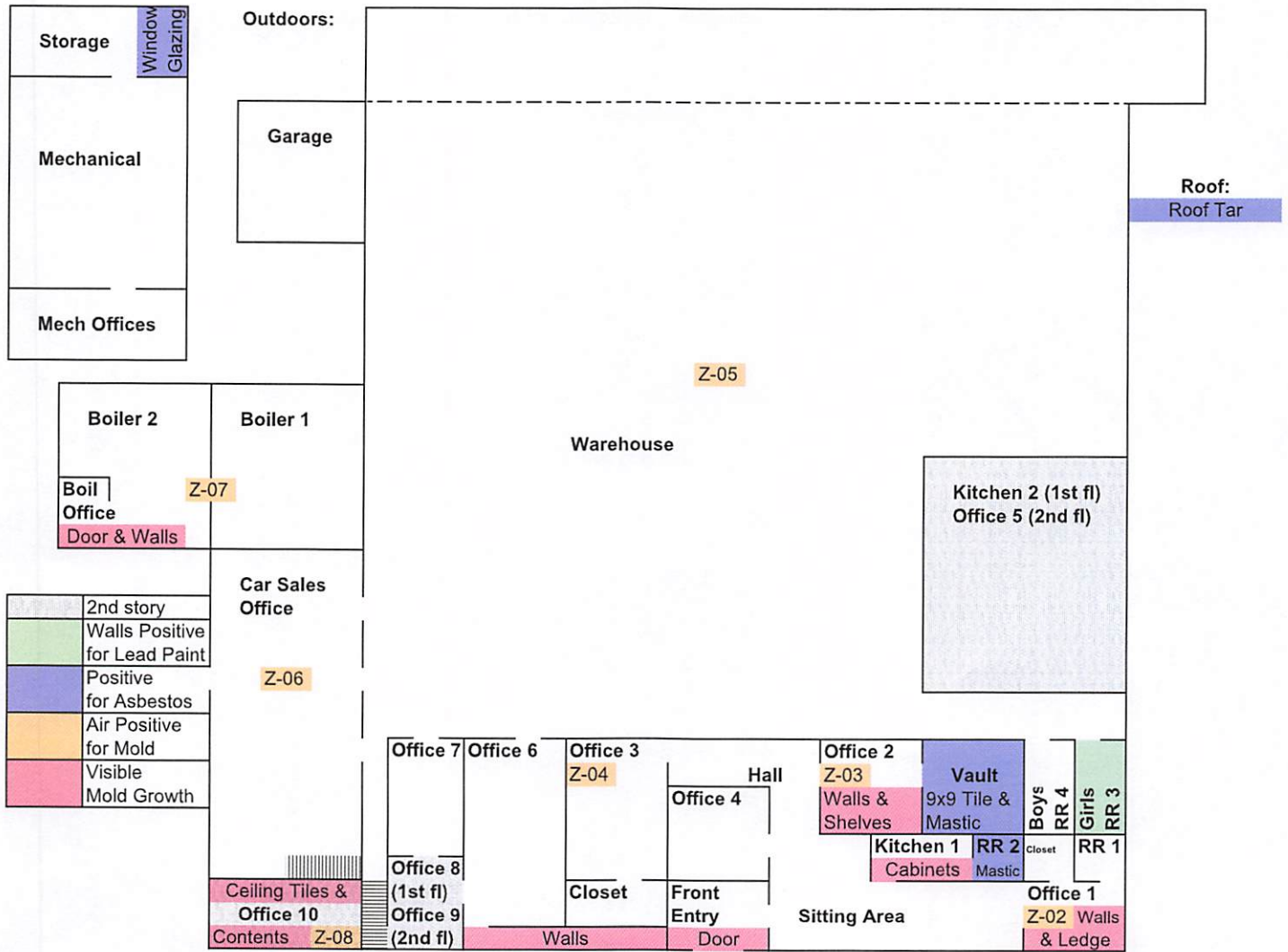

Environmental Management and Engineering

Samples Collected

