

STORM WATER POLLUTION PREVENTION PLAN

OLD 63 SQUARE COMMERCIAL SUBDIVISION

CITY OF LUCEDALE, GEORGE COUNTY, MISSISSIPPI

PREPARED FOR:



ANDERSON CO.

PREPARED BY:



EXECUTIVE SUMMARY

Phelan Engineering, LLC was engaged by Anderson Construction to provide engineering design services for Old 63 Square; a commercial subdivision. The project site is on the east side of the Old Highway 63 and Scott Road intersection in the City of Lucedale, George County, MS; approximate coordinates for the site are 30.900, -88.596081.

The project looks to construct all infrastructure (i.e. roads, water, sewer, drainage, etc.) required for a 6-lot commercial subdivision development; this SWPPP and associated LCNOI is for the infrastructure only with individual lot construction to be considered at a later date. The project will disturb the entire 15.57 acres of the property. As required by the Mississippi Department of Environmental Quality (MDEQ) this Stormwater Pollution Prevention Plan (SWPPP) is being prepared for this specific project for coverage under the Large Construction General Permit.

This SWPPP seeks to outlay the Erosion and Sediment Controls that will be utilized, soil stabilization practices, vegetative practices, structural controls, post construction controls remaining, housekeeping, etc. as well as discuss the receiving stream most affected, implementation of this plan, maintenance of Best Management Practices (BMPs), and site inspections.

Finally, attachments to this report will further illustrate the means of providing sediment and erosion control on site.

<i>Describe the nature of the construction activity:</i>	Construction will consist of infrastructure (roads, water, sewer, drainage, etc.) and grading necessary for an 6-lot commercial subdivision; roads will be approximately 2/10 of a mile.
<i>Describe the intended sequence of major soil disturbing activities:</i>	<ol style="list-style-type: none"> 1) Installation of construction exit. 2) Install initial erosion and sediment control BMPs (these will be maintained and updated as construction progresses). 3) Begin site clearing and grubbing. 4) Perform Earthwork operations to get site to rough grade. 5) Install water, sewer, and drainage facilities 6) Grade road to final grades and pave. 7) Provide permanent stabilization (vegetative cover with a density of at least 70% for the area has been established or equivalent measures (e.g., concrete or asphalt paving, rip rap, etc.) have been employed) 8) Remove all temporary BMPs <p>Contractor will ensure that proper BMPs, commiserate with those shown on this SWPPP and its attachments, will be utilized between phases to protect completed phases from sedimentation on phases under construction.</p>
<i>Total area of the site:</i>	15.57 Acres
<i>Total area of the site to be disturbed:</i>	15.57 Acres
<i>Existing data describing the soil or quality of any stormwater discharge from the site:</i>	<p>Per Web Soil Survey, site is 100% McLaurin fine sandy loam.</p> <p>Stormwater discharge from this site appears to be of normal quality as the site remains undeveloped.</p>
<i>Estimate the drainage area size for each discharge point:</i>	The entire site (15.57 ac) slopes west to east with ultimate outfall near the NE corner of the site.
<i>Latitude and longitude of each discharge point and identify the receiving water or MS4 for each discharge point:</i>	<p>Northeast: 30.9008, -88.5935</p> <p>Offsite, twin barrel 42" culverts take the drainage to Big Cedar Creek. There is no MS4 for Lucedale or George County.</p>
<i>Total Maximum Daily Load (TMDL) for receiving streams</i>	<p>Big Cedar Creek is in the Davis Dead River Basin (#405212) with a Mercury TMDL listed.</p> <p>Civil Construction projects such as the one contemplated are not expected to release mercury into the environment.</p>

Give a detailed description of all controls, Best Management Practices (BMPs) and measures that will be implemented at the construction site for each activity identified in the intended sequence of major soil disturbing activities section.

Construction Exit – Stone pad to remove sediment trapped on vehicle tires.

Check Dam – Straw wattle, hay bale, stone, or similar barrier along a flow line/discharge point to reduce erosion and capture dislodged sediment.

Diversion Ditch – a designed watercourse set either to route undisturbed water around disturbed land or to route disturbed lands to proper erosion control BMPs.

Grass Swale – constructed channel (permanent or temporary) to both handle runoff and use vegetations natural ability to clean stormwater.

Inlet Protection – sediment barrier placed around an inlet structure or open pipe end to prevent dislodged sediment from entering underground drainage conveyance.

Rock Filter Dam – stone embankment used to capture sediment on the upstream side; includes a settling pooling area.

Sediment Barrier (silt fence) – temporary barrier to utilizing a geotextile fabric to prevent sediment from running off downstream.

Sediment Basin – an earthen embankment suitably located to capture runoff and designed to provide an area for runoff to pool and settle out a portion of the sediment.

Describe all temporary and permanent stabilization practices. Stabilization practices include temporary seeding, mulching, permanent seeding, geotextiles, sod stabilization, vegetative buffer strips, protection of trees, vegetative preservations, etc.

Dust Control – use of water to keep wind-blown sediment from dislodging.

Erosion Control Blanket – a temporary protective made of biodegradable materials used to cover seeded bare earth and limit loss of seed during germination.

Seeding – both temporary and permanent, to include establishment of vegetation on all disturbed areas with no ongoing Work. Seeding will be per the attached chart.

Preservation of vegetation – avoidance of an area during land disturbing.

Buffer Strips – a vegetated strip (preferably natural/undisturbed) between disturbed areas and sensitive areas (i.e. existing wetlands).

Protection of Trees – maintaining trees that do no conflict with proposed construction to maintain tree roots' ability to "hold" sediment particles in place.

Note, Vegetative stabilization measures must be initiated whenever any clearing, grading, grubbing, excavating or other land disturbing activities have temporarily or permanently ceased on any portion of the site and will not resume for a period of fourteen (14) calendar days or more. The appropriate temporary or permanent vegetative practices shall be initiated immediately (no later than the next work-day.)

Describe all sediment basins to be implemented for areas that will disturb 10 or more acres at one time. The sediment basins (or an equivalent alternative) should be able to provide 3,600 cubic feet of storage for each acre drained.

No single point of discharge handles greater than 10 acres and therefore no sediment basin is contemplated.

Describe all permanent stormwater management controls such as, but not limited to, detention or retention systems or vegetated swales that will be installed during the construction process.

A detention pond will serve the site in perpetuity to allow for post-developed flow rates to mimic pre-development. The pond is located in naturally lower areas to avoid the need for excessive dirtwork and/or piping to route flow to the pond(s). Further, the pond on this site will provide better water quality capability. The pond will have a single pipe outfall and an emergency spillway set ABOVE the anticipated 100-year water surface elevation.

Grated inlets and throated curb inlets will connect underground pipe networks to discharge stormwater runoff either through the pond(s) or at natural low points. However, vegetated (grass swales) will be provided where concentrated drainage travels overland and will handle the majority of runoff.

Describe in detail controls for the following potential pollutants:

<i>Waste disposal, this may include construction debris, chemicals, litter, and sanitary wastes:</i>	Contractor will be required to provide waste receptacles and portable toilets around the construction site.
<i>Offsite vehicle tracking from construction entrances/exits:</i>	A 50'x20' stone construction exit will be constructed at the single point of entrance. This stone exit will be monitored and regraded/cleaned as necessary. This stone entrance will be moved as phases progress.
<i>The proper application rates of all fertilizers, herbicides and pesticides used at the construction site:</i>	Fertilizers, herbicides, and pesticides, will be stored in designated protected areas. Application rates will be no higher than manufacturer's recommendations. Fertilizers will be tilled in to limit fertilizer runoff.
<i>The storage, application, generation and migration of all toxic substances:</i>	Toxic substances will be stored in protected areas. Fuels will be stored on removable trailers. Equipment maintenance will occur off-site. Spill prevention practices and response procedures will be communicated to workers.

Provide a detailed description of the maintenance plan for all structural and non-structural controls to assure that they remain in good and effective operating condition.

Erosion and sediment controls shall be maintained at all times. All accumulated sediment shall be removed from structural controls when sediment deposits reach one-third to one-half the height of the control. All removed sediment deposits shall be properly disposed of in accordance with the approved SWPPP. Non-functioning controls shall be repaired, replaced or supplemented with functional controls within twenty-four (24) hours of discovery or as soon as field conditions allow.

Inspections: Describe the inspection and inspection documentation procedures.

Inspection of all receiving streams, outfalls, erosion and sediment controls and other SWPPP requirements shall be performed during permit coverage using a copy of the form provided in the Large Construction Forms Package (or equivalent form), and inspections shall be performed by qualified personnel (see Definitions):

- (1) At least weekly for a minimum of four inspections per month; and
- (2) after any rainfall event that produces a discharge
- (3) As often as is necessary to ensure that appropriate erosion and sediment controls have been properly constructed and maintained and to determine if additional or alternative control measures are required.

Before conducting the site inspection, the inspector should review Chapter 4, Inspector's Checklist and Troubleshooting Chart found in MDEQ's Field Manual for Erosion and Sediment Control on Construction Sites in Mississippi. A daily "walk through" inspection of the construction site will help ensure controls are in place and will function properly.

Staff Training

As required by Act 5 of the Large Construction General Permit, a "stormwater team" must carry out compliance activities related to this permit. Staff shall be trained in installation, maintenance, and/or repair of stormwater controls, storage of chemicals, stormwater inspections, and appropriate corrective action.

Prior to construction beginning, representatives of all contractors working on this project are to have a preconstruction conference with the engineer to review requirements of this SWPPP and the plans as well as general permit requirements. Contractors shall also certify to the Owner that all staff completing "land disturbance work" has received additional training with appropriate "refresher training" annually. Engineer will make periodic site visits and assist if any noted training deficiencies are discovered.

Record Keeping Requirements

All records, reports, forms and information resulting from activities required by this permit shall be retained for a period of at least three (3) years from the date that the document(s) was generated. Any documents required by this permit may be kept electronically but must be readily available during site inspection or upon request.

Adjacent Infrastructure "housekeeping"

Where sediment has been tracked-out from the site onto paved roads, sidewalks, or other paved areas outside the site, remove deposited sediment "immediately" by the end of the next work day. Remove the track-out by sweeping, shoveling, or vacuuming these surfaces, or by similarly effective means of sediment removal. Hosing or sweeping track-out sediment into any stormwater conveyance, storm drain inlet, or Waters of the State is prohibited.

"I certify under penalty of law that this document and all attachments were prepared under my direction or supervision in accordance with a system designed to assure that qualified personnel properly gathered and evaluated the information submitted. Based on my inquiry of the person or persons who manage the system, or those persons directly responsible for gathering the information, the information submitted is, to the best of my knowledge and belief, true, accurate and complete. I am aware that there are significant penalties for submitting false information, including the possibility of fine and imprisonment for knowing violations."

ENGINEER:



Date: 12/18/2024

CONTRACTOR:



Date: 12/18/24

Attachments:

- 1) Vicinity Map with USGS Topographical Map
- 2) Seeding Chart for the State of Mississippi
- 3) Large Construction Notice of Intent
- 4) Site Inspection and Certification Form
- 5) Request for Termination of Coverage
- 6) Associated Plan Sheets

Vicinity Map / Topo Map

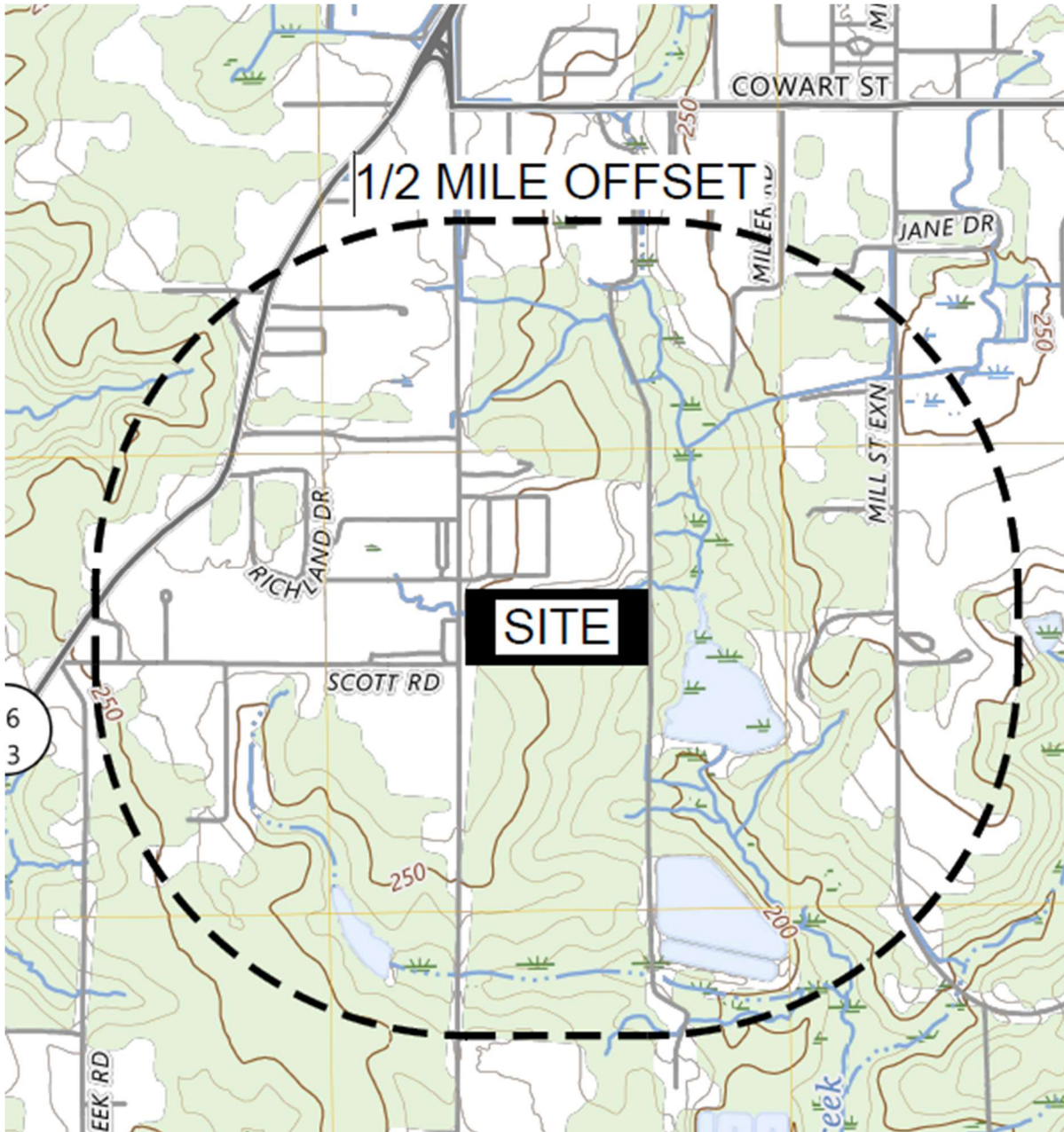

SEEDING CHART FOR THE STATE OF MISSISSIPPI

SPECIES	SEEDING RATE/ACRE	PLANTING TIME	DESIRED pH RANGE	FERTILIZATION RATE/ACRE	METHOD OF ESTABLISHMENT	ZONE OF ADAPTABILITY ¹
Common Bermuda	15 lbs. alone 10 lbs. mixture	3/1 - 7/15 9/1 - 11/30	6.0 - 7.0	600 lbs. 13-13-13	seed or sod	All
Bahia	40 lbs. alone 30 lbs. mixture	3/1 - 7/15 9/1 - 11/30	6.0 - 7.0	600 lbs. 13-13-13	seed	Central South
Fescue	40 lbs. alone 30 lbs. mixture	9/1 - 11/30	6.0 - 7.0	600 lbs. 13-13-13	seed	North Central
Saint Augustine	--	3/1 - 7/15	6.0 - 7.0	600 lbs. 13-13-13	sod only	Central South
Centipede	4 lbs. alone 2.5 lbs. mix	3/1 - 7/15	6.0 - 7.0	600 lbs. 13-13-13	seed or sod	All
Carpet Grass	15 lbs. alone 10 lbs. mixture	3/1 - 7/15	6.0 - 7.0	600 lbs. 13-13-13	seed or sod	All
Oysia Grass	--	3/1 - 7/15	6.0 - 7.0	600 lbs. 13-13-13	sod only	All
Creeping Red Fescue	30 lbs. alone 22.5 lbs. mix	9/1 - 11/30	6.0 - 7.0	600 lbs. 13-13-13	seed	All
Weeping Lovegrass	10 lbs. alone 5 lbs. mix	3/1 - 7/15	6.0 - 7.0	600 lbs. 13-13-13	seed	All
Sericea Lespedeza	40 lbs.	3/1 - 7/15 9/1 - 11/30	6.0 - 7.0	400 lbs. 6-24-24	seed	All
*Wheat	90 lbs. alone	9/1 - 11/30	6.0 - 7.0	600 lbs. 13-13-13	seed	All
*Ryegrass	30 lbs.	9/1 - 11/30	6.0 - 7.0	600 lbs. 13-13-13	seed	All
*White Clover	5 lbs.	9/1 - 11/30	6.0 - 7.0	400 lbs. 6-24-24	seed	All
*Crimson Clover	25 lbs. alone 15 lbs. mix	9/1 - 11/30	6.0 - 7.0	400 lbs. 6-24-24	seed	All
*Hairy Vetch	30 lbs.	9/1 - 11/30	6.0 - 7.0	400 lbs. 6-24-24	seed	All
*Browntop Millet	40 lbs. alone 15 lbs. mix	4/1 - 8/30	6.0 - 7.0	600 lbs. 13-13-13	seed	All

* Annuals. For permanent seeding, annuals can only be used in a mixture with perennials.

North- north of Hwy. 82

Central- south of Hwy. 82 & north of Hwy. 84

South- South of Hwy. 84

AI: 88019

MSR109455

Rec'd via email:
12/19/2024



MISSISSIPPI DEPARTMENT OF
ENVIRONMENTAL QUALITY

LARGE CONSTRUCTION NOTICE OF INTENT (LCNOI) FOR COVERAGE UNDER THE LARGE CONSTRUCTION STORM WATER GENERAL NPDES PERMIT

INSTRUCTIONS

The Large Construction Notice of Intent (LCNOI) is for coverage under the Large Construction General Permit for land disturbing activities of five (5) acres or greater; or for land disturbing activities, which are part of a larger common plan of development or sale that are initially less than five (5) acres but will ultimately disturb five (5) or more acres. Applicant must be the owner or operator. For construction activities, the operator is typically the prime contractor. The owner(s) of the property and the prime contractor associated with regulated construction activity on the property have joint and severable responsibility for compliance with the Large Construction Storm Water General Permit MSR10.

If the company seeking coverage is a corporation, a limited liability company, a partnership, or a business trust, attach proof of its registration with the Mississippi Secretary of State and/or its Certificate of Good Standing. This registration or Certificate of Good Standing must be dated within twelve (12) months of the date of the submittal of this coverage form. Coverage will be issued in the company name as it is registered with the Mississippi Secretary of State.

Completed LCNOIs should be filed at least thirty (30) days prior to the commencement of construction. Discharge of storm water from large construction activities without written notification of coverage is a violation of state law.

Submittals with this LCNOI must include:

- A site-specific Storm Water Pollution Prevention Plan (SWPPP) developed in accordance with ACT5 of the General Permit
- A detailed site-specific scaled drawing showing the property layout and the features outlined in ACT5 of the General Permit
- A United States Geological Survey (USGS) quadrangle map or photocopy, extending at least one-half mile beyond the facility property boundaries with the site location and outfalls outlined or highlighted. The name of the quadrangle map must be shown on all copies. Quadrangle maps can be obtained from the MDEQ, Office of Geology at 601-961-5523.

Additional submittals may include the following, if applicable:

- Appropriate Section 404 documentation from U.S. Army Corps of Engineers
- Appropriate documentation concerning future disposal of sanitary sewage and sewage collection system construction
- Appropriate documentation from the MDEQ Office of Land & Water concerning dam construction and low flow requirements
- Approval from County Utility Authority in Hancock, Harrison, Jackson, Pearl River and Stone Counties
- Antidegradation report for disturbance within Waters of the State

ALL QUESTIONS MUST BE ANSWERED (Answer "NA" if the question is not applicable)

O.C

APPLICANT IS THE: OWNER PRIME CONTRACTOR

OWNER CONTACT INFORMATION

OWNER CONTACT PERSON: BILLY ANDERSON
 OWNER COMPANY LEGAL NAME: BA INVESTMENTS, LLC
 OWNER STREET OR P.O. BOX: 6188 HWY 198
 OWNER CITY: LUCEDALE STATE: MS ZIP: 39452
 OWNER PHONE #: (601) 673-4774 OWNER EMAIL: billya@andersonconstructionms.net

PREPARER CONTACT INFORMATION

IF NOI WAS PREPARED BY SOMEONE OTHER THAN THE APPLICANT

CONTACT PERSON: Andy Phelan
 COMPANY LEGAL NAME: PHELAN ENGINEERING, LLC
 STREET OR P.O. BOX: 2515 HAVARD ROAD
 CITY: Ocean Springs STATE: MS ZIP: 39564
 PHONE # () 228-229-5021 EMAIL: ANDY@GCDEVELOPMENTDESIGN.

PRIME CONTRACTOR CONTACT INFORMATION

PRIME CONTRACTOR CONTACT PERSON: Billy Anderson
 PRIME CONTRACTOR COMPANY LEGAL NAME: Anderson Construction, LLC
 PRIME CONTRACTOR STREET OR P.O. BOX: 6188 HWY 198
 PRIME CONTRACTOR CITY: LUCEDALE STATE: MS ZIP: 39452
 PRIME CONTRACTOR PHONE #: (601) 673-4774 PRIME CONTRACTOR EMAIL: billya@andersonconstructionms.net

FACILITY SITE INFORMATION

FACILITY SITE NAME: OLD 63 SQUARE - COMMERCIAL SUBDIVISION
 FACILITY SITE ADDRESS (If the physical address is not available, please indicate the nearest named road. For linear projects indicate the beginning of the project and identify all counties the project traverses.)
 STREET: +/- 11180 OLD HWY 63
 CITY: LUCEDALE STATE: MS COUNTY: GEORGE ZIP: 39452
 FACILITY SITE TRIBAL LAND ID (N/A If not applicable): N/A
 LATITUDE: 30 degrees 54 minutes 00 seconds LONGITUDE: 88 degrees 35 minutes 44 seconds
 LAT & LONG DATA SOURCE (GPS (Please GPS Project Entrance/Start Point) or Map Interpolation): GOOGLE
 TOTAL ACREAGE THAT WILL BE DISTURBED ¹: 15.57

IS THIS PART OF A LARGER COMMON PLAN OF DEVELOPMENT? YES NO

IF YES, NAME OF LARGER COMMON PLAN OF DEVELOPMENT: _____
AND PERMIT COVERAGE NUMBER: MSR10_____

ESTIMATED CONSTRUCTION PROJECT START DATE: 2025-02-01
 YYYY-MM-DD

ESTIMATED CONSTRUCTION PROJECT END DATE: 2026-02-01
 YYYY-MM-DD

DESCRIPTION OF CONSTRUCTION ACTIVITY: COMMERCIAL SUBDIVISION INFRASTRUCTURE

PROPOSED DESCRIPTION OF PROPERTY USE AFTER CONSTRUCTION HAS BEEN COMPLETED:
COMMERCIAL SUBDIVISION WITH LOTS READY FOR PEOPLE TO BUILD ON

SIC Code: _____ **NAICS Code** _____

NEAREST NAMED RECEIVING STREAM: BIG CEDAR CREEK

IS RECEIVING STREAM ON MISSISSIPPI'S 303(d) LIST OF IMPAIRED WATER BODIES? (The 303(d) list of impaired waters and TMDL stream segments may be found on MDEQ's web site: http://www.deq.state.ms.us/MDEQ.nsf/page/TWB_Total_Maximum_Daily_Load_Section) YES NO

HAS A TMDL BEEN ESTABLISHED FOR THE RECEIVING STREAM SEGMENT? YES NO

FOR WHICH POLLUTANT: MERCURY IN DAVIS DEAD RIVER BASIN

ARE THERE RECREATIONAL STREAMS, PRIVATE/PUBLIC PONDS OR LAKES WITHIN 1/2 MILE DOWNSTREAM OF PROJECT BOUNDARY THAT MAY BE IMPACTED BY THE CONSTRUCTION ACTIVITY? YES NO

EXISTING DATA DESCRIBING THE SOIL (for linear projects please describe in SWPPP):
FINE SANDY LOAM

WILL FLOCCULANTS BE USED TO TREAT TURBIDITY IN STORM WATER? YES NO

IF YES, INDICATE THE TYPE OF FLOCCULANT. ANIONIC POLYACRYLAMIDE (PAM)
 OTHER _____

IF YES, DOES THE SWPPP DESCRIBE THE METHOD OF INTRODUCTION, THE LOCATION OF INTRODUCTION AND THE LOCATION OF WHERE FLOCCULATED MATERIAL WILL SETTLE?

IS A SDS SHEET INCLUDED FOR THE FLOCCULANT? YES NO

WILL THERE BE A 50 FT BUFFER BETWEEN THE PROJECT DISTURBANCE AND THE WATERS OF THE STATE? YES NO

IF NOT, PROVIDE EQUIVALENT CONTROL MEASURES IN THE SWPPP.

¹Acreage for subdivision development includes areas disturbed by construction of roads, utilities and drainage. Additionally, a housesite of at least 10,000 ft² per lot (entire lot, if smaller) shall be included in calculating acreage disturbed.

DOCUMENTATION OF COMPLIANCE WITH OTHER REGULATIONS/REQUIREMENTS
 COVERAGE UNDER THIS PERMIT WILL NOT BE GRANTED UNTIL ALL OTHER REQUIRED
 MDEQ PERMITS AND APPROVALS ARE SATISFACTORILY ADDRESSED

IS LCNOI FOR A FACILITY THAT WILL REQUIRE OTHER PERMITS? YES NO

IF YES, CHECK ALL THAT APPLY: AIR HAZARDOUS WASTE PRETREATMENT
 WATER STATE OPERATING INDIVIDUAL NPDES OTHER: WATER, SEWER, MUNICI

IS THE PROJECT REROUTING, FILLING OR CROSSING A WATER CONVEYANCE OF ANY KIND? (If yes, contact the U.S. Army Corps of Engineers' Regulatory Branch for permitting requirements.) YES NO

IF THE PROJECT REQUIRES A CORPS OF ENGINEER SECTION 404 PERMIT, PROVIDE APPROPRIATE DOCUMENTATION THAT:

- The project has been approved by individual permit, or
- The work will be covered by a nationwide permit and NO NOTIFICATION to the Corps is required, or
- The work will be covered by a nationwide or general permit and NOTIFICATION to the Corps is required

IS THE PROJECT REROUTING, FILLING OR CROSSING A STATE WATER CONVEYANCE OF ANY KIND? (If yes, please provide an antidegradation report.) YES NO

IS A LAKE REQUIRING THE CONSTRUCTION OF A DAM BEING PROPOSED? (If yes, provide appropriate approval documentation from MDEQ Office of Land and Water, Dam Safety.) YES NO

IF THE PROJECT IS A SUBDIVISION OR A COMMERCIAL DEVELOPMENT, HOW WILL SANITARY SEWAGE BE DISPOSED? Check one of the following and attach the pertinent documents.

- Existing Municipal or Commercial System. Please attach plans and specifications for the collection system and the associated "Information Regarding Proposed Wastewater Projects" form or approval from County Utility Authority in Hancock, Harrison, Jackson, Pearl River and Stone Counties. If the plans and specifications can not be provided at the time of LCNOI submittal, MDEQ will accept written acknowledgement from official(s) responsible for wastewater collection and treatment that the flows generated from the proposed project can and will be transported and treated properly. The letter must include the estimated flow.
- Collection and Treatment System will be Constructed. Please attach a copy of the cover of the NPDES discharge permit from MDEQ or indicate the date the application was submitted to MDEQ (Date: _____.)
- Individual Onsite Wastewater Disposal Systems for Subdivisions Less than 35 Lots. Please attach a copy of the Letter of General Acceptance from the Mississippi State Department of Health or certification from a registered professional engineer that the platted lots should support individual onsite wastewater disposal systems.
- Individual Onsite Wastewater Disposal Systems for Subdivisions Greater than 35 Lots. A determination of the feasibility of installing a central sewage collection and treatment system must be made by MDEQ. A copy of the response from MDEQ concerning the feasibility study must be attached. If a central collection and wastewater system is not feasible, then please attach a copy of the Letter of General Acceptance from the State Department of Health or certification from a registered professional engineer that the platted lots should support individual onsite wastewater disposal systems.

INDICATE ANY LOCAL STORM WATER ORDINANCE (I.E. MS4) WITH WHICH THE PROJECT MUST COMPLY:

CITY OF LUCEDALE _____

I certify under penalty of law that this document and all attachments were prepared under my direction or supervision in accordance with a system designed to assure that qualified personnel properly gathered and evaluated the information submitted. Based on my inquiry of the person or persons who manage the system, or those persons directly responsible for gathering the information, the information submitted is, to the best of my knowledge and belief, true, accurate and complete. I am aware that there are significant penalties for submitting false information, including the possibility of fine and imprisonment for knowing violations.

Signature of Applicant¹ (owner or prime contractor)

12/18/24
Date Signed

Billy Anderson
Printed Name¹

Owner
Title

¹This application shall be signed as follows:

- For a corporation, by a responsible corporate officer.
- For a partnership, by a general partner.
- For a sole proprietorship, by the proprietor.

For a municipal, state or other public facility, by principal executive officer, mayor, or ranking elected official

Please submit the LCNOI form to: Chief, Environmental Permits Division
MS Department of Environmental Quality, Office of Pollution Control
P.O. Box 2261
Jackson, Mississippi 39225

Electronically: <https://www.mdeq.ms.gov/construction-stormwater/>

Revised 3/23/22

**Keep a Copy Available at the Permitted Facility or Locally Available
Submit the Inspection Reports Only if Requested by the Mississippi Department of Environmental Quality (MDEQ)**

**LARGE CONSTRUCTION GENERAL PERMIT
SITE INSPECTION AND CERTIFICATION FORM
COVERAGE NUMBER (MSR10 _____)**



INSTRUCTIONS

Results of construction storm water inspections required by ACT6 of this permit shall be recorded on this report form and kept with the Storm Water Pollution Prevention Plan (SWPPP) in accordance with the inspection documentation provisions of ACT9 of the this permit. Inspections shall be performed at least weekly for a minimum of four inspections per month. The coverage number must be listed at the top of all Inspection and Certification Forms.

COVERAGE RECIPIENT INFORMATION

OWNER/PRIME CONTRATOR NAME: ANDERSON CONSTRUCTION

PROJECT NAME: OLD 63 SQUARE

PROJECT STREET ADDRESS: +/- 11180 OLD HWY 63

PROJECT CITY: LUCE DALE PROJECT COUNTY: GEORGE

OWNER/PRIME CONTRACTOR MAILING ADDRESS: 6188 HWY 198

MAILING CITY: LUCE DALE STATE: MS ZIP: 39452

CONTACT PERSON: BILLY ANDERSON CONTACT PHONE NUMBER: (601) 673-4774

EMAIL ADDRESS: billya@andersonconstructionms.net

INSPECTION DOCUMENTATION

DATE (mo/day/yr)	TIME (hr:min AM/PM)	ANY DEFICIENCIES? (CHECK IF YES)	INSPECTOR(S)
		<input type="checkbox"/>	
		<input type="checkbox"/>	
		<input type="checkbox"/>	
		<input type="checkbox"/>	
		<input type="checkbox"/>	
		<input type="checkbox"/>	

Deficiencies Noted During any Inspection (give date(s); attach additional sheets if necessary): _____

Corrective Action Taken or Planned (give date(s); attach additional sheets if necessary): _____

Based upon this inspection, which I or personnel under my direct supervision conducted, I certify that all erosion and sediment controls have been implemented and maintained, except for those deficiencies noted above, in accordance with the Storm Water Pollution Prevention Plan (SWPPP) and sound engineering practices as required by the above referenced permit. I further certify that the LCNOI and SWPPP information is up to date.

I certify under penalty of law that this document and all attachments were prepared under my direction or supervision in accordance with a system designed to assure that qualified personnel properly gather and evaluate the information submitted. Based on my inquiry of the person or persons responsible for gathering the information, the information submitted is, to the best of my knowledge and belief, true, accurate and complete. I am aware that there are significant penalties for submitting false information, including the possibility of fines and imprisonment for knowing violations.

Authorized Signature

Date

Printed Name

Title

Request for Termination (RFT) of Coverage



LARGE CONSTRUCTION GENERAL PERMIT
Coverage No. MSR10 _____ County _____
(Fill in your Certificate of Coverage Number and County)

This form must be submitted within thirty (30) days of achieving final stabilization (see ACT10, S-1 of general permit). Failure to submit this form is a violation of permit conditions.

Color photographs, representative of the stabilized construction site, must be submitted with this form.

The signatory of this form must be the owner or operator (prime contractor) who is the current coverage recipient (rather than the project manager or environmental consultant).

(Please Print or Type)

Project Name _____

Physical Site Street Address (if not available, indicate nearest named road): _____

City: _____ County: _____ Zip: _____

Latitude: degrees minutes seconds Longitude: degrees minutes seconds

Lat & Long Data source (GPS or Map Interpolation): _____

Coverage Recipient Company Name: _____

Street Address / P.O. Box: _____

City: _____ State: _____ Zip: _____

Coverage Recipient Contact Name and Position: _____ Tel. #: (____) _____

EMAIL: _____

Has another owner(s) or operator(s) assumed control over all areas of the site that have not reached final stabilization?

RESIDENTIAL SUBDIVISIONS:

- YES. A copy of the Registration Form for Residential Lot Coverage for each lot or out parcel that has been sold and a site map, indicating which lots have been sold, are attached.
- NO. Coverage may not be terminated until all areas have reached final stabilization.

COMMERCIAL DEVELOPMENT:

- YES. A copy of the site map, indicating which out-parcels have been sold, is attached.
- NO. Coverage may not be terminated until all areas have reached final stabilization.

I certify under penalty of law that this document and all attachments were prepared under my direction or supervision in accordance with a system designed to assure that qualified personnel properly gathered and evaluated the information submitted. Based on my inquiry of the person or persons who manage the system, or those persons directly responsible for gathering the information, the information submitted is, to the best of my knowledge and belief, true, accurate and complete. I am aware that there are significant penalties for submitting false information, including the possibility of fines and imprisonment for knowing violations. I understand that by submitting this Request for Termination and receiving written confirmation, I will no longer be authorized to discharge storm water associated with construction activity under this general permit. Discharging pollutants associated with construction activity to waters of the State without proper permit coverage is a violation of state law. I also understand that the submittal of this Request for Termination does not release an owner or operator from liability for any violations of this permit or the Clean Water Act.

Authorized Name (Print) Telephone Signature Date Signed

¹This application shall be signed according to the General Permit, ACT11, T-7 as follows:

- For a corporation, by a responsible corporate officer.
- For a partnership, by a general partner.
- For a sole proprietorship, by the proprietor.
- For a municipal, state or other public facility, by principal executive officer, mayor, or ranking elected official.

After signing please mail to: Chief, Environmental Permits Division
MS Department of Environmental Quality, Office of Pollution Control
P.O. Box 2261
Jackson, Mississippi 39225

Electronically: <https://www.mdeq.ms.gov/construction-stormwater/>

POND DATA	
POND BOTTOM	227.50
POND TOP	232.00
POND DEPTH	4.50 FT
POND VOLUME	41865 CF
25-YR FLOW INTO POND	48.32 CFS
25-YR POND DISCHARGE	8.86 CFS
25-YR WSE	230.77
25-YR MAX STORAGE	27425 CF
25-YR UNDETAINED FLOW	14.52 CFS
100-YR FLOW INTO POND	59.12 CFS
100-YR POND DISCHARGE	9.98 CFS
100-YR WSE	231.35
100-YR MAX STORAGE	34198 CF
100-YR UNDETAINED FLOW	17.90 CFS
CULVERT OUTFALL = 15" HDPE AT 227.50 @ 0.25%	
10' EMERGENCY SPILL WAY AT ELEV = 231.50	

RUNOFF: PRE- VS POST-DEVELOPED			
	25-YR	100-YR	ACRES ANALYZED
PRE-DEV	23.73	29.31	15.61
POST-DEV	22.72	27.22	15.61

CHANNEL SIZING - OLD 63 SQUARE										
ID	MIN SLOPE	MIN DEPTH	SIDE SLOPES	Q(CAP) CFS	Q(25) CFS	Q(100) CFS	V(25) FPS	V(100) FPS	DEPTH (25) FT	DEPTH (100) FT
A1	5.0%	1.5	2:1	38.19	1.07	1.30	3.34	3.52	0.40	0.43
A2	2.0%	1.5	2:1	24.15	17.07	20.90	4.90	5.11	1.32	1.43
B1	2.0%	1.5	2:1	24.15	2.25	2.76	2.93	3.07	0.62	0.67
C1	2.0%	1.5	2:1	24.15	1.07	1.31	2.42	2.52	0.47	0.51
D1	2.0%	1.5	2:1	24.15	2.02	2.47	2.81	3.02	0.60	0.64
E1	2.0%	2.0	3:1	81.16	19.02	23.28	4.63	4.89	1.17	1.26
F1	4.0%	1.5	2:1	34.16	1.16	1.42	3.14	3.36	0.43	0.46
F2	0.5%	2.0	3:1	40.58	28.93	35.40	3.08	3.23	1.77	1.91

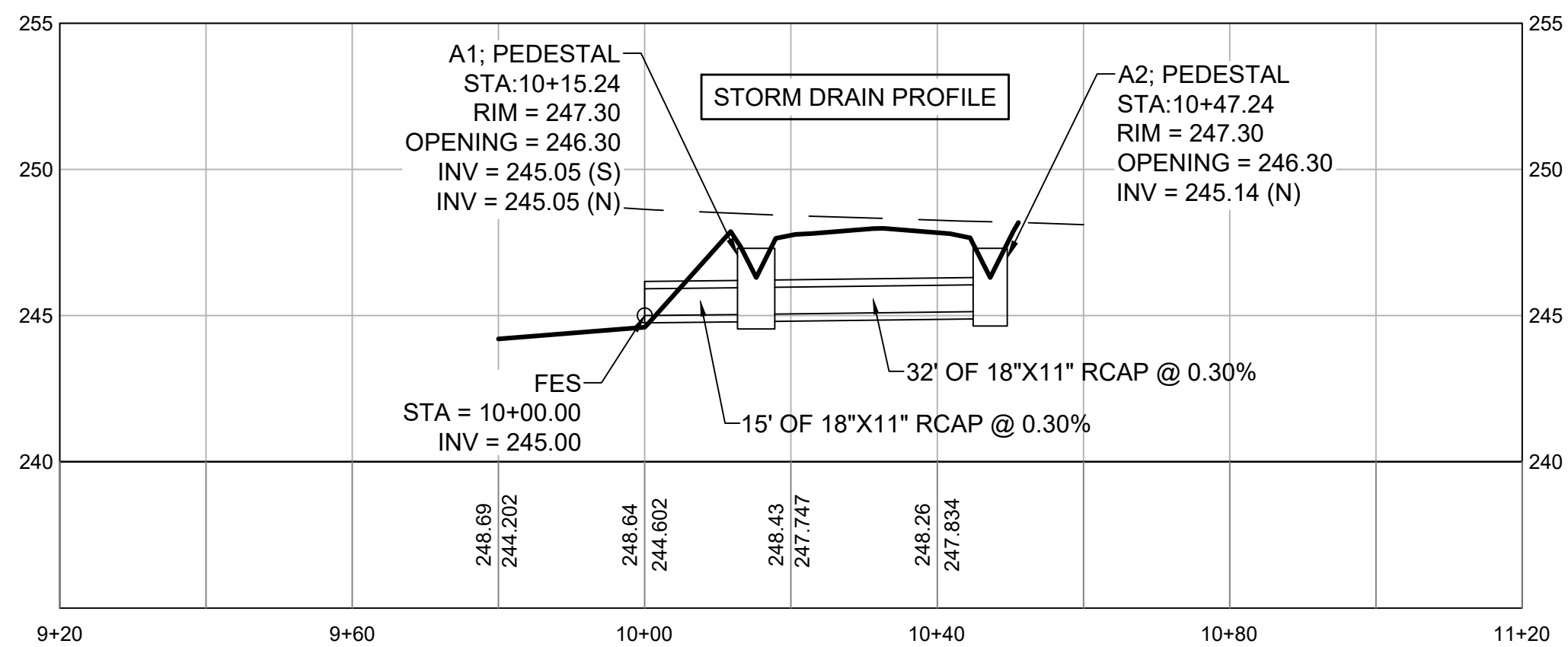

SCALE: 1 INCH = 50 FEET

THIS PROPERTY IS LOCATED IN FLOOD ZONE X (AREAS DETERMINED TO BE OUTSIDE THE 0.2% CHANCE FLOOD PLAIN) ACCORDING TO FLOOD INSURANCE RATE MAP NO. 28039C090E DATED 09/19/2012

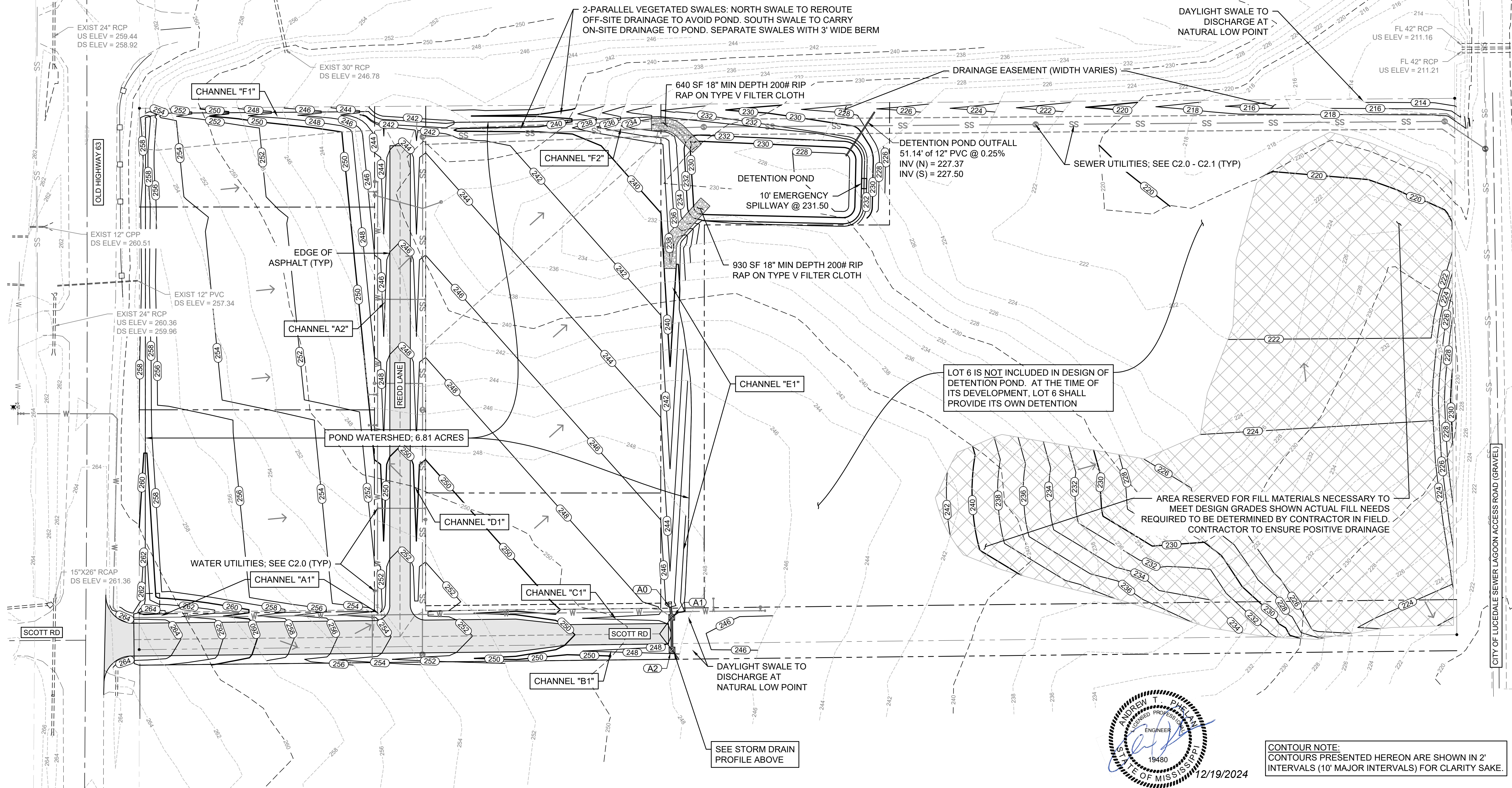

ANDREW T. PHELAN
REGISTERED PROFESSIONAL ENGINEER
STATE OF MISSISSIPPI
19480
12/19/2024

PROJECT: OLD 63 SQUARE; COMMERCIAL SUBDIVISION
CITY REVIEW
PROJECT ADDRESS: +/- 11180 OLD HIGHWAY 63, LUCEDALE, MS
PROJECT NO.: 041
DATE: DEC 2024

REVISION DESCRIPTION

NO. DATE BY

PHELAN ENGINEERING LLC

GRADING AND DRAINAGE PLAN
SHEET TYPE

SHEET NUMBER: C3.0

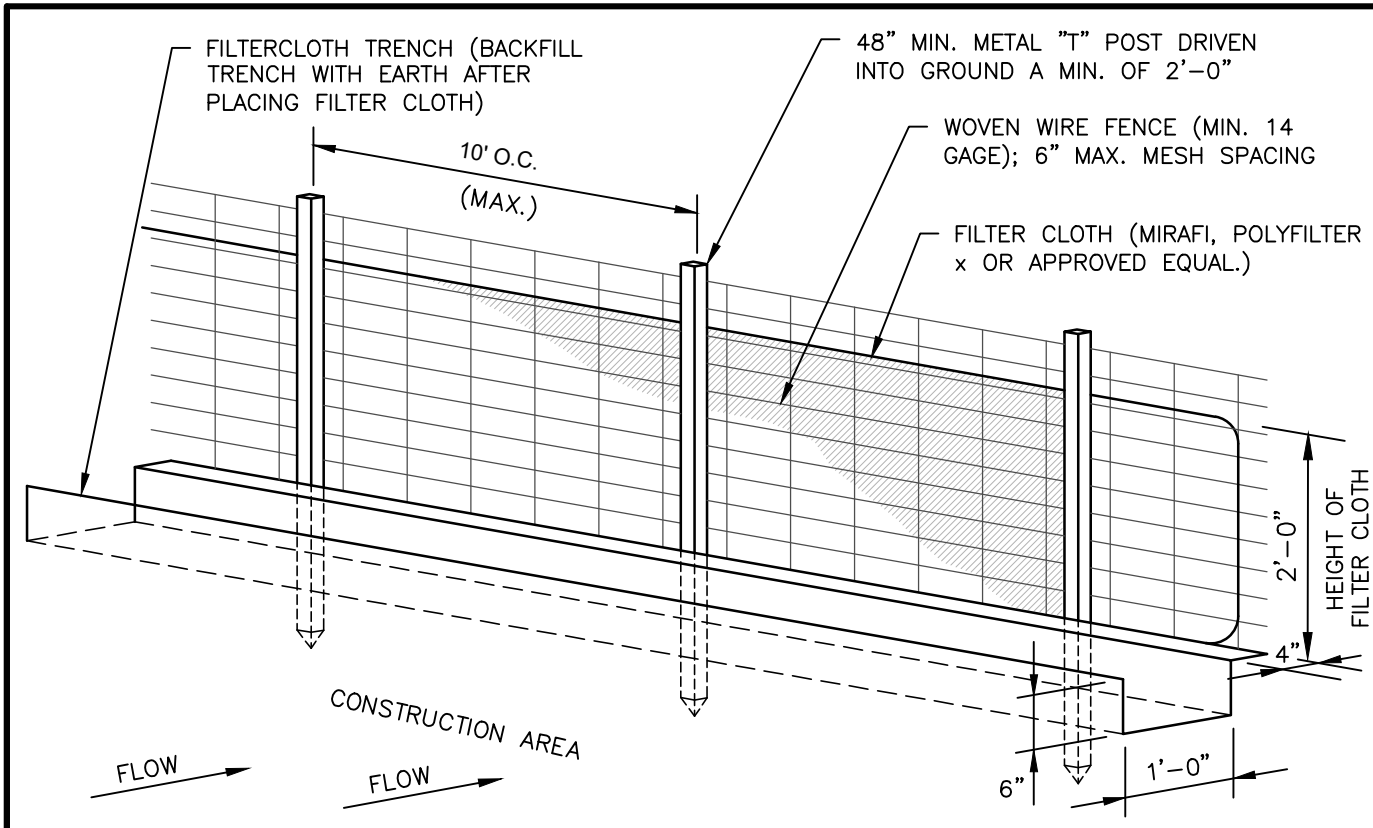

- INSTALLATION:**
1. USE STEEL "T" POSTS THAT ARE 5 FEET IN LENGTH.
 2. INSTALL POSTS STARTING AT THE CENTER OF THE LOWEST POINT OF THE FENCE LINE. DRIVE POSTS 12 INCHES INTO THE GROUND.
 3. INSTALL POSTS ON 10-FOOT CENTERS IF METAL MESH FENCING IS TO BE USED AS ADDITIONAL SUPPORT. IF NO METAL FENCING SUPPORT IS USED, THEN INSTALL POSTS ON 6-FOOT CENTER OR LESS.
 4. EXCAVATE A TRENCH 4 INCHES DEEP BY 4 INCHES WIDE ON THE UPHILL SIDE OF THE FENCE POSTS.
 5. STAPLE OR TIE THE SILT FENCE FABRIC TO POSTS ON UPHILL SIDE, LEAVING 8 INCHES ON THE BOTTOM TO EXTEND DOWN AND ACROSS THE BOTTOM OF THE TRENCH.
 6. BACKFILL TRENCH AND TAMP DOWN OVER FABRIC.
 7. ALLOW 6-INCH OVERLAP AT JOINTS.
 8. MULCH BARE GROUND UPHILL OF SILT FENCE OR PROVIDE OTHER EROSION CONTROL MEASURES.
- MAINTENANCE:**
1. REMOVE ACCUMULATED SEDIMENT ALONG THE FENCE WHEN IT HAS REACHED A THIRD TO A HALF OF THE FENCE HEIGHT. DO NOT PLACE SEDIMENT ON THE DOWNHILL SIDE.
 2. INSPECT WEEKLY AND AFTER EACH SIGNIFICANT STORM EVENT (GREATER THAN 1/2 INCH OF RAIN).
 3. REMOVE FENCE WHEN AREA ABOVE THE FENCE HAS BEEN STABILIZED.
 4. IF FABRIC IS TORN, THEN REPLACE WITH A NEW PIECE THAT STRETCHES TO POST ON EITHER SIDE OF THE TEAR.

SILT FENCE DETAIL		
DATE: 5/20/15	APPR. BY: BCM	REVISION
SCALE: N.T.S.	DR. NO.: 02295 DWG.-1	
DR. BY:	FILE: SILTFNC	

CITY OF GULFPORT
STANDARD CONSTRUCTION DETAILS

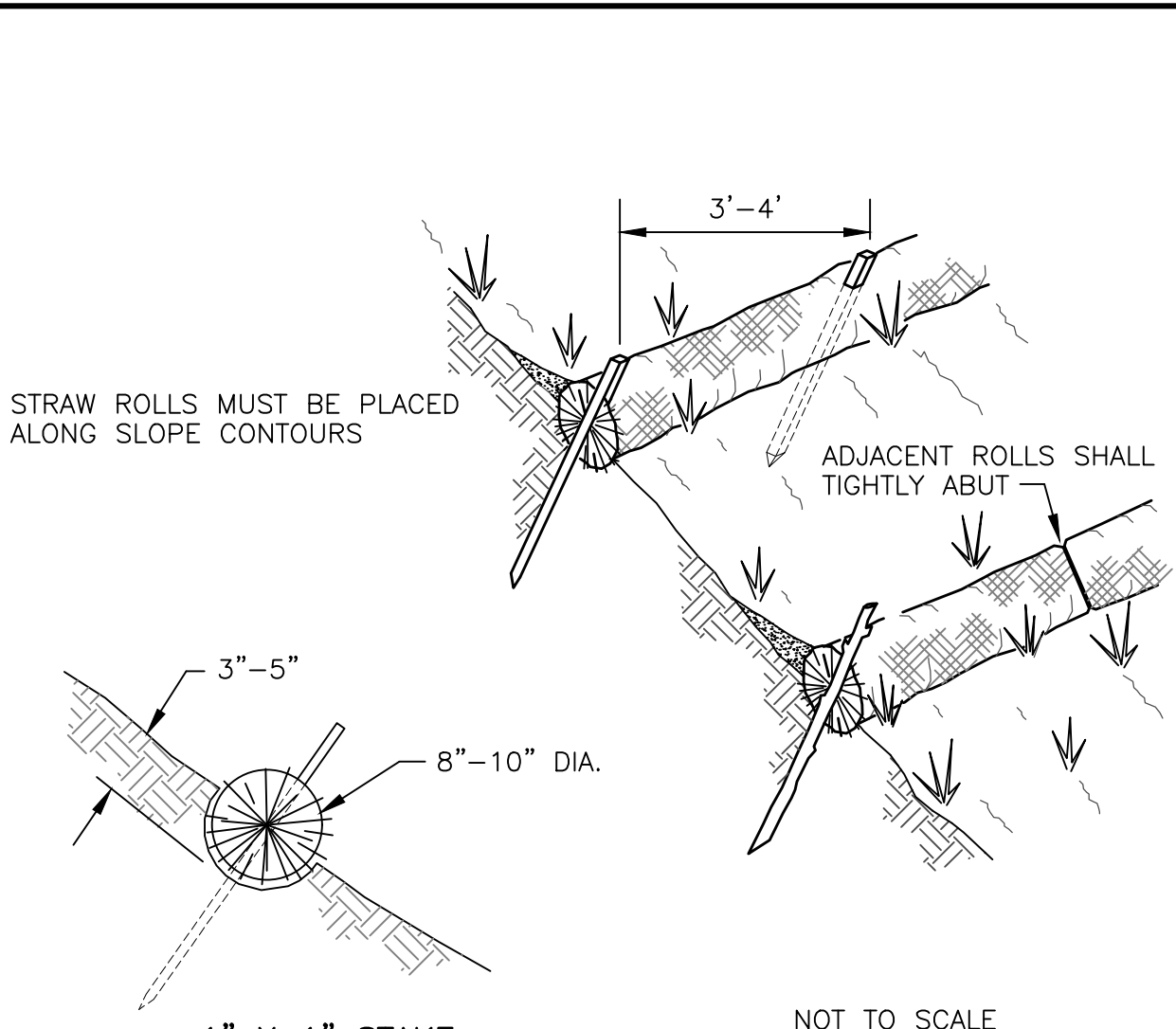

- NOTE:**
1. STRAW ROLL INSTALLATION REQUIRES THE PLACEMENT AND SECURE STAKING OF THE ROLL IN A TRENCH, 3"-5" DEEP, DUG ON CONTOUR. RUNOFF MUST NOT BE ALLOWED TO RUN UNDER OR AROUND ROLL.

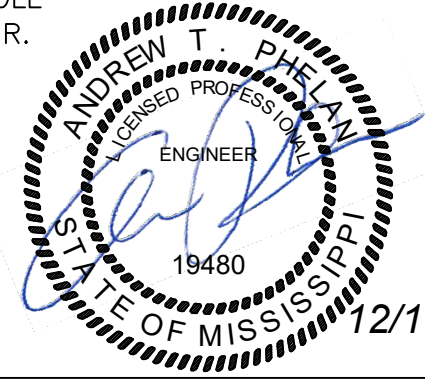

STRAW ROLL WATTLE DETAIL		
DATE: 5/20/15	APPR. BY: BCM	REVISION
SCALE: N.T.S.	DR. NO.: 02295-B	
DR. BY:	FILE: STRAWWATTLE	

CITY OF GULFPORT
STANDARD CONSTRUCTION DETAILS

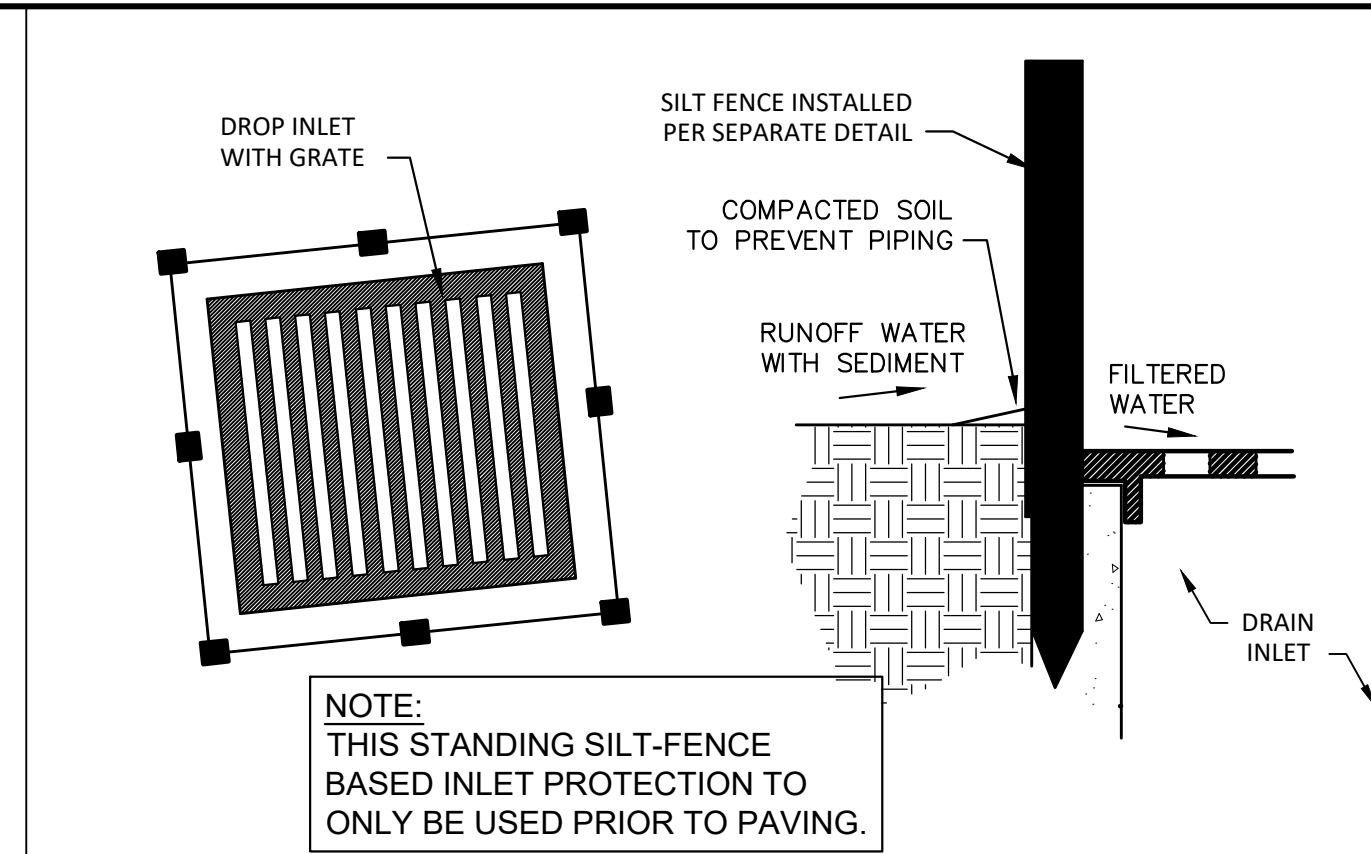

- NOTE:**
THIS WRAPPED INLET PROTECTION MAY BE USED PRIOR TO AND AFTER PAVING OPERATIONS ARE COMPLETE.
- NOTE:**
THIS STANDING SILT-FENCE BASED INLET PROTECTION TO ONLY BE USED PRIOR TO PAVING.
- NOTE:**
STRAW WATTLES ARE NOT AN ACCEPTABLE ALTERNATIVE FOR INLET PROTECTION

STORM DRAIN INLET PROTECTION DETAIL		
DATE: 5/20/15	APPR. BY: BCM	REVISION
SCALE: N.T.S.	DR. NO.: 02295	
DR. BY:	FILE: INLET PROTECTION	

CITY OF GULFPORT
STANDARD CONSTRUCTION DETAILS

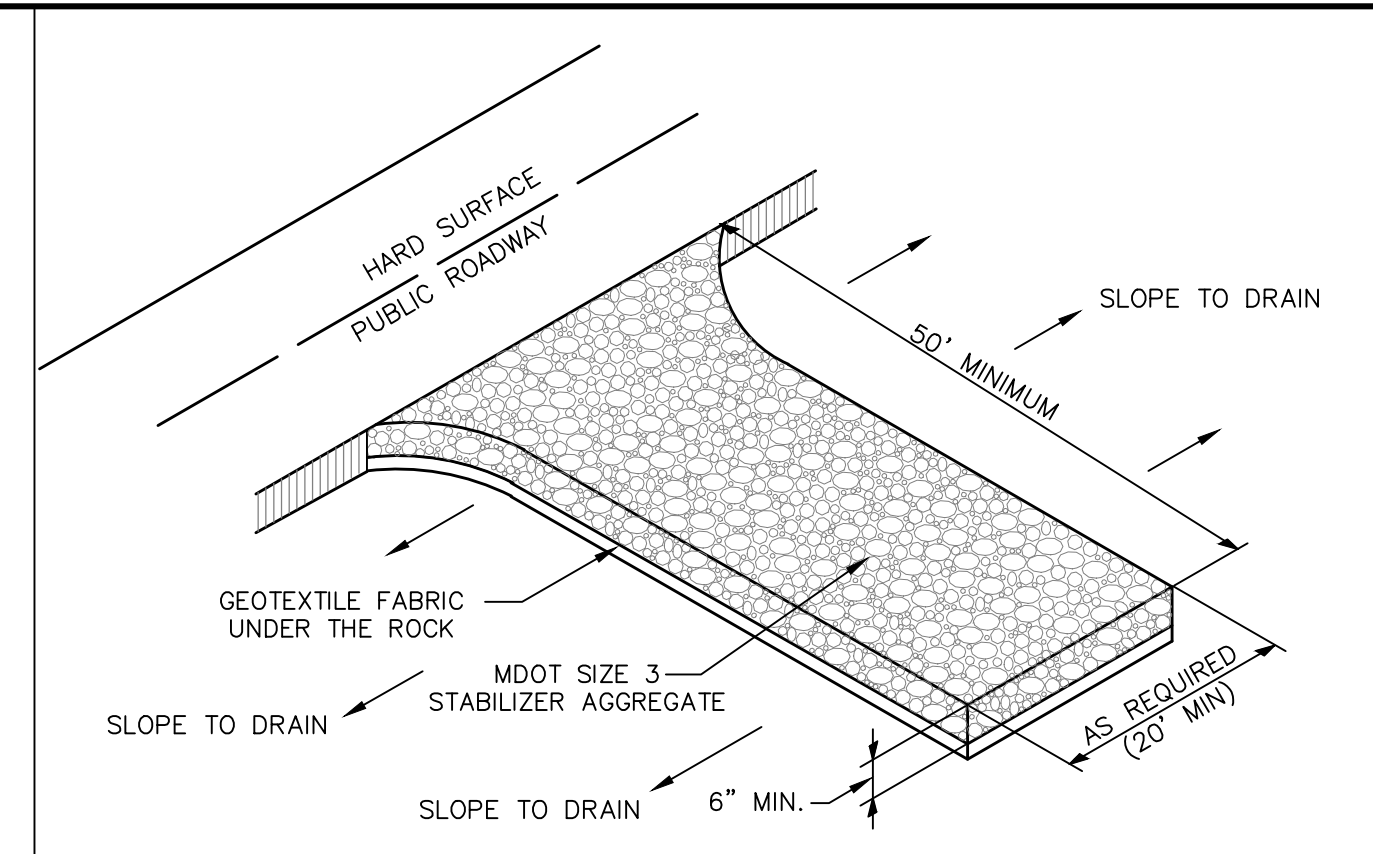

- NOTES:**
1. THE AREA OF THE CONSTRUCTION ENTRANCE SHALL BE EXCAVATED 6 INCHES DEEP, 50 FEET LONG AND SHALL EXTEND THE FULL WIDTH OF ANY VEHICULAR INGRESS AND EGRESS (MINIMUM 20 FEET) LOCATED ON THE SITE.
 2. THE ENTRANCE SHALL BE PROPERLY MAINTAINED FOR THE DURATION OF THE PROJECT TO PREVENT THE TRACKING OF SEDIMENT ONTO PUBLIC RIGHT-OF-WAY. ALL MAINTENANCE AND REPAIRS SHALL BE THE RESPONSIBILITY OF THE CONTRACTOR.
 3. THE ENTRANCE SHALL BE CHECKED ON A DAILY BASIS AND BEFORE & AFTER ANY RAINFALL EVENT FOR ANY DAMAGES. ANY DAMAGES FOUND SHALL BE REMEDIATED BEFORE THE DAYS END AT NO ADDITIONAL COST TO THE CITY.
 4. THE ENTRANCE SHALL BE PROPERLY GRADED TO PREVENT THE FLOW OF SEDIMENT ONTO PUBLIC RIGHT-OF-WAY. ALL MATERIALS SPILLED, DROPPED, WASHED OR TRACKED FROM VEHICLES ONTO ROADWAYS OR INTO STORM DRAINS SHALL BE REMOVED IMMEDIATELY.
 5. MEASURES SHALL BE TAKEN TO PREVENT VEHICULAR TRAFFIC FROM BYPASSING THE CONSTRUCTION ENTRANCE DURING INGRESS AND EGRESS.

LIMESTONE CONSTRUCTION ENTRY DETAIL		
DATE: 5/20/15	APPR. BY: DBA	REVISION
SCALE: N.T.S.	DR. NO.: 02295	
DR. BY:	FILE: CONSTRUCT ENTRY.dwg	

CITY OF GULFPORT
STANDARD CONSTRUCTION DETAILS

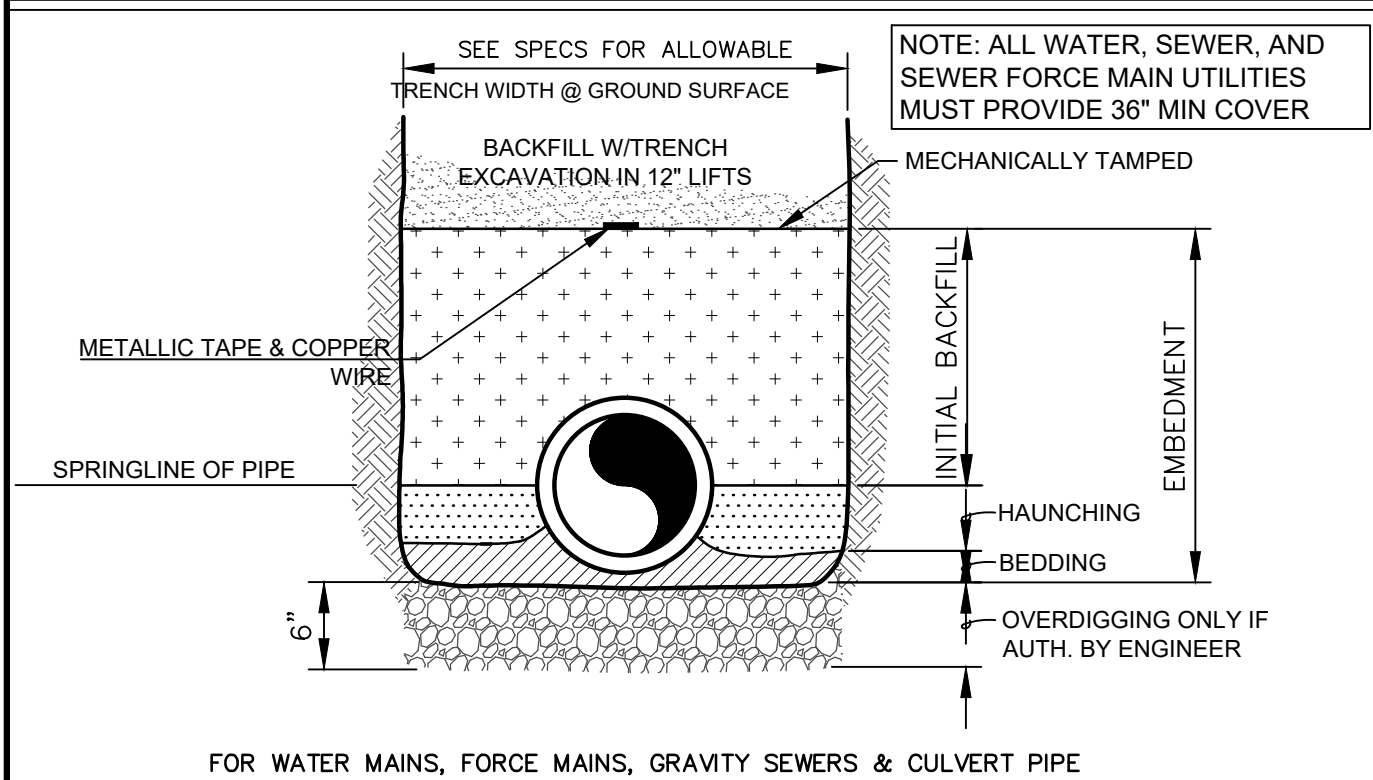

- PIPE EMBEDMENT AND BACKFILL**
- SHOULD ENGINEER DETERMINE THAT THE NATIVE MATERIAL AT THE BOTTOM OF THE TRENCH IS NOT A SUITABLE FOUNDATION FOR THE PIPE, HE MAY AUTHORIZE OVERDIGGING THE TRENCH A DEPTH OF 6 INCHES AND REPLACE WITH A SELECT FOUNDATION MATERIAL.
- GENERALLY, LOOSE MATERIAL LEFT BY THE EXCAVATOR ON THE TRENCH BOTTOM AND SOFT MATERIAL SHAVED FROM THE TRENCH EXCAVATION WILL BE ADEQUATE FOR BEDDING THE PIPE SO THAT IT IS FULLY SUPPORTED.
- THE HAUNCHING MATERIAL SHALL BE NATIVE MATERIAL SECURED FROM THE TRENCH EXCAVATION AND THOROUGHLY COMPACTED TO THE SPRING LINE OF THE PIPE AND EXTENDING TO THE SIDE WALLS OF THE TRENCH. A MINIMUM 85 PERCENT STANDARD PROCTOR WILL BE CONSIDERED ADEQUATE COMPACTION.
- THE INITIAL BACKFILL (NATIVE MATERIAL SECURED FROM THE TRENCH EXCAVATION) MAY THEN PROCEED TO A HEIGHT OF 12 INCHES ABOVE THE TOP OF THE PIPE AND MECHANICALLY TAMPED. FURTHER BACKFILL SHALL NOT PROCEED UNTIL INITIAL BACKFILL HAS BEEN OBSERVED BY ENGINEER.
- SHOULD ENGINEER DETERMINE THAT THE NATIVE MATERIAL SECURED FROM THE TRENCH EXCAVATION IS NOT SUITABLE FOR EMBEDMENT, HE MAY AUTHORIZE THE USE OF A SELECT BEDDING MATERIAL.
- FURTHER BACKFILL UTILIZING MATERIAL FROM TRENCH EXCAVATION MAY THEN PROCEED TO THE ORIGINAL GROUND SURFACE IN 12 INCH LIFTS TO ELIMINATE AIR VOIDS. IN AREAS WHERE THE GROUND SURFACE IS TO RECEIVE PAVEMENT, A MINIMUM 85 PERCENT STANDARD PROCTOR FOR EACH LIFT SHALL BE CONSIDERED ADEQUATE COMPACTION.
- CONTRACTOR SHALL MAINTAIN TRENCH BACKFILL AT ORIGINAL GROUND SURFACE UNTIL FINAL ACCEPTANCE OF THE WORK.
- ALL SURPLUS MATERIALS NOT USED IN BACKFILLING SHALL BE REMOVED AND DISPOSED OF BY CONTRACTOR AT HIS OWN EXPENSE.
- METALLIC TAPE WILL BE PLACED IN THE BACKFILL 12 INCHES ABOVE THE TOP OF PVC WATER MAINS, SEWAGE FORCE MAINS, AND PVC GRAVITY SEWER MAINS WITH LETTERING FACING UP.

PIPE EMBEDMENT & BACKFILL		
DATE: 5/20/15	APPR. BY: BCM	REVISION
SCALE: N.T.S.	DR. NO.: 02660	
DR. BY:	FILE: PIPEBED2	

CITY OF GULFPORT
STANDARD CONSTRUCTION DETAILS

NOTE: WHILE THIS PROJECT IS LOCATED IN LUCEDALE, MS. ENGINEER IS UNAWARE OF ANY CIVIL CONSTRUCTION DETAILS SPECIFICALLY DEVELOPED FOR LUCEDALE; NEARBY CITY OF GULFPORT DETAILS ARE SHOWN HEREON.

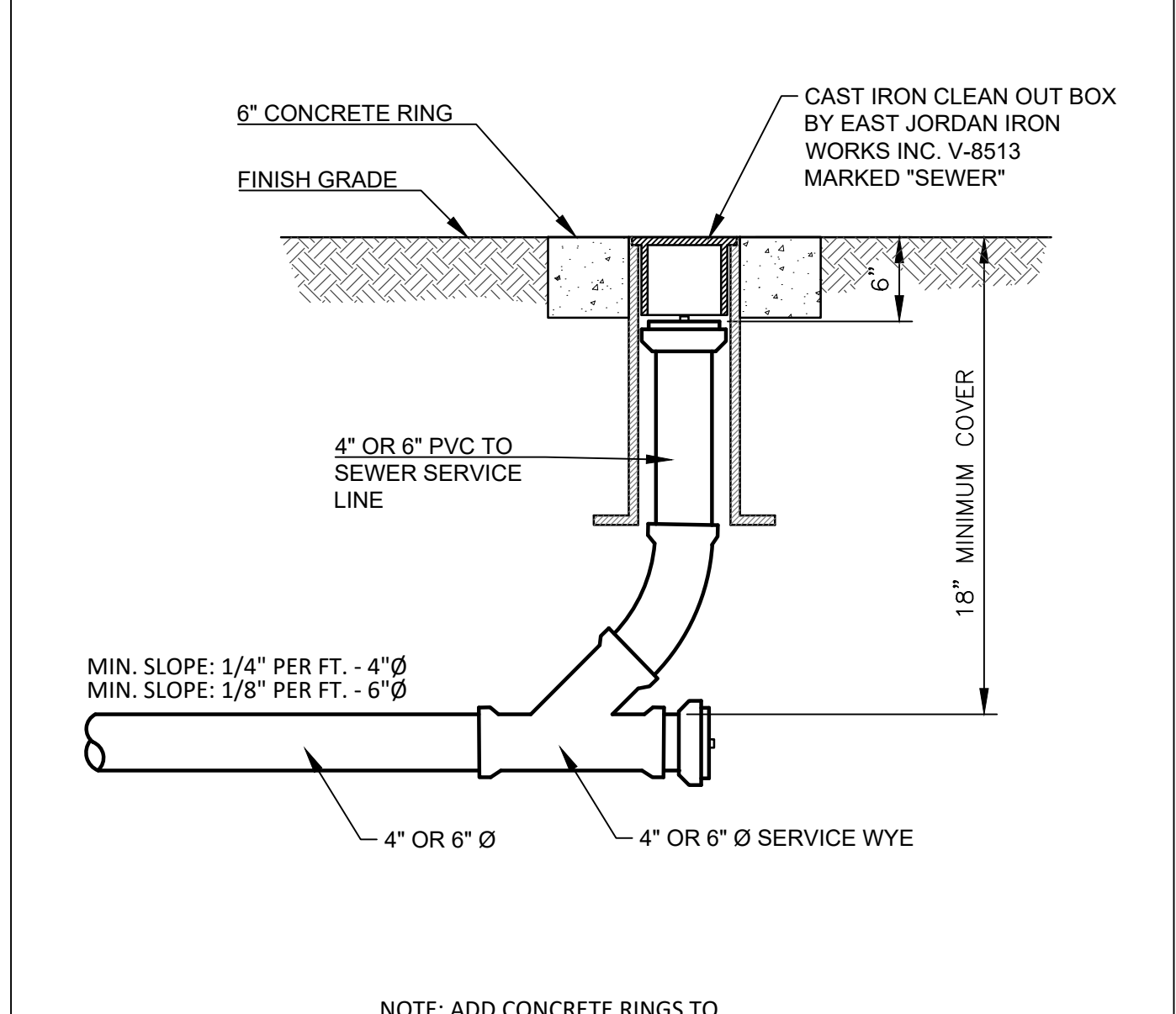

- NOTE: ADD CONCRETE RINGS TO CLEANOUTS IN RIGHT-OF-WAYS**

SEWER CLEANOUT		
DATE: 5/20/15	APPR. BY: BCM	REVISION
SCALE: N.T.S.	DR. NO.: 02730 DWG-2	
DR. BY:	FILE: CLEANOUT	

CITY OF GULFPORT
STANDARD CONSTRUCTION DETAILS

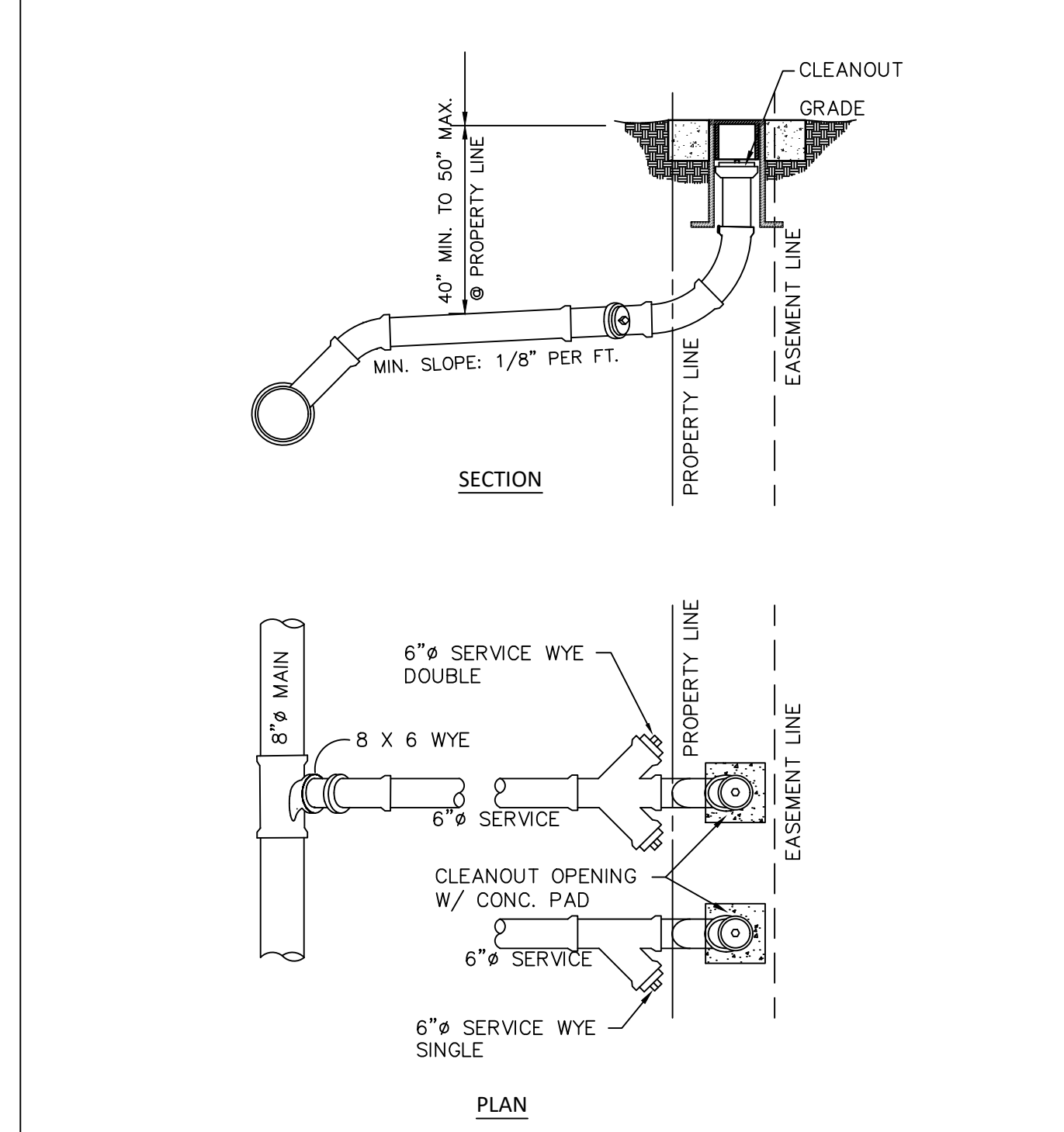

TYPICAL SEWER SERVICE		
DATE: 5/20/15	APPR. BY: BCM	REVISION
SCALE: N.T.S.	DR. NO.: 02730 DWG 3	
DR. BY:	FILE: SWRSRV	

CITY OF GULFPORT
STANDARD CONSTRUCTION DETAILS

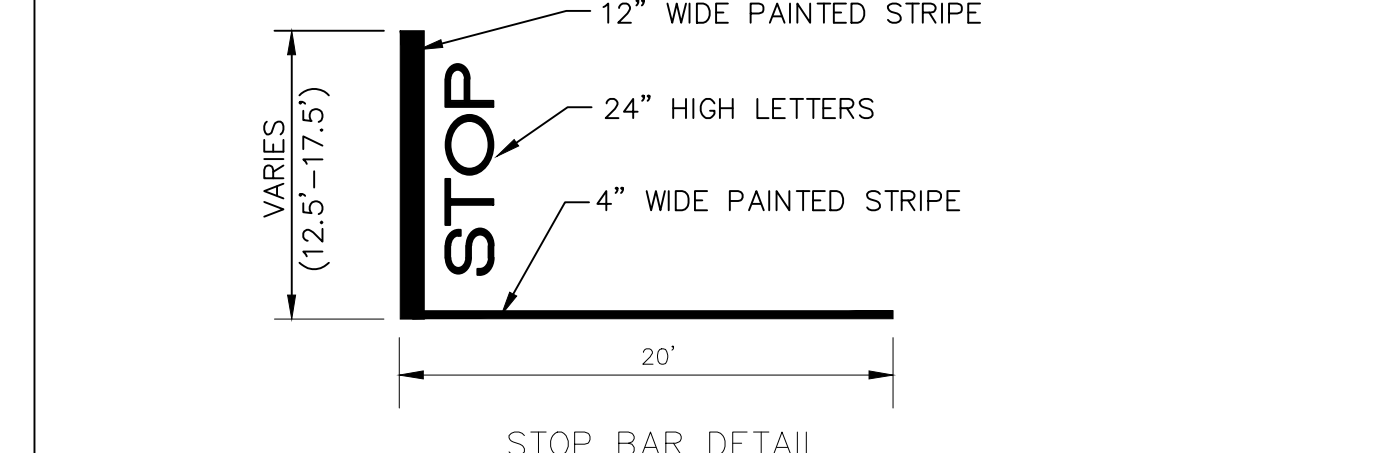
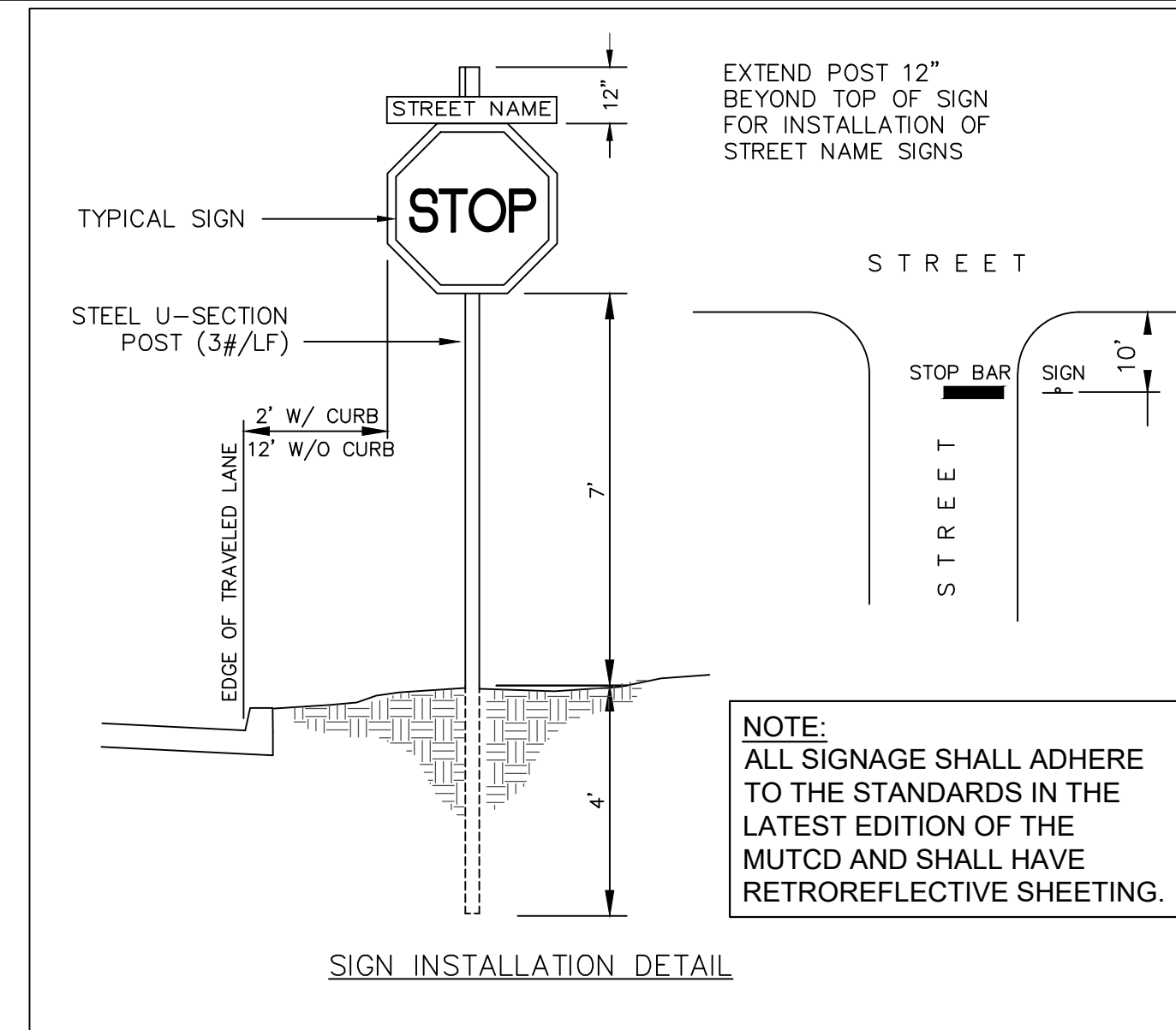

STOP SIGN & BAR DETAIL		
DATE: 5/20/15	APPR. BY: BCM	REVISION
SCALE: N.T.S.	DR. NO.: 02585	
DR. BY:	FILE: STOPSIGN	

CITY OF GULFPORT
STANDARD CONSTRUCTION DETAILS